

LATITUDE 39°20'00" 2,433'

LATITUDE 39°22'30" 8,583' TO BOTTOM HOLE

Antero Resources Corporation
Well No. Nova Unit 2H
API 47-017-06727

8107/05/10

WV NORTH ZONE
GRID NORTH

14,645' TO BOTTOM HOLE

12,385'

LONGITUDE 80°47'30"

LONGITUDE 80°47'30"

1102 1 & 51W

COUNTY NAME

PERMIT

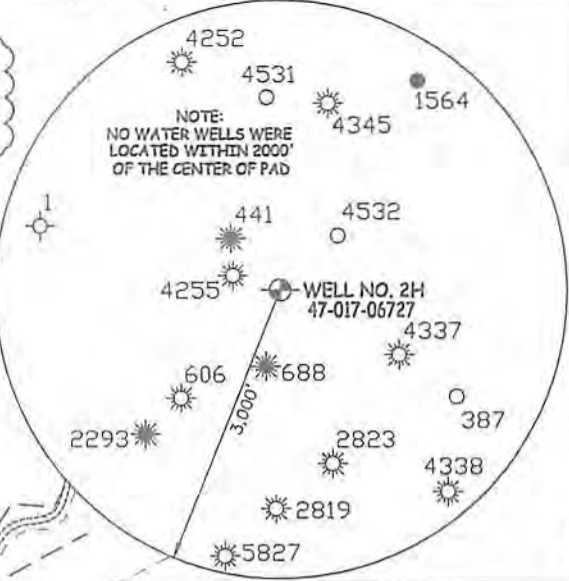

AS DRILLED DATA:
WELL 2H TOP HOLE INFORMATION:
 N: 293,795ft E: 1,632,037ft
 LAT: 39°17'57.59" LON: 80°48'00.95"
BOTTOM HOLE INFORMATION:
 N: 306,799ft E: 1,626,074ft
 LAT: 39°20'05.25" LON: 80°49'19.23"
 WEST VIRGINIA COORDINATE SYSTEM OF 1927 NORTH ZONE. ZONE WAS DERIVED FROM MEASUREMENTS TAKEN WITH TRIMBLE GEOXT SUBMETER MAPPING GRADE GPS UNIT. PLAT ORIENTATION, CORNER, AND WELL REFERENCE TIE LINES ARE BASED ON GRID NORTH.

(NAD) 83 (UTM) ZONE 17 COORDS:
WELL 2H TOP HOLE INFORMATION:
 N: 4,350,023m E: 517,237m
BOTTOM HOLE INFORMATION:
 N: 4,353,954m E: 515,354m

- NOTE**
1. NO OCCUPIED DWELLINGS OR BUILDINGS TWO THOUSAND FIVE HUNDRED (2,500) SQUARE FEET OR LARGER USED TO HOUSE OR SHELTER DAIRY CATTLE OR POULTRY HUSBANDRY ARE LOCATED WITHIN SIX HUNDRED TWENTY-FIVE (625) FEET OF THE CENTER OF THE WELL PAD.
 2. TOP HOLE DATA SHOWN HEREON WAS PROVIDED BY ALLEGHENY SURVEYS, INC.
 3. AS DRILLED DATA WAS PROVIDED BY ANTERO RESOURCES CORPORATION.
 4. WLS IS NOT CERTIFYING THE DATA AND INFORMATION PROVIDED LISTED IN NOTES 2 AND 3. ONLY THE RELATIONSHIP TO THE DATA AND INFORMATION PROVIDED TO THE LEASE BOUNDARIES.
 5. WLS IS BY NO MEANS RESPONSIBLE FOR ANY ERRORS OR INACCURACIES WITH THE DATA AND INFORMATION THAT HAS BEEN PROVIDED.

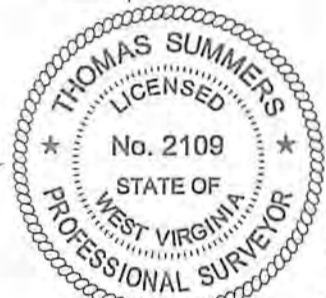

PAD LAYOUT
NOT TO SCALE

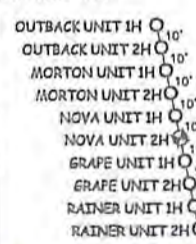

JOB # 15-002WA
 DRAWING # NOVA2HADR
 SCALE 1" = 2000'
 MINIMUM DEGREE OF ACCURACY SUBMETER
 PROVEN SOURCE OF ELEV. SUBMETER MAPPING GRADE GPS

DATE 07/14/17
 OPERATOR'S WELL# NOVAUNIT #2H
 API WELL # 47 - 017 - 06727
 STATE COUNTY PERMIT

I THE UNDERSIGNED, HEREBY CERTIFY THAT THIS PLAT IS CORRECT TO THE BEST OF MY KNOWLEDGE AND BELIEF AND SHOWS ALL THE INFORMATION REQUIRED BY LAW AND THE RULES ISSUED AND PERSCRIBED BY THE DEPARTMENT OF ENVIRONMENTAL PROTECTION.



STATE OF WEST VIRGINIA, DIVISION OF ENVIRONMENTAL PROTECTION, OFFICE OF OIL AND GAS
 WILLOW LAND SURVEYING PLLC
 220 MASONIC AVE. PENNSBORO WEST VIRGINIA 26415

STATE OF WEST VIRGINIA DEPT. OF ENERGY DIVISION OF OIL AND GAS
 WELL TYPE: OIL GAS X LIQUID INJECTION WASTE DISPOSAL
 (IF "GAS") PRODUCTION X STORAGE DEEP SHALLOW X
 LOCATION: AS-DRILLED ELEVATION 1,189'
 WATERSHED HEADWATERS MIDDLE ISLAND CREEK QUADRANGLE WEST UNION 7.5' DISTRICT WEST UNION COUNTY DODDRIDGE
 SURFACE OWNER COASTAL FOREST RESOURCES COMPANY ACREAGE 102 ACRES +/-
 OIL & GAS ROYALTY OWNER ALICE MAXWELL ET AL; GLENEVA MURRAY ET AL; LEASE ACREAGE 420 AC±; 125 AC±;
 MARY MAXINE WELCH; RICHARD MURRAY II; J. DAVIS ET AL; HAUGHT FAMILY TRUST; 202.28 AC±; 14.5 AC±; 12.6 AC±; 45 AC±;
 S.L. FORD ET UX; NELDA LOU KING; JAMES DOUGLAS WHITE; LEWIS MAXWELL ET AL; EDWIN CAIN ET UX 180 AC±; 10 AC±; 150 AC±; 120 AC±; 97 AC±
 PROPOSED WORK: DRILL CONVERT DRILL DEEPER REDRILL FRACTURE OR STIMULATE
 PLUG OFF OLD FORMATION PERFORATE NEW FORMATION OTHER PHYSICAL CHANGE IN WELL
 (SPECIFY) AS DRILLED PLUG & ABANDON CLEAN OUT & REPLUG
 TARGET FORMATION MARCELLUS ESTIMATED DEPTH 6,716' TVD 21,102' MD
 WELL OPERATOR ANTERO RESOURCES CORP. DESIGNATED AGENT DIANNA STAMPER - CT CORPORATION SYSTEM
 ADDRESS 1615 WYNKOOP STREET ADDRESS 5400 D BIG TYLER ROAD
 FORM WW-6 DENVER, CO 80202 CHARLESTON, WV 25313

THOMAS SUMMERS P.S. 2109

LEGEND
 - - - Surface Owner Boundary Lines +/-
 - - - Interior Surface Tracts +/-
 --- Existing Fence
 ⊕ Found monument, as noted
 ⊙ Proposed Well Path
 ⊙ As Drilled Well Path