

Antero Resources Corporation  
Well No. Nova Unit 1H  
API 47-017-06726

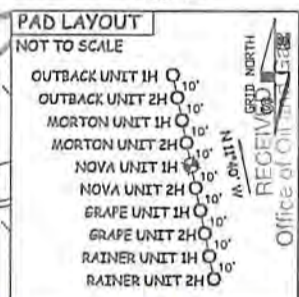

AS DRILLED DATA:  
WELL 1H TOP HOLE INFORMATION:  
N: 293,804ft E: 1,632,035ft  
LAT: 39°17'57.67" LON: 80°48'00.98"  
BOTTOM HOLE INFORMATION:  
N: 305,976ft E: 1,625,649ft  
LAT: 39°19'57.05" LON: 80°49'24.49"  
WEST VIRGINIA COORDINATE SYSTEM OF 1927 NORTH ZONE. ZONE WAS DERIVED FROM MEASUREMENTS TAKEN WITH TRIMBLE GEOXT SUBMETER MAPPING GRADE GPS UNIT. PLAT ORIENTATION, CORNER, AND WELL REFERENCE TIE LINES ARE BASED ON GRID NORTH.

(NAD) 83 (UTM) ZONE 17 COORDS:  
WELL 1H TOP HOLE INFORMATION:  
N: 4,350,025m E: 517,237m  
BOTTOM HOLE INFORMATION:  
N: 4,353,701m E: 515,229m

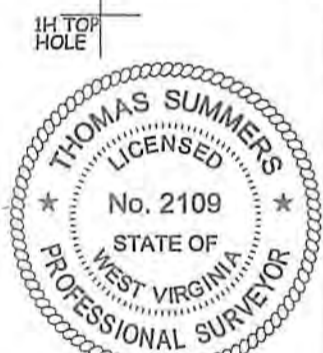

- NOTE
1. NO OCCUPIED DWELLINGS OR BUILDINGS TWO THOUSAND FIVE HUNDRED (2,500) SQUARE FEET OR LARGER USED TO HOUSE OR SHELTER DAIRY CATTLE OR POULTRY HUSBANDRY ARE LOCATED WITHIN SIX HUNDRED TWENTY-FIVE (625) FEET OF THE CENTER OF THE WELL PAD.
  2. TOP HOLE DATA SHOWN HEREON WAS PROVIDED BY ALLEGHENY SURVEYS, INC.
  3. AS DRILLED DATA WAS PROVIDED BY ANTERO RESOURCES CORPORATION.
  4. WLS IS NOT CERTIFYING THE DATA AND INFORMATION PROVIDED LISTED IN NOTES 2 AND 3, ONLY THE RELATIONSHIP TO THE DATA AND INFORMATION PROVIDED TO THE LEASE BOUNDARIES.
  5. WLS IS BY NO MEANS RESPONSIBLE FOR ANY ERRORS OR INACCURACIES WITH THE DATA AND INFORMATION THAT HAS BEEN PROVIDED.

JOB # 15-002WA  
DRAWING # NOVA1HADR  
SCALE 1" = 2000'  
MINIMUM DEGREE OF ACCURACY SUBMETER  
PROVEN SOURCE OF ELEV. SUBMETER MAPPING GRADE GPS

DATE 07/14/17  
OPERATOR'S WELL# NOVA UNIT #1H  
API WELL # 47 - 017 - 06726  
STATE COUNTY PERMIT

I THE UNDERSIGNED, HEREBY CERTIFY THAT THIS PLAT IS CORRECT TO THE BEST OF MY KNOWLEDGE AND BELIEF AND SHOWS ALL THE INFORMATION REQUIRED BY LAW AND THE RULES ISSUED AND PRESCRIBED BY THE DEPARTMENT OF ENVIRONMENTAL PROTECTION.

STATE OF WEST VIRGINIA, DIVISION OF ENVIRONMENTAL PROTECTION, OFFICE OF OIL AND GAS  
WILLOW LAND SURVEYING PLLC  
220 MASONIC AVE. PENNSBORO WEST VIRGINIA 26415

STATE OF WEST VIRGINIA DEPT. OF ENERGY DIVISION OF OIL AND GAS  
WELL TYPE: OIL    GAS X LIQUID INJECTION    WASTE DISPOSAL     
(IF "GAS") PRODUCTION X STORAGE    DEEP    SHALLOW X  
LOCATION: AS-DRILLED ELEVATION 1,189'  
WATERSHED HEADWATERS MIDDLE ISLAND CREEK QUADRANGLE WEST UNION 7.5' DISTRICT WEST UNION COUNTY DODDRIDGE  
SURFACE OWNER COASTAL FOREST RESOURCES COMPANY ACREAGE 102 ACRES +/-  
OIL & GAS ROYALTY OWNER ALICE MAXWELL ET AL; C. THOMAS HYATT ET UX; CORLIS HUDSON ET AL; GLENEVA MURRAY ET AL; ESTELLA GOODFELLOW; G.W. PIGGOTT ET UX; RICHARD MURRAY II; J. DAVIS ET AL; HAUGHT FAMILY TRUST; ARNOLD STUART; S.L. FORD ET UX; EUGENE V. CHIPPS II; JAMES DOUGLAS WHITE; JAMES DOAK ET UX; LEWIS MAXWELL ET AL; EDWIN CAIN ET UX LEASE ACREAGE 420 AC±; 60 AC±; 488.7 AC±; 125 AC±; 11.621 AC±; 124.5 AC±; 14.5 AC±; 12.6 AC±; 45 AC±; 11.6 AC±; 180 AC±; 120 AC±; 150 AC±; 120 AC±; 105 AC±; 97 AC±  
PROPOSED WORK: DRILL    CONVERT    DRILL DEEPER    REDRILL    FRACTURE OR STIMULATE     
PLUG OFF OLD FORMATION    PERFORATE NEW FORMATION    OTHER PHYSICAL CHANGE IN WELL (SPECIFY) AS DRILLED PLUG & ABANDON    CLEAN OUT & REPLUG     
TARGET FORMATION MARCELLUS ESTIMATED DEPTH 6,741' TVD 20,593' MD  
WELL OPERATOR ANTERO RESOURCES CORP. DESIGNATED AGENT DIANNA STAMPER - CT CORPORATION SYSTEM  
ADDRESS 1615 WYNKOOP STREET ADDRESS 5400 D BIG TYLER ROAD  
FORM WW-6 DENVER, CO 80202 CHARLESTON, WV 25313

*Thomas Summers*  
THOMAS SUMMERS P.S. 2109

- LEGEND
- Surface Owner Boundary Lines +/-
  - - - Interior Surface Tracts +/-
  - Existing Fence
  - ⊕ Found monument, as noted
  - Proposed Well Path
  - ⊙ As Drilled Well Path



299' TO BOTTOM HOLE  
 LONGITUDE 80°47'30"  
 12,377'  
 AUG 12 9 00  
 COUNTY NAME PERMIT