

LATITUDE 39°15'00"

11,341'

4,245' TO BOTTOM HOLE  
LATITUDE 39°17'30"

LONGITUDE 80°52'30"  
9,241' TO BOTTOM HOLE  
LONGITUDE 80°50'00"

4,165'

Antero Resources Corporation  
Well No. Mary Jane Unit 1H  
47-017-06699 (AS DRILLED)

LINE	BEARING	DISTANCE
L1	N 72°15' E	1424.3'
L2	N 88°07' E	1606.6'
L3	S 35°12' E	1107.5'
L4	S 17°19' E	1023.9'
L5	S 01°48' W	1030.8'
L6	S 13°26' W	1509.1'
L7	S 14°41' W	1308.9'
L8	S 16°45' W	1051.0'
L9	S 19°07' W	1434.9'
L10	S 24°11' W	1332.7'
L11	S 28°13' W	1000.5'
L12	S 26°15' W	1517.4'
L13	S 32°47' W	1748.1'
L14	S 32°53' W	1005.3'
L15	S 35°35' W	1780.2'
L16	S 38°23' W	1644.9'
L17	S 42°08' W	1809.6'

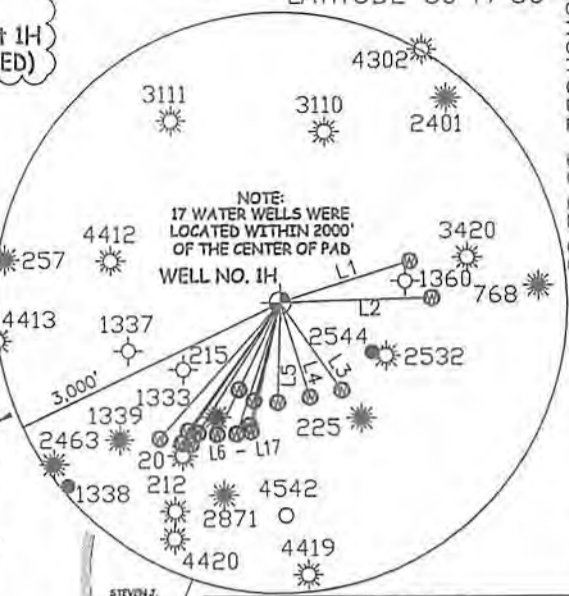

**AS DRILLED DATA:**  
**WELL 1H TOP HOLE INFORMATION:**  
 N: 271,974ft E: 1,611,012ft  
 LAT: 39°14'18.84" LON: 80°52'24.14"  
**BOTTOM HOLE INFORMATION:**  
 N: 282,145ft E: 1,606,461ft  
 LAT: 39°15'58.66" LON: 80°53'23.98"  
 WEST VIRGINIA COORDINATE SYSTEM OF 1927 NORTH ZONE.  
 ZONE WAS DERIVED FROM MEASUREMENTS TAKEN WITH TRIMBLE GEOXT SUBMETER MAPPING GRADE GPS UNIT. PLAT ORIENTATION, CORNER, AND WELL REFERENCE TIE LINES ARE BASED ON GRID NORTH.

**(NAD) 83 (UTM) ZONE 17 COORDS:**  
**WELL 1H TOP HOLE INFORMATION:**  
 N: 4,343,268m E: 510,943m  
**BOTTOM HOLE INFORMATION:**  
 N: 4,346,343m E: 509,505m

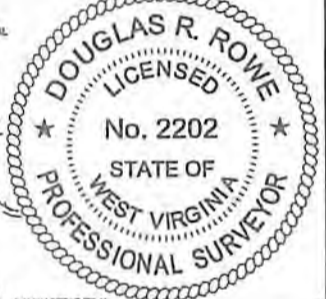

8102/50/10  
01/5/2018



**NOTE**

1. NO OCCUPIED DWELLINGS OR BUILDINGS TWO THOUSAND FIVE HUNDRED (2,500) SQUARE FEET OR LARGER USED TO HOUSE OR SHELTER DAIRY CATTLE OR FOLKLY HUSBANDRY ARE LOCATED WITHIN SIX HUNDRED TWENTY-FIVE (625) FEET OF THE CENTER OF THE WELL PAD.
2. TOP HOLE DATA SHOWN HEREON WAS PROVIDED BY ALLEGHENY SURVEYS, INC.
3. AS DRILLED DATA WAS PROVIDED BY ANTERO RESOURCES CORPORATION.
4. WLS IS NOT CERTIFYING THE DATA AND INFORMATION PROVIDED LISTED IN NOTES 2 AND 3, ONLY THE RELATIONSHIP TO THE DATA AND INFORMATION PROVIDED TO THE LEASE BOUNDARIES.
5. WLS IS BY NO MEANS RESPONSIBLE FOR ANY ERRORS OR DISCREPANCIES WITH THE DATA AND INFORMATION THAT HAS BEEN PROVIDED.

API WELL # 47 - 017 - 06699  
 STATE COUNTY PERMIT

I THE UNDERSIGNED, HEREBY CERTIFY THAT THIS PLAT IS CORRECT TO THE BEST OF MY KNOWLEDGE AND BELIEF AND SHOWS ALL THE INFORMATION REQUIRED BY LAW AND THE RULES ISSUED AND PERSCRIBED BY THE DEPARTMENT OF ENVIRONMENTAL PROTECTION.



STATE OF WEST VIRGINIA, DIVISION OF ENVIRONMENTAL PROTECTION, OFFICE OF OIL AND GAS  
 WILLOW LAND SURVEYING PLLC  
 220 MASONIC AVE. PENNSBORO WEST VIRGINIA 26415

JOB # 14-082WA  
 DRAWING # MARYJANE1HAD  
 SCALE 1" = 1000'  
 MINIMUM DEGREE OF ACCURACY SUBMETER  
 PROVEN SOURCE OF ELEV. SUBMETER MAPPING GRADE GPS

**LEGEND**  
 - - - Surface Owner Boundary Lines +/-  
 - - - Interior Surface Tracts +/-  
 ○ Proposed Well Path  
 ⊙ As Drilled Well Path

DOUGLAS R. ROWE P.S. 2202  
 DATE 11/07/17  
 OPERATOR'S WELL# MARY JANE UNIT #1H

STATE OF WEST VIRGINIA DEPARTMENT OF ENERGY DIVISION OF OIL AND GAS

WELL TYPE: OIL \_\_\_ GAS X LIQUID INJECTION \_\_\_ WASTE DISPOSAL \_\_\_  
 (IF "GAS") PRODUCTION X STORAGE \_\_\_ DEEP \_\_\_ SHALLOW X  
 LOCATION: ELEVATION 991.4' - AS DRILLED WATERSHED CABIN RUN  
 QUADRANGLE OXFORD 7.5' (TOP HOLE) PENNSBORO 7.5' (BOTTOM HOLE)  
 DISTRICT CENTRAL COUNTY DODDRIDGE  
 SURFACE OWNER JAMES E. WEBB ACREAGE 84.89 ACRES +/-

OIL & GAS ROYALTY OWNER CHARLEY WILSON ET UX; H.B. WILLIAMS ET UX; LEASE ACREAGE 91 ACRES+; 307 ACRES+;  
 DONNA HELMICK ET AL; GERALDINE WILLARD; RITA I. TAGANI; ETTA ORDER ET VIR; V. OLIVE ELLIFRIT; E.M. SMITH ET UX 67.25 ACRES+; 131.5 ACRES+; 13.5 ACRES+; 201 ACRES+; 130 ACRES+; 109 ACRES+;  
 PROPOSED WORK: DRILL \_\_\_ CONVERT \_\_\_ DRILL DEEPER \_\_\_ REDRILL \_\_\_ FRACTURE OR STIMULATE \_\_\_  
 PLUG OFF OLD FORMATION \_\_\_ PERFORATE NEW FORMATION \_\_\_ OTHER PHYSICAL CHANGE IN WELL \_\_\_  
 (SPECIFY) AS DRILLED \_\_\_ PLUG & ABANDON \_\_\_ CLEAN OUT & REPLUG \_\_\_  
 TARGET FORMATION MARCELLUS ESTIMATED DEPTH 6,387' TVD 17,542' MD  
 WELL OPERATOR ANTERO RESOURCES CORP. DESIGNATED AGENT DIANNA STAMPER  
 ADDRESS 1615 WYNKOOP STREET ADDRESS 5400 D BIG TYLER ROAD  
 FORM WW-6 DENVER, CO 80202 CHARLESTON, WV 25313

COUNTY NAME PERMIT