

**NOTE:**  
SEE DESIGN FOR WEU 49 WELLS FOR A MORE DETAILED EXHIBIT OF PROPOSED CROSSING & LOCATION OF UTILITIES ETC.

**EQT PRODUCTION COMPANY  
LEWIS MAXWELL LEASE  
WELL NO. WV 514393**

**SHEET 2 OF 2  
SCALE: 1"=500'**



Detail Sketch for Proposed Well WV 514393

- WEU49 WELLS
- H1-WV 514390
- H2-WV 514391
- H3-WV 514392
- H4-WV 514393**
- H5-WV 514394
- H6-WV 514395
- H7-WV 515273
- H8- NOT YET DETERMINED

**NOTE:**  
SEE DESIGN FOR WEU 49 WELLS FOR A MORE DETAILED EXHIBIT OF PROPOSED CROSSING & LOCATION OF UTILITIES ETC.

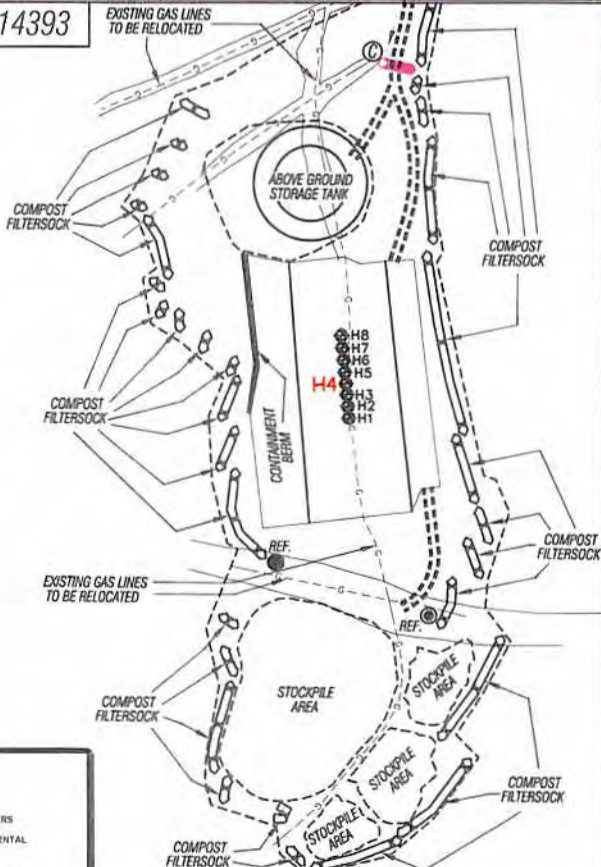

ALL ROADS SHOWN HEREON ARE EXISTING UNLESS OTHERWISE NOTED AND SHALL BE MAINTAINED IN ACCORDANCE WITH WV D.E.P. OIL AND GAS BMP MANUAL ENTRANCES AT COUNTY/STATE ROADS SHALL BE MAINTAINED IN ACCORDANCE WITH WV D.O.T. REGULATION SEPARATE PERMITS MAY BE REQUIRED BY THE D.O.T.

SEDIMENT BASINS (TRAPS) AND APPROPRIATE EROSION CONTROL BARRIERS ARE TO BE CONSTRUCTED AT ALL CULVERT AND CROSS DRAIN INLETS AND OUTLETS AS REQUIRED IN THE WV D.E.P. OIL AND GAS BMP MANUAL. FIELD CONDITIONS (ROCK CUTSLOPES AND BEDROCK) MAY PREVENT INLET TRAPS BEING INSTALLED. WHEN THESE CONDITIONS EXIST ADDITIONAL EROSION CONTROL MEASURES SHALL BE EVALUATED AND UTILIZED AS NEEDED.

EARTHWORK CONTRACTORS ARE RESPONSIBLE FOR NOTIFICATION TO THE OPERATOR AND INSPECTOR PRIOR TO ANY DEVIATION FROM THIS PLAN.

TEMPORARY SEED & MULCH ALL SLOPES AFTER CONSTRUCTION OF LOCATION.

CUT & STACK ALL MARKETABLE TIMBER.

STACKED BRUSH MAY BE USED FOR SEDIMENT CONTROL.

APPLICATIONS FOR SEPARATE PLC PERMITS ON THE ACCESS ROAD STREAM CROSSINGS HAVE BEEN PREPARED (IF APPLIES).

- EXISTING CULVERT
- PROPOSED CULVERT 15' MIN UNLESS OTHERWISE NOTED
- PROPOSED STREAM CROSSING
- APPROXIMATE LIMITS OF DISTURBANCE

Not To Scale

TOPO SECTION OF WEST UNION 7.5' USGS TOPO QUADRANGLE

03/14/2014

**Professional Energy Consultants**  
A DIVISION OF SMOOTH LAND SURVEYING

SURVEYORS PROJECT MGMT. **SLS** ENGINEERS ENVIRONMENTAL

725 Vicki Mann St. P.O. Box 150 Glenville, WV 26031 (304) 462-6634

66015 Diller Bottom Road Shadyvale, OH 43047 (740) 671-0911

HONESTY. INTEGRITY. QUALITY

DRAWN BY: K.D.W. FILE NO.: 7871 DATE: 12/04/13 CADD FILE: 7871REC514393.dwg