



west virginia department of environmental protection

Office of Oil and Gas
601 57th Street, S.E.
Charleston, WV 25304
(304) 926-0450
fax: (304) 926-0452

Jim Justice, Governor
Austin Caperton, Cabinet Secretary
www.dep.wv.gov

Tuesday, May 16, 2017
NOTICE OF PERMIT CANCELLATION
Horizontal 6A / Horizontal 6A Well - 1

JAY-BEE OIL & GAS, INC. (A)
1720 RT. 22 E

UNION, NJ 070830000

Re: Permit cancellation for ROBERT M. ASH 1HC
47-017-06438-00-00

The FINAL INSPECTION REPORT for the CANCELLED PERMIT, issued for U.S. Well Number 47-017-06438-00-00, has been received by the Office of Oil and Gas. The permit has been cancelled as of 12/26/2013.

If there are any questions, please feel free to contact me at (304) 926- 0450.



James A. Martin
Chief

Operator's Well Number: ROBERT M. ASH 1HC
Farm Name: ASH, ROBERT M.
U.S. WELL NUMBER: 47-017-06438-00-00
Horizontal 6A / Horizontal 6A Well - 1
Date Cancelled: 12/26/2013

Promoting a healthy environment.

05/19/2017

Top Hole 2,379'

Bottom Hole 1,944'

References

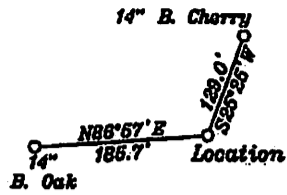

Top Hole	
NAD 27-39.414861 N, 80.676058 W	
UTM NAD83(meters)-4362875.4 N, 527887.6 E	
State Plane NAD 27-335382.0 N, 1668077.9 E	
Landing Point LP-1	
NAD 27-39.414096 N, 80.674692 W	
UTM NAD83(meters)-4362790.7 N, 528027.9 E	
State Plane NAD 27-335102 N, 1668146 E	
Bottom Hole	
NAD 27-39.407032 N, 80.673387 W	
UTM NAD83(meters)-4362007.1 N, 528134.5 E	
State Plane NAD 27-332525 N, 1668453 E	

NUMBER	DIRECTION	DISTANCE
L1	S24°32'E	308'
L2	S64°42'W	466'
L3	S71°14'E	679'

Notes: No water wells were found within 250' of the well location. No dwellings or agricultural buildings were found within 625' of the center of the well pad.

- A- Robert Ash TM 11/9 65.38 ac
- B- Cayton TM 11/8 93.69 ac
- C- Lamp TM 12/10 4.625 ac.
- D- Sisler TM 12/11 28 ac
- E- Lamp TM 11/28.3 3.12 ac.
- F- Lamp TM 11/27 5.46 ac.
- G- Lamp TM 11/28.2 2.6 ac.
- H- Lamp TM 11/28 0.99 ac.
- I- Johnson TM 11/8.2, 37, 28.1
- J- Lamp TM 11/27.1 0.6 ac.
- K- Miller TM 11/3 64.6 ac
- L- Ash & Brown TM 6/13 45.26 ac
- M- Cline TM 12/1.2 30.43 ac
- N- Lamp TM 12/62 4.39 ac
- O- Swiger TM 12/64 1.3 ac.
- P- Ashley Christian Church TM 12/8.1 0.65 ac.

AREA 500' FROM BORE PATH

Notes: All wells within 500' of the horizontal leg are shown on this plat based upon information taken from DEP mapping, well plats, & aerial photos.

Notes: Ties to wells and corners are based on State Plane Grid North-WV North Zone NAD 27.

(+) DENOTES LOCATION OF WELL ON UNITED STATES TOPOGRAPHIC MAPS

FILE NO. _____
 DRAWING NO. 1
 SCALE 1" = 1000'
 MINIMUM DEGREE OF ACCURACY 1 in 200
 PROVEN SOURCE OF ELEVATION GPS
submeter unit

I THE UNDERSIGNED, HEREBY CERTIFY THAT THIS PLAT IS CORRECT TO THE BEST OF MY KNOWLEDGE AND BELIEF AND SHOWS ALL THE INFORMATION REQUIRED BY LAW AND THE RULES ISSUED AND PRESCRIBED BY THE DEPARTMENT OF ENVIRONMENTAL PROTECTION.

(SIGNED) David J. Jackson
 R.P.E. _____ P.L.S. 708

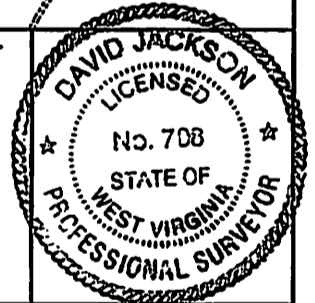

STATE OF WEST VIRGINIA
 Division of Environmental Protection
 OFFICE OF OIL AND GAS

DATE December 19, 2013
 OPERATOR'S WELL NO. Robert M. Ash 1HC
 API WELL NO. _____

WELL TYPE: OIL GAS LIQUID INJECTION WASTE DISPOSAL STATE 017 06438 H6A
 (IF 'GAS') PRODUCTION STORAGE DEEP SHALLOW
 LOCATION: ELEVATION 1075.8' WATER SHED Broad Run
 DISTRICT McClellan COUNTY Doddridge
 QUADRANGLE Center Point 7 1/2'

SURFACE OWNER Robert M. Ash ACREAGE 65.38 ac.
 OIL & GAS ROYALTY OWNER Rosalee Wilson (T.M. 11/9), Jack Lamp (T.M. 12/10, 11, 52 T.M. 11/8.1, 8.2, 8.3, 8.4, 27, 27.1, 28.1, 28.2, 28.3, 28.4, 37)

LEASE NO. RW17, D423B

PROPOSED WORK: DRILL CONVERT DRILL DEEPER REDRILL FRACTURE OR STIMULATE PLUG OFF OLD FORMATION PERFORATE NEW FORMATION OTHER PHYSICAL CHANGE IN WELL (SPECIFY) _____

PLUG AND ABANDON CLEAN OUT AND REPLUG
 TARGET FORMATION Marcellus ESTIMATED DEPTH TMD 10,990' + TVD 9976'

WELL OPERATOR Jay Bee Oil & Gas, Inc. DESIGNATED AGENT Randy Broda
 ADDRESS 1720 Rt. 22, East Union, NJ 07083 ADDRESS Route 1, Box 5, Cairo, WV 26337

05/19/2017