

# LEWIS MAXWELL LEASE

## 2654 ACRES ±

### WELL NO. WV 512482

LATITUDE 39° 15' 00"  
NOTES ON SURVEY

1. TIES TO WELLS, REFERENCES AND CORNERS ARE BASED ON GRID NORTH FOR THE WV STATE PLANE COORDINATE SYSTEM NORTH ZONE NAD'27.
2. LEASE BOUNDARY SHOWN HEREON TAKEN FROM DEED BOOK 28 PAGE 177.
3. SURFACE OWNER AND ADJOINER INFORMATION TAKEN FROM THE ASSESSOR AND COUNTY CLERK RECORDS OF DODDRIDGE COUNTY IN JULY, 2013.
4. WELL LAT./LONG. (NAD'27) ESTABLISHED BY DGPS(SURVEY GRADE).
5. PLAT DATED 03/11/10 REVISED 12/26/12 TO EXTEND HORIZONTAL LEG AND CHANGE BOTTOM HOLE COORDINATES, REVISED 06/06/13 TO SHOW NEW TOP HOLE COORDINATES, REVISED 08/12/13 TO CONFORM TO WV CODE R. 35-8 ETC.

LONGITUDE 80° 47' 30"

**BOTTOM HOLE**  
WELL NO. WV 512482  
STATE PLANE COORDINATES  
(NORTH ZONE) NAD'27

N. 268,620.4  
E. 1,630,973.0

LAT=(N) 39.230175  
LONG=(W) 80.802735

UTM (NAD83)(METERS)  
N. 4,342,347.8  
E. 517,041.0

HAESSLY LAND &  
TIMBER, LLC  
266.38 ACRES±

ZOE K. WALTERS  
261 ACRES±

BOTTOM HOLE  
WELL NO. WV 512482

HAESSLY LAND &  
TIMBER, LLC  
485 ACRES±

017-4265 017-0080

WILLIAM RANDALL  
HAMBLET, ET AL  
442.60 ACRES±  
TM 23-3.1

017-3728

FENCE POST  
FOUND

N 86°37' W  
3218.50'

WELL NO.  
WV 512482

N 45°13' E  
1000.89'

LANDING POINT  
WELL NO. WV 512482  
STATE PLANE COORDINATES  
(NORTH ZONE) NAD'27

N. 266,073.6  
E. 1,632,160.6

LAT=(N) 39.223231  
LONG=(W) 80.798413

UTM (NAD83)(METERS)  
N. 4,341,578.0  
E. 517,415.7

WELL NO. WV 512482  
STATE PLANE COORDINATES  
(NORTH ZONE) NAD'27

N. 265,368.5  
E. 1,631,450.3

LAT=(N) 39.221267  
LONG=(W) 80.800884

UTM (NAD83)(METERS)  
N. 4,341,359.6  
E. 517,202.9

LUCY E. HARPER  
442.60 ACRES±  
TM 23-03

S 06°10' W  
2822.73'

017-2990

017-4046

### REFERENCES

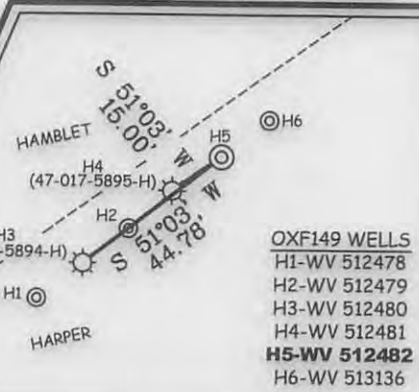

I THE UNDERSIGNED, HEREBY CERTIFY THAT THIS PLAT IS CORRECT TO THE BEST OF MY KNOWLEDGE AND BELIEF AND SHOWS ALL THE INFORMATION REQUIRED BY LAW AND THE REGULATIONS ISSUED AND PRESCRIBED BY THE DIVISION OF ENVIRONMENTAL PROTECTION.

P.S. 677 *Gregory A. Smith*

(+) DENOTES LOCATION OF WELL ON UNITED STATES TOPOGRAPHIC MAPS.  
DATE AUGUST 29, 20 13  
OPERATORS WELL NO. WV 512482  
API WELL NO. 47-017-06391 H6A  
STATE COUNTY PERMIT

MINIMUM DEGREE OF ACCURACY 1/200 FILE NO. 6980P512482R7 (280-67)  
PROVEN SOURCE OF ELEVATION DGPS (SURVEY GRADE TIE TO CORS NETWORK) SCALE 1" = 1,000'

STATE OF WEST VIRGINIA  
DIVISION OF ENVIRONMENTAL PROTECTION  
OFFICE OF OIL AND GAS

WELL TYPE: OIL  GAS  LIQUID INJECTION  WASTE DISPOSAL  IF "GAS" PRODUCTION  STORAGE  DEEP  SHALLOW

LOCATION: ELEVATION 1,240'(GROUND) 1,242.5'(PROPOSED) WATERSHED LEFT FORK

DISTRICT WEST UNION COUNTY DODDRIDGE QUADRANGLE OXFORD 7.5'

SURFACE OWNER LUCY E. HARPER ACREAGE 442.6±

ROYALTY OWNER LEWIS MAXWELL HEIRS LEASE ACREAGE 2,654±

PROPOSED WORK: DRILL  CONVERT  DRILL DEEPER  REDRILL  FRACTURE OR STIMULATE  PLUG OFF OLD

FORMATION  PERFORATE NEW FORMATION  PLUG AND ABANDON  CLEAN OUT AND REPLUG  OTHER

PHYSICAL CHANGE IN WELL (SPECIFY) \_\_\_\_\_ TARGET FORMATION MARCELLUS

ESTIMATED DEPTH \_\_\_\_\_

WELL OPERATOR EQT PRODUCTION COMPANY DESIGNATED AGENT REX C. RAY

ADDRESS 115 PROFESSIONAL PLACE P.O. BOX 280 BRIDGEPORT, WV 26330 ADDRESS 115 PROFESSIONAL PLACE P.O. BOX 280 BRIDGEPORT, WV 26330

01/24/2014



# LEWIS MAXWELL LEASE OXF149 WELLS

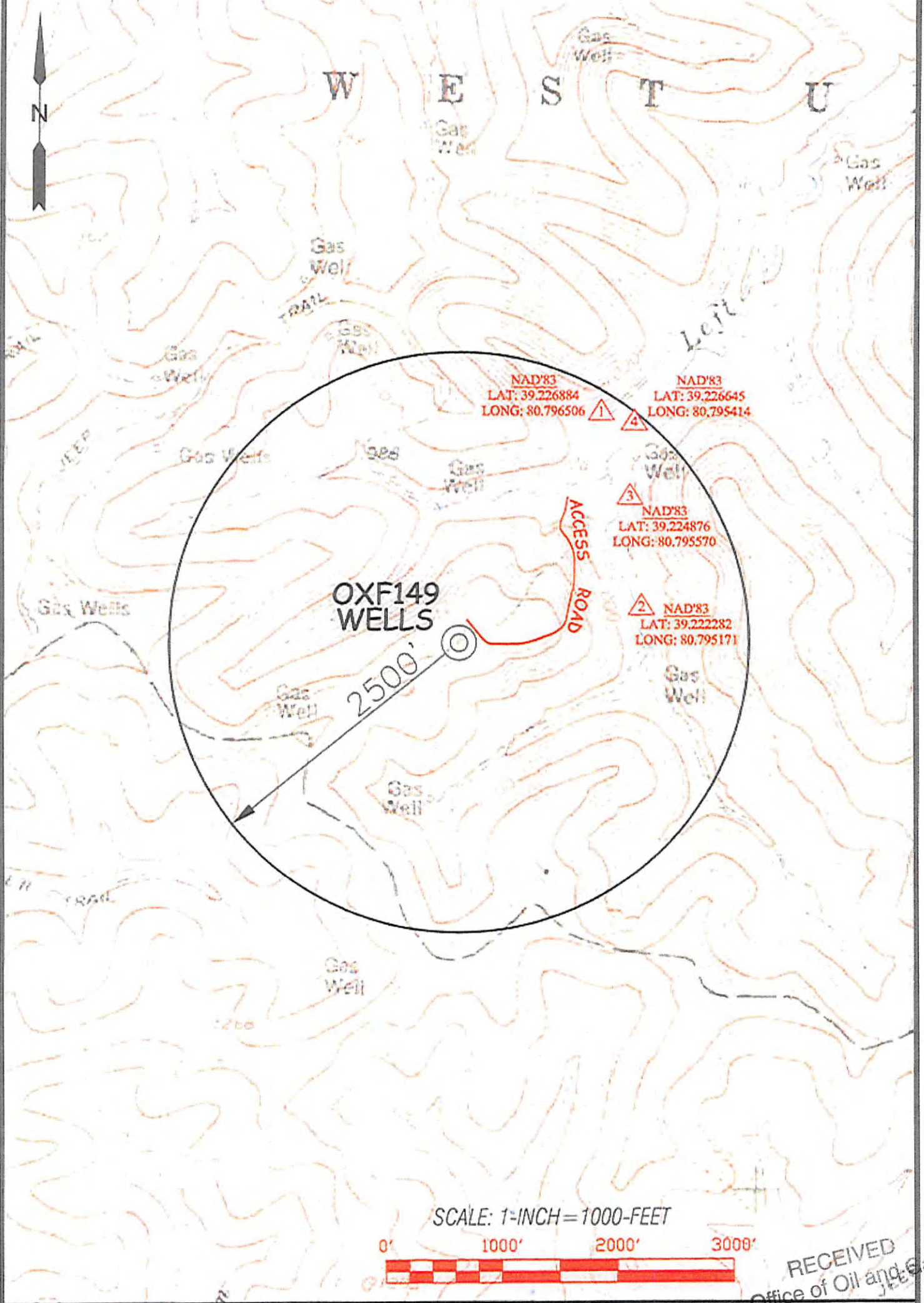

SCALE: 1-INCH=1000-FEET



RECEIVED  
Office of Oil and Gas  
SEP 28 2013  
WV Department of Environmental Protection

		TOPO SECTION OF: OXFORD, WV 7.5' QUAD.		OPERATOR: EQT PRODUCTION COMPANY 115 PROFESSIONAL PLACE P.O. BOX 280 BRIDGEPORT, WV 26330	
DRAWN BY: K.D.W. FILE NO: 6980 DATE: 09/12/13 CADD FILE: 6980WS51247BR2		DISTRICT: WEST UNION COUNTY: DODDRIDGE TAX MAP-PARCEL NO.: 23-3.1			