

LATITUDE 39°15'00"

8,363'

9,564' TO BOTTOM HOLE

LATITUDE 39°17'30"

LONGITUDE 80°50'00"

4,525'

13,219' TO BOTTOM HOLE

LONGITUDE 80°50'00"

Antero Resources Corporation  
Well No. Leggett Unit 2H  
47-017-06293 (AS DRILLED)

AS DRILLED DATA:  
WELL 2H TOP HOLE INFORMATION:  
N: 271,569ft E: 1,613,984ft  
LAT: 39°14'15.28" LON: 80°51'46.29"  
BOTTOM HOLE INFORMATION:  
N: 278,068ft E: 1,612,880ft  
LAT: 39°15'19.34" LON: 80°52'01.58"  
WEST VIRGINIA COORDINATE SYSTEM OF 1927 NORTH ZONE. ZONE WAS DERIVED FROM MEASUREMENTS TAKEN WITH TRIMBLE GEOXT SUBMETER MAPPING GRADE GPS UNIT. PLAT ORIENTATION, CORNER, AND WELL REFERENCE TIE LINES ARE BASED ON GRID NORTH.

(NAD) 83 (UTM) ZONE 17 COORDS:  
WELL 2H TOP HOLE INFORMATION:  
N: 4,343,159m E: 511,850m  
BOTTOM HOLE INFORMATION:  
N: 4,345,134m E: 511,481m

WV NORTH ZONE GRID NORTH

- NOTE
1. NO OCCUPIED DWELLINGS OR BUILDINGS TWO THOUSAND FIVE HUNDRED (2,500) SQUARE FEET OR LARGER USED TO HOUSE OR SHELTER DAIRY CATTLE OR POULTRY HUSBANDRY ARE LOCATED WITHIN SIX HUNDRED TWENTY-FIVE (625) FEET OF THE CENTER OF THE WELL PAD.
  2. TOP HOLE DATA SHOWN HEREON WAS PROVIDED BY ALLEGHENY SURVEYS, INC.
  3. AS DRILLED DATA WAS PROVIDED BY ANTERO RESOURCES CORPORATION.
  4. WLS IS NOT CERTIFYING THE DATA AND INFORMATION PROVIDED LISTED IN NOTES 2 AND 3, ONLY THE RELATIONSHIP TO THE DATA AND INFORMATION PROVIDED TO THE LEASE BOUNDARIES.
  5. WLS IS BY NO MEANS RESPONSIBLE FOR ANY ERRORS OR INACCURACIES WITH THE DATA AND INFORMATION THAT HAS BEEN PROVIDED.

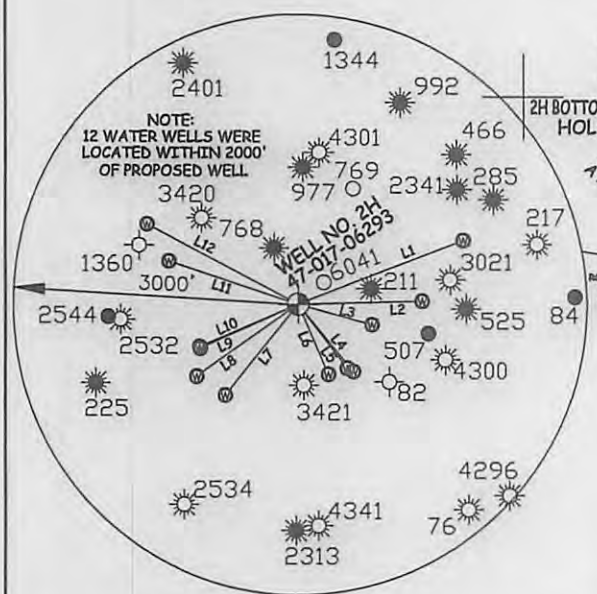

LINE	BEARING	DISTANCE
L1	N 68°34' E	1822.0'
L2	N 88°15' E	1269.1'
L3	S 74°43' E	774.9'
L4	S 38°59' E	882.5'
L5	S 36°54' E	814.8'
L6	S 22°21' E	773.3'
L7	S 39°55' W	1214.3'
L8	S 55°35' W	1306.3'
L9	S 66°35' W	1135.1'
L10	S 67°32' W	1132.2'
L11	N 71°50' W	1437.6'
L12	N 62°30' W	1798.3'

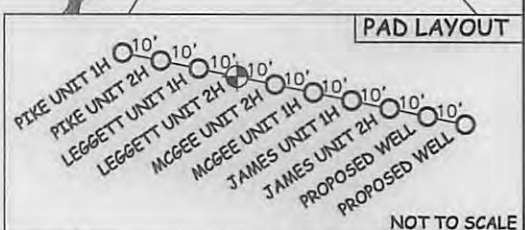

JOB # 12-153WA  
DRAWING # LEGGETT2HAD  
SCALE 1" = 1000'  
MINIMUM DEGREE OF ACCURACY SUBMETER  
PROVEN SOURCE OF ELEV. SUBMETER MAPPING GRADE GPS



STATE OF WEST VIRGINIA, DIVISION OF ENVIRONMENTAL PROTECTION, OFFICE OF OIL AND GAS

WILLOW LAND SURVEYING PLLC  
220 MASONIC AVE. PENNSBORO  
WEST VIRGINIA 26415

LEGEND  
 - - - Surface Owner Boundary Lines +/-  
 - - - Interior Surface Tracts +/-  
 X Existing Fence  
 ⊕ Found monument, as noted  
 ○ Proposed Well Path  
 ⊗ As Drilled Well Path

DATE 05/29/15  
OPERATOR'S WELL# LEGGETT UNIT #2H  
API WELL # 47 - 017 - 06293  
STATE COUNTY PERMIT

STATE OF WEST VIRGINIA DEPARTMENT OF ENERGY DIVISION OF OIL AND GAS  
WELL TYPE: OIL GAS  LIQUID INJECTION WASTE DISPOSAL  
(IF "GAS") PRODUCTION  STORAGE DEEP SHALLOW   
LOCATION: ELEVATION 1,000' ORIGINAL - 990' AS DRILLED WATERSHED NORTH FORK HUGHES RIVER  
QUADRANGLE OXFORD 7.5' (TOP HOLE) WEST UNION 7.5' (BOTTOM HOLE) DISTRICT CENTRAL COUNTY DODDRIDGE  
SURFACE OWNER ROBERT WILLIAMS ACREAGE 37.67 ACRES +/-  
OIL & GAS ROYALTY OWNER H.B. WILLIAMS ET UX; RALPH LEGGETT ET UX; GUSSIE LEGGETT; W.S. CALHOUN; EVELYN M. FOSTER; F.H. ROSS ET UX; W. HENRY & CALLIE DOTSON ET AL; CASSIE REESE  
LEASE ACREAGE 307 ACRES±; 72 ACRES±; 78 ACRES±; 63 ACRES±; 10.7 ACRES±; 72 ACRES±; 50.25 ACRES±; 142 ACRES±  
PROPOSED WORK: DRILL CONVERT DRILL DEEPER REDRILL FRACTURE OR STIMULATE  
PLUG OFF OLD FORMATION PERFORATE NEW FORMATION OTHER PHYSICAL CHANGE IN WELL (SPECIFY)  AS DRILLED PLUG & ABANDON CLEAN OUT & REPLUG  
TARGET FORMATION MARCELLUS ESTIMATED DEPTH 6,522' TVD 13,103' MD  
WELL OPERATOR ANTERO RESOURCES CORP. DESIGNATED AGENT DIANNA STAMPER  
ADDRESS 1615 WYNKOOP STREET ADDRESS CT CORPORATION SYSTEM  
FORM WW-6 DENVER, CO 80202 ADDRESS 5400 D BIG TYLER ROAD CHARLESTON, WV 25313

08/14/2015

COUNTY NAME PERMIT