

State of West Virginia
Department of Environmental Protection - Office of Oil and Gas
Well Operator's Report of Well Work

API 47 - 017 - 06293 County Doddridge District Central
Quad Oxford 7.5' Pad Name Robert Williams Pad Field/Pool Name ----
Farm name Williams, Robert Well Number Leggett Unit 2H
Operator (as registered with the OOG) Antero Resources Corporation
Address 1615 Wynkoop St. City Denver State CO Zip 80202

As Drilled location NAD 83/UTM Attach an as-drilled plat, profile view, and deviation survey
Top hole Northing 4343159m Easting 511850m
Landing Point of Curve Northing 4343513.30m Easting 512278.16m
Bottom Hole Northing 4345134m Easting 511481m

Elevation (ft) 990' GL Type of Well New Existing Type of Report Interim Final
Permit Type Deviated Horizontal Horizontal 6A Vertical Depth Type Deep Shallow
Type of Operation Convert Deepen Drill Plug Back Redrilling Rework Stimulate
Well Type Brine Disposal CBM Gas Oil Secondary Recovery Solution Mining Storage Other _____
Type of Completion Single Multiple Fluids Produced Brine Gas NGL Oil Other _____
Drilled with Cable Rotary

Drilling Media Surface hole Air Mud Fresh Water Intermediate hole Air Mud Fresh Water Brine
Production hole Air Mud Fresh Water Brine
Mud Type(s) and Additive(s)
Air- Foam & 4% KCL
Mud- Polymer

Date permit issued 8/21/2013 Date drilling commenced 12/18/2013 Date drilling ceased 6/23/2014
Date completion activities began 8/30/2014 Date completion activities ceased 11/12/2014
Verbal plugging (Y/N) N/A Date permission granted N/A Granted by N/A

Please note: Operator is required to submit a plugging application within 5 days of verbal permission to plug

Freshwater depth(s) ft 57' Open mine(s) (Y/N) depths No
Salt water depth(s) ft 1507' Void(s) encountered (Y/N) depths No
Coal depth(s) ft None Identified Cavern(s) encountered (Y/N) depths No
Is coal being mined in area (Y/N) No

RECEIVED
Office of Oil and Gas
JUL 13 2015
Reviewed by:
JLC 7/24/15
08/14/2015
WV Department of
Environmental Protection

API 47-017 - 06293 Farm name Williams, Robert Well number Leggett Unit 2H

CASING STRINGS	Hole Size	Casing Size	Depth	New or Used	Grade wt/ft	Basket Depth(s)	Did cement circulate (Y/N) * Provide details below*
Conductor	30"	20"	40'	New	94# H-40	N/A	Y
Surface	17- 1/2"	13- 3/8"	361'	New	48# H-40	N/A	Y
Coal							
Intermediate 1	12-1/4"	9-5/8"	2500'	New	36# J-55	N/A	Y
Intermediate 2							
Intermediate 3							
Production	8-3/4" & 8-1/2"	5-1/2"	13103'	New	20# P-110	N/A	Y
Tubing		2-3/8"	7008'		5.95# N-80	N/A	
Packer type and depth set		N/A					

Comment Details Cement 20" conductor with 150 sacks of Class A cement. Grout conductor with 50 sacks of Class A cement.

CEMENT DATA	Class/Type of Cement	Number of Sacks	Slurry wt (ppg)	Yield (ft ³ /sks)	Volume (ft ³)	Cement Top (MD)	WOC (hrs)
Conductor	Class A	200 sx*	15.6	1.18	38	0'	8 Hrs.
Surface	Class A	448 sx	15.6	1.18	251	0'	8 Hrs.
Coal							
Intermediate 1	Class A	922 sx	15.6	1.18	783	0'	8 Hrs.
Intermediate 2							
Intermediate 3							
Production	Class H	904 sx (Lead) 1051 sx (Tail)	13.5 Lead 15.2 Tail	1.44 Lead 1.8 Tail	2544	-500' into Intermediate Casing	8 Hrs.
Tubing							

Drillers TD (ft) 13103' MD, 6522' TVD (BHL); 6544' TVD (Deepest point drilled) Loggers TD (ft) 13057'
 Deepest formation penetrated Marcellus Plug back to (ft) N/A
 Plug back procedure N/A

Kick off depth (ft) 6275'

Check all wireline logs run caliper density deviated/directional induction neutron resistivity gamma ray temperature sonic

Well cored Yes No Conventional Sidewall Were cuttings collected Yes No

DESCRIBE THE CENTRALIZER PLACEMENT USED FOR EACH CASING STRING _____

Conductor- 0
 Surface- 1 above guide shoe, 1 above insert float, 1 every 4th joint to surface
 Intermediate- 1 above float joint, 1 above float collar, 1 every 4th joint to surface
 Production- 1 above float joint, 1 below float collar, 1 every 3rd joint to top of cement

WAS WELL COMPLETED AS SHOT HOLE Yes No DETAILS _____

WAS WELL COMPLETED OPEN HOLE? Yes No DETAILS Office of Oil and Gas

WERE TRACERS USED Yes No TYPE OF TRACER(S) USED JUL 13 2015

API 47- 017 - 06293 Farm name Williams, Robert Well number Leggett Unit 2H

PRODUCING FORMATION(S)	DEPTHS	
Marcellus	6489' (TOP) TVD	6971' (TOP) MD

Please insert additional pages as applicable.

GAS TEST Build up Drawdown Open Flow OIL TEST Flow Pump
 SHUT-IN PRESSURE Surface 3600 psi Bottom Hole --- psi DURATION OF TEST --- hrs
 OPEN FLOW Gas 8769 mcfpd Oil 36 bpd NGL --- bpd Water 332 bpd GAS MEASURED BY Estimated Orifice Pilot

LITHOLOGY/ FORMATION	TOP DEPTH IN FT NAME TVD	BOTTOM DEPTH IN FT TVD	TOP DEPTH IN FT MD	BOTTOM DEPTH IN FT MD	DESCRIBE ROCK TYPE AND RECORD QUANTITY AND TYPE OF FLUID (FRESHWATER, BRINE, OIL, GAS, H ₂ S, ETC)
	0		0		
*PLEASE SEE ATTACHED EXHIBIT 3					

Please insert additional pages as applicable.

Drilling Contractor Precision Drilling Company, LP
 Address 2640 Reach Rd. City Williamsport State PA Zip 15301
 Logging Company STRC
 Address 1560 Good Hope Pike City Clarksburg State WV Zip 26301
 Cementing Company Allied Oil & Gas Services, LLC
 Address 1036 East Main Street City Bridgeport State WV Zip 26330
 Stimulating Company US Well Services
 Address 533 Industrial Park Dr. City Jane Lew State WV Zip 26378

Please insert additional pages as applicable.

Completed by Kara Quackenbush Telephone 303-357-7233
 Signature [Signature] Title Permit Representative Date Jul 14 2015

RECEIVED
Office of Oil and Gas

EXHIBIT 1

Stage No.	Perforation Date	Perforated from MD ft.	Perforated to MD ft.	Number of Perforations	Formations
1	30-Aug-14	12,864	13,034	60	Marcellus
2	8-Sep-14	12,662	12,832	60	Marcellus
3	8-Sep-14	12,461	12,631	60	Marcellus
4	8-Sep-14	12,259	12,429	60	Marcellus
5	8-Sep-14	12,057	12,227	60	Marcellus
6	9-Sep-14	11,856	12,026	60	Marcellus
7	9-Sep-14	11,654	11,824	60	Marcellus
8	9-Sep-14	11,452	11,622	60	Marcellus
9	10-Sep-14	11,250	11,420	60	Marcellus
10	11-Sep-14	11,049	11,219	60	Marcellus
11	11-Sep-14	10,847	11,017	60	Marcellus
12	11-Sep-14	10,645	10,815	60	Marcellus
13	11-Sep-14	10,443	10,614	60	Marcellus
14	12-Sep-14	10,242	10,412	60	Marcellus
15	12-Sep-14	10,040	10,210	60	Marcellus
16	12-Sep-14	9,838	10,008	60	Marcellus
17	12-Sep-14	9,637	9,807	60	Marcellus
18	12-Sep-14	9,435	9,605	60	Marcellus
19	13-Sep-14	9,233	9,403	60	Marcellus
20	13-Sep-14	9,031	9,202	60	Marcellus
21	16-Sep-14	8,830	9,000	60	Marcellus
22	16-Sep-14	8,628	8,798	60	Marcellus
23	17-Sep-14	9,426	8,596	60	Marcellus
24	17-Sep-14	8,225	8,395	60	Marcellus
25	17-Sep-14	8,023	8,193	60	Marcellus
26	17-Sep-14	7,821	7,991	60	Marcellus
27	17-Sep-14	7,619	7,789	60	Marcellus
28	18-Sep-14	7,418	7,588	60	Marcellus
29	18-Sep-14	7,216	7,386	60	Marcellus
30	18-Sep-14	7,014	7,184	60	Marcellus

RECEIVED
Office of Oil and Gas

JUL 13 2015

WV Department of
Environmental Protection 08/14/2015

EXHIBIT 2

Stage No.	Stimulations Date	Avg Pump Rate	Avg Treatment Pressure (PSI)	Max Breakdown Pressure (PSI)	ISIP (PSI)	Amount of Proppant (lbs)	Amount of Water (bbls)	Amount of Nitrogen/ other (units)
1	7-Sep-14	58.4	7,899	6,225	5,325	102,850	6,958	N/A
2	8-Sep-14	69.0	7,365	6,023	5,147	103,050	7,180	N/A
3	8-Sep-14	27.0	8,734	6,588	5,486	1,500	6,939	N/A
4	8-Sep-14	69.2	7,433	6,402	4,277	173,650	7,502	N/A
5	9-Sep-14	71.4	7,421	6,262	4,313	251,550	6,899	N/A
6	9-Sep-14	77.0	7,504	6,291	5,475	254,500	6,872	N/A
7	9-Sep-14	72.9	7,531	5,747	5,203	164,050	7,425	N/A
8	10-Sep-14	67.2	7,829	5,704	4,628	152,500	6,863	N/A
9	11-Sep-14	68.3	7,640	5,858	5,200	185,450	7,370	N/A
10	11-Sep-14	77.0	7,795	5,622	4,900	178,500	6,489	N/A
11	11-Sep-14	66.0	6,861	5,783	5,325	252,700	6,664	N/A
12	11-Sep-14	65.2	6,834	5,440	5,146	194,200	5,685	N/A
13	12-Sep-14	63.7	7,626	5,940	4,009	162,500	6,365	N/A
14	12-Sep-14	66.0	6,767	5,944	5,411	207,500	5,772	N/A
15	12-Sep-14	66.0	6,839	6,169	4,896	207,400	5,772	N/A
16	12-Sep-14	66.5	6,658	6,112	4,900	204,100	5,696	N/A
17	12-Sep-14	65.2	6,521	6,079	5,475	204,550	5,701	N/A
18	13-Sep-14	65.0	6,469	6,183	5,758	199,500	5,721	N/A
19	13-Sep-14	65.0	6,289	6,037	5,318	207,200	5,653	N/A
20	16-Sep-14	64.0	6,454	6,548	4,714	207,200	5,651	N/A
21	16-Sep-14	67.2	6,361	5,887	4,349	207,750	5,618	N/A
22	16-Sep-14	66.8	6,430	5,958	4,728	206,300	5,598	N/A
23	17-Sep-14	67.0	6,546	6,316	4,656	207,000	5,566	N/A
24	17-Sep-14	66.0	6,422	5,997	5,221	207,000	5,544	N/A
25	17-Sep-14	67.0	6,475	5,865	6,284	210,200	5,552	N/A
26	17-Sep-14	67.1	6,296	5,908	4,789	206,800	5,501	N/A
27	18-Sep-14	69.8	6,516	6,162	4,510	192,200	5,277	N/A
28	18-Sep-14	65.0	6,239	5,515	5,150	207,000	5,460	N/A
29	18-Sep-14	64.0	6,645	7,271	5,229	192,500	5,242	N/A
30	18-Sep-14	65.0	5,994	5,697	4,449	207,000	5,414	N/A
AVG=		65.8	6,946	6,051	5,009	5,658,200	183,949	TOTAL

RECEIVED
Office of Oil and Gas

JUL 13 2015

WV Department of
Environmental Protection 08/14/2015

EXHIBIT 3

LITHOLOGY/ FORMATION	TOP DEPTH (TVD) From Surface	BOTTOM DEPTH (TVD) From Surface	TOP DEPTH (MD) From Surface	BOTTOM DEPTH (MD) From Surface
Fresh Water	57'	N/A	57'	N/A
Shale/ Sandstone	0	427	0	427
Limestone/ Sandstone	est. 427	507	est. 427	507
Shale/ Siltstone	est. 507	587	est. 507	587
Sandstone/ Trace Coal	est. 587	607	est. 587	607
Sandstone/ Siltstone	est. 607	687	est. 607	687
Sandstone/ Limestone	est. 687	787	est. 687	787
Shale/ Sandstone	est. 787	947	est. 787	947
Siltstone/ Limestone	est. 947	1327	est. 947	1327
Shale/ Trace Coal	est. 1327	1387	est. 1327	1387
Shale/ Sandstone	est. 1387	1427	est. 1387	1427
Shale/ Coal	est. 1427	1487	est. 1427	1487
Sandstone	est. 1487	1527	est. 1487	1527
Sandstone/ Trace Coal	est. 1527	1667	est. 1527	1667
Sandstone/ Siltstone	est. 1667	1907	est. 1667	1907
Sandstone/ Trace Coal	est. 1907	1988	est. 1907	1988
Big Lime	1988	2079	1988	2079
Big Injun	2079	2393	2079	2393
Gantz Sand	2393	2633	2393	2633
Fifty Foot Sandstone	2633	2680	2633	2680
Gordon	2680	3000	2680	3006
Fifth Sandstone	3000	3019	3006	3026
Bayard	3019	3416	3026	3450
Warren	3416	3778	3450	3851
Speechley	3778	4078	3851	4185
Baltown	4078	4539	4185	4697
Bradford	4539	4957	4697	5165
Benson	4957	5199	5165	5440
Alexander	5199	5367	5440	5623
Elk	5367	5847	5623	6151
Rhinestreet	5847	6144	6151	5587
Sycamore	6144	6313	5587	6688
Middlesex	6313	6433	6688	6860
Burkett	6433	6460	6860	6908
Tully	6460	6489	6908	6971
Marcellus	6489	NA	6971	NA

*Please note Antero determines formation tops based on mud logs that are only run on one well on a multi-well pad. The measured depth (MD) data on subsequent wells may be slightly different due to the well's unique departure.

RECEIVED
Office of Oil and Gas

JUL 13 2015

WV Department of
Environmental Protection

08/14/2015

Hydraulic Fracturing Fluid Product Component Information Disclosure

Job Start Date:	9/7/2014
Job End Date:	9/18/2014
State:	West Virginia
County:	Doddridge
API Number:	47-017-06293-00-00
Operator Name:	Antero Resources Corporation
Well Name and Number:	Leggett Unit 2H
Longitude:	-80.86269200
Latitude:	39.23765600
Datum:	NAD83
Federal/Tribal Well:	NO
True Vertical Depth:	6,544
Total Base Water Volume (gal):	7,725,858
Total Base Non Water Volume:	393,958



Hydraulic Fracturing Fluid Composition:

Trade Name	Supplier	Purpose	Ingredients	Chemical Abstract Service Number (CAS #)	Maximum Ingredient Concentration in Additive (% by mass)**	Maximum Ingredient Concentration in HF Fluid (% by mass)**	Comments
Water	Antero Resources	Base Fluid	Water	7732-18-5	100.00000	91.52630	
Sand	U.S. Well Services, LLC	Proppant	Crystalline Silica, quartz	14808-60-7	100.00000	8.03732	
Guar	U.S. Well Services, LLC	Gelling Agents	Guar Gum	9000-30-0	50.00000	0.09068	
Petroleum Distillates	U.S. Well Services, LLC		Petroleum Distillates	64742-47-8	60.00000	0.08588	
Suspending agent (solid)	U.S. Well Services, LLC		Suspending agent (solid)	14808-60-7	3.00000	0.01387	
Surfactant	U.S. Well Services, LLC		Surfactant	68439-51-0	3.00000	0.00544	
Bulk Acid	U.S. Well Services, LLC		Water	7732-18-5	87.50000	0.10097	
Friction Reducer	U.S. Well Services, LLC		Hydrogen Chloride	7647-01-0	18.00000	0.02412	
Antionic Polyacrylamide	U.S. Well Services, LLC		Antionic Polyacrylamide	Proprietary		0.03074	
Water	U.S. Well Services, LLC		Water	7732-18-5	40.00000	0.03074	
Petroleum Distillates	U.S. Well Services, LLC		Petroleum Distillates	64742-47-8	22.00000	0.02474	
Crystalline Salt	U.S. Well Services, LLC		Crystalline Salt	12125-02-9	5.00000	0.00384	

SI-1000	J.S. Well Services, LLC	Scale Inhibitor	Ethoxylated alcohol blend	Proprietary	5.00000	0.00384
			Anionic Copolymer	Proprietary		0.00412
			Ethylene Glycol	107-21-1	20.00000	0.00372
			Water	7732-18-5	30.00000	0.00311
K-BAC 1020	J.S. Well Services, LLC	Anti-Bacterial Agent				
			2,2-dibromo-3-nitropropionamide	10222-01-2	20.00000	0.00487
			Deionized Water	7732-18-5	28.00000	0.00278
AP One	J.S. Well Services, LLC	Gel Breakers				
			Ammonium Persulfate	7727-54-0	100.00000	0.00232
AI-300	J.S. Well Services, LLC	Acid Corrosion Inhibitors				
			Ethylene Glycol	107-21-1	31.00000	0.00026
			N,N-Dimethylformamide	68-12-2	15.00000	0.00008
			Cinnamaldehyde	104-55-2	5.00000	0.00007
			Tar bases, quinoline derivs, benzyl chloride-quaternized	72480-70-7	13.00000	0.00007
			2-Butoxyethanol	111-76-2	7.00000	0.00006
			Water	7732-18-5	20.00000	0.00002
			Ethoxylated Nonylphenol	68412-54-4	5.00000	0.00002
			Triethyl Phosphate	78-40-0	3.00000	0.00001
			Isopropyl Alcohol	67-63-0	3.00000	0.00001

Ingredients shown above are subject to 29 CFR 1910.1200(i) and appear on Material Safety Data Sheets (MSDS). Ingredients shown below are Non-MSDS.

* Total Water Volume sources may include fresh water, produced water, and/or recycled water

** Information is based on the maximum potential for concentration and thus the total may be over 100%

Note: For Field Development Products (products that begin with FDP), MSDS level only information has been provided. Ingredient information for chemicals subject to 29 CFR 1910.1200(i) and Appendix D are obtained from suppliers Material Safety Data Sheets (MSDS)

RECEIVED
Office of Oil and Gas
JUL 13 2015
WV Department of
Environmental Protection
08/14/2015

LATITUDE 39°15'00"

8,363'

9,564' TO BOTTOM HOLE

LATITUDE 39°17'30"

LONGITUDE 80°50'00"

4,525'

13,219' TO BOTTOM HOLE

LONGITUDE 80°50'00"

Antero Resources Corporation
Well No. Leggett Unit 2H
47-017-06293 (AS DRILLED)

AS DRILLED DATA:
WELL 2H TOP HOLE INFORMATION:
N: 271,569ft E: 1,613,984ft
LAT: 39°14'15.28" LON: 80°51'46.29"
BOTTOM HOLE INFORMATION:
N: 278,068ft E: 1,612,880ft
LAT: 39°15'19.34" LON: 80°52'01.58"
WEST VIRGINIA COORDINATE SYSTEM OF 1927 NORTH ZONE. ZONE WAS DERIVED FROM MEASUREMENTS TAKEN WITH TRIMBLE GEOXT SUBMETER MAPPING GRADE GPS UNIT. PLAT ORIENTATION, CORNER, AND WELL REFERENCE TIE LINES ARE BASED ON GRID NORTH.

(NAD) 83 (UTM) ZONE 17 COORDS:
WELL 2H TOP HOLE INFORMATION:
N: 4,343,159m E: 511,850m
BOTTOM HOLE INFORMATION:
N: 4,345,134m E: 511,481m

WV NORTH ZONE GRID NORTH

- NOTE
1. NO OCCUPIED DWELLINGS OR BUILDINGS TWO THOUSAND FIVE HUNDRED (2,500) SQUARE FEET OR LARGER USED TO HOUSE OR SHELTER DAIRY CATTLE OR POULTRY HUSBANDRY ARE LOCATED WITHIN SIX HUNDRED TWENTY-FIVE (625) FEET OF THE CENTER OF THE WELL PAD.
 2. TOP HOLE DATA SHOWN HEREON WAS PROVIDED BY ALLEGHENY SURVEYS, INC.
 3. AS DRILLED DATA WAS PROVIDED BY ANTERO RESOURCES CORPORATION.
 4. WLS IS NOT CERTIFYING THE DATA AND INFORMATION PROVIDED LISTED IN NOTES 2 AND 3, ONLY THE RELATIONSHIP TO THE DATA AND INFORMATION PROVIDED TO THE LEASE BOUNDARIES.
 5. WLS IS BY NO MEANS RESPONSIBLE FOR ANY ERRORS OR INACCURACIES WITH THE DATA AND INFORMATION THAT HAS BEEN PROVIDED.

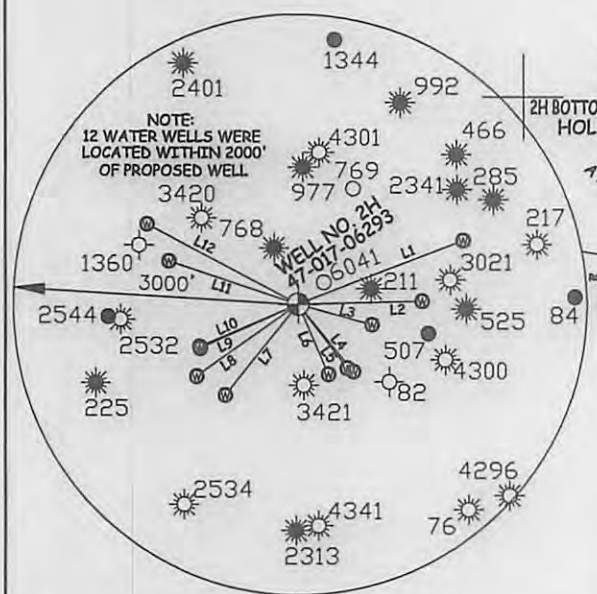

LINE	BEARING	DISTANCE
L1	N 68°34' E	1822.0'
L2	N 88°15' E	1269.1'
L3	S 74°43' E	774.9'
L4	S 38°59' E	882.5'
L5	S 36°54' E	814.8'
L6	S 22°21' E	773.3'
L7	S 39°55' W	1214.3'
L8	S 55°35' W	1306.3'
L9	S 66°35' W	1135.1'
L10	S 67°32' W	1132.2'
L11	N 71°50' W	1437.6'
L12	N 62°30' W	1798.3'

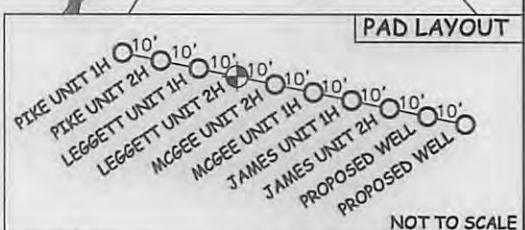

JOB # 12-153WA
DRAWING # LEGGETT2HAD
SCALE 1" = 1000'
MINIMUM DEGREE OF ACCURACY SUBMETER
PROVEN SOURCE OF ELEV. SUBMETER MAPPING GRADE GPS



STATE OF WEST VIRGINIA, DIVISION OF ENVIRONMENTAL PROTECTION, OFFICE OF OIL AND GAS

WILLOW LAND SURVEYING PLLC
220 MASONIC AVE. PENNSBORO
WEST VIRGINIA 26415

LEGEND
 - - - Surface Owner Boundary Lines +/-
 - - - Interior Surface Tracts +/-
 X Existing Fence
 ⊕ Found monument, as noted
 ○ Proposed Well Path
 ⊗ As Drilled Well Path

DATE 05/29/15
OPERATOR'S WELL# LEGGETT UNIT #2H
API WELL # 47 - 017 - 06293
STATE COUNTY PERMIT

STATE OF WEST VIRGINIA DEPARTMENT OF ENERGY DIVISION OF OIL AND GAS
WELL TYPE: OIL GAS LIQUID INJECTION WASTE DISPOSAL
(IF "GAS") PRODUCTION STORAGE DEEP SHALLOW
LOCATION: ELEVATION 1,000' ORIGINAL - 990' AS DRILLED WATERSHED NORTH FORK HUGHES RIVER
QUADRANGLE OXFORD 7.5' (TOP HOLE) WEST UNION 7.5' (BOTTOM HOLE) DISTRICT CENTRAL COUNTY DODDRIDGE
SURFACE OWNER ROBERT WILLIAMS ACREAGE 37.67 ACRES +/-
OIL & GAS ROYALTY OWNER H.B. WILLIAMS ET UX; RALPH LEGGETT ET UX; GUSSIE LEGGETT; W.S. CALHOUN; EVELYN M. FOSTER; F.H. ROSS ET UX; W. HENRY & CALLIE DOTSON ET AL; CASSIE REESE
LEASE ACREAGE 307 ACRES±; 72 ACRES±; 78 ACRES±; 63 ACRES±; 10.7 ACRES±; 72 ACRES±; 50.25 ACRES±; 142 ACRES±
PROPOSED WORK: DRILL CONVERT DRILL DEEPER REDRILL FRACTURE OR STIMULATE
PLUG OFF OLD FORMATION PERFORATE NEW FORMATION OTHER PHYSICAL CHANGE IN WELL (SPECIFY) AS DRILLED PLUG & ABANDON CLEAN OUT & REPLUG
TARGET FORMATION MARCELLUS ESTIMATED DEPTH 6,522' TVD 13,103' MD
WELL OPERATOR ANTERO RESOURCES CORP. DESIGNATED AGENT DIANNA STAMPER
ADDRESS 1615 WYNKOOP STREET ADDRESS CT CORPORATION SYSTEM
FORM WW-6 DENVER, CO 80202 ADDRESS 5400 D BIG TYLER ROAD CHARLESTON, WV 25313

08/14/2015

COUNTY NAME PERMIT