

Note: It appears 0 water wells were found within 2000' of proposed well. No occupied dwellings or buildings 2,500 square feet or larger used to house or shelter dairy cattle or poultry husbandry are located within 625' of the center of the well pad.

9 Gas Wells. See Wellhead Detail
 Drilled Well No. Swiger Unit 2H
 3000'
 47-017-5033
 47-017-3134
 47-017-2716 (Plugged)
 47-017-3130 (Abandoned)
 47-017-3112 (Plugged)
 47-017-2716 (Plugged)
 Scale: 1" = 2000'

TM/Par	Owner	Bk / Pg	Acres
1 20/23	Odbert J. Herrod, Jr. & Betty M. Herrod	217 / 562	100.00
2 20/22	Shawn E. & David B. Smith	262 / 684	37.59
3 18/17.1	Edward L. & Connie Lee Cumpston	281 / 355	29.41
4 20/5	Clifford Devericks	241 / 614	12.00
5 20/8	James Devericks, et al	131 / 11	31.10
6 20/7	Mary Banle Merandi & Paul Lister (Mountain Link Associates)	288 / 131	13.00
7 20/9.2	Mark E. & Tara A. Bee	253 / 149	4.44
8 20/9	Warren & Judy Bee	228 / 360	90.17
9 20/9.3	Mark E. & Tara A. Bee	253 / 146	19.77
10 24/2	Eleanor R. Nicholson	206 / 363	69.82



Notes:
 West Virginia Coordinate System of 1927, North Zone based upon Differential GPS Measurements.
 Well No. Swiger Unit 2H Top Hole coordinates are
 N 252,913.58' Latitude: 39°11'18.79"
 E 1,670,755.86' Longitude: 80°39'41.74"
 Bottom Hole coordinates are
 N 241,165.74' Latitude: 39°09'22.97"
 E 1,672,994.86' Longitude: 80°39'11.39"
UTM Zone 17, NAD 1983
 Top Hole Coordinates Bottom Hole Coordinates
 N: 4,337,765.135 m N: 4,334,197.571 m
 E: 529,240.624 m E: 529,982.418 m
 Plat orientation and corner and well references are based upon the grid north meridian.
 Well location references are based upon the magnetic meridian.

- Legend**
- Proposed gas well
 - Found Monument (as noted)
 - Creek or Drain
 - Existing Road
 - Surface boundary (approx.)
 - Interior surface tracts (approx.)
 - County Routes

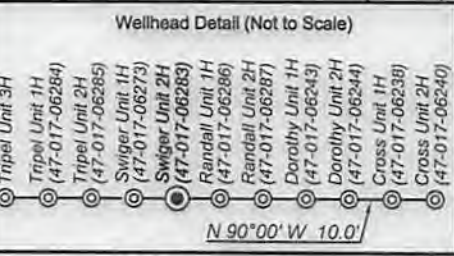

I, the undersigned, hereby certify that this plat is correct to the best of my knowledge and belief and shows all the information required by law and the rules issued and prescribed by the Department of Environmental Protection.

Bradley D. Miller, P.S. 2167

Top Hole coordinates verified by survey grade GPS. As-drilled data and information was provided by Antero Resources Corporation. Allegheeny Surveys, Inc. (ASI) is not certifying the data and information provided. ASI is not responsible for any errors or inaccuracies with the data and information that has been provided

	Bearing	Distance
L1	S 75°24' E	846.4'
L2	S 78°03' W	1619.6'
L3	N 22°15' E	1440.9'
L4	N 40°23' E	443.7'

FILE NO: 78-30-NM-13
 DRAWING NO: 78-13 Swiger 2H As-Drilled
 SCALE: 1" = 1500'
 MINIMUM DEGREE OF ACCURACY: Submeter
 PROVEN SOURCE OF ELEVATION: WVDOT, Bridgeport, WV

STATE OF WEST VIRGINIA
 DEPARTMENT OF ENVIRONMENTAL PROTECTION
OIL AND GAS DIVISION

DATE: July 13 2017
 OPERATOR'S WELL NO. Swiger Unit 2H
 API WELL NO
 47 - 017 - 06283
 STATE COUNTY PERMIT

WELL TYPE: OIL GAS LIQUID INJECTION WASTE DISPOSAL
 (IF GAS) PRODUCTION: STORAGE DEEP SHALLOW

LOCATION: ELEVATION: Existing Grade - 1334' Original Grade - 1361' WATERSHED: Headwaters Middle Island Creek QUADRANGLE: New Milton
 DISTRICT: New Milton Joyce A. Shaw Nazelrod, et al; Chad A. Swiger, et al
 SURFACE OWNER: Randall & Carolyn S. Stewart Haught Family Trust, Ruby Farr Maxwell, et al
 ROYALTY OWNER: Randall P. Stewart, et al; O.J. Herrod, et ux; Everett Nicholson, et ux
 LEASE NO: 21121 ACREAGE: 105.1 115; 51,9414; 384 195; 121; 102; 52.50; 102.19; 69.54

PROPOSED WORK: DRILL CONVERT DRILL DEEPER FRACTURE OR STIMULATE PLUG OFF OLD FORMATION
 PERFORATE NEW FORMATION OTHER PHYSICAL CHANGE IN WELL (SPECIFY) As-Drilled 7.337' TVD
 PLUG AND ABANDON CLEAN OUT AND REPLUG TARGET FORMATION: Marcellus Shale ESTIMATED DEPTH: 19,334' MD

WELL OPERATOR: Antero Resources Corporation DESIGNATED AGENT: Dianna Stamper - CT Corporation System
 ADDRESS: 1615 Wynkoop Street ADDRESS: 5400 D Big Tyler Road
 Denver, CO 80202 Charleston, WV 25313

11/10/2017