

1,555' to Bottom Hole

4,406' to Top Hole
LATITUDE 39 - 15 - 00

LONGITUDE 80 - 35 - 00
1000' to Top Hole

9,966' to Bottom Hole

Antero Resources
Well No. Welling Unit 1H
Antero Resources Corporation

(*) Denotes Location of Well on United States Topographical Maps

Richard E. & Wilma J. Marsden
229/54 386 Ac.

Tangent Point
N: 273,785.29'
E: 1,688,740.51'

White Unit 1H (47-17-6182)
Proposed Welling Unit 1H (47-17-6181)
Welling Unit 2H (47-17-6183)
Golden Unit 1H (47-17-6227)
Golden Unit 2H (47-17-6230)
Perkins Unit 1H (47-17-6229)
Flossie Unit 1H (47-17-6180)
Flossie Unit 2H (47-17-6144)

Top Hole 7.5' Spot

K	Isaac Eddy, et ux Lease L012454 and James Romine Lease DV011162
J	Pauline M. Coltrill & Margaret H. Vincent Lease DAD35254
I	Blaine W. Devericks, et ux, Memorandum of Oil and Gas Lease
H	Timothy J. Goldsmith, et ux, Memorandum of Oil and Gas Lease
G	Glennville State College Foundation Lease
F	Eddy Cemetery Assoc. Public Burying Ground, Memorandum of Oil and Gas Lease
E	Charles W. Wellings Jr., et ux, Memorandum of Oil and Gas Lease
D	Gregory M. Pigg, et ux, Memorandum of Oil and Gas Lease
C	Jason T. Powell Lease TML #1419
B	Richard William Bond II, et ux Lease DAD36472/001
A	Margaret J. & William G. Prickett Lease 22045
Tag	

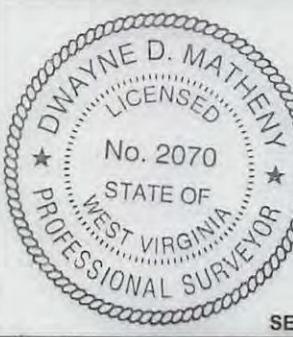

LESSOR			
26	7/7.3	Robert W. & Loretta C. Kelley	253/105 0.72
25	7/14.7	Shawn K. & Penny J. Dahlheimer	249/217 30.38
24	7/12-2	Jeffrey A. & Penelope B. Mills	166/378 1.66
23	7/14.4	Kenneth Kirk (Parcel 2, Tract 3)	267/652 20.02
22	8/34	Gregory M. & Tessa M. Pigg	281/276 0.83
21	8/34.1	D. Duane & Leah L. Perkins	273/298 0.14
20	7/14.5	Melvin W. & Louise Morris	237/172 0.59
19	7/14.4	Phoonsombat Smith	271/219 1.01
18	8/33	D. Duane & Leah Perkins	227/200 1.10
17	7/46	Charles W. Jr. & Barbara L. Wellings	203/229 Lot #7
16	7/30	Robert Marshall & Vernie Mae Hilling	280/347 -
15	7/7.4	Robert W. & Loretta C. Kelley	279/590 0.96
14	7/31	Timothy J. & Julie Goldsmith	273/126 3.76
13	7/14.3	Judy D. Martin (Tract 2)	204/518 1.27
12	7/14.1	Murray Hill Energy Inc.	279/257 20.0
11	4/9.1	James M. & Cathy Sue Clark	179/777 1.50
10	7/7.2	Danny R. Flanagan	WB42/409 0.73
9	7/14.6	Shawn K. & Penny J. Dahlheimer	249/217 1.54
8	7/51	Trustees of the Eddy Cemetery Assoc.	249/650 1.70
7	7/14.8	William & Lanita Stewart	281/311 1.00
6	7/50	Green Meadow Sewage Treat. Plant	220/449 -
5	7/47	Judith K. Mohr & Rocky L. Romanello	254/459 Lot #6
4	7/49	Howard & Muriel Van Buren	191/192 Lot #4
3	7/48	Carrie J. & William J. Curran II	273/399 Lot #5
2	7/7.1	Ronald E. & Julie C. Clevenger	257/249 0.74
1	4/27.3	Ronnie & Betty Perkins	173/259 40.2
Tag	TM/PAR	OWNER	BK / PG AC.

Well Location References



Bearing	Distance
L1 N 50°20' E	1,339.7'
L2 N 44°07' E	617.4'
L3 N 01°51' E	409.3'
L4 N 17°13' W	559.6'
L5 S 14°48' W	238.1'

Notes:
West Virginia Coordinate System of 1927, North Zone based upon Differential GPS Measurements.
Well No. Welling Unit 1H Top Hole coordinates are
N: 274,015.49' Latitude: 39°14'49.59"
E: 1,688,801.33' Longitude: 80°35'55.84"
Bottom Hole coordinates are
N: 265,049.11' Latitude: 39°13'21.32"
E: 1,691,652.30' Longitude: 80°35'18.23"
UTM Zone 17, NAD 1983
Top Hole Coordinates Bottom Hole Coordinates
N: 4,344,285.563m N: 4,341,568.439m
E: 534,631.035m E: 535,545.146m
Plat orientation and corner and well references are based upon the grid north meridian.
Well location references are based upon the magnetic meridian.

Legend

- Proposed gas well
- Found Monument (as noted)
- Creek or Drain
- Existing Road
- Surface boundary (approx.)
- Interior surface tracts (approx.)

I, the undersigned, hereby certify that this plat is correct to the best of my knowledge and belief and shows all the information required by law and the rules issued and prescribed by the Department of Environmental Protection.

Dwayne D. Matheny
Dwayne D. Matheny, P.S. 2070

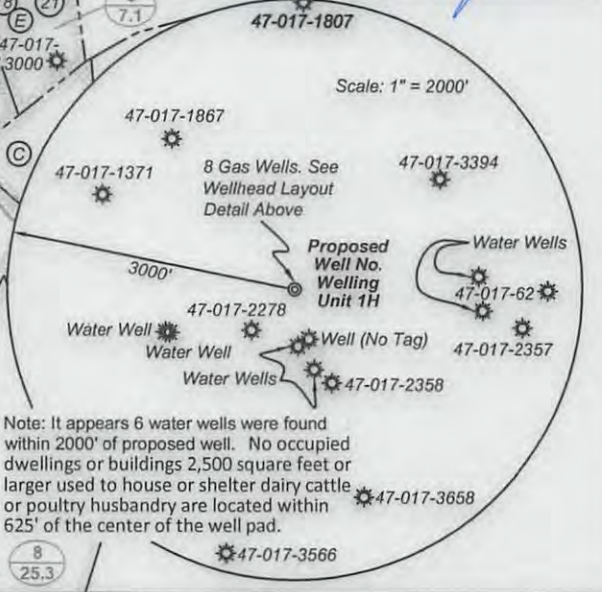

FILE NO: 235-30-G-12
DRAWING NO: 235-12 Welling 1H Well
SCALE: 1" = 1200'
MINIMUM DEGREE OF ACCURACY: Submeter
PROVEN SOURCE OF ELEVATION: WV DOT, Bridgeport, WV

STATE OF WEST VIRGINIA
DEPARTMENT OF ENVIRONMENTAL PROTECTION
OIL AND GAS DIVISION

DATE: October 17 2013
OPERATOR'S WELL NO. Welling Unit 1H
API WELL NO MOD
47 - 017 - 06181
STATE COUNTY PERMIT

WELL TYPE: OIL GAS LIQUID INJECTION WASTE DISPOSAL
(IF GAS) PRODUCTION: STORAGE DEEP SHALLOW
LOCATION: ELEVATION: 971'
DISTRICT: Greenbrier Richard E. & Wilma J. Marsden
SURFACE OWNER: Wilma J. Marsden
ROYALTY OWNER: M.T. Williams, et al; Okey Clark, et ux; Margaret J. & William G. Prickett
PROPOSED WORK: DRILL CONVERT DRILL DEEPER FRACTURE OR STIMULATE PLUG OFF OLD FORMATION
 PERFORATE NEW FORMATION OTHER PHYSICAL CHANGE IN WELL (SPECIFY) Modification - BHL
 PLUG AND ABANDON CLEAN OUT AND REPLUG TARGET FORMATION: Marcellus Shale ESTIMATED DEPTH: 7,300' TVD 17,400' MD

WELL OPERATOR: Antero Resources Corporation DESIGNATED AGENT: Dianna Stamper - CT Corporation System
ADDRESS: 1625 17th Street ADDRESS: 5400 D Big Tyler Road
Denver, CO 80202 Charleston, WV 25313

02/21/2014

EXHIBIT 2, TOPOGRAPHICAL MAP OF WELL SITE LOCATION (MARSDEN PAD)

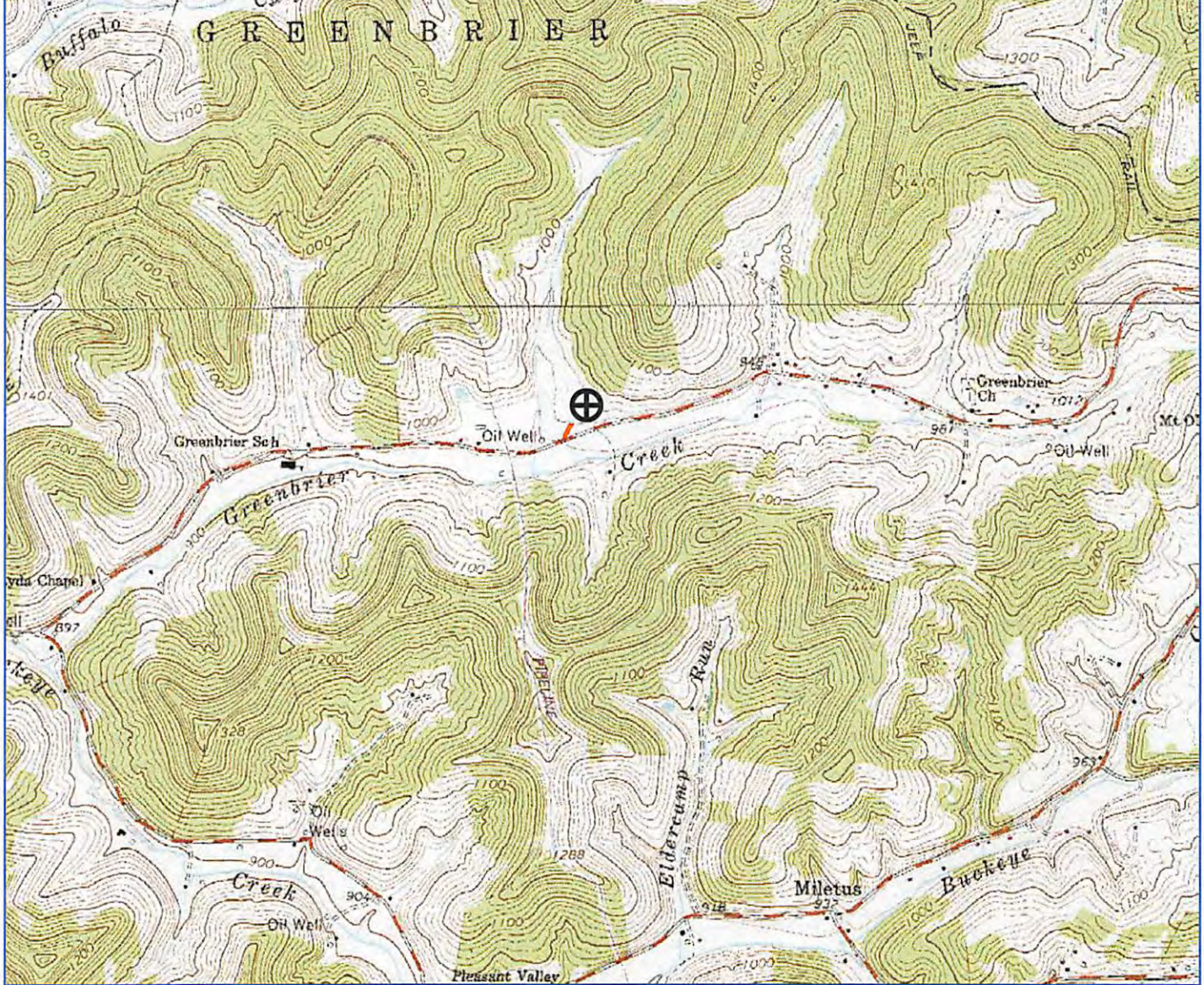

PETRA 7/24/2012 1:53:29 PM

Antero Resources Corporation

APPALACHIAN BASIN

Marsden Pad

Doddridge County

REMARKS

QUADRANGLE: BIG ISAAC
 WATERSHED: UPPER MIDDLE ISL. CR.
 DISTRICT: GREENBRIER



July 24, 2012