

4,826' TO TOP HOLE | LATITUDE 39°22'30"

6,949' TO BOTTOM HOLE | LATITUDE 39°25'00"

LONGITUDE 80°32'30"
2,374' TO TOP HOLE
LONGITUDE 80°32'30"
11,804' TO BOTTOM HOLE

Antero Resources
Well No. Webb Unit 2H
Antero Resources Appalachian Corp.

LEGEND

- Surface Owner Boundary Lines +/-
- - - Interior Surface Tracts +/-
- ⊕ Found monument, as noted

I-H TOP HOLE
SALEM 7.5' SPOT

NOTES:

WELL 2-H TOP HOLE INFORMATION:
N: 318,083ft E: 1,700,680ft
LAT: 39°22'06.5" LON: 80°33'31.5"
BOTTOM HOLE INFORMATION:
N: 323,854ft E: 1,698,625ft
LAT: 39°23'03.3" LON: 80°33'58.5"
WEST VIRGINIA COORDINATE SYSTEM OF 1927 NORTH ZONE. ZONE WAS DERIVED FROM MEASUREMENTS TAKEN WITH TRIMBLE GEOXT SUBMETER MAPPING GRADE GPS UNIT. PLAT ORIENTATION, CORNER, AND WELL REFERENCE TIE LINES ARE BASED ON GRID NORTH.

(NAD) 83 (UTM) ZONE 17 COORDS:
WELL 2-H TOP HOLE INFORMATION:
N: 4,357,771m E: 538,926m
BOTTOM HOLE INFORMATION:
N: 4,359,519m E: 537,371m

(+) DENOTES LOCATION OF WELL ON U. S. TOPOGRAPHIC MAPS

PAD LAYOUT

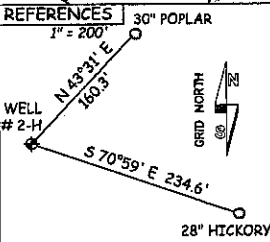
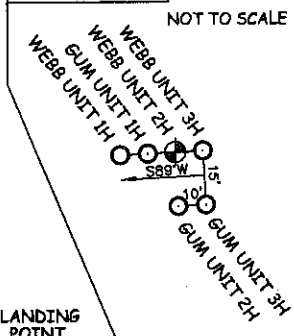

WELL # 2-H TO WATER WELLS

LTNE	BEARING	DIST.
W1	S 72°04' W	1351.6'
W2	N 65°52' W	973.2'
W3	N 89°48' W	614.1'
W4	N 55°46' E	1408.3'

NOTE: 4 WATER WELLS WERE LOCATED WITHIN 2000' OF PROPOSED WELL

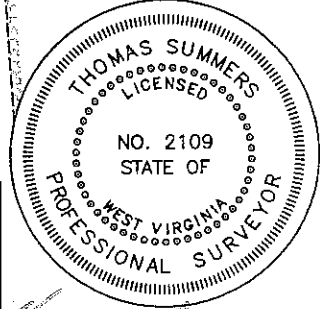

JOB # 11-048
DRAWING # WEBBUNIT2H
SCALE 1" = 1000'

I THE UNDERSIGNED, HEREBY CERTIFY THAT THIS PLAT IS CORRECT TO THE BEST OF MY KNOWLEDGE AND BELIEF AND SHOWS ALL THE INFORMATION REQUIRED BY LAW AND THE REGULATIONS ISSUED AND PERSCRIBED BY THE DEPARTMENTAL OF ENVIRONMENTAL PROTECTION.

MINIMUM DEGREE OF ACCURACY SUBMETER
PROVEN SOURCE OF ELEV. SUBMETER MAPPING GRADE GPS



STATE OF WEST VIRGINIA, DIVISION OF ENVIRONMENTAL PROTECTION, OFFICE OF OIL AND GAS
WILLOW LAND SURVEYING PLLC
266 HUSHERS RUN RD PENNSBORO WEST VIRGINIA 26415

THOMAS SUMMERS P.S. 2109
DATE 8/25/11
OPERATOR'S WELL# WEBB UNIT 2H
API WELL # 47 - 017 - 06045H

STATE OF WEST VIRGINIA DEPARTMENT OF ENERGY DIVISION OF OIL AND GAS

WELL TYPE: OIL ___ GAS X LIQUID INJECTION ___ WASTE DISPOSAL ___
(IF "GAS") PRODUCTION X STORAGE ___ DEEP ___ SHALLOW X
LOCATION: ELEVATION 921' WATERSHED SKELTON RUN DISTRICT McCLELLAN COUNTY DODDRIDGE

QUADRANGLE TOP HOLE - SALEM 7.5' AND BOTTOM HOLE - FOLSOM 7.5'
SURFACE OWNER ALLEN L. & JANET S. ASH ACREAGE 164.75 ACRES +/-
OIL & GAS ROYALTY OWNER CHARLES DODDSON; VALERIE & MICHAEL HALL ET AL; LUCILLE LEASE ACREAGE 31 AC, 23.25 AC, 110.5 AC
ROLLIN ET AL; WILLIAM HAMMOND ET AL; CLARENCE MUTSCHELKNAUS; NANCY ARTHUR ET AL; ROYAL ASHCRAFT ET AL 35 AC; 110 AC; 119 AC; 160 AC
PROPOSED WORK: DRILL X CONVERT ___ DRILL DEEPER ___ REDRILL ___ FRACTURE OR STIMULATE X PLUG OFF OLD FORMATION ___ PERFORATE NEW FORMATION X
OTHER PHYSICAL CHANGE IN WELL (SPECIFY) ___
PLUG & ABANDON ___ CLEAN OUT & REPLUG ___ ESTIMATED DEPTH 7200' TVD 14,000' MD
TARGET FORMATION MARCELLUS DIANNA STAMPER
WELL OPERATOR ANTERO RESOURCES APPALACHIAN CORP. DESIGNATED AGENT CT CORPORATION SYSTEM
ADDRESS 1625 17TH STREET ADDRESS 5400 D BIG TYLER ROAD
DENVER, CO 80202 CHARLESTON, WV 25313

COUNTY NAME PERMIT

LEASE # 21033; 21460; 21272; 21465; 21462; 21463; 21255

EXHIBIT 2, TOPOGRAPHICAL MAP OF WELL SITE LOCATION (ALLEN ASH PAD)

11 0004517
17-06045

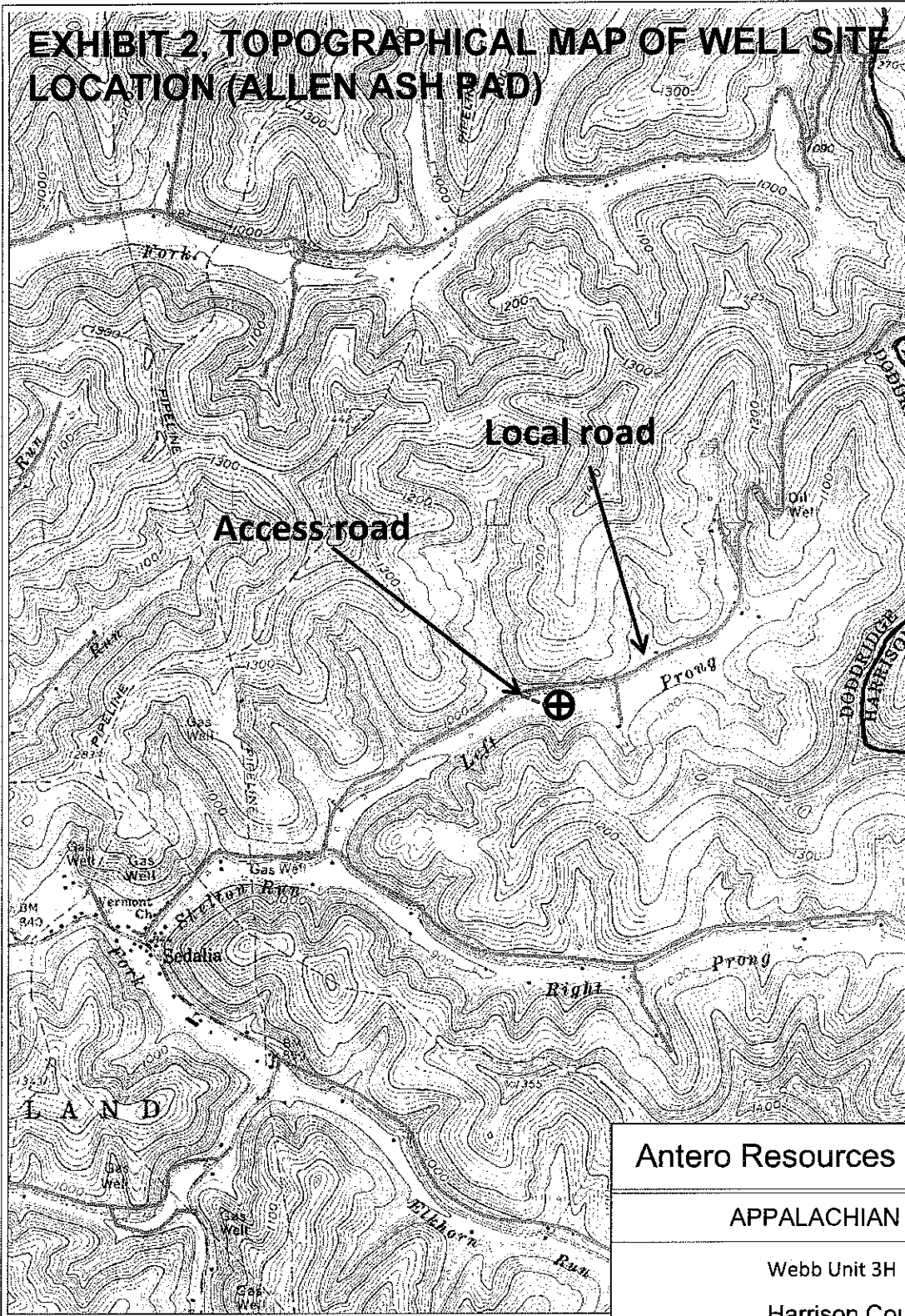

PETRA821/2011 11:53:03 AM

RECEIVED
Office of Oil & Gas
SEP 29 2011
WV Department of
Environmental Protection

Antero Resources Corporation
APPALACHIAN BASIN
Webb Unit 3H
Harrison County
REMARKS QUADRANGLE: SALEM WATERSHED: SKELTON RUN DISTRICT: MCCLELLAN
Date: 9/01/11