

HAESSLY LAND &  
TIMBER, LLC.  
615 ACRES±

# MAXWELL LEASE 2,400 ACRES± WELL NO. WV 512454

WELL NO. WV 512454  
BOTTOM HOLE

WELL NO. WV 512454  
STATE PLANE COORDINATES  
NORTH ZONE (NAD 27)

N. 260,880  
E. 1,634,672

LAT=(N) 39.20907  
LONG=(W) 80.78929

UTM (NAD 83)  
N. 4,340,008  
E. 518,207

WELL NO. WV 512454  
BOTTOM HOLE  
STATE PLANE COORDINATES  
NORTH ZONE (NAD 27)

N. 262,549  
E. 1,631,551

LAT=(N) 39.21353  
LONG=(W) 80.80039

UTM (NAD 83)  
N. 4,340,501  
E. 517,248

I.L. MORRIS  
P/O 6,603.75 ACRES±

I.L. MORRIS  
P/O 6,603.75 ACRES±

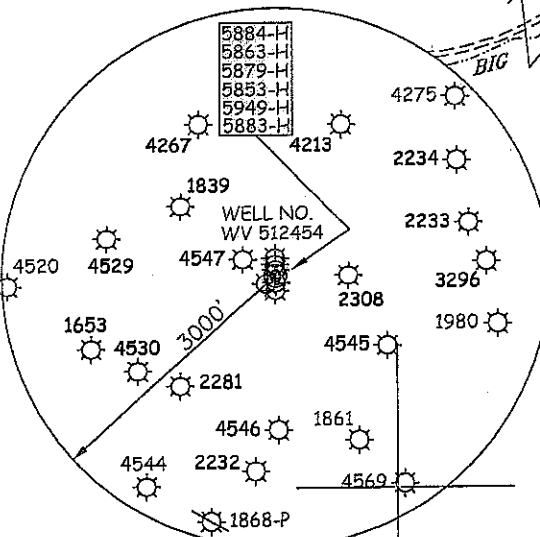

### NOTES ON SURVEY

1. TIES TO WELLS AND CORNERS ARE BASED ON GRID NORTH FOR THE WV STATE PLANE COORDINATE SYSTEM NORTH ZONE NAD 27.
2. TIES TO REFERENCES ARE BASED ON MAGNETIC NORTH 04/29/08.
3. LEASE BOUNDARY SHOWN HEREON TAKEN FROM DEED BOOK 28 PAGE 207 & 210 AND LEASE BOOK 14 PAGE 376.
4. SURFACE OWNER AND ADJOINER INFORMATION TAKEN FROM THE ASSESSOR AND COUNTY CLERK RECORDS OF DODDRIDGE COUNTY IN JULY, 2008.
5. WELL LAT./LONG. (NAD'27) ESTABLISHED BY DGPS (SUBMETER MAPPING GRADE).
6. ORIGINAL PLAT DATED 05/28/09 WAS UPDATED 02/22/12 TO REFLECT CURRENT SPOT CIRCLE, OWNERSHIP, TARGET FORMATION AND WELL TYPE.

### REFERENCES

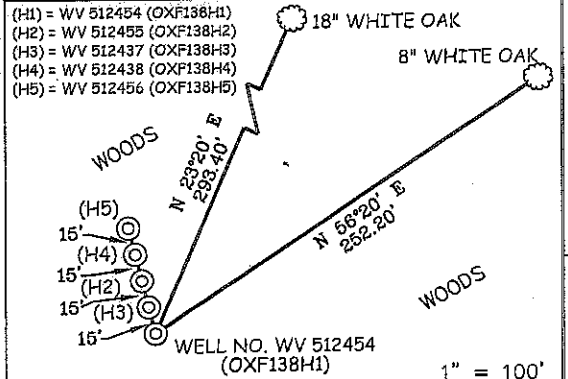

I THE UNDERSIGNED, HEREBY CERTIFY THAT THIS PLAT IS CORRECT TO THE BEST OF MY KNOWLEDGE AND BELIEF AND SHOWS ALL THE INFORMATION REQUIRED BY LAW AND THE REGULATIONS ISSUED AND PRESCRIBED BY THE DIVISION OF ENVIRONMENTAL PROTECTION.

P.S. 677

*Gregory A. Smith*

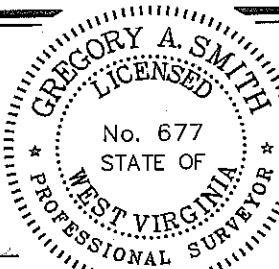

(+) DENOTES LOCATION OF WELL ON UNITED STATES TOPOGRAPHIC MAPS.  
DATE FEBRUARY 22, 20 12  
OPERATORS WELL NO. WV 512454  
API WELL NO. 47 - 017 - 05853H  
STATE COUNTY PERMIT  
*Revised*

MINIMUM DEGREE OF ACCURACY 1/200 FILE NO. 3959P512454R (275-68)  
PROVEN SOURCE OF ELEVATION DGPS (SUBMETER MAPPING GRADE) SCALE 1" = 1,000'

STATE OF WEST VIRGINIA  
DIVISION OF ENVIRONMENTAL PROTECTION  
OFFICE OF OIL AND GAS

WELL TYPE: OIL  GAS  LIQUID INJECTION  WASTE DISPOSAL  IF "GAS" PRODUCTION  STORAGE  DEEP  SHALLOW

LOCATION: ELEVATION 1,075' WATERSHED BIG RUN  
DISTRICT SOUTHWEST COUNTY DODDRIDGE QUADRANGLE OXFORD 7.5'

SURFACE OWNER I.L. MORRIS ACREAGE 6,603.75±  
ROYALTY OWNER WBM HEIRS PROPERTIES, LLC. LEASE ACREAGE 2,400±  
PROPOSED WORK: LEASE NO. 090490  
DRILL  CONVERT  DRILL DEEPER  REDRILL  FRACTURE OR STIMULATE  PLUG OFF OLD   
FORMATION  PERFORATE NEW FORMATION  PLUG AND ABANDON  CLEAN OUT AND REPLUG  OTHER   
PHYSICAL CHANGE IN WELL (SPECIFY) \_\_\_\_\_ TARGET FORMATION ONONDAGA  
ESTIMATED DEPTH \_\_\_\_\_

WELL OPERATOR EQT PRODUCTION COMPANY DESIGNATED AGENT REX C. RAY  
ADDRESS 1710 PENNSYLVANIA AVENUE ADDRESS 1710 PENNSYLVANIA AVENUE  
CHARLESTON, WV 25302 CHARLESTON, WV 25302 **04/20/2012**