

MAXWELL LEASE 79.75 ACRES ± WELL NO. 1

I. L. MORRIS
2331.51 AC. ±
(SURFACE)

I. L. MORRIS
173 AC. ±
(SURFACE)

WELL NO. 1
STATE PLANE
COORDINATES

(N) 263,900
(E) 1,651,975

STONE

I. L. MORRIS
2331.51 AC. ±
(SURFACE)

79.75 AC. ±
(MINERAL TRACT)

WELL NO. 1

DANIEL M.
SPENCE
185.50 AC. ±
(SURFACE)

I. L. MORRIS
2331.51 AC. ±
(SURFACE)

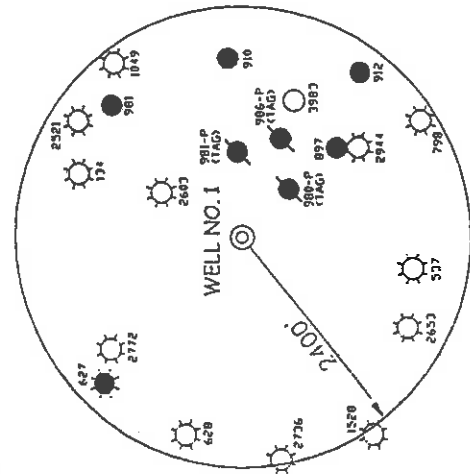

NOTES ON SURVEY

1. TIES TO WELLS AND CORNERS ARE BASED ON STATE PLANE GRID NORTH WV NORTH ZONE NAD '27.
2. TIES TO REFERENCES ARE BASED ON MAGNETIC NORTH 2/05/04.
3. LEASE BOUNDARY SHOWN HEREON TAKEN FROM DEED 111 AT PAGE 306.
4. SURFACE OWNER AND ADJOINER INFORMATION TAKEN FROM THE ASSESSOR AND COUNTY CLERK RECORDS OF DODDRIDGE COUNTY IN FEBRUARY, 2004.
5. WELL LAT./LONG. ESTABLISHED BY DGPS (SUBMETER MAPPING GRADE).

REFERENCES

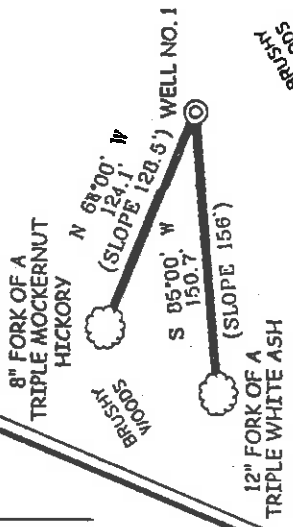

I THE UNDERSIGNED, HEREBY CERTIFY THAT THIS PLAN IS CORRECT TO THE BEST OF MY KNOWLEDGE AND BELIEF AND SHOWS ALL THE INFORMATION REQUIRED BY LAW AND THE REGULATIONS ISSUED AND PRESCRIBED BY THE DIVISION OF ENVIRONMENTAL PROTECTION.

P.S.
677 *Gregory A. Smith*

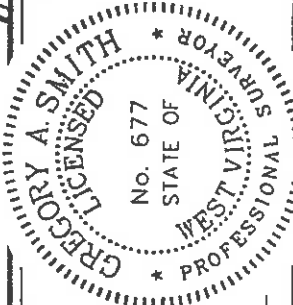

(+) DENOTES LOCATION OF WELL ON UNITED STATES TOPOGRAPHIC MAPS.

DATE FEBRUARY 11, 20 04
OPERATORS WELL NO. MAXWELL NO. 1

API WELL NO. 47 -- 017 -- 04806
STATE COUNTY PERMIT

MINIMUM DEGREE OF ACCURACY 1 / 200
FILE NO. 5444P1 (160-30)
PROVEN SOURCE OF ELEVATION DGPS (SUBMETER MAPPING GRADE)
SCALE 1" = 500'

STATE OF WEST VIRGINIA
DIVISION OF ENVIRONMENTAL PROTECTION
OFFICE OF OIL AND GAS



WELL TYPE: OIL GAS INJECTION WASTE LIQUID DISPOSAL WASTE IF GAS* PRODUCTION STORAGE DEEP SHALLOW

LOCATION: ELEVATION 950' WATERSHED G*OUSE RUN
DISTRICT NEW MILTON COUNTY C*ODDRIDGE QUADRANGLE NEW MILTON 7.5'
SURFACE OWNER I. L. MORRIS ACREAGE 2,331.51 ±
ROYALTY OWNER NANCY FOUT, ET AL LEASE ACREAGE 79.75 ±
LEASE NO. _____

PROPOSED WORK:
DRILL CONVERT DRILL DEEPER REDRILL FRACTURE OR STIMULATE PLUG OFF OLD
FORMATION PERFORATE NEW FORMATION PLUG AND ABANDON CLEAN OUT AND REPLUG OTHER
PHYSICAL CHANGE IN WELL (SPECIFY) _____ TARGET FORMATION GORDON
ESTIMAT. D DEPTH 2,800'

WELL OPERATOR INTERSTATE PRODUCTION COMPANY DESIGNATED AGENT ROGER A. MURRAY
ADDRESS 118 EAST MAIN STREET BRIDGEPORT, WV 26330
ADDRESS 118 EAST MAIN STREET BRIDGEPORT, WV 26330

0000 4806
COUNTY NAME PERMIT

(New Milton: North 144 6-6)

State of West Virginia
Department of Environmental Protection
Office of Oil and Gas

msf

Well Operator's Report of Well Work

Farm name: I. L. Morris

Operator Well No.: Maxwell #1

LOCATION: Elevation: 950'

Quadrangle: New Milton 7 1/2'

District: New Milton
Latitude: 11,580 Feet South of 39 Deg. 15 Min. 00 Sec.
Longitude: 5,630 Feet West of 80 Deg. 42 Min. 30 Sec.
County: Doddridge

Company: INTERSTATE PRODUCTION COMPANY

| Address: | Casing & Tubing | Used in drilling | Left in well | Cement fill up Cu. Ft. |
|---|-----------------|------------------|--------------|------------------------|
| 118 East Main Street Bridgeport, WV 26330 | 9 5/8" | 209' | 209' | 65 sx. |
| Agent: Roger A. Murray | 7" | 974' | 974' | 140 sx. |
| Inspector: Mike Underwood | | | | |
| Date Permit Issued: 3/18/04 | | | | |
| Date Well Work Commenced: 3/30/04 | 4 1/2" | | 2,586' | 106 sx. |
| Date Well Work Completed: 4/26/04 | | | | |
| Verbal Plugging: | | | | |
| Date Permission granted on: | | | | |
| Rotary <input checked="" type="checkbox"/> Cable <input type="checkbox"/> Rig | | | | |
| Total Depth (feet): 2,712 | | | | |
| Fresh Water Depth (ft.): 50', 100', 150' | | | | |
| Salt Water Depth (ft.): 1,300' | | | | |
| Is coal being mined in area (N/Y)? N | | | | |
| Coal Depths (ft.): | | | | |

OPEN FLOW DATA

Producing formation Gordon Pay zone depth (ft) 2,519' - 2,523'
 Gas: Initial open flow 15 MCF/d Oil: Initial open flow Bbl/d
 Final open flow 174 MCF/d Final open flow show Bbl/d
 Time of open flow between initial and final tests Hours
 Static rock Pressure 195 psig (surface pressure) after 96 Hours

Second producing formation Big Injun, Weir, Berea Pay zone depth (ft) 1,864' - 2,302'
 Gas: Initial open flow * MCF/d Oil: Initial open flow * Bbl/d
 Final open flow * MCF/d Final open flow * Bbl/d
 Time of open flow between initial and final tests Hours
 Static rock Pressure * psig (surface pressure) after * Hours

* Comingled

NOTE: ON BACK OF THIS FORM PUT THE FOLLOWING: 1). DETAILS OF PERFORATED INTERVALS, FRACTURING OR STIMULATING, PHYSICAL CHANGE, ETC. 2). THE WELL LOG WHICH IS A SYSTEMATIC DETAILED GEOLOGICAL RECORD OF ALL FORMATIONS, INCLUDING COAL ENCOUNTERED BY THE WELLBORE.

Signed:

By: Roger A. Murray, Secretary/Treasurer

RECEIVED
COMMISSIONER'S OFFICE
MAY 17 2004
WV Department of Environmental Protection

0000 4806

JUN 04 2004

| FORMATION | COLOR | HARD/SOFT | TOP | BOTTOM | REMARKS |
|------------------|-----------------|-----------|--------------|--------|---|
| 5 Stage Frac | | | | | |
| Gordon | 2,519' - 2,523' | 10 holes | 20,000# sand | | 234 Bbl. SLF |
| Berea | 2,297' - 2,302' | 10 holes | 15,000# sand | | 176 Bbl. SLF |
| L. Weir | 2,143 2,160 | 12 holes | 15,000# sand | | 175 Bbl. SLF |
| U. Weir | 2,093 2,112 | 10 holes | 15,000# sand | | 168 Bbl. SLF |
| Big Injun | 1,864' - 1,872' | 12 holes | 25,000# sand | | 259 Bbl. SLF |
| Fill | | | 0 | 10 | |
| Sand & shale | mixed | soft | 10 | 20 | |
| Sand | gray | med. | 20 | 30 | |
| Sand & Shale | gray | med. | 30 | 421 | FW @ 50', 100', 150' |
| RR/Sand/Shale | red/gray | soft | 421 | 448 | FW @ 260' |
| Sand | gray | hard | 448 | 464 | |
| Shale | gray | soft | 464 | 477 | |
| Sand | gray | med. | 477 | 558 | |
| Shale | red & gray | soft | 558 | 630 | |
| Shale | gray | med. | 630 | 725 | |
| Sand & Shale | gray | med. | 725 | 763 | |
| Shale | white & gray | hard | 763 | 845 | |
| Sand, Shale & RR | dark gray | soft | 845 | 1158 | |
| Lime | gray/red | soft | 1158 | 1175 | |
| Shale | light gray | soft | 1175 | 1219 | |
| Sand & Shale | dark gray | soft | 1219 | 1275 | |
| Salt Sand | white | med. | 1275 | 1350 | 1 1/2" st. SW @ 1300' |
| Sand & Shale | gray | soft | 1350 | 1525 | |
| Maxon | light gray | med. | 1525 | 1615 | |
| Sand & Shale | gray | soft | 1615 | 1752 | |
| Big Lime | tan | hard | 1752 | 1862 | |
| Big Injun | dark gray | med. | 1862 | 1944 | |
| Sand & Shale | gray | soft | 1944 | 2080 | |
| Weir | gray | med. | 2080 | 2087 | |
| Sand | gray | med. | 2087 | 2118 | gas 2/10 thru 1" w/w |
| Shale | gray | soft | 2118 | 2300 | |
| Berea | gray | soft | 2300 | 2380 | |
| Sand & Shale | gray | med. | 2380 | 2510 | |
| Gordon | light brown | med. | 2510 | 2540 | |
| Sand & Shale | gray | soft | 2540 | 2712 | gas 6/10 thru 1" w/w gas @ TD 14/10 thru 1" w/w |
| Total Depth | | | 2712 | | |