

Proposed Boggress Well No. 3
Mountain "V" Oil and Gas, Inc.
54 of 91 Acre Lease

11,090

LATITUDE

39 - 22 - 30

2,630

LONGITUDE

80 - 35 - 00

24 - 21
Albert K. Gasfon et al

24 - 20
Charles E. & Sandra E. Postfshwait

S 87°30' E

Proposed Boggress
Well # 3

N 11°08'02" E

24 - 22
Frederick F. Wilson et al

N 25° E

24 - 23
Frederick F. Wilson et al

64 Acres

S 02°53'40" W

873.35'

Point in center
of road

2046.00'

GRID NORTH

N 70° W

412.50'

S 65° W

602.25'

5/8" Rebar,
Pound

24 - 24
Larry G. Davis et ux

24 - 25.1
Steven D. & Annette M. Wilson

1237.50'

S 85° W

2046.00'

1237.50'

S 85° W

1237.50'

S 85° W

1237.50'

S 85° W

1237.50'

S 85° W

1237.50'

S 85° W

1237.50'

S 85° W

1237.50'

S 85° W

1237.50'

S 85° W

1237.50'

S 85° W

1237.50'

S 85° W

1237.50'

S 85° W

1237.50'

S 85° W

1237.50'

S 85° W

1237.50'

S 85° W

1237.50'

S 85° W

1237.50'

S 85° W

1237.50'

S 85° W

1237.50'

S 85° W

1237.50'

S 85° W

1237.50'

S 85° W

1237.50'

S 85° W

1237.50'

S 85° W

1237.50'

Notes:
Well site coordinates are
N: 318,045
E: 1,682,622
West Virginia, North Zone
Coordinate System of 1927
based upon
Differential GPS Measurements.
Plat orientation and corner and well references
are based upon the grid north meridian.
Well location references
are based upon the magnetic meridian.

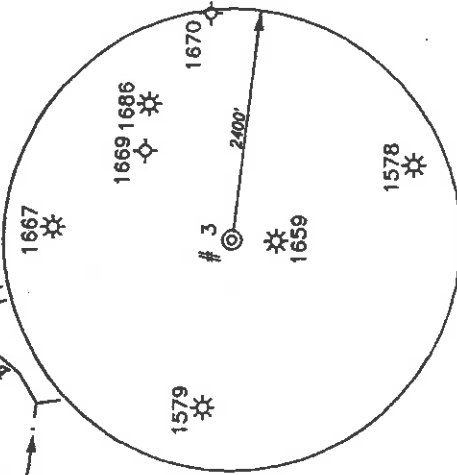

(*) Denotes Location of well on United States Topographic Maps



I, the undersigned, hereby certify that this plat is correct to the best of my knowledge and belief and shows all the information required by law and the regulations issued and prescribed by the Department of Mines.

James R. Skinner
P.S. 1962

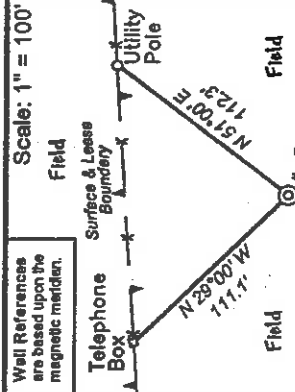
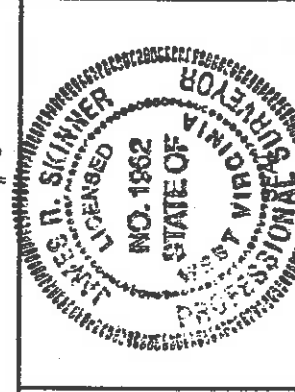

FILE NO: WV-08-30-M-03
DRAWING NO: W0830m03_3.dwg
SCALE: 1" = 400'
MINIMUM DEGREE OF ACCURACY: 1:200
PROVEN SOURCE OF ELEVATION: Junction of Roads Elevation 883'

STATE OF WEST VIRGINIA
DEPARTMENT OF ENVIRONMENTAL PROTECTION
OIL AND GAS DIVISION

DATE: June 2, 20 03
OPERATOR'S WELL NO. Boggress #3
API WELL NO.:
47 - 017 - 04743
STATE COUNTY PERMIT

WELL TYPE: OIL GAS LIQUID INJECTION WASTE DISPOSAL
(IF GAS) PRODUCTION: STORAGE DEEP SHALLOW
LOCATION: ELEVATION: 828' WATERSHED Big Battle Run QUADRANGLE: Salem 7.5
DISTRICT: McClellan COUNTY: Doddridge
SURFACE OWNER: Frederick F. Wilson et al
OIL AND GAS ROYALTY OWNER: Frederick F. Wilson et al LEASE NO: 54 of 91
PROPOSED WORK: DRILL CONVERT DRILL DEEPER FRACTURE OR STIMULATE PLUG OFF OLD FORMATION
 PERFORATE NEW FORMATION OTHER PHYSICAL CHANGE IN WELL (SPECIFY)
 PLUG AND ABANDON CLEAN OUT AND REPLUG TARGET FORMATION: Benson ESTIMATED DEPTH: 5995'
WELL OPERATOR: Mountain "V" Oil & Gas, Inc. DESIGNATED AGENT: Mike Shaver
ADDRESS: P.O. Box 470 Bridgeport, WV 26330

WELL TYPE: OIL GAS LIQUID INJECTION WASTE DISPOSAL
(IF GAS) PRODUCTION: STORAGE DEEP SHALLOW
LOCATION: ELEVATION: 828' WATERSHED Big Battle Run QUADRANGLE: Salem 7.5
DISTRICT: McClellan COUNTY: Doddridge
SURFACE OWNER: Frederick F. Wilson et al
OIL AND GAS ROYALTY OWNER: Frederick F. Wilson et al LEASE NO: 54 of 91
PROPOSED WORK: DRILL CONVERT DRILL DEEPER FRACTURE OR STIMULATE PLUG OFF OLD FORMATION
 PERFORATE NEW FORMATION OTHER PHYSICAL CHANGE IN WELL (SPECIFY)
 PLUG AND ABANDON CLEAN OUT AND REPLUG TARGET FORMATION: Benson ESTIMATED DEPTH: 5995'
WELL OPERATOR: Mountain "V" Oil & Gas, Inc. DESIGNATED AGENT: Mike Shaver
ADDRESS: P.O. Box 470 Bridgeport, WV 26330

0000 4743

(Smile) - Fred - Red (11/11/03)

State of West Virginia
Department of Environmental Protection
Office of Oil and Gas

Well Operator's Report of Well Work

Farm name: Fredrick F. Wilson etal

Operator Well No.: Boggess #3

LOCATION: Elevation: 828

Quadrangle: Salem 7.5'

District: McClellan

County: Doddridge

Latitude: 39° 22' 30' Feet South of Deg. Min Sec.
Longitude: 80° 35' 00' Feet West of Deg. Min Sec.

Company: Mountain V Oil & Gas, Inc.

Address:	Casing & Tubing	Used in drilling	Left in well	Cement fill up Cu. Ft.
PO Box 470	9 5/8"		265'	75 sks.
Bridgeport, WV 26330	7"		1362'	220 sks.
Agent: Mike Shaver	4 1/2"		5289'	265 sks.
Inspector: Mike Underwood				
Date Permit Issued: 6/30/03				
Date Well Work Commenced: 9/11/03				
Date Well Work Completed: 9/19/03				
Verbal Plugging:				
Date Permission granted on:				
Rotary X Cable Rig				
Total Depth (feet): 5395				
Fresh Water Depth (ft.): 110'				
Salt Water Depth (ft.): 2000'				
Is coal being mined in area (N/Y)? N				
Coal Depths (ft.): N/A				

OPEN FLOW DATA Gordon, Benson, Alexander (Comingled)

Producing formation: **Comingled** Pay zone depth (ft.) _____
 Gas: Initial open flow: **Odor**MCF/d itial open flow **N/A** Bbl/d
 Final open flow: **474,000** MCF/D open flow _____ Bbl/d
 Time of open flow between initial and final tests _____ Pay zone depth (ft) _____
 Static rock Pressure **45** psi(surface pressure) after **24** hours
 Second producing formation _____ MCF/d Oil: Initial open flow _____ Bbl/d
 Gas: Initial open flow _____ MCF/d Final open flow _____ Bbl/d
 Final open flow _____ MCF/d Final open flow _____ Bbl/d
 Time of open flow between initial and final tests _____ Hours
 Static rock Pressure _____ psig (surface pressure) after _____ Hours

NOTE: ON BACK OF THIS FORM PUT THE FOLLOWING: 1). DETAILS OF PERFORATED INTERVALS, FRACTURING OR STIMULATING, PHYSICAL CHANGE, ETC. 2). THE WELL LOG WHICH IS A SYSTEMATIC DETAILED GEOLOGICAL RECORD OF ALL FORMATIONS, INCLUDING COAL ENCOUNTERED BY THE WELLBORE.

Signed: *Mike Shaver*
 By: Mike Shaver, Vice-President

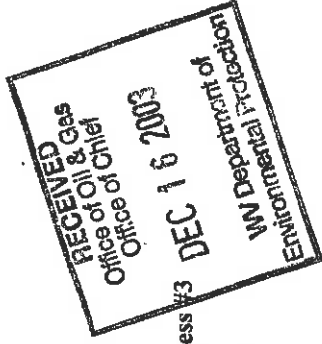

12/17

0000 4743

See 27.004

STAGE	PERFORATIONS	PROPANT QUANTITY	N2	FOAM QUALITY	BBL'S
1	5136-5137 (2 Holes) 5118-5120 (2 Holes) 5052-5056 (6 Holes)	25,000#	325,000	65 Quality Cross Link Foam	131 BBL'S Foam
2	4908 (2 Holes) 4853-4855 (4 Holes) 4708-4711 (4 Holes)	25,100#	311,000	65 Quality Cross Link Foam	133 BBL'S Foam
3	2506-2508 (4 Holes) 2298-2302 (8 Holes)	30,000#	234,000	65 Quality Cross Link Foam	155 BBL'S Foam

FORMATION	TOP	BOTTOM
Clay/Shale/Sand	0	1726
Lime	1726	1808
Sand/Shale	1808	1846
Injun	1846	1936
Sand/Shale	1936	2240
Gordon Stray	2290	2316
Sand/Shale	2316	2483
Gordon	2483	2515
Sand/Shale	2515	4703
Benson	4703	4717
Sand/Shale	4717	4849
Alexander	4849	5150
Total Depth	5395	

H2O
N/A

GAS CHECKS
Odor @ TD