

E. Jifiable Production Company, Inc.
47-017-04536 WV215181
W.B. Maxwell 2400 Acre Lease

Notes:
Well site coordinates are
N: 255359 Latitude: 39.193900
E: 1634323 Longitude: 80.790239
West Virginia
Coordinate System of 1927, North Zone
based upon
Differential GPS Measurements.
Plat orientation and corner and well
references are based upon the grid
north meridian.
Well location references are based upon
the magnetic meridian.

LATITUDE

39 - 12 - 30

LONGITUDE

80 - 45 - 00

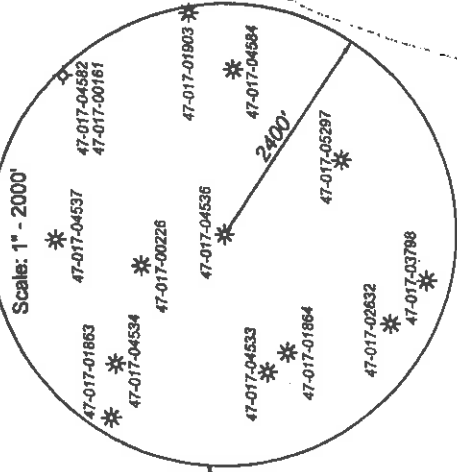

3/4" Iron pin

47-017-04537

N 20°07'00" W
7826.34'

47-017-00226

N 19°30'20" W 923.82'

Oak snag

FIG 10-2
I.L. (Ike) Morris
c/o Steve Holloway
230/307
6603.75 Acres

FIG 10-2

47-017-04536

WV215181

S 73°15'20" W
1505.68'

47-017-04533

47-017-01864

FIG 10-2
I.L. (Ike) Morris
c/o Steve Holloway
230/307
6603.75 Acres

FIG 10-2

GRID NORTH

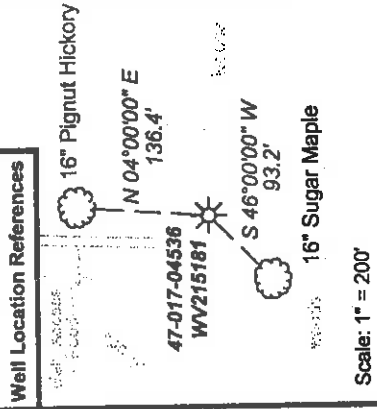

(-*) Denotes location of well on United States topographic maps

- Legend**
- ☼ Gas well existing or proposed
 - Found corner, as noted
 - Surface boundary (approximate)
 - ▤ Lease boundary

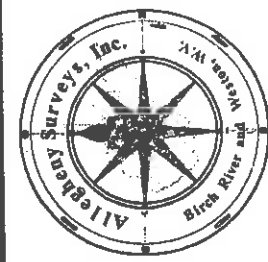

I, the undersigned, hereby certify that this plat is correct to the best of my knowledge and belief and shows all the information required by law and the regulations issued and prescribed by the Department of Environmental Protection.

Ben R. Singleton
P.S. 2092

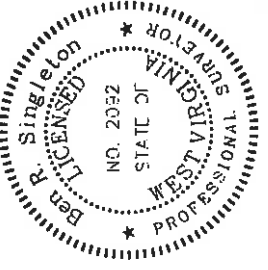

FILE NO: 96-30-S-07
DRAWING NO: 9630S07_WV215181
SCALE: 1" = 500'
MINIMUM DEGREE OF ACCURACY:
1:2500
PROVEN SOURCE OF ELEVATION:
NGS CORS GSSP

STATE OF WEST VIRGINIA
DEPARTMENT OF ENVIRONMENTAL PROTECTION
OFFICE OF OIL AND GAS

DATE: September 10 20_07
OPERATOR'S WELL NO. WV215181
API WELL NO: 47-017-04536
STATE 47 COUNTY 017 COUNTY PERMIT 04536F
Maxwell B

WELL TYPE: OIL GAS LIQUID INJECTION WASTE DISPOSAL
(IF GAS) PRODUCTION: STORAGE DEEP SHALLOW
LOCATION: ELEVATION: 1253' WATERSHED South Fork Hughes River
QUADRANGLE: Oxford DISTRICT: Southwest COUNTY: Doddridge
SURFACE OWNER: I.L. (Ike) Morris c/o Steve Holloway ACREAGE: 6603.75 Ac.
OIL AND GAS ROYALTY OWNER: W. B. Maxwell Heirs LEASE NO: 090490 ACREAGE: 2400 Ac.
PROPOSED WORK: DRILL CONVERT DRILL DEEPER FRACTURE OR STIMULATE PLUG OFF OLD FORMATION
 PERFORATE NEW FORMATION OTHER PHYSICAL CHANGE IN WELL (SPECIFY)
 PLUG AND ABANDON CLEAN OUT AND REPLUG TARGET FORMATION: Alexander ESTIMATED DEPTH: 5557'

WELL OPERATOR: Equitable Production Company, Inc. DESIGNATED AGENT: L. Todd Tetrick NOV 3 0 2007
ADDRESS: 1710 Pennsylvania Ave. 1710 Pennsylvania Ave.
Charleston, WV 25302 (Singleton) 153-66 Charleston, WV 25302

D000 4536 F

FORUM WV 6 LONG. 80°47'24.8" LATITUDE 39°12'30" 11,420' 5.270' 80°45'00"

**W.B. MAXWELL LEASE
2400 ACRES ±
WELL NO. 9**

2.0
1.0
1.0

2400 ACRE MINERAL TRACT

I.L. MORRIS
6603.75 AC.
(SURFACE)

I.L. MORRIS
6603.75 AC.
(SURFACE)

NOTE: LEASE BOUNDARY RUNS WITH THE OLD SALEM-PARKERSBURG TURNPIKE.

WELL NO. 9
STATE PLANE
COORDINATES
(N) 256,361
(E) 1634,331

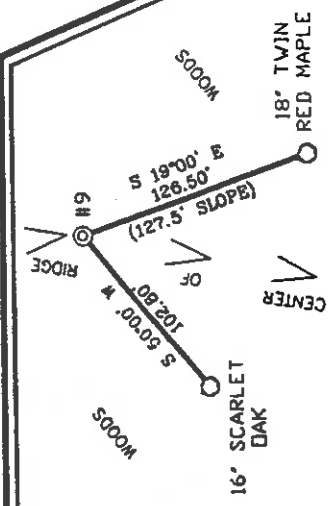

REFERENCES

NOTES ON SURVEY

1. TIES TO WELLS ARE BASED ON STATE PLANE GRID NORTH WV NORTH ZONE NAD '27.
2. TIES TO REFERENCES ARE BASED ON MAGNETIC NORTH 10/04/99.
3. LEASE BOUNDARY SHOWN HEREON TAKEN FROM DODDRIDGE COUNTY LEASE BOOK 14 ON PAGE 376.
4. SURFACE OWNERS AND ADJOINER INFORMATION OBTAINED FROM THE ASSESSOR AND COUNTY CLERK RECORDS OF DODDRIDGE COUNTY IN MAY, 1998.
5. WELL LAT./LONG. ESTABLISHED BY DGPS (SUBMETER MAPPING GRADE).



I THE UNDERSIGNED, HEREBY CERTIFY THAT THIS PLAT IS CORRECT TO THE BEST OF MY KNOWLEDGE AND BELIEF AND SHOWS ALL THE INFORMATION REQUIRED BY LAW AND THE REGULATIONS ISSUED AND PRESCRIBED BY THE DEPARTMENT OF ENERGY.

P.S. 677 *Gregory A. Smith*

(+) DENOTES LOCATION OF WELL ON UNITED STATES TOPOGRAPHIC MAPS.
DATE OCTOBER 7, 19 99
OPERATORS WELL NO. W.B. MAXWELL #9
API WELL NO. 47 - 017 COUNTY PERMIT NO. 04536

MINIMUM DEGREE OF ACCURACY 1 / 200 FILE NO. 3959P9 (80-38) SCALE 1" = 1000'
PROVEN SOURCE OF ELEVATION JUNCTION OF ROADS ELEVATION 886'

STATE OF WEST VIRGINIA
DIVISION OF ENVIRONMENTAL PROTECTION
OFFICE OF OIL AND GAS



WELL TYPE : OIL GAS INJECTION DISPOSAL WASTE LIQUID GAS "GAS" PRODUCTION STORAGE DEEP SHALLOW

LOCATION : ELEVATION 1259' WATERSHED CAMP RUN OF THE SOUTH FORK HUGHES RIVER
DISTRICT SOUTHWEST COUNTY DODDRIDGE QUADRANGLE OXFORD 7.5'
SURFACE OWNER I.L. MORRIS ACREAGE 6603.75
ROYALTY OWNER W.B. MAXWELL HEIRS ET AL LEASE ACREAGE 2400 LEASE NO. 90490
PROPOSED WORK :
DRILL CONVERT DRILL DEEPER REDRILL FRACTURE OR STIMULATE PLUG OFF OLD FORMATION PERFORATE NEW FORMATION PLUG AND ABANDON! CLEAN OUT AND REPLUG OTHER ALEXANDER
PHYSICAL CHANGE IN WELL (SPECIFY) _____ TARGET FORMATION _____ ESTIMATED DEPTH 5500'

COUNTY NAME D000 PERMIT 4536

WELL OPERATOR EASTERN STATES OIL AND GAS, INC. DESIGNATED AGENT ROBERT ALLEY
ADDRESS P.O. BOX 2347 CHARLESTON, WV 25328

NOV 1 1999

WR-35

28-Oct-99
API # 47- 017-04536

Division of Oil and Gas
Permitting

State of West Virginia
Division of Environmental Protection
Section of Oil and Gas

Reviewed K

JAN 13 2000

WV Division of

Well Operator's Report of Well Work

Farm Name: MORRIS, I.L.

Operator Well No.: W.B. MAXWELL 9

LOCATION:

Elevation: 1,259.00

Quadrangle: OXFORD

District: SOUTHWEST

County: DODDRIDGE

Latitude: 5270

Feet South of

39 DEG 12 MIN 30 SEC

Longitude: 11420

Feet West of

80 DEG 45 MIN 0 SEC

Company: BLAZER ENERGY CORPORATION
P.O. BOX 2347
CHARLESTON, WV 25328

Agent: Richard Smeltzer

Inspector: MIKE UNDERWOOD

Permit Issued: 10/28/99

Well work commenced: 11/17/99

Well work completed: 12/11/99

Verbal Plugging

Permission granted on:

Rotary Rig X Cable Rig

Total Depth 5557 feet

Fresh water depths (ft)

Salt water depths (ft)

Is coal being mined in area?

Coal Depths (ft):

Casing & Tubing Size	Used in Drilling	Left in Well	Cement Fill Up Cu. Ft.
8-5/8"	1289'	1289'	425 FT ³
4-1/2"	5383'	5383'	684 FT ³

OPEN FLOW DATA

Producing formation Alexander, Benson/Riley, Balltown, Speechley

Pay Zone Depth (ft): Reverse

Gas: Initial open flow NA MCF/d Oil: Initial open flow

Final open flow: 60 (In Line MCF/d Final open flow:

Time of open flow between initial and final tests

Static rock pressure 510 psig (surface pressure) after

Hours

Second producing formation

Gas: Initial open flow MCF/d Oil: Initial open flow

Final open flow: MCF/d Final open flow:

Time of open flow between initial and final tests

Static rock pressure psig (surface pressure) after

Hours

NOTE: ON BACK OF THIS FORM PUT THE FOLLOWING: 1) DETAILS OF PERFORATED INTERVALS, FRACTURING OR STIMULATING, PHYSICAL CHANGE, ETC. 2) THE WELL LOG WHICH IS A SYSTEMATIC DETAILED GEOLOGICAL RECORD OF ALL FORMATIONS, INCLUDING COAL ENCOUNTERED BY THE WELLBC

For: BLAZER ENERGY CORPORATION

By: Barbara L Shuman
Date: 1-12-00

Dodd 4536

FEB 25 2000

EASTERN STATES OIL & GAS, INC.
WR-35 COMPLETION REPORT - Attachment
Well Treatment Summary

Well: Maxwell 9

API# 47-017-04536

Date	12/7/99	12/8/99	12/8/99	12/8/99		
Type Frac Acid, N ₂ , Foam, Water	WF 15 Alexander	WF 20 Benson/Riley	WF 20 Balltown	WF 20 Speechley		
Zone Treated						
# Perfs	20	20	20	20		
From - To:	5182-5244	4801-5113	3817-4484	3289-3408		
BD Pressure @ psi	2050	2000	NA	NA		
ATP psi	2000	2500	2800	1900		
Avg. Rate, B=B/M, S=SCF/M	35 B	34 B	28 B	34 B		
Max. Treat Press psi						
ISIP psi	1000	1200	1000	900		
Frac Gradient		.63	.67	.68	.70	
10 min S-I Pressure						
Material Volume						
Sand-sks	400	300	300	300		
Water-bbl	590	720	580	550		
SCF N ₂						
Acid-gal	500 gal 16%	1100 gal 16%	1100 gal 16%	500 gal 15%		
NOTES:						

TOP	BASE	FORMATION	REMARKS
0	1720	Sand Shale	
1720	1754	Shale	
1754	1787	Maxton	
1787	1891	Sand & Shale	
1891	1905	Little Lime	
1905	2003	Big Lime	
2003	2043	Injun	
2043	2204	Shale	
2204	2308	Weir	
2308	2399	Shale	
2399	2404	Sand	
2404	2582	Shale	
2582	2634	Sand	
2634	3275	Shale	
3275	3305	Warren	
3305	3400	Shale	
3400	3408	Speechley	
3408	3760	Shale	
3760	4348	Balltown	
4348	4467	Shale	
4467	4061	Riley	
4061	5110	Benson	
5110	5148	Shale	
5148	5245	Alexander	
5245	5482	TD	

Checked by
 Printed
 JAN 13 2000
 WPC/eng

**State of West Virginia
Division of Environmental Protection
Section of Oil and Gas
Well Operator's Report of Well Work**

API # 470170453600

017-04536 F

Farm Name I.L. Morris Well Number 215181

Location Elevation 1,253 Quadrangle OXFORD

District Southwest County Doddridge, WV

Latitude 5265 FSL Longitude 39.00 Minute 12.00 Second 30.00

Longitude 80.00 FWL 45.00 0.00

Company EQT Production Company
1710 Pennsylvania Avenue Charleston,
WV 25328

Agent Jason Burns

Inspector Mike Underwood

Permit issued 11/28/2007

Well Work Commenced 07/03/08

Well Work Completed 09/03/2008

Verbal Plugging

Permission granted on _____

Rotary Rig Cable Rig _____

Total Depth 5,557

Water Encountered

Type From
Previously Reported

Coal & Open Mines

Type From
Previously Reported

RECEIVED
DIVISION OF OIL & GAS
JUN 15 2009
ENVIRONMENTAL PROTECTION
DEPARTMENT

Open Flow Data

Producing Formation _____
Weir/Berea _____; Keener/Injun _____

Gas: Initial Open Flow 1 MCF _____ Date _____

Final Open Flow 440 MCF 09/04/2008 Date _____

Time of open flow between initial and final tests _____ 0 hours

Static Rock Pressure 0 after 0 hours

Second Producing Formation

Gas: Initial Open Flow _____ MCF _____ Date _____

Final Open Flow _____ MCF _____ Date _____

Time of open flow between initial and final tests _____ hours

Static Rock Pressure _____ after _____ hours

Pay Zone Depth (ft): See attached for details

Oil: Initial Open Flow _____ Bbl/d

Final Open Flow _____

_____ hours

Pay Zone Depth (ft) _____

Oil: Initial Open Flow _____ Bbl/d

Final Open Flow _____

_____ hours

RECEIVED
Office of Oil & Gas

APR 22 2009

WV Department of
Environmental Protection

NOTE: On back of this form put the following

- 1) Details of Perforated intervals, fracturing or stimulating, physical change, etc.
- 2) The well log, a systematic detailed geological record of all formations including coal encountered in the well bore

AUG 6 7 2009

By [Signature] Production Company

Date 4/16/09

Well Number 215181

EQT Company

WR-35 Completion Report - Attachment

Well Treatment Summary

API # 470170453600

Slings 1		Slings 1	
Date	08/14/2008	Date	08/14/2008
Fract Typ	20Q Foam	Fract Typ	20Q Foam
Zone	Weir/Berea	Zone	Keencer/Injun
# of Perfs	36	# of Perfs	29
From/To	2,206- 2,406	From/To	1,980- 2,014
BD Press	1,894	BD Press	1,050
ATP Psi	2,229	ATP Psi	2,115
Avg Rate	32	Avg Rate	30
Max Press Psi	2,269	Max Press Psi	2,141
ISIP Psi	1,250	ISIP Psi	1,111
10min SIP	1,392	10min SIP	1,180
5 min Frac Gradient	1.11	5 min Frac Gradient	1.15
Sand Proppant	330.00	Sand Proppant	405.00
Water-bbl	456	Water-bbl	556
SCE N2	88,000	SCE N2	100,000
Acid-gal	500 gal	Acid-gal	500 gal
	15%HCL		15%HCL
Formation Name		Depth To	Depth Bottom
			Formation Thick

Gas Tests

Depth Remarks

Previously rphd

N/D
No print

State of West Virginia
Division of Environmental Protection
Section of Oil and Gas
Well Operator's Report of Well Work

API # 47017045368
REV.

Farm Name I.L. Morris Well Number 215181
Location Elevation 1,253 Quadrangle OXFORD
District Southwest County Doddridge, WV
Latitude 5265 FSL 39.00 Minute 12.00 Second 30.00
Longitude FWL 80.00 45.00 0.00

Company EQT Production Company
1710 Pennsylvania Avenue Charleston,
WV 25328

Agent Jason Burns

Inspector Mike Underwood
Permit Issued 11/28/2007

Well Work Commenced 4/23/2008

Well Work Completed 09/03/2008

Verbal Plugging

Permission granted on

Rotary Rig Cable Rig

Total Depth 5,557

Water Encountered

Type From

Previously reported

RECEIVED
OCT 23 2009

AUG 19 2009

Coal & Open Mines

Type From

Previously reported

RECEIVED
OCT 23 2009
Environmental Protection

Open Flow Data

Producing Formation
Weir/Bases ; Keener/Injun

Pay Zone Depth (ft): See attached for details

Gas: Initial Open Flow 0 MCF 09/04/2008 Date
Final Open Flow 440 MCF 09/04/2008 Date

Oil: Initial Open Flow Bbl/d
Final Open Flow

Time of open flow between initial and final tests 0 after 0 hours

Static Rock Pressure 0 after 0 hours

Second Producing Formation

Pay Zone Depth (ft)

Gas: Initial Open Flow MCF Date
Final Open Flow MCF Date

Oil: Initial Open Flow Bbl/d
Final Open Flow

Time of open flow between initial and final tests after hours

Static Rock Pressure after hours

NOTE: On back of this form put the following

1) Details of Perforated intervals, fracturing or stimulating, physical change, etc.

2) The well log, a systematic detailed geological record of all formations including coal encountered in the well bore

By Equitable Production Company

Date

8/11/09

OCT 23 2009

0000 45 36 W

Well Number 215181

EQT Company
WR-35 Completion Report - Attachment
Well Treatment Summary

API # 470170453600

Date	08/14/2008	Date	08/14/2008
Fract Typ	20Q Foam	Fract Typ	20Q Foam
Zone	Weir/Berea	Zone	Kecener/Injin
# of Perfs	36	# of Perfs	29
From/To	2,206—2,406	From/To	1,980—2,014
BD Press	1,894	BD Press	1,050
ATP Psi	2,229	ATP Psi	2,115
Avg Rate	32	Avg Rate	30
Max Press Psi	2,269	Max Press Psi	2,141
ISIP Psi	1,250	ISIP Psi	1,111
10min SIP	1,392	10min SIP	1,180
Fract Gradient	1.11	Fract Gradient	1.15
Sand Proppant	330.00	Sand Proppant	405.00
Water-bbl	456	Water-bbl	556
SCF N2	88,000	SCF N2	100,000
Acid-gal	500 gal 15%HCL	Acid-gal	500 gal 15%HCL

Formation Thick

Gas Tests

Depth Remarks

Previously reported