

# WEST VIRGINIA PULP & PAPER LEASE P/O 125 ACRES± WELL # 1

*James*  
*4/2/96*  
DAVIS

FORD ET.AL.

FORD ET.AL.

SEMAC INDUSTRIES, Inc  
115.95 AC.± (SURFACE)

GOURLEY

REFERENCES

FARR ET.AL.

NORTH

N/F MORRIS & SMITH

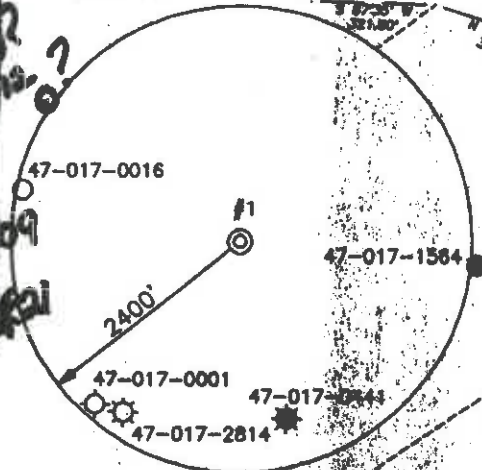

I THE UNDERSIGNED, HEREBY CERTIFY THAT THIS PLAT IS CORRECT TO THE BEST OF MY KNOWLEDGE AND BELIEF AND SHOWS ALL THE INFORMATION REQUIRED BY LAW AND THE REGULATIONS ISSUED AND PRESCRIBED BY THE DEPARTMENT OF ENERGY.

P.S. Gregory A. Smith  
677

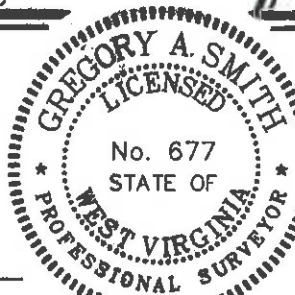

(+) DENOTES LOCATION OF WELL ON UNITED STATES TOPOGRAPHIC MAPS.  
DATE DECEMBER 4, 19 95  
OPERATORS WELL NO. W.V. PULP & PAPER #1  
API WELL NO. 47-017-04252  
STATE COUNTY PERMIT

MINIMUM DEGREE OF ACCURACY 1 / 200 FILE NO. 3465P1 (56-73)  
PROVEN SOURCE OF ELEVATION TOP OF KNOB ELEVATION 1268' SCALE 1" = 500'

STATE OF WEST VIRGINIA  
DEPARTMENT OF ENERGY  
OIL AND GAS DIVISION



WELL TYPE : OIL \_\_\_ GAS X LIQUID INJECTION \_\_\_ WASTE DISPOSAL \_\_\_ IF "GAS" PRODUCTION X STORAGE \_\_\_ DEEP \_\_\_ SHALLOW X

LOCATION :  
ELEVATION 1188' WATERSHED MIDDLE ISLAND CREEK  
DISTRICT WEST UNION COUNTY DODDRIDGE QUADRANGLE WEST UNION 7.5'

SURFACE OWNER SEMAC INDUSTRIES, Inc. ACREAGE 115.95 OF 125  
ROYALTY OWNER GLENVA MURRAY ET.AL. LEASE ACREAGE 125

PROPOSED WORK :  
DRILL X CONVERT \_\_\_ DRILL DEEPER \_\_\_ REDRILL \_\_\_ FRACTURE OR STIMULATE X PLUG OFF OLD FORMATION \_\_\_ PERFORATE NEW FORMATION \_\_\_ PLUG AND ABANDON \_\_\_ CLEAN OUT AND REPLUG \_\_\_ OTHER \_\_\_  
PHYSICAL CHANGE IN WELL (SPECIFY) \_\_\_ TARGET FORMATION ALEXANDER  
ESTIMATED DEPTH 5400'

WELL OPERATOR MURVIN OIL Corp. DESIGNATED AGENT P. NATHAN BOWLES, Jr.  
ADDRESS P.O. BOX 297 OLNEY, IL 62450 ADDRESS P.O. BOX 1386 CHARLESTON, WV 25325

6-6 91

COUNTY NAME PERMIT

RECEIVED  
WV Division of  
Environmental Protection  
SEP 12 1996

State of West Virginia  
Division of Environmental Protection  
Section of Oil and Gas

Permitting  
Office of Oil & Gas

Well Operator's Report of Well Work

Farm name: SEMAC INDUSTRIES Operator Well No.: WV.PULP/PAPER 1

LOCATION: Elevation: 1,188.00 Quadrangle: WEST UNION

District: WEST UNION County: DODDRIDGE  
Latitude: 9990 Feet South of 39 Deg. 20Min. 0 Sec.  
Longitude 3570 Feet West of 80 Deg. 47 Min. 30 Sec.

Company: MURVIN OIL COMPANY  
1712 S. WHITTLE AVE/P.O. BX297  
OLNEY, IL 62450-0297

Agent: P. NATHAN BOWLES, JR.

Inspector: MIKE UNDERWOOD  
Permit Issued: 04/03/96  
Well work Commenced: 08/21/96  
Well work Completed: 09/05/96  
Verbal Plugging  
Permission granted on: \_\_\_\_\_  
Rotary \_\_\_\_\_ Cable \_\_\_\_\_ Rig \_\_\_\_\_  
Total Depth (feet) 5656'  
Fresh water depths (ft) 55', 920'

Salt water depths (ft) \_\_\_\_\_

Is coal being mined in area (Y/N)? N  
Coal Depths (ft): \_\_\_\_\_

Casing & Tubing Size	Used in Drilling	Left in Well	Cement Fill Up Cu. Ft.
11 3/4	42	42	
8 5/8	1141	1141	377.6
4 1/2	5562	5562	600.0

OPEN FLOW DATA

Producing formation Riley/Benson/Alexander Pay zone depth (ft) 4100'-5471'  
Gas: Initial open flow show \_\_\_\_\_ MCF/d Oil: Initial open flow \_\_\_\_\_ Bbl/d  
Final open flow 1,391 MCF/d Final open flow \_\_\_\_\_ Bbl/d  
Time of open flow between initial and final tests 4 Hours  
Static rock Pressure 1450 psig (surface pressure) after 72 Hours

Second producing formation Warren/Speechly/Balltown Pay zone depth (ft) 3540'-4570'  
Gas: Initial open flow show \_\_\_\_\_ MCF/d Oil: Initial open flow \_\_\_\_\_ Bbl/d  
Final open flow 1,391 MCF/d Final open flow \_\_\_\_\_ Bbl/d  
Time of open flow between initial and final tests 4 Hours  
Static rock Pressure 1450 psig (surface pressure) after 72 Hours

NOTE: ON BACK OF THIS FORM PUT THE FOLLOWING: 1). DETAILS OF PERFORATED INTERVALS, FRACTURING OR STIMULATING, PHYSICAL CHANGE, ETC. 2). THE WELL LOG WHICH IS A SYSTEMATIC DETAILED GEOLOGICAL RECORD OF ALL FORMATIONS, INCLUDING COAL ENCOUNTERED BY THE WELLBORE.

For: MURVIN OIL COMPANY

By: Gary L. Hill  
Date: September 10, 1996

SEP 13 1996

09/03/96: Ran Sonic Bond Log and perforated Alexander Formation 5411' to 5471' (20 holes).

09/04/96: Foam fractured Alexander perfs with 420 bbls fluid, 535 MSCF Nitrogen, 60,000 lbs 20/40 and 500 gals 15% HCL acid.

Perforated Benson formation 5140' to 5141' (4holes) and Third Riley formation 5032' to 5077' (8 holes). Foam fractured perfs with 160 bbls fluid, 570 MSCF Nitrogen, 40,000 lbs 20/40 and 500 gals 15% HCL acid.

Perforated Riley formation 4700' to 4718' (11 holes) and Lower Balltown formation 4569' to 4570' (4 holes). Foam fractured perfs with 358 bbls fluid, 543 MSCF Nitrogen, 10,000 lbs 80/100, 40,000 lbs 20/40, and 750 gals 15 % HCL acid.

Perforated Upper Balltown formation 4094' to 4095' (4 holes), Speechly formation 3680' to 3681' (5 holes) and Warren formation 3540' to 3564' (11 holes). Foam fractured perfs with 338 bbls fluid, 10,000 lbs 80/100, 40,000 lbs 20/40, and 1000 gals 15% HCL acid.

WELL LOG

FORMATION	TOP	BOTTOM
Sand/Shale	10	120
Sand	120	160
Shale	160	200
Red Rock	200	292
Sand/Shale	292	2057
Little Lime	2057	2069
Shale	2069	2078
Big Lime	2078	2258
Injun	2258	2310
Shale	2310	2433
Weir	2433	2542
Shale	2542	2639
Berea	2639	2642
Shale	2642	2847
Gordon	2847	2887
Shale	2887	3501
Warren	3501	3569
Shale	3569	3582
Speechly	3582	3690
Shale	3690	3898
Balltown	3898	4574
Shale	4574	4676
Riley	4676	4744
Shale	4744	5022
Third Riley	5022	5091
Shale	5091	5138
Benson	5138	5153
Shale	5153	5386
Alexander	5386	5478
Shale	5478	5656
Total Depth	5656	

MAR 18 1996

STATE OF WEST VIRGINIA

DIVISION OF ENVIRONMENTAL PROTECTION, OFFICE OF OIL AND GAS

Permitting WELL WORK PERMIT APPLICATION  
Office of Oil & Gas

21747

Well Operator: <sup>595</sup> Murvin Oil Company 34050 (8) 671

Operator's Well Number: WV Pulp & Paper #1 3) Elevation: 1188

Well type: (a) Oil    / or Gas X / Sealed 04/03/96  
(b) If Gas: Production X / Underground Storage    / Expires 04/03/98  
Deep    / Shallow X /

Proposed Target Formation(s): <sup>435</sup> Balltown, Riley, Benson, Alexander

6) Proposed Total Depth: 5600 feet

7) Approximate fresh water strata depths: 75

8) Approximate salt water depths:   

9) Approximate coal seam depths:   

10) Does land contain coal seams tributary to active mine? Yes    / No X /

11) Proposed Well Work: Drill and Complete New Well

12)

CASING AND TUBING PROGRAM

TYPE	SPECIFICATIONS		FOOTAGE INTERVALS		CEMENT	
	Size	Grade	Weight per ft.	For drilling		Left in well
Conductor						<u>OK MU</u>
Fresh Water	8 5/8	L.S.	20/24	1140	1140	<u>CTS</u>
Coal						<u>305R/11.3</u>
Intermediate						<u>305R/11.2.2</u>
Production	4 1/2	J/K	10.5	5600	5600	400
Tubing						<u>305R/11.1</u>
Liners						

PACKERS : Kind     
Sizes     
Depths set   

For Office of Oil and Gas Use Only

Fee(s) paid:  Well Work Permit  Reclamation Fund  WPCP  
Plat  WW-9  WW-2B  Bond Surety Agent  
(Type Blanket)

**RECEIVED**  
WV Division of  
Environmental Protection

MAR 18 1996

Permitting  
Office of Oil & Gas

- 1) Date: March 11, 1996
- 2) Operator's well number  
WV Pulp and Paper #1
- 3) API Well No: 47 - 017 - 4252  
State County Permit

**STATE OF WEST VIRGINIA - BUREAU OF ENVIRONMENT  
DIVISION OF ENVIRONMENTAL PROTECTION  
OFFICE OF OIL AND GAS**

**NOTICE AND APPLICATION FOR A WELL WORK PERMIT**

- 4) Surface Owner(s) to be served:
  - (a) Name SEMAC Industries  
Address 7100 CR 407  
Millersburg, Ohio 44654
  - (b) Name \_\_\_\_\_  
Address \_\_\_\_\_
  - (c) Name \_\_\_\_\_  
Address \_\_\_\_\_
- 5) (a) Coal Operator:
  - Name N/A  
Address \_\_\_\_\_
  - (b) Coal Owner(s) with Declaration  
Name N/A  
Address \_\_\_\_\_
  - Name \_\_\_\_\_  
Address \_\_\_\_\_
  - (c) Coal Lessee with Declaration  
Name N/A  
Address \_\_\_\_\_
- 6) Inspector Mr. Mike Underwood  
Address Route 2, Box 135  
Salem, West Virginia 26426  
Telephone (304)-782-1043

**TO THE PERSON(S) NAMED ABOVE TAKE NOTICE THAT:**

Included is the lease or leases or other continuing contract or contracts by which I hold the right to extract oil and gas OR  
X Included is the information required by Chapter 22, Article 6, Section 8(d) of the Code of West Virginia (see page 2)

I certify that as required under Chapter 22 of the West Virginia Code I have served copies of this notice and application, a location plat, and accompanying documents pages 1 through 8 on the above named parties, by:

- Personal Service (Affidavit attached)
- X Certified Mail (Postmarked postal receipt attached)
- Publication (Notice of Publication attached)

I have read and understand Chapter 22-6 and 38 CSR 11-18, and I agree to the terms and conditions of any permit issued under this application.

I certify under penalty of law that I have personally examined and am familiar with the information submitted on this application form and all attachments, and that based on my inquiry of those individuals immediately responsible for obtaining the information, I believe that the information is true, accurate, and complete.

I am aware that there are significant penalties for submitting false information, including the possibility of fine and imprisonment.

Well Operator Murvin Oil Company  
By: Gary A. Hill  
Its: Executive Vice President  
Address P.O. Box 297  
Olney, Illinois 62450  
Telephone 618-393-2124

Subscribed and sworn before me this 11th day of March, 1996

Barbara A. Hill Notary Public  
My commission expires November 9, 1996