

LATITUDE

39° 20' 00"

80° 50' 00"

LONGITUDE

7'5 OGIS topo location

7.5' loc 2.365
.32 w

15' loc _____
(calc.) _____

Company _____

Farm _____

Quad West Union

County Dodd

District Central

WELL LOCATION MAP

File No. 17-3975

INSTRUCTIONS

1) Attach a photo copy of the location of the well on a 7.5 minute Quadrangle with the corresponding Longitude and Latitude.
 2) Designate the location of the well with the symbol (+).

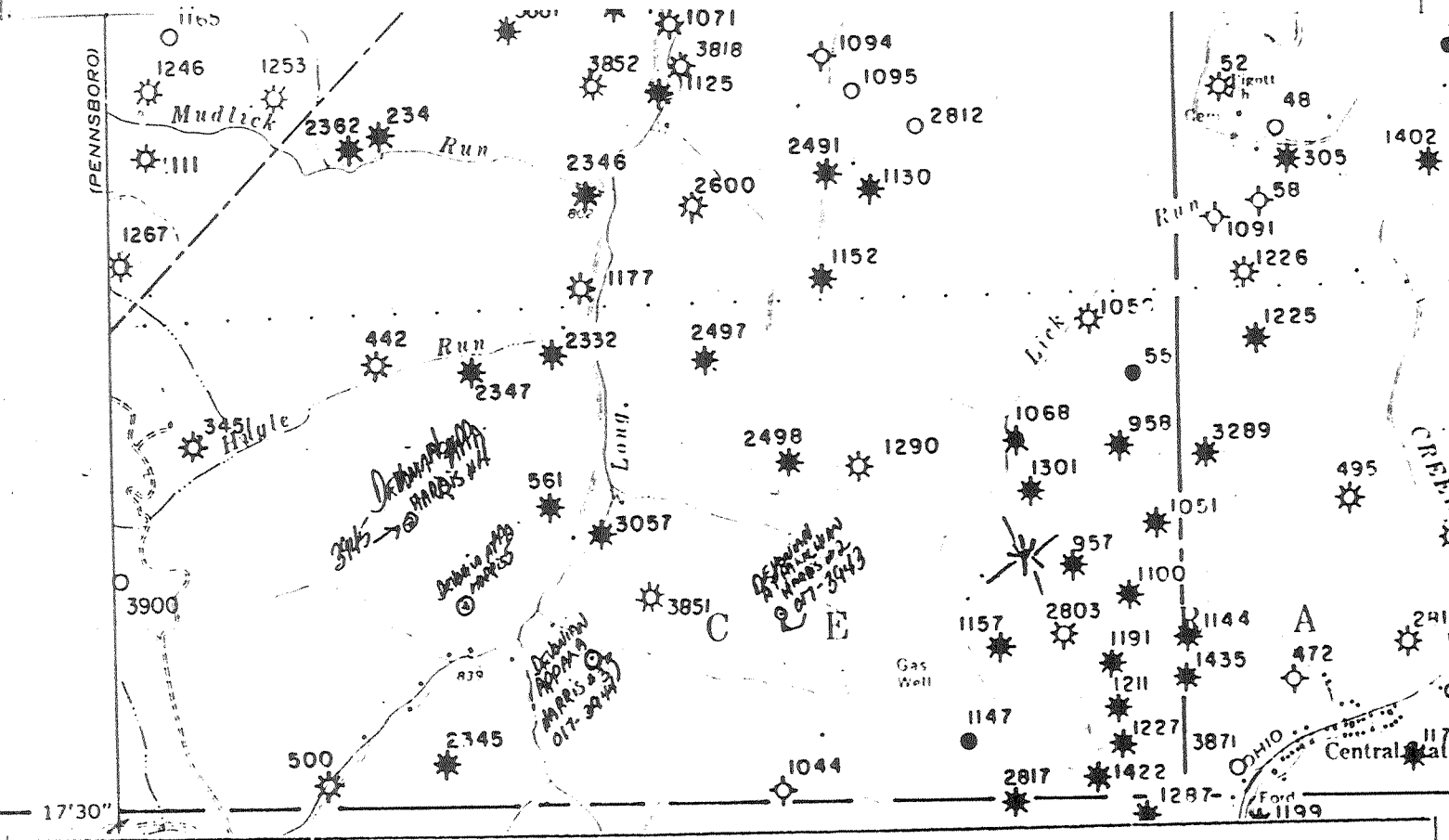

I, the undersigned, hereby certify that this plat is correct to the best of my knowledge and belief.

SIGNED Louell P BEE

TITLE Pres

DATE May 21, 19 92

OPERATORS WELL NO. D.L. PIGOTT

API WELL NO. 017-3975

STATE OF WEST VIRGINIA
 DEPARTMENT OF ENERGY
 OIL AND GAS DIVISION

WELL TYPE: OIL GAS LIQUID INJECTION _____ WASTE DISPOSAL _____
 (IE "GAS" PRODUCTION _____ STORAGE _____ DEEP _____ SHALLOW _____)

LOCATION: ELEVATION 1080 WATER SHED LICK RUN
 DISTRICT CENTRAL COUNTY DODDRIDGE
 QUADRANGLE WEST UNION

SURFACE OWNER JOSEPH H BAILI ACREAGE _____

OIL & GAS ROYALTY OWNER _____ LEASE ACREAGE 81.13
 LEASE NO. _____

PRODUCING FORMATION BIG INJUN TOTAL DEPTH NO RECORD JUST PURCHASED

WELL OPERATOR BEECHLICK OIL, INC. DESIGNATED AGENT LOUELL P BEE

ADDRESS RT 3 BOX 26 ADDRESS RT 3 BOX 62

SALEM, WV 26426 SALEM, WV 26426

JUL 21 1992