

INSTRUCTIONS

1) Attach a photo copy of the location of the well on a 7.5 minute Quadrangle with the corresponding Longitude and Latitude.  
 2) Designate the location of the well with the symbol(+).

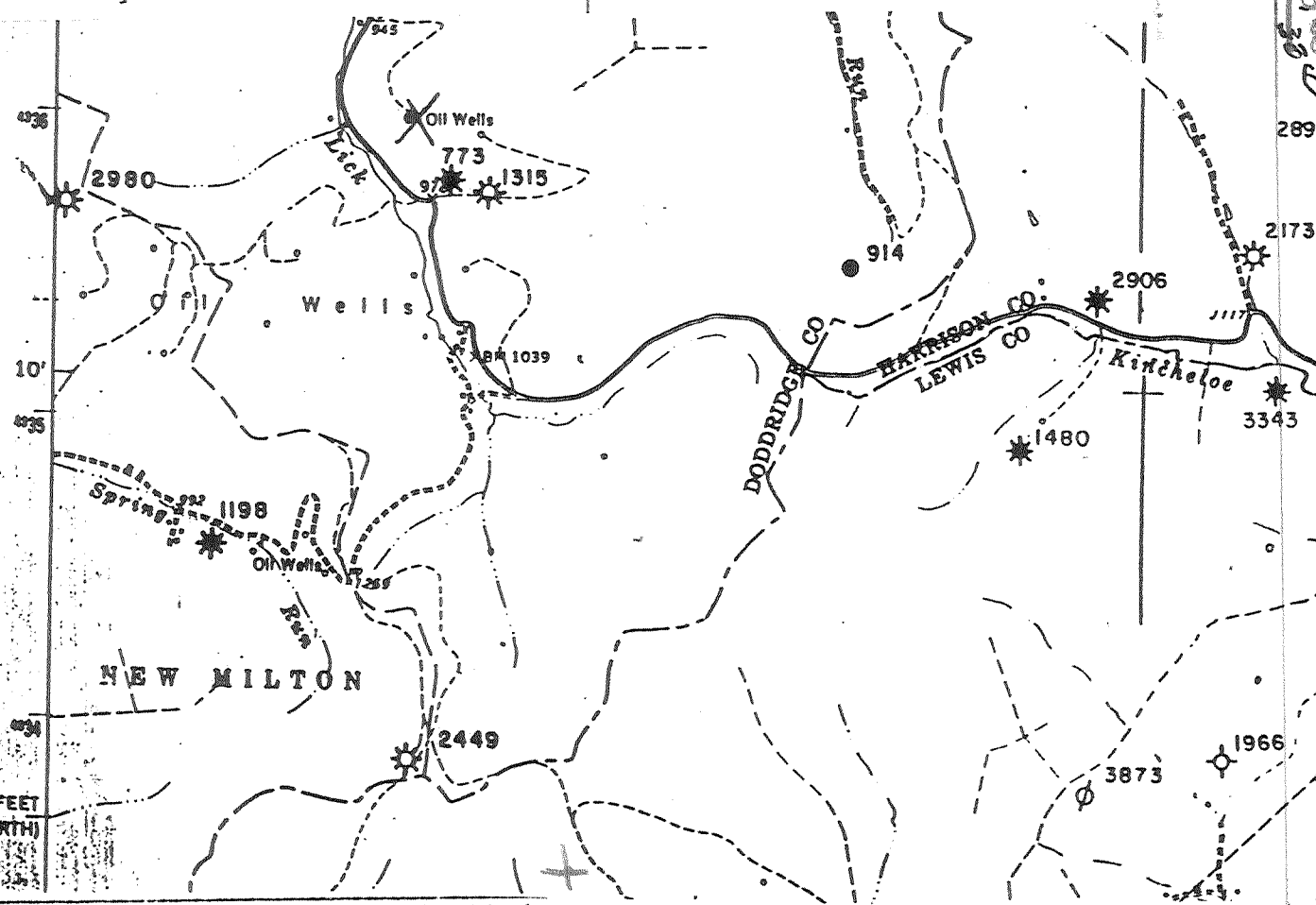

I, the undersigned, hereby certify that this plat is correct to the best of my knowledge and belief.

2335  
1490

SIGNED Lowell P Bee

TITLE Pres.

DATE May 15, 19 92

OPERATORS WELL NO. STALWAKER 7

API WELL NO. 017-3972

STATE OF WEST VIRGINIA  
 DEPARTMENT OF ENERGY  
 OIL AND GAS DIVISION

WELL TYPE: OIL  GAS  LIQUID INJECTION \_\_\_\_\_ WASTE DISPOSAL \_\_\_\_\_  
 (IE "GAS" PRODUCTION  STORAGE \_\_\_\_\_ DEEP \_\_\_\_\_ SHALLOW \_\_\_\_\_)

LOCATION: ELEVATION 1260 WATER SHED BEECHLICK RUN  
 DISTRICT GREENBRIER COUNTY Doddridge  
 QUADRANGLE Big ISAAC

SURFACE OWNER RAIPH MORGAN ACREAGE \_\_\_\_\_

OIL & GAS ROYALTY OWNER \_\_\_\_\_ LEASE ACREAGE 290  
 LEASE NO. \_\_\_\_\_

PRODUCING FORMATION Big INJUN TOTAL DEPTH 2388

WELL OPERATOR BEECHLICK O.I. INC. DESIGNATED AGENT Lowell P BEE

ADDRESS RT 3 Box 26 ADDRESS RT 3 Box 62  
SALEM, WV 26426 SALEM, WV 26426

JUL 21 1992