

Jamie 11/30/89

9650'

LATITUDE 39° 22' 30"

BODE

PETROVICH

3747

STONE

N87°W, 1287'

S3°15'W,
415.84

SET STONE
(FOUND)

N22°40'W,
1890.61'

S13°30'E,
2178'

1.32S
1.81W

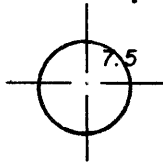

BAGLEY,
ET. AL.

NO. 1

S29°29'E,
1527.40'

RYMER

ZIEGENFUSS

LONGITUDE 80° 45' 00"

7035'

WELL REFERENCES:

- N62°W, 137' TO 6" WILD CHERRY
- N12°E, 100' TO 4" ELM

W Union EC
4.20 S
1.81 W

LAND SURVEYING SERVICES
21 CEDAR LANE
BRIDGEPORT, WV 26330
PHONE: 304-842-2018

(+) DENOTES LOCATION OF WELL ON UNITED STATES TOPOGRAPHIC MAPS

FILE NO. _____
 DRAWING NO. _____
 SCALE 1" = 500'
 MINIMUM DEGREE OF
 ACCURACY 1 IN 200
 PROVEN SOURCE OF
 ELEVATION TOP OF KNOB 2500' SE
OF LOC. AT ELEV. 1236'

I THE UNDERSIGNED, HEREBY CERTIFY THAT
 THIS PLAT IS CORRECT TO THE BEST OF MY
 KNOWLEDGE AND BELIEF AND SHOWS ALL THE
 INFORMATION REQUIRED BY LAW AND THE REGU-
 LATIONS ISSUED AND PRESCRIBED BY THE DEPART-
 MENT OF ENERGY.
 (SIGNED) _____

R.P.E. _____ L.L.S. NO. 674
STEPHEN D. LOSH

PLACE SEAL HERE

STATE OF WEST VIRGINIA
DEPARTMENT OF ENERGY
OIL AND GAS DIVISION



DATE AUGUST 28, 19 89
OPERATOR'S WELL NO. FREEMAN BROS I
API WELL NO.

47 - 017 - 3763
STATE COUNTY PERMIT

WELL TYPE: OIL ___ GAS X LIQUID INJECTION ___ WASTE DISPOSAL ___
 (IF "GAS,") PRODUCTION X STORAGE ___ DEEP ___ SHALLOW X
 LOCATION: ELEVATION 940' WATERSHED CAMP MISTAKE RUN
 DISTRICT West Union 8 COUNTY DODDRIDGE
 QUADRANGLE WEST UNION

SURFACE OWNER ANDREW FREEMAN HRS. ACREAGE 88.65
 OIL & GAS ROYALTY OWNER ANDREW FREEMAN HRS. LEASE ACREAGE 300.
 LEASE NO. _____

PROPOSED WORK: DRILL X CONVERT ___ DRILL DEEPER ___ REDRILL ___ FRACTURE OR
 STIMULATE ___ PLUG OFF OLD FORMATION ___ PERFORATE NEW
 FORMATION ___ OTHER PHYSICAL CHANGE IN WELL (SPECIFY) _____

PLUG AND ABANDON ___ CLEAN OUT AND REPLUG ___

TARGET FORMATION BENSON ESTIMATED DEPTH 5300'

WELL OPERATOR STONEWALL GAS CO. DESIGNATED AGENT JESSE SHELL

ADDRESS P.O. DRAWER R ADDRESS P.O. DRAWER R

JANE LEW, WV 26378-0080

847

JANE LEW, WV 2637-0080

COUNTY NAME PERMIT

State of West Virginia
DEPARTMENT OF ENERGY
Division of Oil and Gas

Freeman Brothers

Well Operator's Report of Well Work

Farm name: FREEMAN, ANDREW HEIRS Operator Well No.: 1-426-S

LOCATION: Elevation: 940.00 Quadrangle: WEST UNION

District: WESTUNION County: DODDRIDGE
Latitude: 7035 Feet South of 39 Deg. 22Min. 30 Sec.
Longitude 9650 Feet West of 80 Deg. 45 Min. 0 Sec.

RECEIVED
Division of Oil and Gas
SEPT 12 1990
Permitting

Company: STONEWALL GAS CO.
P. O. BOX 1575
RICHMOND, VA 23213-1575

Agent: JESSE A. SHELL

Inspector: MIKE UNDERWOOD
Permit Issued: 12/06/89
Well work Commenced: 08-01-90
Well work Completed: 08-04-90
Verbal Plugging
Permission granted on: _____
Rotary X Cable _____ Rig _____
Total Depth (feet) 5050
Fresh water depths (ft) 14

Salt water depths (ft) _____
581 & 835

Is coal being mined in area (Y/N)? N
Coal Depths (ft): N/A

Casing & Tubing Size	Used in Drilling	Left in Well	Cement Fill Up Cu. Ft.
11 3/4	127	127	75 SKS
8 5/8	1215	1215	285 SKS
4 1/2	5002	5002	710 SKS

OPEN FLOW DATA

Producing formation BENSON Pay zone depth (ft) 4871
Gas: Initial open flow 0 MCF/d Oil: Initial open flow 0 Bbl/d
Final open flow 984 MCF/d Final open flow 0 Bbl/d
Time of open flow between initial and final tests 1 Hours
Static rock Pressure 1050* psig (surface pressure) after 168 Hours

Second producing formation RILEY Pay zone depth (ft) 4439
Gas: Initial open flow 0 MCF/d Oil: Initial open flow 0 Bbl/d
Final open flow 984 MCF/d Final open flow 0 Bbl/d
Time of open flow between initial and final tests 1 Hours
Static rock Pressure 1050* psig (surface pressure) after 168 Hours

* LOW ROCK PRESSURE DUE TO 20 BBLs OF FRAC FLUID IN WELL

NOTE: ON BACK OF THIS FORM PUT THE FOLLOWING: 1). DETAILS OF PERFORATED INTERVALS, FRACTURING OR STIMULATING, PHYSICAL CHANGE, ETC. 2). THE WELL LOG WHICH IS A SYSTEMATIC DETAILED GEOLOGICAL RECORD OF ALL FORMATIONS, INCLUDING COAL ENCOUNTERED BY THE WELLBORE.

For: STONEWALL GAS CO.
By: [Signature] PETROLEUM ENGINEER
Date: SEPTEMBER 5, 1990

SEP 14 1990

STAGE 2	FRAC	WATER	DATE	08-15-90		
ZONES	PERFS		HOLES	BBL	BP	ISIP
BENSON	4871-4876		15	700	1810	1580
RILEY	4439-4443		16	500	3460	1720
FORMATION	COLOR		HARD/SOFT	TOP	BOTTOM	REMARKS
RED ROCK & SHALE	GRAY	SOFT	0	12		
SAND & SHALE	GRAY	SOFT	12	30		
SAND	BROWN	HARD	30	65		
RR & SHALE	GRAY	HARD	65	120		
SAND	BROWN	SOFT	120	190		
SAND & SHALE	GRAY	SOFT	190	297		
COAL	GRAY	SOFT	297	304		
SAND & SHALE	BROWN	HARD	304	325		
RR & SHALE	GRAY	HARD	325	338		
SAND & SHALE	BROWN	SOFT	338	563		
COAL	GRAY	SOFT	563	566		
SAND	BROWN	SOFT	566	585		
SAND & SHALE	GRAY	HARD	585	727		
RR & SHALE	GRAY	HARD	727	835		
SAND & SHALE	BROWN	HARD	835	1367		
WHITE SAND	WHITE	HARD	1367	1488		
SAND & SHALE	GRAY	HARD	1488	1770		
LITTLE LIME	BROWN	SOFT	1770	1783		
SHALE	GRAY	SOFT	1783	1795		
BIG LIME	BROWN	SOFT	1795	1900		
BIG INJUN	GRAY	SOFT	1900	2012		
SAND & SHALE	GRAY	HARD	2012	2560		
GORDON	BROWN	HARD	2560	2587		
SAND & SHALE	BROWN	SOFT	2587	4428		
RILEY	BROWN	SOFT	4428	4490		
SAND & SHALE	GRAY	SOFT	4490	4880		
BENSON	BROWN	SOFT	4880	4890		
SAND & SHALE	BROWN	SOFT	4890	5050		
TD			5050			

7985

017-3763
 issued 12/06/89

Page ___ of ___

STATE OF WEST VIRGINIA expires 12/06/91
 DEPARTMENT OF ENERGY, DIVISION OF OIL AND GAS
 WELL WORK PERMIT APPLICATION

- 1) Well Operator: STONEWALL GAS COMPANY ⁸⁴⁷ 47850 (8) 670
- 2) Operator's Well Number: FREEMAN BRO. #1 (426-S) 3) Elevation: 940'
- 4) Well type: (a) Oil ___ / or Gas X /
 (b) If Gas: Production X / Underground Storage ___ /
 Deep ___ / Shallow X /
- 5) Proposed Target Formation(s): BENSON 425
- 6) Proposed Total Depth: 5000' feet
- 7) Approximate fresh water strata depths: 190', 242'
- 8) Approximate salt water depths: 1420', 1415', 985'
- 9) Approximate coal seam depths: N/A possible coal at 300'-304', 568'-573'
- 10) Does land contain coal seams tributary to active mine? Yes ___ / No X /
- 11) Proposed Well Work: Drill & Stimulate New Well
- 12)

CASING AND TUBING PROGRAM

TYPE	SPECIFICATIONS			FOOTAGE INTERVALS		CEMENT
	Size	Grade	Weight per ft.	For drilling	Left in well	Fill-up (cu. ft.)
Conductor	11 3/4		28	130	130 CTS	38CSR18-11.3
Fresh Water						
Coal						38CSR18-11.2 ^{ok}
Intermediate	8 5/8	ERW	23	1232	1232 CTS	38CSR18-11.2.2
Production	4 1/2	ERW	10.5	5000	5000	38CSR18-11.1
Tubing						
Liners						

RECEIVED
 NOV 20 1989

PACKERS : Kind _____
 Sizes _____
 Depths set _____

DIVISION OF OIL & GAS
 DEPARTMENT OF ENERGY

For Division of Oil and Gas Use Only

608
 29
 Fee(s) paid: Plat WW-9 WW-2B Bond Blanket sure Agent
Plat WW-9 WW-2B Bond Blanket sure Agent

RECEIVED
NOV 20 1989

Page 1 of _____
Form WW2-A
(09/87)
File Copy

DIVISION OF OIL & GAS
DEPARTMENT OF ENERGY

1) Date: NOVEMBER 16, 1989
2) Operator's well number
FREEMAN BROTHERS #1 (426-S)
3) API Well No: 47 - 017 - 3763
State - County - Permit

STATE OF WEST VIRGINIA
DEPARTMENT OF ENERGY, DIVISION OF OIL AND GAS

NOTICE AND APPLICATION FOR A WELL WORK PERMIT

4) Surface Owner(s) to be served:
(a) Name ANDREW FREEMAN HRS.
Address C/O EDITH SMITH WHITE
701 MARYLAND AVE., FAIRMONT, WV

(b) Name _____
Address _____

(c) Name _____
Address _____

6) Inspector MIKE UNDERWOOD
Address RT 2 BOX 135
SALEM, WV 26426
Telephone (304)-782-1043

5) (a) Coal Operator:
Name N/A
Address _____

(b) Coal Owner(s) with Declaration
Name SEE ATTACHED SHEET
Address _____

Name _____
Address _____

(c) Coal Lessee with Declaration
Name _____
Address _____

TO THE PERSON(S) NAMED ABOVE TAKE NOTICE THAT:

_____ Included is the lease or leases or other continuing contract or contracts by which I hold the right to extract oil and gas OR

X Included is the information required by Chapter 22B, Article 1, Section 8(d) of the Code of West Virginia (see page 2)

I certify that as required under Chapter 22B of the West Virginia Code I have served copies of this notice and application, a location plat, and accompanying documents pages 1 through _____ on the above named parties, by:

- _____ Personal Service (Affidavit attached)
- X Certified Mail (Postmarked postal receipt attached)
- _____ Publication (Notice of Publication attached)

I have read and understand Chapter 22B and 38 CSR 11-18, and I agree to the terms and conditions of any permit issued under this application.

I certify under penalty of law that I have personally examined and am familiar with the information submitted on this application form and all attachments, and that based on my inquiry of those individuals immediately responsible for obtaining the information, I believe that the information is true, accurate, and complete.

I am aware that there are significant penalties for submitting false information, including the possibility of fine and imprisonment.

Well Operator STONEWALL GAS COMPANY
By: Beja A. Hunt
Its: PRESIDENT
Address PO DRAWER R
JANE LEW, WV 26378
Telephone 304/884-7881

Subscribed and sworn before me this 16TH day of NOVEMBER, 1989

Richard K. Davis
My commission expires

OCTOBER 14, 1993

XXXXXXXXXXXX

Commissioner of West Virginia