

WELL REFERENCES: *Jamie 6/12/89*
N83°E, 97.5' TO 6" SOURWOOD
S7°W, 112' TO 7" RED MAPLE

DOTSON

TYLER CO.

DODDRIDGE CO.

STEPHEN PITTS
77 AC.

REED

*3.63
1.50*

PITTS

TIE LINES:

- A) N64°44'E, 428.40'
- B) S34°45'E, 235.91'
- C) N88°47'W, 522.04'

ELMORE

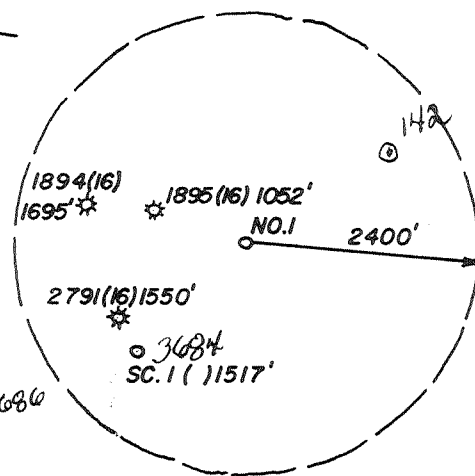

N56°W, 363'

NO. 1

S26°30'W, 264'

ROCK

STONE & 14" HICKORY

S87°W, 429'

ZIEGENFUSS

N74°30'W, 99'

LAND SURVEYING SERVICES
21 CEDAR LANE
BRIDGEPORT, WV 26330
PHONE: 304-842-2018

(+) DENOTES LOCATION OF WELL ON UNITED STATES TOPOGRAPHIC MAPS

FILE NO. _____
 DRAWING NO. _____
 SCALE 1" = 500'
 MINIMUM DEGREE OF ACCURACY 1 IN 200
 PROVEN SOURCE OF ELEVATION TOP OF KNOB 1485'
NE. OF LOC. AT ELEV. 1307'

I THE UNDERSIGNED, HEREBY CERTIFY THAT THIS PLAT IS CORRECT TO THE BEST OF MY KNOWLEDGE AND BELIEF AND SHOWS ALL THE INFORMATION REQUIRED BY LAW AND THE REGULATIONS ISSUED AND PRESCRIBED BY THE DEPARTMENT OF ENERGY.

(SIGNED) *[Signature]*
 R.P.E. _____ L.L.S. NO. 674
STEPHEN D. LOSH

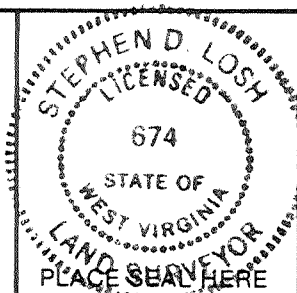

STATE OF WEST VIRGINIA
 DEPARTMENT OF ENERGY
 OIL AND GAS DIVISION



DATE JULY 18, 19 88
 OPERATOR'S WELL NO. PITTS NO. 1
 API WELL NO. 47-017-3727
 STATE COUNTY PERMIT

WELL TYPE: OIL ___ GAS X LIQUID INJECTION ___ WASTE DISPOSAL ___
 (IF "GAS,") PRODUCTION X STORAGE ___ DEEP ___ SHALLOW X
 LOCATION: ELEVATION 1219' WATER SHED SANDY RUN
 DISTRICT GRANT 3 COUNTY DODDRIDGE
 QUADRANGLE WEST UNION 7.5' 671 1336 +15' EC
 SURFACE OWNER ERMA PITTS ACREAGE 77
 OIL & GAS ROYALTY OWNER STEPHEN PITTS LEASE ACREAGE 227
 LEASE NO. _____

PROPOSED WORK: DRILL X CONVERT ___ DRILL DEEPER ___ REDRILL ___ FRACTURE OR STIMULATE ___ PLUG OFF OLD FORMATION ___ PERFORATE NEW FORMATION ___ OTHER PHYSICAL CHANGE IN WELL (SPECIFY) _____

PLUG AND ABANDON ___ CLEAN OUT AND REPLUG ___
 TARGET FORMATION BENSON ESTIMATED DEPTH 5500'
 WELL OPERATOR STONEWALL GAS CO. DESIGNATED AGENT CHARLES CANFIELD
 ADDRESS P.O. DRAWER R ADDRESS P.O. DRAWER R
JANE LEW, WV 26378-0080 847 JANE LEW, WV 26378-0080

JUN 26 1989

JAN 04 1990

State of West Virginia
DEPARTMENT OF ENERGY
Division of Oil and Gas
DEPARTMENT OF ENERGY
Well Operator's Report of Well Work

Farm name: PITTS, ERMA MABEL Operator Well No.: PITTS 1 381-S

LOCATION: Elevation: 1219.00 Quadrangle: WEST UNION

District: GRANT County: DODDRIDGE
Latitude: 4000 Feet South of 39 Deg. 22Min. 30 Sec.
Longitude: 7975 Feet West of 80 Deg. 45 Min. 0 Sec.

Company: STONEWALL GAS CO.
P. O. BOX 1575
RICHMOND, VA 23213-1575

Agent: JESSE A. SHELL

Inspector: MIKE UNDERWOOD
Permit Issued: 06/19/89
Well work Commenced: 12-03-89
Well work Completed: 12-09-89
Verbal Plugging
Permission granted on:
Rotary Cable _____ Rig
Total Depth (feet) 5459
Fresh water depths (ft) 250

Casing & Tubing Size	Used in Drilling	Left in Well	Cement Fill Up Cu. Ft.
11 3/4	170	170	90 sks
8 5/8	1418	1418	340 sks
4 1/2	5285	5285	718 sks

Salt water depths (ft) 1650

Is coal being mined in area (Y/N)? n
Coal Depths (ft): n/a

OPEN FLOW DATA

Producing formation BENSON Pay zone depth (ft) 5160
Gas: Initial open flow 189 MCF/d Oil: Initial open flow 0 Bbl/d
Final open flow 1100 MCF/d Final open flow 0 Bbl/d
Time of open flow between initial and final tests 1 Hours
Static rock Pressure 1625 psig (surface pressure) after 168 Hours

Second producing formation RILEY Pay zone depth (ft) 4720
Gas: Initial open flow 189 MCF/d Oil: Initial open flow 0 Bbl/d
Final open flow 1100 MCF/d Final open flow 0 Bbl/d
Time of open flow between initial and final tests 1 Hours
Static rock Pressure 1625 psig (surface pressure) after 168 Hours

NOTE: ON BACK OF THIS FORM PUT THE FOLLOWING: 1). DETAILS OF PERFORATED INTERVALS, FRACTURING OR STIMULATING, PHYSICAL CHANGE, ETC. 2). THE WELL LOG WHICH IS A SYSTEMATIC DETAILED GEOLOGICAL RECORD OF ALL FORMATIONS, INCLUDING COAL ENCOUNTERED BY THE WELLBORE.

For: STONEWALL GAS CO.

By: [Signature]
Date: DECEMBER 19, 1989

JAN 05 1990

SAND & WATER 2

FRAC	STAGE	DATE	DECEMBER 14, 1989			
ZONES	PERFS	HOLES	BBL	SAND	BD	ISIP
BENSON	5162-5168	18	800	80,000	2950	1700
RILEY	4724-4728	12	500	50,000	2950	1700
FORMATION	COLOR	HARD/SOFT	TOP FT	BOTTOM FT	REMARKS	
RR & SHALE	BROWN	HARD	0	30	1/2 " H ₂ O 250'	
SAND	GREY	SOFT	30	75	DUST @ 1505	
SAND & SHALE	BROWN	HARD	75	120		
RR & SHALE	RED	HARD	120	128	GAS CK 2084 NO SHOW	
SAND & SHALE	BROWN	HARD	128	230		
SAND	GREY	SOFT	230	250	GAS CK 2148 NO SHOW	
SAND & SHALE	GREY	SOFT	250	450		
SAND	BROWN	SOFT	450	500	CAS CK 2210 GAS ODOR	
SAND & SHALE	BROWN	HARD	500	650		
SHALE	GREY	HARD	650	750	GAS CK 2335 ODOR	
RR	RED	HARD	750	780	GAS CK 2866 ODOR	
SAND & SHALE	BROWN	SOFT	780	835		
RR	RED	HARD	835	895	GAS CK 2927 4/10 2"	
SAND & SHALE	GREY	SOFT	895	915	W/WATER	
SHALE	GREY	HARD	915	960		
RR	RED	HARD	960	1070	GAS CK 5241 GOOD ODO	
SHALE	GREY	HARD	1070	1190		
RR	RED	HARD	1190	1215	GAS CK D.C. 20/10 2"	
SAND	TAN	SOFT	1215	1270	W/WATER	
SAND & SHALE	BROWN	SOFT	1270	1415		
SAND	TAN	SOFT	1415	1460		
SAND & SHALE	BROWN	SOFT	1460	1620		
SAND (WHITE)	WHITE	HARD	1620	1850		
SAND & SHALE	GREY	HARD	1850	2070		
LIME	GREY	SOFT	2070	2180		
INJUN	BROWN	SOFT	2180	2360		
SAND & SHALE	GREY	HARD	2360	2580		
SAND	TAN	SOFT	2580	2745		
SHALE	GREY	HARD	2745	2750		
SAND & SHALE	BROWN	MED	2750	2870		
GORDON	BROWN	HARD	2870	2945		
SAND	GREY	SOFT	2945	2985		
SAND & SHALE	GREY	SOFT	2985	3580		
SAND	BROWN	SOFT	3580	3625		
SAND & SHALE	GREY	MED	3625	3750		
SAND	GREY	SOFT	3750	4715		
RILEY	GREY	HARD	4715	4755		
SAND & SHALE	BROWN	SOFT	4755	5180		
BENSON	BROWN	SOFT	5180	5230		
SAND & SHALE	BROWN	SOFT	5230	5450		
TD	5450					

STATE OF WEST VIRGINIA
DEPARTMENT OF ENERGY, DIVISION OF OIL AND GAS
WELL WORK PERMIT APPLICATION

- 1) Well Operator: STONEWALL GAS COMPANY *49850, 3, 670*
- 2) Operator's Well Number: PITTS #1 (381-S) 3) Elevation: 1219
- 4) Well type: (a) Oil / or Gas /
(b) If Gas: Production / Underground Storage
Deep / Shallow
- 5) Proposed Target Formation(s): BENSON
- 6) Proposed Total Depth: 5300 feet
- 7) Approximate fresh water strata depths: 110' *201', 229'*
- 8) Approximate salt water depths: 1230' *1649', 1964'*
- 9) Approximate coal seam depths: N/A *Possible seam 947'-952'*
- 10) Does land contain coal seams tributary to active mine? Yes / No
- 11) Proposed Well Work: *Drill & Stimulate New Well*
- 12)

CASING AND TUBING PROGRAM

TYPE	SPECIFICATIONS		FOOTAGE INTERVALS		CEMENT	
	Size	Grade	Weight per ft.	For drilling		Left in well
Conductor	11 3/4	ERW	42#	155' 20"	<i>cts</i> 155' 20"	38 CSR 18-11.3
Fresh Water						38 CSR 18-11.2.2
Coal						<i>cts</i>
Intermediate	8 5/8	ERW	23#	1400'	1400'	38 CSR 18-11.3
Production	4 1/2	ERW	10.5#	5250'	5250'	38 CSR 18-11.1
Tubing						
Liners						

RECEIVED
JUN 02 1989

PACKERS : Kind _____
Sizes _____
Depths set _____

For Division of Oil and Gas Use Only
DIVISION OF OIL & GAS
DEPARTMENT OF ENERGY

Fee(s) paid: Well Work Permit Reclamation Fund WPCP
Plat WW-9 WW-2B Bond *Blanket Sure* Agent
(Type)

5142
0395
02

RECEIVED
JUN 02 1989

Date: MAY 30, 1989
Operator's well number
PITTS #1 381-S
API Well No: 47 - 017 - 3727
State - County - Permit

DIVISION OF OIL & GAS
DEPARTMENT OF ENERGY

STATE OF WEST VIRGINIA
DEPARTMENT OF ENERGY, DIVISION OF OIL AND GAS

NOTICE AND APPLICATION FOR A WELL WORK PERMIT

4) Surface Owner(s) to be served:
(a) Name ERMA MABEL PITTS
Address CP STAR ROUTE BOX 171
WEST UNION, WV 26456

(b) Name _____
Address _____

(c) Name _____
Address _____

6) Inspector MIKE UNDERWOOD
Address RT 2 BOX 135
SALEM, WV 26426
Telephone (304)- 782-1043

5) (a) Coal Operator:
Name N/A
Address _____

(b) Coal Owner(s) with Declaration
Name SAME AS SURFACE
Address _____

Name _____
Address _____

(c) Coal Lessee with Declaration
Name N/A
Address _____

TO THE PERSON(S) NAMED ABOVE TAKE NOTICE THAT:

_____ Included is the lease or leases or other continuing contract or contracts by which I hold the right to extract oil and gas OR
X Included is the information required by Chapter 22B, Article 1, Section 8(d) of the Code of West Virginia (see page 2)

I certify that as required under Chapter 22B of the West Virginia Code I have served copies of this notice and application, a location plat, and accompanying documents pages 1 through _____ on the above named parties, by:

- _____ Personal Service (Affidavit attached)
- X Certified Mail (Postmarked postal receipt attached)
- _____ Publication (Notice of Publication attached)

I have read and understand Chapter 22B and 38 CSR 11-18, and I agree to the terms and conditions of any permit issued under this application. I certify under penalty of law that I have personally examined and am familiar with the information submitted on this application form and all attachments, and that based on my inquiry of those individuals immediately responsible for obtaining the information, I believe that the information is true, accurate, and complete.

I am aware that there are significant penalties for submitting false information, including the possibility of fine and imprisonment.

Well Operator STONEWALL GAS COMPANY
By: [Signature]
Its: PRESIDENT
Address PO DRAWER R
JANE LEW, WV 26378-0080
Telephone 304-884-7881

Subscribed and sworn before me this 31ST day of MAY, 19 89

[Signature]
My commission expires OCTOBER 14, 93

Commissioner Of West Virgin
~~XXXXX~~