

James 7/25/88

1875'

(-|-) DENOTES LOCATION OF WELL ON U.S.G.S. TOPOGRAPHIC MAP

LATITUDE 39°12'30"

LONGITUDE 80°37'30"

11,525'

ELTON D. PATTON
52.00 AC.

N 37°30' W
534.6'

N 55°57' W
251.70'

N 48°30' E
594.0'

PROP WELL
CNGD 3405

N 37° E 181.5'
STO. PILE

N 21°38' W 431.65'

N 10°45' E 265.00'
STO. PILE

N 32°30' E 148.5'

ETHEL MAE GREATHOUSE
42.60 AC.

S 45°00' E 2900'

N 54°30' E 219.12'

N 66°30' E 280.5'

N 54° E 82.5'
N 53°30' E 123.75'

PAUL DOUGLASS
FARR II
11.00 AC.

N 30° E 1023'

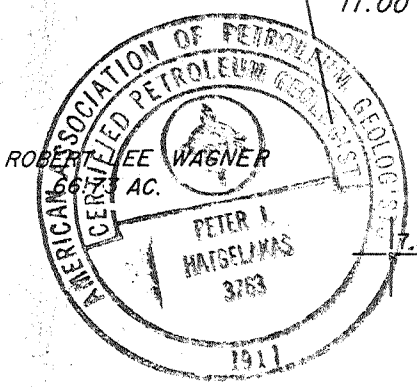

MAGNETIC REFERENCE TIES

S 51°28' E 251.70' TO STO. PILE W/C.O. PTR.
S 57°00' E 169.18' TO 16" C.O. ON RIDGE

MSES consultants, inc.
FILE NO. MSES 88 - 823
DRAWN BY RRC/VSH
SCALE 1" = 500'
MIN. DEGREE OF ACCURACY 1 IN 2500
PROVEN SOURCE OF ELEVATION:
ELEV. 896' AT JUNCTION OF
ROUTES 58 & 60

I, THE UNDERSIGNED, HEREBY CERTIFY THAT THIS PLAT IS CORRECT TO THE BEST OF MY KNOWLEDGE AND BELIEF AND SHOWS ALL THE INFORMATION REQUIRED BY LAW AND THE REGULATIONS ISSUED AND PRESCRIBED BY THE DEPARTMENT OF MINES.

(SIGNED) John S. Bailey
R.P.E. _____ L.L.S. 652

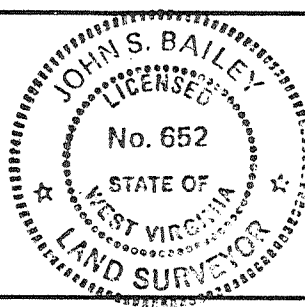

STATE OF WEST VIRGINIA
DEPARTMENT OF MINES
OIL AND GAS DIVISION



DATE MAY 19, 1988
OPERATOR'S WELL NO. CNGD 3405
API WELL NO. 47 - 017 - 3661
STATE COUNTY PERMIT

WELL TYPE: OIL GAS LIQUID INJECTION WASTE DISPOSAL Cancelled
IF "GAS", PRODUCTION STORAGE DEEP SHALLOW

LOCATION: ELEVATION 1334.40' WATERSHED INDIAN FORK OF MEATHOUSE FORK
DISTRICT NEW MILTON COUNTY DODDRIDGE
QUADRANGLE NEW MILTON 7.5' NEAREST TOWN COLDWATER

SURFACE OWNER ADDIE V. REED ACREAGE 29.32
OIL & GAS ROYALTY OWNER GORE CORPORATION LEASE ACREAGE 80.25

LEASE NO. DV 5610

PROPOSED WORK: DRILL CONVERT DRILL DEEPER REDRILL FRACTURE OR STIMULATE
PLUG OFF OLD FORMATION PERFORATE NEW FORMATION
OTHER PHYSICAL CHANGE IN WELL (SPECIFY) _____
PLUG AND ABANDON CLEAN OUT AND REPLUG

TARGET FORMATION ALEXANDER ESTIMATED DEPTH 5880' SEP 24 1990
WELL OPERATOR CNG DEVELOPMENT COMPANY DESIGNATED AGENT GARY A. NICHOLAS
ADDRESS ONE PARK RIDGE CENTER ADDRESS CROSSWIND CORPORATE PARK
P.O. BOX 15746 ROUTE 2 BOX 698
PITTSBURGH, PA 15244 BRIDGEPORT, WV 26330

FORM IV - 6

Done 7/25/88

151 1875'

(+/-) DENOTES LOCATION OF WELL ON U.S.G.S. TOPOGRAPHIC MAP

LATITUDE 39°12'30"

ELTON D. PATTON
52.00 AC.

N 37°30' W
534.6'

LONGITUDE 80°37'30"

11,525'

2400'
PROP WELL
CNGD 3405

460 (17)
1450'

2999 (25)
2375'

ETHEL MAE GREATHOUSE
42.60 AC.

PROP WELL
CNGD 3405

N 55°57' W
251.70'

N 48°30' E 594.0'

N 37° E 181.5'

STO. PILE

N 21°38' W 431.65'

N 10°45' E 265.00'

STO. PILE

N 32°30' E 148.5'

N 54°30' E 219.12'

N 66°30' E 280.5'

N 54° E 82.5'

N 53°30' E 123.75'

PAUL DOUGLASS
FARR II
11.00 AC.

N 30° E 1023'

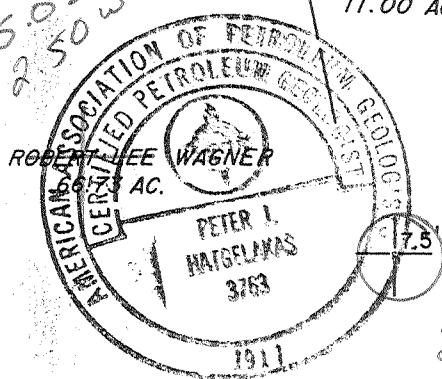

MAGNETIC REFERENCE TIES

S 51°28' E 251.70' TO STO. PILE W/C.O. PTR.
S 57°00' E 169.18' TO 16" C.O. ON RIDGE

MSES consultants, inc.

FILE NO. MSES 88-823

DRAWN BY RRC/VSH

SCALE 1" = 500'

MIN. DEGREE OF ACCURACY 1 IN 2500

PROVEN SOURCE OF ELEVATION:

ELEV. 896' AT JUNCTION OF

ROUTES 58 & 60

I, THE UNDERSIGNED, HEREBY CERTIFY THAT THIS PLAT IS CORRECT TO THE BEST OF MY KNOWLEDGE AND BELIEF AND SHOWS ALL THE INFORMATION REQUIRED BY LAW AND THE REGULATIONS ISSUED AND PRESCRIBED BY THE DEPARTMENT OF MINES.

(SIGNED)

John S. Bailey
R.P.E. _____ L.L.S. 652

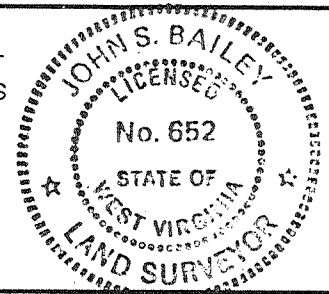

STATE OF WEST VIRGINIA
DEPARTMENT OF MINES
OIL AND GAS DIVISION



DATE MAY 19, 1988

OPERATOR'S WELL NO. CNGD 3405

API WELL NO.

47-017-3661
STATE COUNTY PERMIT

WELL TYPE: OIL GAS LIQUID INJECTION WASTE DISPOSAL
IF "GAS", PRODUCTION STORAGE DEEP SHALLOW

LOCATION: ELEVATION 1334.40' WATERSHED INDIAN FORK OF MEATHOUSE FORK

DISTRICT NEW MILTON 6 COUNTY DODDRIDGE

QUADRANGLE NEW MILTON 7.5' 511 123 NEAREST TOWN COLDWATER

SURFACE OWNER ADDIE V. REED ACREAGE 29.32

OIL & GAS ROYALTY OWNER GORE CORPORATION LEASE ACREAGE 80.25

LEASE NO. DV 5610

PROPOSED WORK: DRILL CONVERT DRILL DEEPER REDRILL FRACTURE OR STIMULATE
PLUG OFF OLD FORMATION PERFORATE NEW FORMATION
OTHER PHYSICAL CHANGE IN WELL (SPECIFY) _____
PLUG AND ABANDON CLEAN OUT AND REPLUG

TARGET FORMATION ALEXANDER ESTIMATED DEPTH 5880'

WELL OPERATOR CNG DEVELOPMENT COMPANY

DESIGNATED AGENT GARY A. NICHOLAS

ADDRESS ONE PARK RIDGE CENTER

ADDRESS CROSSWIND CORPORATE PARK

P.O. BOX 15746

ROUTE 2 BOX 698

PITTSBURGH, PA 15244

BRIDGEPORT, WV 26330

AUG 5 - 1988

FORM IV - 6

STATE OF WEST VIRGINIA
 DEPARTMENT OF ENERGY, DIVISION OF OIL AND GAS
 WELL WORK PERMIT APPLICATION

- 1) Well Operator: CNG DEVELOPMENT COMPANY 10110, C, 510
- 2) Operator's Well Number: CNGD 3405 3) Elevation: 1334.40
- 4) Well type: (a) Oil / or Gas X/
 (b) If Gas: Production X/ Underground Storage /
 Deep / Shallow X/
- 5) Proposed Target Formation(s): Alexander
- 6) Proposed Total Depth: 5880 feet
- 7) Approximate fresh water strata depths: - 520', 470'
- 8) Approximate salt water depths: 1847, 1942 1410 water?
- 9) Approximate coal seam depths: 1017
- 10) Does land contain coal seams tributary to active mine? Yes / No X/
- 11) Proposed Well Work: Drill new well ; Stimulate
- 12)

CASING AND TUBING PROGRAM

TYPE	SPECIFICATIONS			FOOTAGE INTERVALS		CEMENT
	Size	Grade	Weight per ft.	For drilling	Left in well	Fill-up (cu. ft.)
Conductor						
Fresh Water	11-3/4	H-40	42	250	250	To surface
Coal						To surface
Intermediate	8-5/8	X-42	23	1700	1700	38CSR1811.2.2 & 38CSR181.3
Production	4-1/2	J-55	10.5	5880	5880	200-400 sks 38CSR18-11.1
Tubing	1-1/2	CN-55	2.75			
Liners						

RECEIVED
 JUL 19 1988

PACKERS : Kind _____
 Sizes _____
 Depths set _____

DIVISION OF OIL & GAS
 DEPARTMENT OF ENERGY

For Division of Oil and Gas Use Only

Fee(s) paid: Well Work Permit Reclamation Fund WPCP
 Plat WW-9 WW-2B Bond 50 Blanket Agent
 (Type)

145-
 024571
 [Signatures]

RECEIVED
JUL 19 1988

Page 1 of _____
Form WW2-A
(09/87)
File Copy

DIVISION OF OIL & GAS 3)
DEPARTMENT OF ENERGY

Date: July 7, 1988
Operator's well number
CNGD 3405
API Well No: 47 - 017 - 3661
State - County - Permit

STATE OF WEST VIRGINIA
DEPARTMENT OF ENERGY, DIVISION OF OIL AND GAS
NOTICE AND APPLICATION FOR A WELL WORK PERMIT

4) Surface Owner(s) to be served:
(a) Name Addie Reed
Address Route 1
New Milton, WV 26411
(b) Name _____
Address _____
(c) Name _____
Address _____
6) Inspector Mike Underwood
Address Route 2, Box 135
Salem, WV 26426
Telephone (304)-782-1043

5) (a) Coal Operator:
Name _____
Address _____
(b) Coal Owner(s) with Declaration
Name Peabody Coal Co., (Eastern Assoc. Coal)
Address 800 Laidley Tower, P.O. Box 1233
Charleston, WV 25324
Name _____
Address _____
(c) Coal Lessee with Declaration
Name _____
Address _____

TO THE PERSON(S) NAMED ABOVE TAKE NOTICE THAT:

_____ Included is the lease or leases or other continuing contract or contracts by which I hold the right to extract oil and gas OR

X Included is the information required by Chapter 22B, Article 1, Section 8(d) of the Code of West Virginia (see page 2)

I certify that as required under Chapter 22B of the West Virginia Code I have served copies of this notice and application, a location plat, and accompanying documents pages 1 through _____ on the above named parties, by:

- _____ Personal Service (Affidavit attached)
- X Certified Mail (Postmarked postal receipt attached)
- _____ Publication (Notice of Publication attached)

I have read and understand Chapter 22B and 38 CSR 11-18, and I agree to the terms and conditions of any permit issued under this application.

I certify under penalty of law that I have personally examined and am familiar with the information submitted on this application form and all attachments, and that based on my inquiry of those individuals immediately responsible for obtaining the information, I believe that the information is true, accurate, and complete.

I am aware that there are significant penalties for submitting false information, including the possibility of fine and imprisonment.

Well Operator CNG Development Company
By: [Signature]
Its: Supervisor, Purchasing and Production Service
Address One Park Ridge Center, P.O. Box 15746
Pittsburgh, PA 15244
Telephone (412) 787-4117

Subscribed and sworn before me this 20th day of May, 1988

[Signature] Notary Public
My commission expires June 18, 1990