

87B 7/15/87

5775' 25

LATITUDE 39° 22' 30"

LONGITUDE 80° 47' 30"

WELL REFERENCES:

N17°30'W, 124.50' TO 6" ELM
S74°W, 118.5' TO 3" HEMLOCK

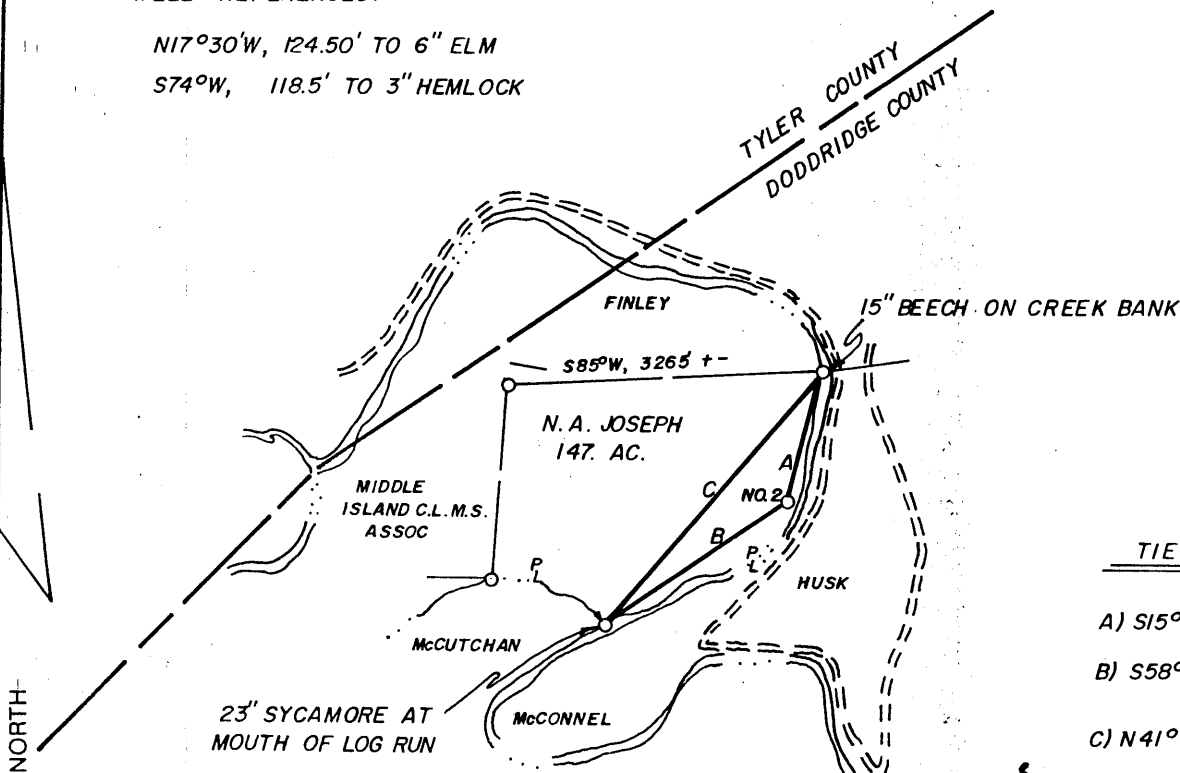

TIE LINES

- A) S15°11'W, 1471.22'
- B) S58°18'W, 2291.50'
- C) N41°40'E, 3512.16'

5.10S
332W

2.22S
1.08W

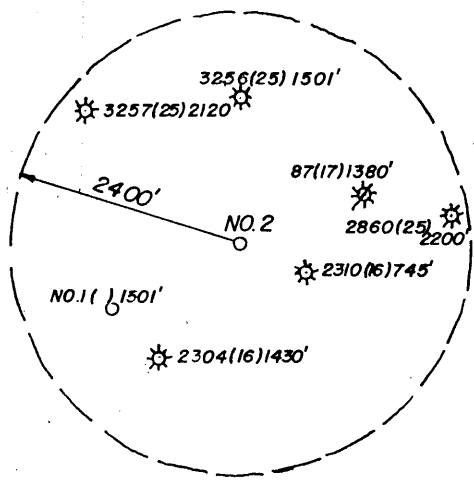
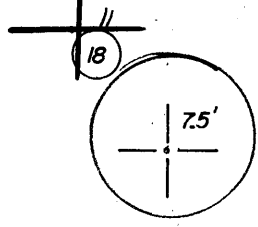

NOTE: EASTERN BOUNDARY RUNS WITH MIDDLE ISLAND CREEK. SOUTHERN BOUNDARY WITH LOG RUN.

LAND SURVEYING SERVICES
21 CEDAR LANE
BRIDGEPORT, WV 26330
PHONE: 304-842-2018

(+) DENOTES LOCATION OF WELL ON UNITED STATES TOPOGRAPHIC MAPS.

FILE NO. _____
 DRAWING NO. _____
 SCALE 1" = 2000'
 MINIMUM DEGREE OF ACCURACY 1 IN 200
 PROVEN SOURCE OF ELEVATION - B.M. 1750' SE. OF LOC. AT ELEV. 751'

I THE UNDERSIGNED, HEREBY CERTIFY THAT THIS PLAT IS CORRECT TO THE BEST OF MY KNOWLEDGE AND BELIEF AND SHOWS ALL THE INFORMATION REQUIRED BY LAW AND THE REGULATIONS ISSUED AND PRESCRIBED BY THE DEPARTMENT OF ENERGY.

(SIGNED) *Stephen D. Losh*

R.P.E. _____ L.L.S. NO. 674
STEPHEN D. LOSH

PLACE SEAL HERE

STATE OF WEST VIRGINIA
DEPARTMENT OF ENERGY
OIL AND GAS DIVISION



DATE JUNE 22, 19 87
 OPERATOR'S WELL NO. N.A. JOSEPH 2
 API WELL NO.

47 - 017 - 3574
STATE COUNTY PERMIT

WELL TYPE: OIL ___ GAS X LIQUID INJECTION ___ WASTE DISPOSAL ___
 (IF "GAS,") PRODUCTION X STORAGE ___ DEEP ___ SHALLOW X
 LOCATION: ELEVATION 740' WATER SHED MIDDLE ISLAND CREEK
 DISTRICT WEST UNION 4 COUNTY DODDRIDGE
 QUADRANGLE WEST UNION 7.5 671 133 CC
 SURFACE OWNER N.A. JOSEPH, heirs ACREAGE 147. (DEED)
 OIL & GAS ROYALTY OWNER N.A. JOSEPH, heirs LEASE ACREAGE 168.
 LEASE NO. _____

PROPOSED WORK: DRILL X CONVERT ___ DRILL DEEPER ___ REDRILL ___ FRACTURE OR STIMULATE ___ PLUG OFF OLD FORMATION ___ PERFORATE NEW FORMATION ___ OTHER PHYSICAL CHANGE IN WELL (SPECIFY) _____

PLUG AND ABANDON ___ CLEAN OUT AND REPLUG ___
 TARGET FORMATION BENSON ESTIMATED DEPTH 5000'
 WELL OPERATOR STONEWALL GAS COMPANY DESIGNATED AGENT CHARLES CANFIELD
 ADDRESS P.O. DRAWER R ADDRESS P.O. DRAWER R
 JANE LEW, WV 26378-0080 847 JANE LEW, WV 26378-0080

AUG 03 1987

COUNTY NAME
PERMIT



WR-35

RECEIVED
SEP 22 1987

State of West Virginia

DEPARTMENT OF ENERGY
Oil and Gas Division

Date SEPTEMBER 10, 1987
Operator's
Well No. JOSEPH #2 206-S
Farm JOSEPH
API No. 47 - 017 - 3574

DIVISION OF OIL & GAS
DEPARTMENT OF ENERGY

WELL OPERATOR'S REPORT
OF

DRILLING, FRACTURING AND/OR STIMULATING, OR PHYSICAL CHANGE

WELL TYPE: Oil ___ / Gas X / Liquid Injection ___ / Waste Disposal ___ /
(If "Gas," Production X / Underground Storage ___ / Deep ___ / Shallow X /)

LOCATION: Elevation: 740 Watershed MIDDLE ISLAND CREEK

District: WEST UNION County DODDRIDGE Quadrangle WEST UNION

COMPANY STONEWALL GAS COMPANY
ADDRESS PO DRAWER R, JANE LEW, WV 26378
DESIGNATED AGENT CHARLES W. CANFIELD
ADDRESS PO DRAWER R, JANE LEW, WV 26378
SURFACE OWNER WILLIAM R. JOHNSON
ADDRESS RT 1, BOX 46AA, BRISTOL, WV 26332
MINERAL RIGHTS OWNER CW MUTSCHELKNAUS
ADDRESS RT 1, BOX 52, SALEM, WV 26426
OIL AND GAS INSPECTOR FOR THIS WORK MIKE
UNDERWOOD ADDRESS RT 2, BOX 135, SALEM, WV
PERMIT ISSUED JULY 29, 1987 26426
DRILLING COMMENCED 8/24/87
DRILLING COMPLETED 8/28/87

Casing & Tubing	Used in Drilling	Left in Well	Cement fill up Cu. ft.
Size 20-16 Cond.			
11 3/4" 13-10"	160	160	75 SKS
9 5/8			
8 5/8	1003	1003	225 SKS
7			
5 1/2			
4 1/2	4786	4786	200 SKS
3			
2			
Liners used			

IF APPLICABLE: PLUGGING OF DRY HOLE ON CONTINUOUS PROGRESSION FROM DRILLING OR REWORKING. VERBAL PERMISSION OBTAINED ON

GEOLOGICAL TARGET FORMATION BENSON Depth 4648 feet

Depth of completed well 4786 feet Rotary X / Cable Tools

Water strata depth: Fresh 65 feet; Salt 360 feet

Coal seam depths: 80 - 83' Is coal being mined in the area? NO

OPEN FLOW DATA

Producing formation BENSON Pay zone depth 4648 feet

Gas: Initial open flow 70 Mcf/d Oil: Initial open flow N/A Bbl/d

Final open flow 348 Mcf/d Final open flow N/A Bbl/d

Time of open flow between initial and final tests 72 hours

Static rock pressure 1400# psig (surface measurement) after 72 hours shut in

(If applicable due to multiple completion--)

Second producing formation Pay zone depth feet

Gas: Initial open flow Mcf/d Oil: Initial open flow Bbl/d

Final open flow Mcf/d Oil: Final open flow Bbl/d

Time of open flow between initial and final tests hours

Static rock pressure psig (surface measurement) after hours shut in

SEP 28 1987
(Continue on reverse)

DETAILS OF PERFORATED INTERVALS, FRACTURING OR STIMULATING, PHYSICAL CHANGE, ETC.

FRAC ONE STAGE 9/2/87

	PERFS	HOLES	BBL	SAND	B.D.	I.S.I.P
<u>BENSON</u>	<u>4644-4648</u>	12	715	60,000#	2000#	1700#

WELL LOG

FORMATION	COLOR	HARD OR SOFT	TOP FEET	BOTTOM FEET	REMARKS
					Including indication of all fresh and salt water, coal, oil and gas
FILL	RED	SOFT	0	5	2" STREAM H ² O 65'
RED SHALE	RED	SOFT	5	80	
COAL	BLACK	SOFT	80	83	
SAND & SHALE	GREY	HARD	83	1580	4" STREAM H ² O 180'
BIG LIME	GREY	HARD	1580	1650	½" STREAM H ² O 210'
BIG INJUN	GREY	HARD	1680	1780	1" STREAM H ² O 360'
WEIR	GREY	SOFT	1930	2040	GAS CK @ 1799 8/10 1½" H ² O
BEREA	GREY	SOFT	2120	2130	GAS CK @ 2396 20/10 1½" H ² O
GORDON	GREY	SOFT	2330	2380	
WARREN	GREY	HARD	3040	3080	
RILEY	GREY	HARD	4200	4320	GAS CK @ 4340 24/10 1½" H ² O
BENSON	GREY	HARD	4620	4660	GAS CK @ 4683 46/10 1½" H ² O
T.D.				<u>4840</u>	GAS CK @ T.D. 20/10 1½" H ² O

RECEIVED
SEP 22 1987

DIVISION OF OIL & GAS
DEPARTMENT OF ENERGY

(Attach separate sheets as necessary)

STONEWALL GAS COMPANY

Well Operator

By: Benjamin A. Hardesty
BENJAMIN A. HARDESTY, VICE PRESIDENT

Date: _____

Note: Regulation 2.02(i) provides as follows:
"The term 'log' or 'well log' shall mean a systematic detailed geological record of all formations, including coal, encountered in the drilling of a well."

WR-35

29-Jun-98

API # 47- 17-03574 W

State of West Virginia
Division of Environmental Protection
Section of Oil and Gas

Well Operator's Report of Well Work

Farm name: GOLDSMITH, JENNINGS Operator Well No.: JOSEPH #2

LOCATION: Elevation: 740.00 Quadrangle: WEST UNION

District: WEST UNION County: DODDRIDGE
Latitude: 11800 Feet South of 39 Deg. 22Min. 30 Sec.
Longitude 5775 Feet West of 80 Deg. 47 Min. 30 Sec.

Company: DOMINION APPALACHIAN DEVE
P. O. BOX 1248
JANE LEW, WV 26378-0000

Agent: JOHN T. HASKINS

Inspector: MIKE UNDERWOOD
Permit Issued: 06/29/98
Well work Commenced: 9/18/98
Well work Completed: 9/29/98
Verbal Plugging
Permission granted on: *
Rotary * Cable * Rig
Total Depth (feet) *
Fresh water depths (ft) _____
Salt water depths (ft) *

Is coal being mined in area (Y/N)? *
Coal Depths (ft): _____

Casing & Tubing Size	Used in Drilling	Left in Well	Cement Fill Up Cu. Ft.
* No Change, see original WR-35			

OPEN FLOW DATA

Producing formation Big Injun Pay zone depth (ft) 1756-1764'
Gas: Initial open flow 0 MCF/d Oil: Initial open flow 0 Bbl/d
Final open flow TSTM MCF/d Final open flow 0 Bbl/d
Time of open flow between initial and final tests 4 Hours
Static rock Pressure 350 psig (surface pressure) after 72 Hours

Second producing formation _____ Pay zone depth (ft) _____
Gas: Initial open flow _____ MCF/d Oil: Initial open flow _____ Bbl/d
Final open flow _____ MCF/d Final open flow _____ Bbl/d
Time of open flow between initial and final tests _____ Hours
Static rock Pressure _____ psig (surface pressure) after _____ Hours

NOTE: ON BACK OF THIS FORM PUT THE FOLLOWING: 1). DETAILS OF PERFORATED INTERVALS, FRACTURING OR STIMULATING, PHYSICAL CHANGE, ETC. 2). THE WELL LOG WHICH IS A SYSTEMATIC DETAILED GEOLOGICAL RECORD OF ALL FORMATIONS, INCLUDING COAL ENCOUNTERED BY THE WELLBORE.

For: Larry J. Cavallo
DOMINION APPALACHIAN DEVELOPMENT, INC.

By: Larry J. Cavallo; Manager of Engineering
Date: 1/18/99

FEB 01 1999

D000 3574 W

ZONES	1	STAGE(S)	750 foam	FRAC	DATE	9/29/98	
		PERFS		HOLES	BBL	BP	ISIP
Big Injun		1756-1764		18	348 (foam)	1211	2090

FORMATION	COLOR	HARD/SOFT	TOP	BOTTOM	REMARKS
-----------	-------	-----------	-----	--------	---------

* No Change, See Original WR-35

1000
 CHESTERFIELD
 (Pencil)
 JAN 22 1999
 W.D. and
 P.

RECEIVED
JUL 13 1987



1) Date: July 1, 19 87
2) Operator's Well No. Joseph #2 206-S
3) API Well No. 47 State 017 County 3574 Permit

STATE OF WEST VIRGINIA
DIVISION OF OIL & GAS DEPARTMENT OF ENERGY, OIL AND GAS DIVISION
DEPARTMENT OF ENERGY APPLICATION FOR A WELL WORK PERMIT

- 4) WELL TYPE: A Oil Gas
B (If "Gas", Production Underground storage Deep Shallow)
- 5) LOCATION: Elevation: 740' Watershed: Middle Island Creek
District: West Union 8 County: Doddridge 017 Quadrangle: West Union 670
- 6) WELL OPERATOR Stonewall Gas CODE: 47850 7) DESIGNATED AGENT Charles W. Canfield
Address P.O. Drawer R Address P.O. Drawer R
Jane Lew, WV 26378 Jane Lew, WV 26378
- 8) OIL & GAS INSPECTOR TO BE NOTIFIED Name Mike Underwood 782-1043
Address Rt 2, Box 135
Salem, WV 26426
- 9) DRILLING CONTRACTOR: Name S.W. Jack
Address Buckhannon, WV 26201
- 10) PROPOSED WELL WORK: Drill / Drill deeper / Redrill / Stimulate
Plug off old formation / Perforate new formation
Other physical change in well (specify) _____
- 11) GEOLOGICAL TARGET FORMATION, Benson
- 12) Estimated depth of completed well, 5000' feet
- 13) Approximate trata depths: Fresh, _____ feet; salt, _____ feet.
- 14) Approximate coal seam depths: _____ Is coal being mined in the area? Yes / No

15) CASING AND TUBING PROGRAM

CASING OR TUBING TYPE	SPECIFICATIONS					FOOTAGE INTERVALS		CEMENT FILL-UP OR SACKS (Cubic feet)	PACKERS
	Size	Grade	Weight per ft.	New	Used	For drilling	Left in well		
Conductor	11 3/4			X		150'	150'	Rule 15.05	Kinds
Fresh water									
Coal									Sizes
Intermediate	8 5/8			X		940'	940'	Rule 15.05	
Production	4 1/2			X		5000'	5000'	Rule 15.01	Depths set
Tubing									
Liners									Perforations: Top Bottom

OFFICE USE ONLY
DRILLING PERMIT

Permit number 47-017-3574

July 29 19 87
Date

This permit covering the well operator and well location shown below is evidence of permission granted to drill in accordance with the pertinent legal requirements subject to the conditions contained herein and on the reverse hereof. Notification must be given to the District Oil and Gas Inspector. (Refer to No. 8) Prior to the construction of roads, locations and pits for any permitted work. In addition, the well operator or his contractor shall notify the proper district oil and gas inspector 24 hours before actual permitted work has commenced.)

The permitted work is as described in the Notice and Application, plat, and reclamation plan, subject to any modifications and conditions specified on the reverse hereof.

Permit expires July 29, 1989 unless well work is commenced prior to that date and prosecuted with due diligence.

Bond: <input checked="" type="checkbox"/>	Agent: <input checked="" type="checkbox"/>	Plat: <input checked="" type="checkbox"/>	Fee: <u>218</u> <u>3094</u>	Other: <input checked="" type="checkbox"/>
---	--	---	--------------------------------	--

NOTE: Keep one copy of this permit posted at the drilling location.

[Signature]
Director, Division of Oil and Gas

File

10443