

1987 7/1/87

LATITUDE 39° 15' 00" LONGITUDE 80° 35' 00"

WELL REFERENCES:
N52°W, 62' TO POWER POLE
S74°W, 118' TO POWER POLE

WAIVERS REQUIRED:
S71°W, 95' TO HOUSE TRAILER
N61°W, 114' TO HOUSE
N79°45'W, 127' TO WATER WELL

DUKATE
1.99 AS

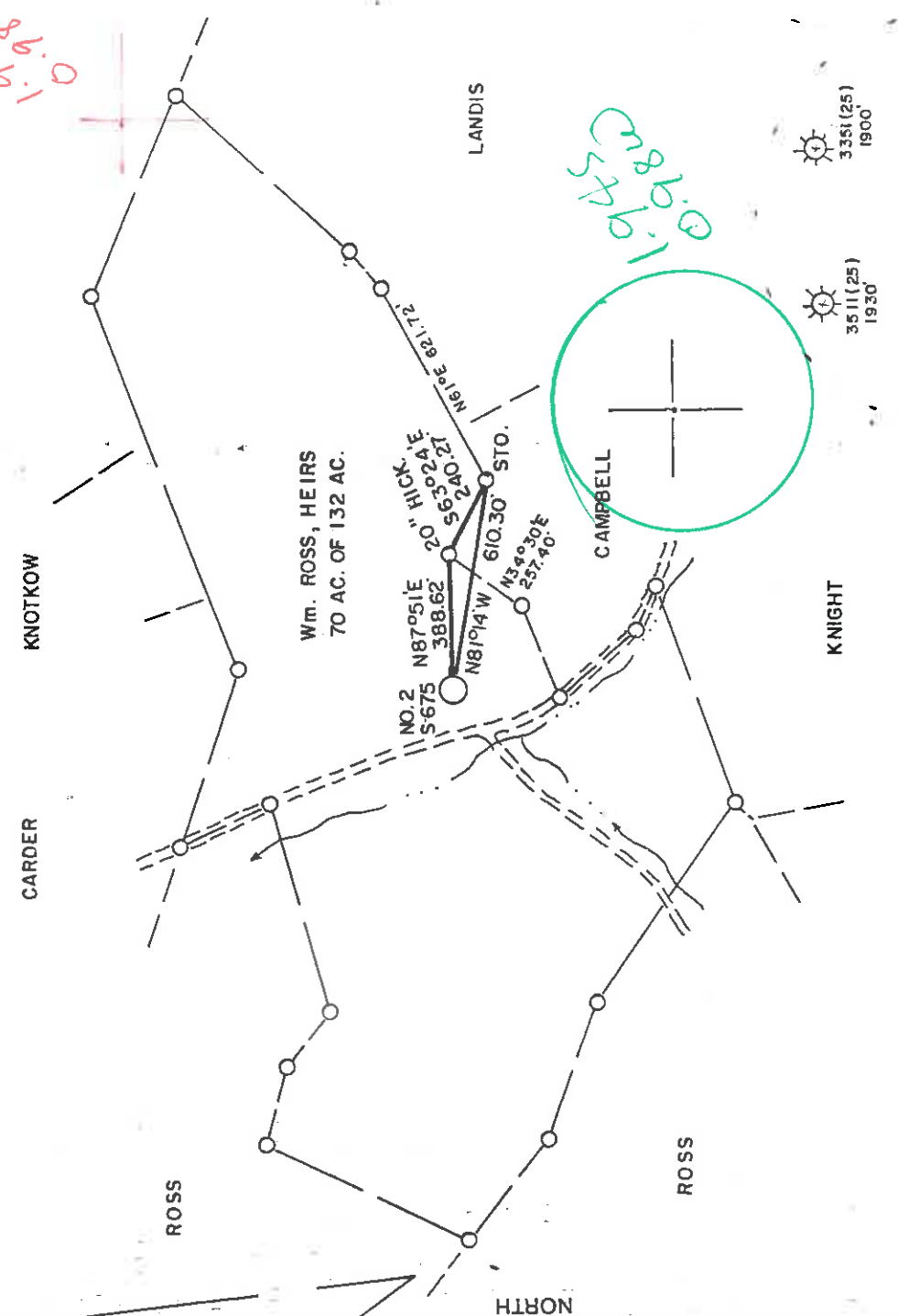

LAND SURVEYING SERVICES
21 CEDAR LANE
BRIDGEPORT, WV 26330
PHONE: 304-842-2018

(+) DENOTES LOCATION OF WELL ON UNITED STATES TOPOGRAPHIC MAPS

FILE NO. _____
DRAWING NO. _____
SCALE 1" = 500'
MINIMUM DEGREE OF _____
ACCURACY 1 in 200
PROVEN SOURCE OF _____
ELEVATION RD. INTER. 175' S.W. OF _____
LOCATION ELEV. - 913'

I THE UNDERSIGNED, HEREBY, CERTIFY THAT THIS PLAN IS CORRECT TO THE BEST OF MY KNOWLEDGE AND BELIEF AND SHOWS ALL THE INFORMATION REQUIRED BY LAW AND THE REGULATIONS ISSUED AND PRESCRIBED BY THE DEPARTMENT OF ENERGY.
(SIGNED) *Stephen D. Losh*
R.P.E. _____ L.L.S. 674
STEPHEN D. LOSH

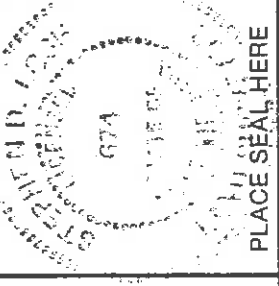

STATE OF WEST VIRGINIA
DEPARTMENT OF ENERGY
OIL AND GAS DIVISION



DATE JUNE 22, 19 87
OPERATOR'S WELL NO. S-675
API WELL NO. ROSS NO. 2
47 017 3568

WELL TYPE: OIL _____ GAS _____ LIQUID INJECTION _____ WASTE DISPOSAL _____
(IF "GAS,") PRODUCTION _____ STORAGE _____ DEEP _____ SHALLOW _____
LOCATION: ELEVATION 922' WATER SHED INDIAN FORK
DISTRICT GREENBRIER 4 COUNTY DODDRIDGE
QUADRANGLE BIG ISAAC 7.5 min. 252 123 2 VADIS DC ACREAGE 64
SURFACE OWNER VIRGINIA JANISZEWSKI ARCHIE FRYE
OIL & GAS ROYALTY OWNER WILLIAM ROSS, HEIRS LEASE ACREAGE 132
LEASE NO. 2030

PROPOSED WORK: DRILL _____ CONVERT _____ DRILL DEEPER _____ REDRILL _____ FRACTURE OR STIMULATE _____ PLUG OFF OLD FORMATION _____ PERFORATE NEW FORMATION _____ OTHER PHYSICAL CHANGE IN WELL (SPECIFY) _____

PLUG AND ABANDON _____ CLEAN OUT AND REPLUG _____
TARGET FORMATION ALEXANDER / BENSON ESTIMATED DEPTH 5300'
WELL OPERATOR SCOTT OIL COMPANY DESIGNATED AGENT DARREL WRIGHT
ADDRESS P.O. BOX 112 774 ADDRESS P.O. BOX 112 SALEM, WV 26426

6-6 Meathouse Fork - Bristol (146)

JUL 20 1987

COUNTY NAME

PERMIT



MR-35

RECEIVED
OCT 16 1987

State of West Virginia

DEPARTMENT OF ENERGY
Oil and Gas Division

Date September 9, 1987
Operator's
Well No. S-675
Farm William Ross #2
API No. 47 - 017 - 3568

DIVISION OF OIL & GAS
DEPARTMENT OF ENERGY

WELL OPERATOR'S REPORT
OF

DRILLING, FRACTURING AND/OR STIMULATING, OR PHYSICAL CHANGE

WELL TYPE: Oil / Gas x / Liquid Injection / Waste Disposal /
(If "Gas," Production x / Underground Storage / Deep / Shallow /)

LOCATION: Elevation: 922 Watershed Indian Fork
District: Greenbrier County Doddridge Quadrangle Big Isaac

COMPANY Scott Oil Company

ADDRESS P. O. Box 112, Salem, WV 26426

DESIGNATED AGENT Darrel Wright

ADDRESS P. O. Box 112, Salem, WV 26426

SURFACE OWNER Archie F. Frye

ADDRESS Dayton, Ohio

MINERAL RIGHTS OWNER William Ross Heirs

ADDRESS _____

OIL AND GAS INSPECTOR FOR THIS WORK Mike

Underwood ADDRESS Route 2, Salem

PERMIT ISSUED July 16, 1987

DRILLING COMMENCED 8/24/87

DRILLING COMPLETED 8/30/87

IF APPLICABLE: PLUGGING OF DRY HOLE ON
CONTINUOUS PROGRESSION FROM DRILLING OR
REWORKING. VERBAL PERMISSION OBTAINED
CN

Casing & Tubing	Used in Drilling	Left in Well	Cement fill up Cu. ft.
Size 20-16 Cond.			
13-10"	30		
9 5/8			
8 5/8		961	to surface
7			
5 1/2			
4 1/2		5367	235 sks
3			
2			
Liners used			

GEOLOGICAL TARGET FORMATION Benson, Alexander Depth _____ feet

Depth of completed well 5450 feet Rotary / Cable Tools

Water strata depth: Fresh 81 feet; Salt _____ feet

Coal seam depths: 300-304 Is coal being mined in the area? no

OPEN FLOW DATA

Producing formation Benson, Alexander Pay zone depth _____ feet

Gas: Initial open flow _____ Mcf/d Oil: Initial open flow _____ Bbl/d

Final open flow (474) Mcf/d Final open flow _____ Bbl/d

Time of open flow between initial and final tests 16 hours

Static rock pressure 1925 psig (surface measurement) after _____ hours shut in

(If applicable due to multiple completion--)

Second producing formation _____ Pay zone depth _____ feet

Gas: Initial open flow _____ Mcf/d Oil: Initial open flow _____ Bbl/d

Final open flow _____ Mcf/d Oil: Final open flow _____ Bbl/d 26 1987

Time of open flow between initial and final tests _____ hours

Static rock pressure _____ psig (surface measurement) after _____ hours shut in

(Continue on reverse side)

DETAILS OF PERFORATED INTERVALS, FRACTURING OR STIMULATING, PHYSICAL CHANGE, ETC.

Benson 4860-4870 Sand 500 sks 600 bb1 fluid
Alexander 5200-5218 Sand 400 sks 550 bb1 fluid

RECEIVED
 OCT 16 1987

DIVISION OF OIL & GAS
 DEPARTMENT OF ENERGY

WELL LOG

FORMATION	COLOR	HARD OR SOFT	TOP FEET	BOTTOM FEET	REMARKS
Fill			0	10	Including indication of all fresh and salt water, coal, oil and gas
Sand & Shale			25	300	
Coal			300	304	
Shale			304	315	
Red Rock			315	320	
Sand & Shale			320	698	
Red Rock			698	711	
Shale			711	745	
Red Rock			745	780	
Sand & Shale			780	1880	
Lime			1880	1897	
Sand & Shale			1897	1923	
Lime			1923	1980	
Sand			1980	2065	
Sand & Shale			2065	2560	
Sand			2560	2595	
Sand & Shale			2595	2645	
Sand			2645	2688	
Sand & Shale			2688	4800	
Sand			4850	4860	
Sand & Shale			4860	5183	
Sand			5183	5248	
Sand & Shale			5247	<u>5450TD</u>	
<input checked="" type="checkbox"/> Gamma Ray					
Big Lime			1918	1980	
Big Injun			1980	2065	
Gordon Stray			2560	2595	
Gordon			2645	2688	
Benson			4850	4860	
<input checked="" type="checkbox"/> Alexander			5183	5248	

(Attach separate sheets as necessary)

By: Scott Oil Company
 Well Operator Daniel Wang
 Date: 9/9/87

Note: Regulation 2.02(i) provides as follows:
 "The term 'log' or 'well log' shall mean a systematic detailed geological record of all formations, including all, encountered in the drilling of a well."

