

39° 15' 1100' W

LATITUDE : 39-12-30

Topo. Loc. 7.5'

.075
.20W
2.07
2.93
3.95

LONGITUDE : 80-50-00

2.935
0.23W

39 12 25
80 50 15

NORTH

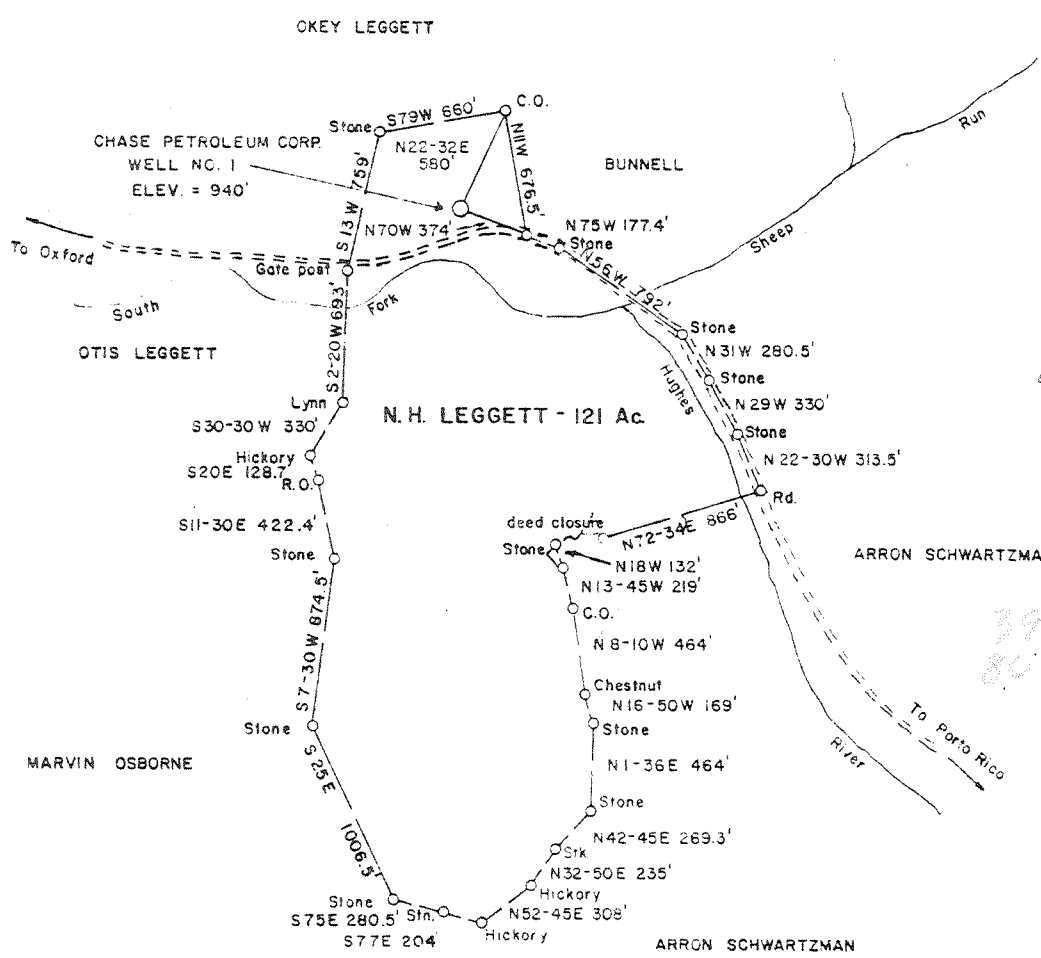

FILE NO. _____
 DRAWING NO. _____
 SCALE 1 inch = 1000 feet
 MINIMUM DEGREE OF ACCURACY 1/200
 PROVEN SOURCE OF ELEVATION Jct Rds 700' SE
of Location Elev. = 841'

I THE UNDERSIGNED, HEREBY CERTIFY THAT THIS PLAT IS CORRECT TO THE BEST OF MY KNOWLEDGE AND BELIEF AND SHOWS ALL THE INFORMATION REQUIRED BY LAW AND THE REGULATIONS ISSUED AND PRESCRIBED BY THE DEPARTMENT OF MINES. *Mark C. Echard*
 (SIGNED) MARK C. ECHARD
 R.P.E. _____ L.L.S. 490

PLACE SEAL HERE

(+) DENOTES LOCATION OF WELL ON UNITED STATES TOPOGRAPHIC MAPS
 FORM IV-6 (8-78)



DATE NOVEMBER 14, 1980
 OPERATOR'S WELL NO. ONE
 API WELL NO. 47-017-2897
 STATE WEST VIRGINIA COUNTY DODDRIDGE PERMIT ONE

STATE OF WEST VIRGINIA
 DEPARTMENT OF MINES
 OIL AND GAS DIVISION

WELL TYPE: OIL ___ GAS LIQUID INJECTION ___ WASTE DISPOSAL ___
 (IF "GAS,") PRODUCTION STORAGE ___ DEEP ___ SHALLOW
 LOCATION: ELEVATION 940' WATER SHED SOUTH FORK OF HUGHES RIVER
 DISTRICT SOUTHWEST COUNTY DODDRIDGE
 QUADRANGLE OXFORD 75' Halbrook 15' NC
 SURFACE OWNER N.H. LEGGETT, et al ACREAGE 121
 OIL & GAS ROYALTY OWNER N.H. LEGGETT, et al LEASE ACREAGE 121
 LEASE NO. _____
 PROPOSED WORK: DRILL CONVERT ___ DRILL DEEPER ___ REDRILL ___ FRACTURE OR STIMULATE ___ PLUG OFF OLD FORMATION ___ PERFORATE NEW FORMATION ___ OTHER PHYSICAL CHANGE IN WELL (SPECIFY) _____
 PLUG AND ABANDON ___ CLEAN OUT AND REPLUG ___
 TARGET FORMATION ALEXANDER ESTIMATED DEPTH 5650'
 WELL OPERATOR CHASE PETROLEUM CORP DESIGNATED AGENT MR. ALTON SKINNER
 ADDRESS BOX 297 ADDRESS BOX 297
GLENVILLE, W.V. 26351 GLENVILLE, W.V. 26351

TRASCO

6-6 Straight Fork-Bluestone Creek (133) JAN 13 1981



STATE OF WEST VIRGINIA
DEPARTMENT OF MINES

RECEIVED

AUG 25 1981

Oil and Gas Division

OIL AND GAS DIVISION
WV DEPARTMENT OF MINES

WELL RECORD

Rotary Oil _____
Cable _____ Gas
Recycling _____ Comb _____
Water Flood _____ Storage _____
Disposal _____ (Kind) _____

Quadrangle Oxford 7.5

Permit No. 47-017-2897

Company Chase Petroleum
Address Drawer 369, Glenville, WV 26351
Farm N.H. Leggett, et al Acres 121
Location (waters) South Fork of Hughes River
Well No. Hedrick Leggett #1 Elev. 940
District Southwest County Doddridge
The surface of tract is owned in fee by N.H. Leggett,
et al
Address Oxford, WV 26414
Mineral rights are owned by N.H. Leggett, et al
Address Oxford, WV
Drilling Commenced April 4, 1981
Drilling Completed April 9, 1981
Initial open flow 300,000 cu. ft. 0 bbls.
Final production 2,500,00 cu. ft. per day 0 bbls.
Well open 10 hrs. before test 1900 RP.

Casing and Tubing	Used in Drilling	Left in Well	Cement fill up Cu ft (Sks.)
Size 20-16			
Cond.			
13-10" 11 3/4	30	0	
9 5/8			
8 5/8 23#	1399.05	1399.05	CTs
7			
5 1/2			
4 1/2 10.5#	5092	5092	250 Sks
3			
2			
Lines Used			

Well treatment details:

Attach copy of cementing record. 2,500 MCF

Fraced Alexander; 4947-5003; 15 holes; 580 bbls. Total Fluid; 20,000 # 80/100
60,000 # 20/40
Fraced Benson; 4533-4689; 21 holes; 579 bbls. Total Fluid; 20,000 # 80/100
60,000 # 20/40

Coal was encountered at none Feet _____ Inches _____
Fresh water 50 Feet _____ Salt Water _____ Feet _____
Producing Sand Alexander; Benson Depth 4947-5003; 4533-4689
Alex BNSN

Formation	Color	Hard or Soft	Top Feet	Bottom Feet	Oil, Gas or Water	• Remarks
Cond.			G.L.	46		
Sand			46	50		
Shale			50	85		
Sand			85	86		
Red Rock			86	89		
Sand			89	93		
Red Rock & Shale			93	103		
Sand			103	111		
Shale & Red Rock			111	125		
Sand & Shale			125	137		
Sand			137	140		
Sand & Shale			140	143		
Sand			143	164		
Shale & Red Rock			164	206		
Sand			206	208		
Red Rock			208	225		
Sand			225	232		
Red Rock			232	249		
Sand			249	256		
Sand & Shale			256	264		
Sand			264	276		
Sand & Shale			276	289		
Sand			289	295		
Shale			295	299		
Sand			299	312		

SEP 9 1981

Formation	Color	Hard or Soft	Top Feet	Bottom Feet	Oil, Gas or Water	Remarks
Sand & Shale			312	331		
Red Rock			331	337		
Sand			337	360		
Red Rock			360	367		
Sand			367	370		
Shale			370	373		
Sand			373	379		
Red Rock & Shale			379	400		
Sand			400	412		
Shale & Red Rock			412	555		
Sand & Shale			555	647		
Red Rock			647	670		
Sand & Shale			670	874		
Sand			874	900		
Red Rock			900	903		
Sand & Shale			903	1265		
Shale			1265	1365		
Sand & Shale			1365	1427		
Sand			1427	1430		
Shale			1430	1500		
Sand			1500	1523		
Sand & Shale			1523	1620		
Shale & Red Rock			1620	1665		
Sand			1665	1693		
Shale			1693	1702		
Big Lime & Injun			1702	1825		
Sand & Shale			1825	2053		
Sand			2053	2130		
Sand & Shale			2130	2170		
Shale			2170	2200		
Sand & Shale			2200	2408		
Sand			2408	2415		
Sand & Shale			2415	3410		
Shale			3410	3458		
Sand & Shale			3458	4664		
Brown Sand (Benson)			4664	4667		
Shale			4667	4673		
White Sand			4673	4690		
Sand & Shale			4690	4869		
Sand & Shale			4869	4934		
Sand (Alexander)			4934	4979		
Sand & Shale			4979	5250	TD	

Date 8/21 1927

APPROVED Alton Skinner Owner

**STATE OF WEST VIRGINIA
DIVISION OF ENVIRONMENTAL PROTECTION, OFFICE OF OIL AND GAS
WELL WORK PERMIT APPLICATION**

22618

Well Operator: Meridian Exploration Corporation ⁴⁷⁴² 31805 (1) 562

Operator's Well Number: Burgess #3 1573-01 3) Elevation: 1035'

Well type: (a) Oil / or Gas / **Issued 9/30/96**
 (b) If Gas: Production x / Underground Storage / **Expires 9/30/98**
 Deep / Shallow /

Proposed Target Formation(s): Balltown ⁴³³ @ 3900', Speechley @ 3400'

6) Proposed Total Depth: 5530 ³⁹⁰⁰ feet

7) Approximate fresh water strata depths: 170'

8) Approximate salt water depths: None

9) Approximate coal seam depths: None

10) Does land contain coal seams tributary to active mine? Yes / No X

11) Proposed Well Work: Set plug. Perf & frac Balltown @

12) 3900', Perf & frac Speechley @ 3,400' Drill Plug.

CASING AND TUBING PROGRAM

TYPE	SPECIFICATIONS		FOOTAGE INTERVALS			CEMENT (cu. ft.)
	Size	Grade	Weight per ft.	For drilling	Left in well	
Conductor	11 3/4"			34	0	
Fresh Water						
Coal						
Intermediate	8 5/8"		23	1975	1975	CTS
Production	4 1/2"		10.5	5395	5395	3,200'
Tubing						
Liners						

PACKERS : Kind _____
 Sizes None
 Depths set _____

For Office of Oil and Gas Use Only

Fee(s) paid: Well Work Permit Reclamation Fund WPCP
 Plat WW-9 WW-2B Bond Agent
 (Type)

1) Date: 9/19/96
2) Operator's well number
Burgess #3 1573-01
3) API Well No: 47 - 017 - 02797 15
State County Permit

STATE OF WEST VIRGINIA - BUREAU OF ENVIRONMENT
DIVISION OF ENVIRONMENTAL PROTECTION
OFFICE OF OIL AND GAS

NOTICE AND APPLICATION FOR A WELL WORK PERMIT

4) Surface Owner(s) to be served:
(a) Name Ralph Cunningham
Address Rt. 1, Box 198-A
West Union, WV 26456
(b) Name _____
Address _____
(c) Name _____
Address _____
) Inspector Mike Underwood
Address RT. 2, Box 135
Salem, WV 26426-0135
Telephone (304) - _____

5) (a) Coal Operator:
Name None
Address _____
(b) Coal Owner(s) with Declaration
Name None
Address _____
Name _____
Address _____
(c) Coal Lessee with Declaration
Name None
Address _____

TO THE PERSON(S) NAMED ABOVE TAKE NOTICE THAT:

_____ Included is the lease or leases or other continuing contract or contracts by which I hold the right to extract oil and gas OR
_____ Included is the information required by Chapter 22, Article 6, Section 8(d) of the Code of West Virginia (see page 2)

I certify that as required under Chapter 22 of the West Virginia Code I have served copies of this notice and application, a location plat, and accompanying documents pages 1 through _____ on the above named parties, by:
_____ Personal Service (Affidavit attached)
_____ Certified Mail (Postmarked postal receipt attached)
_____ Publication (Notice of Publication attached)

I have read and understand Chapter 22-6 and 38 CSR 11-18, and I agree to the terms and conditions of any permit issued under this application.

I certify under penalty of law that I have personally examined and am familiar with the information submitted on this application form and all attachments, and that based on my inquiry of those individuals immediately responsible for obtaining the information, I believe that the information is true, accurate, and complete.

I am aware that there are significant penalties for submitting false information, including the possibility of fine and imprisonment.

Well Operator Meridian Exploration Corporation
By: John Guide John Guide
Its: Chief Engineer
Address Penn Center West Two, Suite 325
Pittsburgh, PA 15276
Telephone (412) 494-0604

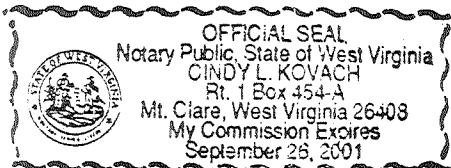

Subscribed and sworn before me this 4th day of September, 1996

Cindy L. Kovach Notary Public
My commission expires Sept. 26, 2001

OIL AND GAS WELL PERMIT APPLICATION

WELL TYPE: Oil ___ / Gas X /
(If "Gas", Production X / Underground storage ___ / Deep ___ / Shallow X /

LOCATION: Elevation: 940 Watershed: South Fork of Hughes River

District: Southwest County: Doddridge Quadrangle: Oxford 7.5

WELL OPERATOR Chase Petroleum
Address P.O. Drawer 369
Glenville, W.Va. 26351

DESIGNATED AGENT Alton Skinner
Address P.O. Drawer 369
Glenville, W.Va. 26351

OIL & GAS
ROYALTY OWNER N.H. Leggett, et al
Address Oxford, W.Va. 26414

COAL OPERATOR None
Address _____

ACREAGE 121

COAL OWNER(S) WITH DECLARATION ON RECORD:

SURFACE OWNER N.H. Leggett, et al
Address Oxford, W.Va. 26414

Name No Coal
Address _____

ACREAGE 121

Name _____

FIELD SALE (IF MADE) TO:
Name Uncommitted

Address _____
OIL & GAS DIVISION
DEPT. OF MINES

Address _____

COAL LESSEE WITH DECLARATION ON RECORD:

OIL AND GAS INSPECTOR TO BE NOTIFIED:
Name Paul Garrett

Name None
Address _____

The undersigned well operator is entitled to operate for oil or gas purposes at the above location under a deed ___ / lease X / other contract ___ / dated November 28, 1980, to the undersigned well operator from N.H. Leggett, et al (if said deed, lease or other contract has been recorded:)

Recorded on _____, 19____, in the office of the Clerk of the County Commission of _____ County, West Virginia, in _____ Book _____, at page _____. A permit is requested as follows

PROPOSED WORK: Drill X / Drill Deeper ___ / Redrill ___ / Fracture or stimulate X /
Plug off old formation ___ / Perforate new formation ___ /
Other physical change in well (specify) _____

--planned as shown on the work order on the reverse side hereof.

Above named coal operator, coal owner(s), and coal lessee are hereby notified that any they wish to make or are required to make by Code 522-4-3 must be filed with the Department of Mines within fifteen (15) days after the receipt of this Application by Department. This Permit Application and the enclosed plat and reclamation plan have been mailed or delivered by hand to the above named coal operator, coal owner(s), and coal lessee before the day of the mailing or delivery of this Permit Application to the Department of Mines, Charleston, West Virginia.

COPIES OF ALL
DIRECTLY TO:

Chase Petroleum

Alton Skinner
Well Operator

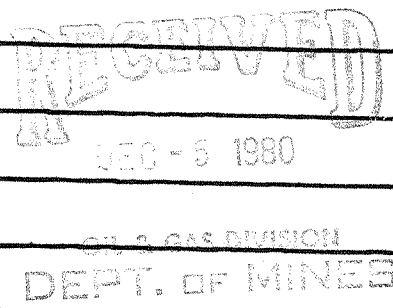

PROPOSED WORK ORDER

THIS IS AN ESTIMATE ONLY: ACTUAL INFORMATION MUST BE SUBMITTED ON FORM IV-35 UPON COMPLETION

DRILLING CONTRACTOR (IF KNOWN) S.W. Jack Drilling Co. Address Buckhannon, W.Va. 26201

GEOLOGICAL TARGET FORMATION, Alexander

Estimated depth of completed well, 5650 feet Rotary X / Cable tools / Approximate water strata depths: Fresh, 30 feet; salt, - feet. Approximate coal seam depths: No Coal Is coal being mined in the area? Yes / No X /

CASING AND TUBING PROGRAM

Table with columns: CASING OR TUBING TYPE, SPECIFICATIONS (Size, Grade, Weight per ft, New, Used), FOOTAGE INTERVALS (For drilling, Left in well), CEMENT FILL-UP OR SACKS (Cubic feet), PACKERS (Kinds, Sizes, Depths set, Perforations: Top, Bottom)

NOTE: Regulation 7.02 of the Department of Mines provides that the original and four copies of Form IV-2 must be filed with the Department, accompanied by (i) a plat in the form prescribed by Regulation 11, (ii) a bond in one of the forms prescribed by Regulation 12, or in lieu thereof the other security allowed by Code § 22-4-3, (iii) Form IV-9, "Reclamation Plan", applicable to the reclamation required by Code § 22-4-12b and Regulation 23, (iv) unless previously paid on the same well, the fee required by Code § 22-4-12a, and (v) if applicable, the consent required by Code § 22-4-8a from the owner of any water well or dwelling within 200 feet of the proposed well.

A separate Form IV-2 shall not be required for fracturing or stimulating a well where fracturing or stimulating is to be part of the work for which a permit is sought and is noted as such on the Form IV-2 filed in connection therewith.

THIS PERMIT MUST BE POSTED AT THE WELL SITE

All provisions being in accordance with Chapter 22, of the W. Va. Code, the location is hereby approved for drilling. This permit shall expire if operations have not commenced by 8-10-81

J. J. Murray Deputy Director - Oil & Gas Division

The following waiver must be completed by the coal operator and by any coal owner or coal lessee who has recorded a declaration under Code § 22-4-20, if the permit is to be issued within fifteen (15) days of receipt thereof:

W A I V E R

The undersigned coal operator / owner / lessee of the coal under this well location has examined this proposed well location. If a mine map exists which covers the area of the well location, the well location has been added to the mine map. The undersigned has no objection to the work proposed to be done at this location, provided, the well operator has complied with all applicable requirements of the West Virginia Code and the governing regulations.

By Its