

1.425
1.38W

G. DETTERMAN
39 0845
80 4130

(1.435)
(1.39W)

OIL & GAS ROYALTY OWNER(S)
W. H. SHULTE, HEIRS 100 AC.
ST. CLARA, W. VA.
SURFACE OWNER - 100 AC.
KENNETH CAPP
HURRICANE, W. VA.

DESIGNATED AGENT:
MR. ROBERT R. JONES
P.O. BOX 86
SAND FORK, W. VA. 26430

Minimum Error of Closure ONE PART IN 200'

Source of Elevation USGS BM ON BRIDGE ABUT. SOUTH 4900'

ELEVATION = 888'

I, the undersigned, hereby certify that this map is correct to the best of my knowledge and belief and shows all the information required by paragraph 6 of the rules and regulations of the oil and gas section of the mining laws of West Virginia.

Fracture GAS-DRILL-SHALLOW
New Location DELTAICAN SHALES-75' EST. DEPTH 3300'
Drill Depth
Abandonment

Signed: *Mark C. Echard*
Squares: N S E W

WELL OPERATOR/
Company ROCKWELL PETROLEUM COMPANY
Address RD. BOX 86 SAND FORK, W. VA. 26430
Farm W. H. SHULTE LEASE (K. CAPP)
Tract _____ Acres 100.27 Lease No. _____
Well (Farm) No. ONE Serial No. _____
Elevation (Spirit Level) 938'
Quadrangle NEW MILTON 7.5' (VADIS) 15' WC
County BOONVILLE District COYE
SURVEYOR/
Engineer MARK C. ECHARD
SURVEYORS/
Engineer's Registration No. 490
File No. _____ Drawing No. _____
Date AUGUST 12 1919 Scale 1" = 500'

STATE OF WEST VIRGINIA
DEPARTMENT OF MINES
OIL AND GAS DIVISION
CHARLESTON

WELL LOCATION MAP
FILE No. 47-017-2705
FORMERLY 017-2474

+ Denotes location of well on United States Topographic Maps, scale 1 to 25,000, latitude and longitude lines being represented by border lines as shown.
- Denotes one inch spaces on border line of original tracing.

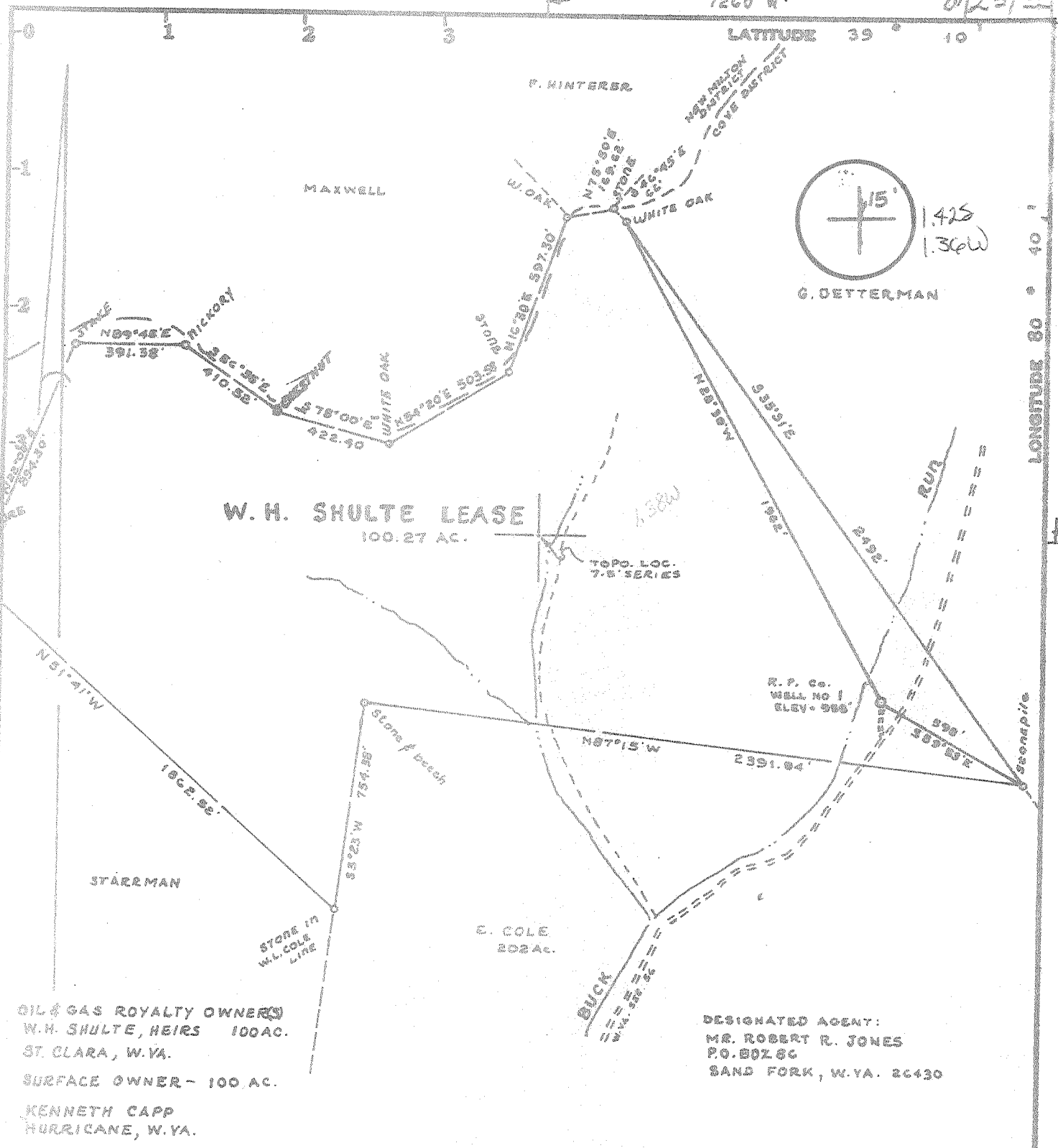

W. H. SHULTE LEASE
100.27 AC.

OIL & GAS ROYALTY OWNERS
W. H. SHULTE, HEIRS 100 AC.
ST. CLARA, W. VA.
SURFACE OWNER - 100 AC.
KENNETH CAPP
HURRICANE, W. VA.

DESIGNATED AGENT:
MR. ROBERT R. JONES
P.O. BOX 86
SAND FORK, W. VA. 26430

Minimum Error of Closure ONE PART IN 200'

Source of Elevation USGS BM ON BRIDGE ABUT. SOUTH 4900'

ELEVATION = 888'

I, the undersigned, hereby certify that this map is correct to the best of my knowledge and belief and shows all the information required by paragraph 6 of the rules and regulations of the oil and gas section of the mining laws of West Virginia.

- Fracture..... GAS-DRILL-SHALLOW
- New Location..... DEVONIAN SHALE-TY EST. DEPTH 5300'
- Drill Deeper.....
- Abandonment.....

Signed: Mark C. Echard
Squares: N S E W

Map No. _____

WELL OPERATOR/
Company ROCKWELL PETROLEUM COMPANY

Address P.O. BOX 86 SAND FORK, W. VA. 26430

Farm W. H. SHULTE LEASE (K. CAPP)

Tract _____ Acres 100.27 Lease No. _____

Well (Farm) No. ODE Serial No. _____

Elevation (Spirit Level) 958'

Quadrangle NEW MILTON 7.5' (VADIS) 15'

County DODDRIDGE District COVE

Engineer MARK C. ECHARD

Engineer's Registration No. 490

File No. _____ Drawing No. _____

Date AUGUST 18, 1979 Scale 1" = 500'

STATE OF WEST VIRGINIA
DEPARTMENT OF MINES
OIL AND GAS DIVISION
CHARLESTON

WELL LOCATION MAP

FILE NO. 47-017-2474
was: _____
new: 2705

+ Denotes location of well on United States Topographic Maps, scale 1 to 24,000, latitude and longitude lines being represented by border lines as shown.

SEP 7 1979

-- Denotes one inch spaces on border line of original tracing.

Form IV-35
(Reverse)

WELL OPERATOR'S REPORT //

8-78,

OF
DRILLING, FRACTURING AND/OR STIMULATING, OR PHYSICAL CHANGE

Well Type: Oil / Gas / Liquid Injection / Waste Disposal
(If "Gas", Production / Underground storage / Deep / Shallow /)
Elevation: 958' Watershed: Buck Run
District: Cove County: Doddridge Quadrangle: New Milton

Operator: Rockwell Petroleum Company DESIGNATED AGENT Robert R. Jones
Address: P O Box 86 Address: P O Box 86
Sand Fork, WV 26430 Sand Fork, WV 26430

Work: Drill / Convert / Drill deeper / Redrill / Fracture or stimulate
Plug off old formation / Perforate new formation
Other physical change in well (specify) _____

ISSUED ON April 25, 19 80 OIL & GAS INSPECTOR FOR THIS WORK:
Name Paul Garrett
Address Clarksburg, WV 26301
622-3871

Target Formation: Devonian Shale Depth 5339 feet
Depth of completed well, 5460 feet Rotary / Cable Tools
Enter strata depth: Fresh, 120 feet; salt, _____ feet.
Coal seam depths: None Is coal being mined in the area? No
Work was commenced May 12, 19 80, and completed May 17, 19 80

LOGGING AND TUBING PROGRAM

LOG TYPE	SPECIFICATIONS				FOOTAGE INTERVALS		CEMENT FILL-UP OR SACKS (Cubic feet)	PACKERS
	Size	Grade	Weight per ft	New	Used	For drilling		
Water	8 5/8					1141'	1141'	To surface
Diaphragm								
Isolation	4 1/2						5403'	150 sks
								Depth set
								Perforations:
								Top Bottom

RECEIVED
JUN 2 1980
OIL & GAS DIVISION
DEPT. OF MINES

Flow Data
Producing formation Benson Pay zone depth 5009 feet
Gas: Initial open flow, _____ Mcf/d Oil: Initial open flow, _____ Bbl/d
Final open flow, _____ Mcf/d Final open flow, _____ Bbl/d
Time of open flow between initial and final tests, _____ hours

Static rock pressure, _____ psig (surface measurement) after _____ hours shut in
[if applicable due to multiple completion--]
Producing formation Elk ALEX Pay zone depth 5339 feet
Gas: Initial open flow, _____ Mcf/d Oil: Initial open flow, _____ Bbl/d
Final open flow, 910 Mcf/d Final open flow, _____ Bbl/d
Time of open flow between initial and final tests, 3 hours
Static rock pressure, 1840 psig (surface measurement) after 55 hours shut in

JUL 7 1980

DETAILS OF PERFORATED INTERVALS, FRACTURING OR STIMULATING, PHYSICAL CHANGE, ETC.

Fractured May 24, 1980

~~51k~~ **ALEX**
 20,000 lb. 80/100 sand
 40,000 lb. 20/40 sand
 2200 lb. breakdown
 519 bbls. water
 15.2 BPM at 2800 lb.

Benson - 20,000 lb. 80/100 sand
 40,000 lb. 20/40 sand
 2150 lb. breakdown
 480 bbls. water
 16.7 BPM at 1810 lb.

Perforations - 5124 - 5339, 8 holes

Perforations - 5007 - 5009, 5 holes

WELL LOG

FORMATION	Color	Hard or Soft	Top Feet	Bottom Feet	Remarks Including indication of all free and salt water, coal, oil and gas
Surface			0	120	
Sand			120	124	Water
Red Rock			124	132	
Slate			132	280	
Red Rock			280	291	
Slate			291	303	
Shale			303	495	
Red Rock			495	522	
Sand			522	601	
Red Rock			601	629	
Shale			629	942	
Sand			942	981	
Red Rock			981	1098	
Shale			1098	1420	
Sand			1420	1488	
Shale			1488	1930	
Sand			1930	1965	
Shale			1965	2045	
Lime			2045	2074	
Slate			2074	2085	
Lime			2085	2255	
Shale			2255	2320	
Sandy Shale			2320	2410	
Shale			2410	2525	
Sand			2525	2554	
Shale			2554	2738	
Sand			2738	2748	
Shale			2748	3080	
Sand			3080	3092	
Shale			3092	3450	
Sandy Shale			3450	3460	
Shale			3460	5002	
Sandy Shale			5002	5014	Show of gas
Shale			5014	5120	
Shale with sand stringers ALEX			5120	5350	Show of gas
Shale			5350	5460	
Total Depth			5460		

Rockwell Petroleum Company

Well Operator

By

Its Partner

NOTE: Regulation 2.02(i) provides as follows:

"The term 'log' or 'well log' shall mean a systematic, detailed geological record of all formations, including coal, encountered in the drilling of a well."

COPY

Date: April 24, 19 80

[08-78]

OIL AND GAS WELL PERMIT APPLICATION

Operator's Well No. Shulte #1
API Well No. 47 - 017 - 2705
State County Permit

WELL TYPE: Oil / Gas X /
(If "Gas", Production X / Underground storage / Deep / Shallow X /)

LOCATION: Elevation: 958' Watershed: Buck Run
District: Cove County: Doddridge Quadrangle: New Milton

WELL OPERATOR Rockwell Petroleum Company
Address P O Box 86
Sand Fork, WV 26430

DESIGNATED AGENT Robert R. Jones
Address P O Box 86
Sand Fork, WV 26430

OIL & GAS ROYALTY OWNER W. H. Shulte Heirs
Address St. Clara, WV

COAL OPERATOR N/A
Address

ACREAGE 100

COAL OWNER(S) WITH DECLARATION ON RECORD:

SURFACE OWNER Kenneth Kapp
Address Hurricane, WV

Name N/A
Address

ACREAGE 100

Name N/A
Address

FIELD SALE (IF MADE) TO:
Name N/A
Address

COAL LESSEE WITH DECLARATION ON RECORD:
Name N/A
Address

OIL & GAS INSPECTOR TO BE NOTIFIED
Name Paul Garrett
Address Clarksburg, WV 26301
622-3871

RECEIVED
APR 25 1980
OIL & GAS DIVISION
DEPT. OF MINES

The undersigned well operator is entitled to operate for oil or gas purposes at the above location under a deed / lease X / other contract / dated January 3, 19 79, to the undersigned well operator from W. H. Shulte Heirs.

If said deed, lease, or other contract has been recorded:]
Recorded on August 18, 19 79, in the office of the Clerk of the County Commission of Doddridge county, West Virginia, in Deed Book 110 at page 223. A permit is requested as follows:

PROPOSED WORK: Drill X / Drill deeper / Redrill / Fracture or stimulate /
Plug off old formation / Perforate new formation /
Other physical change in well (specify)

--planned as shown on the work order on the reverse side hereof.

The above named coal operator, coal owner(s), and coal lessee are hereby notified that any objection they wish to make or are required to make by Code § 22-4-3 must be filed with the Department of Mines within fifteen (15) days after the receipt of this Application by the Department.

Copies of this Permit Application and the enclosed plat and reclamation plan have been mailed by registered mail or delivered by hand to the above named coal operator, coal owner(s), and coal lessee on or before the day of the mailing or delivery of this Permit Application to the Department of Mines at Charleston, West Virginia.

PLEASE SUBMIT COPIES OF ALL GEOLOGICAL LOGS DIRECTLY TO:
WEST VIRGINIA OIL AND GAS CONSERVATION COMMISSION
111 WASHINGTON STREET EAST
CHARLESTON, WV 25311
TELEPHONE: (304) 348-3092

BLANKET BOND

Rockwell Petroleum Company
Well Operator
By Mark R. Luvell
Its Partner

COPY

PROPOSED WORK ORDER

THIS IS AN ESTIMATE ONLY:
ACTUAL INFORMATION MUST BE SUBMITTED ON FORM IV-35 UPON COMPLETION

DILLING CONTRACTOR (IF KNOWN) Union Drilling, Inc.
Address Drawer 40
Buckhannon, WV 26201

GEOLOGICAL TARGET FORMATION, Devonian Shale

Estimated depth of completed well, 5300 feet Rotary X / Cable tools /

Approximate water strata depths: Fresh, 123 feet; salt, N/A feet.

Approximate coal seam depths: N/A Is coal being mined in the area? Yes / No X

DRILLING AND TUBING PROGRAM

DRILLING OR TUBING TYPE	SPECIFICATIONS					FOOTAGE INTERVALS		CEMENT FILL-UP OR SACKS (Cubic feet)	PACKERS
	Size	Grade	Weight per ft	New	Used	For drilling	Left in well		
Conductor									Kinds
Fresh water	8 5/8					1125'	1125'	To surface	
Intermediate									Sizes
Production	4 1/2						5300'	160 sks	Depths set
Logging									Perforations:
Packers									Top Bottom

NOTE: Regulation 7.02 of the Department of Mines provides that the original and four copies of Form IV-2 must be filed with the Department, accompanied by (i) a plat in the form prescribed by Regulation 11, (ii) a bond in one of the forms prescribed by Regulation 12, or in lieu thereof the other security allowed by Code § 22-4-2, (iii) Form IV-9, "Reclamation Plan", applicable to the reclamation required by Code § 22-4-12b and Regulation 23, (iv) unless previously paid on the same well, the fee required by Code § 22-4-12a, and (v) if applicable, the consent required by Code § 22-4-8a from the owner of any water well or dwelling within 200 feet of the proposed well.

A separate Form IV-2 shall not be required for fracturing or stimulating a well where fracturing or stimulating is to be part of the work for which a permit is sought and this notice is posted at the well site.

All provisions being in accordance with Chapter 22, of the W. Va. Code, the location is hereby approved for drilling. This permit shall expire if operations have not commenced by 1-5-81.

Robert L. [Signature]

Deputy Director - Oil & Gas Division

The following waiver must be completed by the coal operator and by any coal owner or coal lessee who has recorded a declaration under Code § 22-4-20, if the permit is to be issued within fifteen (15) days of receipt thereof:

W A I V E R

The undersigned coal operator / owner / lessee / of the coal under this well location has examined this proposed well location. If a mine map exists which covers the area of the well location, the well location has been added to the mine map. The undersigned has no objection to the work proposed to be done at this location, provided, the well operator has complied with all applicable requirements of the West Virginia Code and the governing regulations.

Date: , 19

By
Its

[08-78]

COPY

OIL AND GAS WELL PERMIT APPLICATION

Operator's
Well No. Shulte #1

API Well No. 47 - 017 - 2474
State County Permit

WELL TYPE: Oil / Gas X /
(If "Gas", Production X / Underground storage / Deep / Shallow X /)

LOCATION: Elevation: 958' Watershed: Buck Run
District: Cove County: Doddridge Quadrangle: New Milton 7.5'

WELL OPERATOR Rockwell Petroleum Company
Address P O Box 86
Sand Fork, WV 26430

DESIGNATED AGENT Robert R. Jones
Address P O Box 86
Sand Fork, WV 26430

OIL & GAS
ROYALTY OWNER W. H. Shulte, Heirs
Address St. Clara, WV

COAL OPERATOR N/A
Address

ACREAGE 100
SURFACE OWNER Kenneth Capp
Address Hurricane, WV
ACREAGE 100

COAL OWNER(S) WITH DECLARATION ON RECORD:
Name N/A
Address
Name N/A
Address

FIELD SALE (IF MADE) TO:
Name N/A
Address

COAL LESSEE WITH DECLARATION ON RECORD:
Name N/A
Address

OIL & GAS INSPECTOR TO BE NOTIFIED
Name Paul Garrett
Address Clarksburg, WV
622-3871

RECEIVED
AUG 23 1979

The undersigned well operator is entitled to operate for oil or gas purposes at the above location under a deed / lease *** / other contract / dated January 3, 19 79, to the undersigned well operator from W. H. Shulte Heirs
[If said deed, lease, or other contract has been recorded:]

OIL & GAS DIVISION
DEPT. OF MINES

Recorded on August 18, 19 79, in the office of the Clerk of the County Commission of Doddridge County, West Virginia, in Deed Book 110 at page 225. A permit is requested as follows:

PROPOSED WORK: Drill X / Drill deeper / Redrill / Fracture or stimulate /
Plug off old formation / Perforate new formation /
Other physical change in well (specify)

--planned as shown on the work order on the reverse side hereof.

The above named coal operator, coal owner(s), and coal lessee are hereby notified that any action they wish to make or are required to make by Code § 22-4-3 must be filed with the Department of Mines within fifteen (15) days after the receipt of this Application by the Department.

Copies of this Permit Application and the enclosed plat and reclamation plan have been mailed by registered mail or delivered by hand to the above named coal operator, coal owner(s), and coal lessee on or before the day of the mailing or delivery of this Permit Application to the Department of Mines at Charleston, West Virginia.

PLEASE SUBMIT COPIES OF ALL
PHYSICAL LOGS DIRECTLY TO:
WEST VIRGINIA OIL AND GAS
CONSERVATION COMMISSION
5 WASHINGTON STREET EAST
CHARLESTON, WV 25311
TELEPHONE: (304) 348-3092

Rockwell Petroleum Company
Well Operator
By Robert R. Jones
Its Partner

[08-78]

PROPOSED WORK ORDER

THIS IS AN ESTIMATE ONLY:
ACTUAL INFORMATION MUST BE SUBMITTED ON FORM IV-35 UPON COMPLETION

DRILLING CONTRACTOR (IF KNOWN) Union Drilling, Inc
Address Drawer 40
Buckhannon, WV 26201

GEOLOGICAL TARGET FORMATION, Devonian Shale

Estimated depth of completed well, 5300' feet Rotary X / Cable tools /

Approximate water strata depths: Fresh, 123 feet; salt, feet.

Approximate coal seam depths: None **Is coal being mined in the area?** Yes / No X /

CASING AND TUBING PROGRAM

CASING OR TUBING TYPE	SPECIFICATIONS				FOOTAGE INTERVALS		CEMENT FILL-UP OR SACKS (Cubic feet)	PACKERS
	Size	Grade	Weight per ft	New	Used	For drilling		
Conductor								Kinds
Fresh water	8 5/8					1125 ft	1125 ft	To surface
Coal								Sizes
Intermediate								
Production	4 1/2						5300'	160 sks
Tubing								
Liners								Perforations:
								Top Bottom

NOTE: Regulation 7.02 of the Department of Mines provides that the original and four copies of Form IV-2 must be filed with the Department, accompanied by (i) a plat in the form prescribed by Regulation 11, (ii) a bond in one of the forms prescribed by Regulation 12, or in lieu thereof the other security allowed by Code § 22-4-2, (iii) Form IV-9, "Reclamation Plan", applicable to the reclamation required by Code § 22-4-12b and Regulation 23, (iv) unless previously paid on the same well, the fee required by Code § 22-4-12a, and (v) if applicable, the consent required by Code § 22-4-8a from the owner of any water well or dwelling within 200 feet of the proposed well.

A separate Form IV-2 shall not be required for fracturing or stimulating a well where fracturing or stimulating is to be part of the work for which a permit is sought and is included on the Form IV-2 filed in connection therewith.

All provisions being in accordance with Chapter 22, of the W. Va. Code, the location is hereby approved for drilling. This permit shall expire if operations have not commenced by 4-23-80.

John H. [Signature]
Deputy Director - Oil & Gas Division

The following waiver must be completed by the coal operator and by any coal owner or coal lessee who has recorded a declaration under Code § 22-4-20, if the permit is to be issued within fifteen (15) days of receipt thereof:

W A I V E R

The undersigned coal operator / owner / lessee / of the coal under this well location has examined this proposed well location. If a mine map exists which covers the area of the well location, the well location has been added to the mine map. The undersigned has no objection to the work proposed to be done at this location, provided, the well operator has complied with all applicable requirements of the West Virginia Code and the governing regulations.

Date: , 19

By
Its