

LATITUDE 39° 12' 30"



80° 42' 30"

LONGITUDE

7'5 OGIS topo location

7.5' loc	<u>0.625</u>	15' loc	<u>3.505</u>
	<u>1.94W</u>	(calc.)	<u>4.17W</u>

Company \_\_\_\_\_

Farm \_\_\_\_\_

Elevation topo est. 1140

Vad's NW

Quad NEW MILTON 7 1/2'

County DODD RIDGE

District NEW MILTON

WELL LOCATION MAP

File No. 017-2238

LATITUDE 39° 12' 30"

LONGITUDE 80° 42' 30"

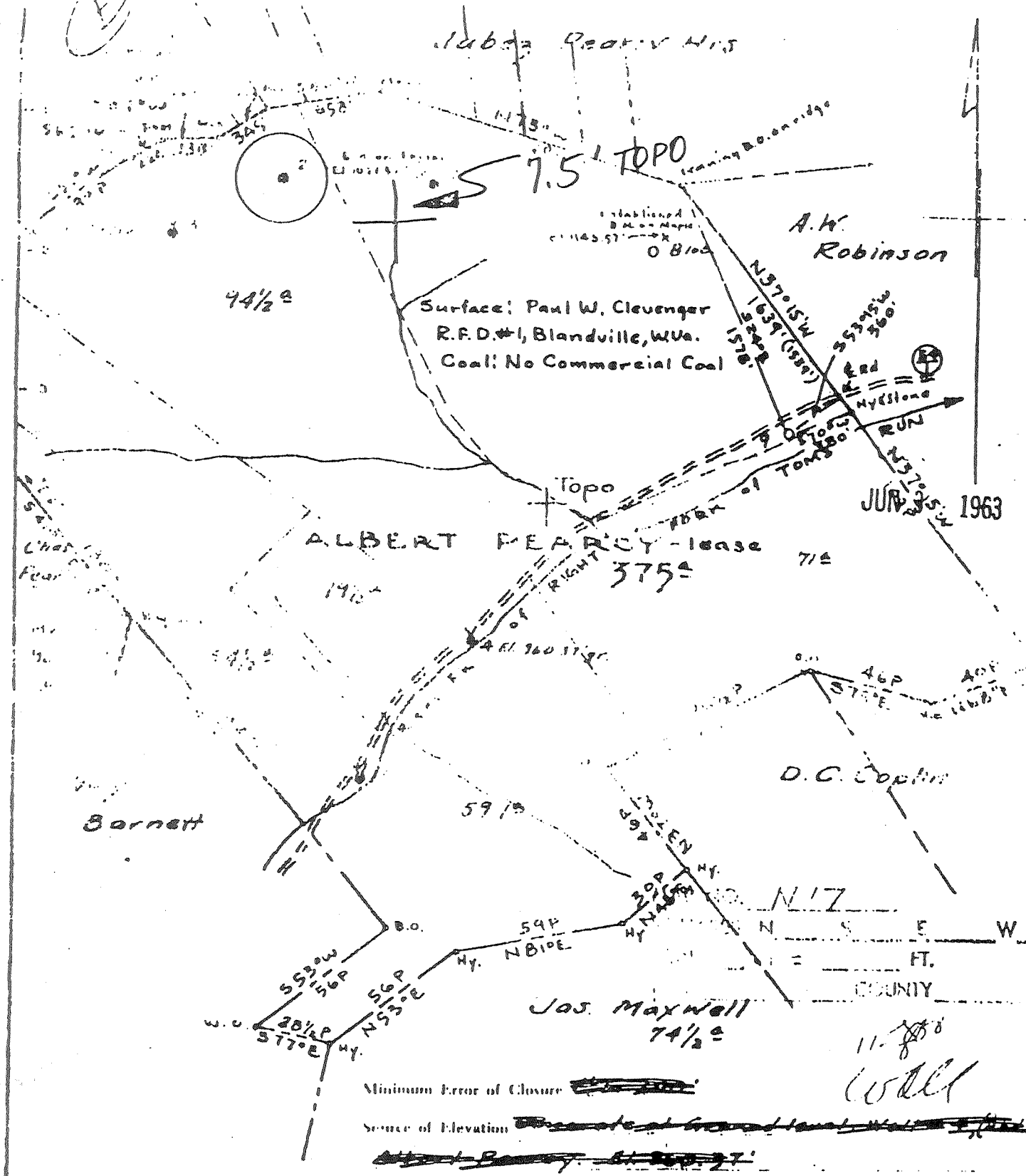

Minimum Error of Closure ~~1/1000~~

Source of Elevation ~~State of West Virginia~~

I, the undersigned hereby certify that this map is correct to the best of my knowledge

(+) DENOTES LOCATION OF WELL ON UNITED STATES TOPOGRAPHIC MAPS  
 FORM IV-C  
 (8-78)  
 N17 S18 W8



DATE JAN. 25, 19 79  
 OPERATOR'S WELL NO. 2  
 API WELL NO. 47-017-2238  
 STATE COUNTY PERMIT

STATE OF WEST VIRGINIA  
 DEPARTMENT OF MINES  
 OIL AND GAS DIVISION

WELL TYPE: OIL  GAS  LIQUID INJECTION  WASTE DISPOSAL   
 (IF "GAS", PRODUCTION  STORAGE  DEEP  SHALLOW   
 LOCATION: ELEVATION \_\_\_\_\_ WATER SHED Wesley Fork  
 DISTRICT New Milton COUNTY DODDRIDGE  
 QUADRANGLE 7.5  
 SURFACE OWNER Vadis ACREAGE \_\_\_\_\_  
 OIL & GAS ROYALTY OWNER \_\_\_\_\_ LEASE NO. \_\_\_\_\_  
 PROPOSED WORK: DRILL  CONVERT  DRILL DEEPER  REDRILL  FRACTURE OR STIMULATE  PLUS OFF OLD FORMATION  PERFORATE NEW FORMATION  OTHER PHYSICAL CHANGE IN WELL (SPECIFY) \_\_\_\_\_  
 PLUS AND ABANDON  CLEAN OUT AND REPLUS   
 TARGET FORMATION \_\_\_\_\_ ESTIMATED DEPTH \_\_\_\_\_  
 WELL OPERATOR PENNZOIL COMPANY DESIGNATED AGENT JAMES A. CREWS  
 ADDRESS P. O. BOX 1588 ADDRESS P. O. BOX 1588  
PARKERSBURG, WV PARKERSBURG, WV

ALBERT PEARCY - 7

Well No. 2 A. S. Pearey Farm Acres  
 Lease No. \_\_\_\_\_ District \_\_\_\_\_ County Wade State \_\_\_\_\_  
 Contractor Altamberg D. L. Co. Contractor  
 Drilling Commenced June 23 1900 Drilling Completed Aug 11 1900  
 N. S. E. W.

ROCK FORMATION	TOP	BOTTOM	STEEL LINE MEASUREMENT	REMARKS
<u>1st Sand</u>	<u>357</u>	<u>440</u>		
<u>Coar Run</u>	<u>1100</u>	<u>1115</u>		
<u>Salt</u>	<u>1272</u>	<u>1315</u>		
<u>Magnon</u>	<u>1585</u>	<u>1650</u>		
<u>Big Lime</u>	<u>1810</u>	<u>1930</u>		
<u>Big Shale</u>	<u>1930</u>	<u>2010</u>		
<u>Shaly Sand</u>	<u>2570</u>	<u>2583</u>		
<u>Shaly</u>	<u>2583</u>	<u>2588</u>		
<u>Dil</u>	<u>2589</u>			
<u>London Sand</u>	<u>2588</u>	<u>2593</u>		
<u>Total Depth</u>		<u>2605</u>		

CASING RECORD AS TALLIED. NOT STEEL LINE MEASUREMENT

SIZE	PUT IN WELL		PULLED OUT		LEFT IN WELL		Shot Date	Amount	Sand	Result	Packer Size	Depth Set
	FEET	IN.	FEET	IN.	FEET	IN.						
<u>10</u>	<u>387</u>		<u>387</u>				<u>6-14-03</u>					
<u>8 1/4</u>	<u>1009</u>		<u>1009</u>				<u>7-27-03 / 9-19-25</u>	<u>30 QTS</u>		<u>Water</u>		
<u>1 3/8</u>	<u>1420</u>							<u>160 QTS</u>				
<u>5 3/4</u>	<u>2075</u>											

Production First 24 Hours \_\_\_\_\_ Bbls. Gas Test \_\_\_\_\_  
 Approved by \_\_\_\_\_ Superintendent \_\_\_\_\_

47-017-2738

Well No. **6238** *Albert Pearcey* Farm.  
 Lease No. *Shrub* Township *Dodge* County *W*  
 Rig built by *G. H. Ross* les Contractor.  
 Well drilled by *Dufour* les  
 1098 Began drilling *July 8* 1903 Completed *Aug 11* 1903

Rock Formation	Top	Bottom	Remarks
Conductor	0	15	Shot May 22 05-30 ft
Coals	255	252	" May 6-27-40 ft
Bluff Sand	385	425	
Coarse Sand	1065	1090	
"	1170	1240	
Shalt	1360	1423	Water at 1365
"	1550	1580	
"	1610	1685	
Little Limestone	1840	1855	
Beucit Limestone	1870		
Blue Monday	1872	1892	
Big Limestone	1842	1947	
Dryum Sand	1947	2042	
Oil	1973	1980	Shot at 1972
Total Depth.		2047	

*30 bbls 12 1/2 24 34*

Casing Records.

Put in	Pulled	Depth
100	476-2	476-2
8 1/2	1187-2	1182-2
5 1/2	1443-	1443-
0 1/2	none	none

*Log # = Sours depth*

*Log Sept 2-1903 2045. well closed when shot used*

47-017-27  
017-2238