

1702198 P

WW-7
8-30-06



West Virginia Department of Environmental Protection
Office of Oil and Gas
WELL LOCATION FORM: GPS

API: 47-017-2198 WELL NO.: 8
FARM NAME: J. H. Bode
RESPONSIBLE PARTY NAME: S. L. Meadows, Jr. Production, Inc.
COUNTY: Doddridge DISTRICT: Cove
QUADRANGLE: Oxford 7.5
SURFACE OWNER: Timothy Defazio
ROYALTY OWNER: S. L. Meadows, Jr. Production, Inc.
UTM GPS NORTHING: 4,334,649 (NAD 83)
UTM GPS EASTING: 521,316 (NAD 83) GPS ELEVATION: 328 m or 1076 feet

The Responsible Party named above has chosen to submit GPS coordinates in lieu of preparing a new well location plat for a plugging permit or assigned API number on the above well. The Office of Oil and Gas will not accept GPS coordinates that do not meet the following requirements:

- Datum: NAD 1983, Zone: 17 North, Coordinate Units: meters, Altitude: height above mean sea level (MSL) – meters.
- Accuracy to Datum – 3.05 meters
- Data Collection Method:
Survey grade GPS : Post Processed Differential
Real-Time Differential
Mapping Grade GPS : Post Processed Differential
Real-Time Differential

Received
Office
MAY 13 2015

4. **Letter size copy of the topography map showing the well location.**
I the undersigned, hereby certify this data is correct to the best of my knowledge and belief and shows all the information required by law and the regulations issued and prescribed by the Office of Oil and Gas.

[Signature] Professional Surveyor March 11, 2015
Signature Title Date

01/08/2016

SUBJECT WELL
J.H. Bode No.8
47-017-2198

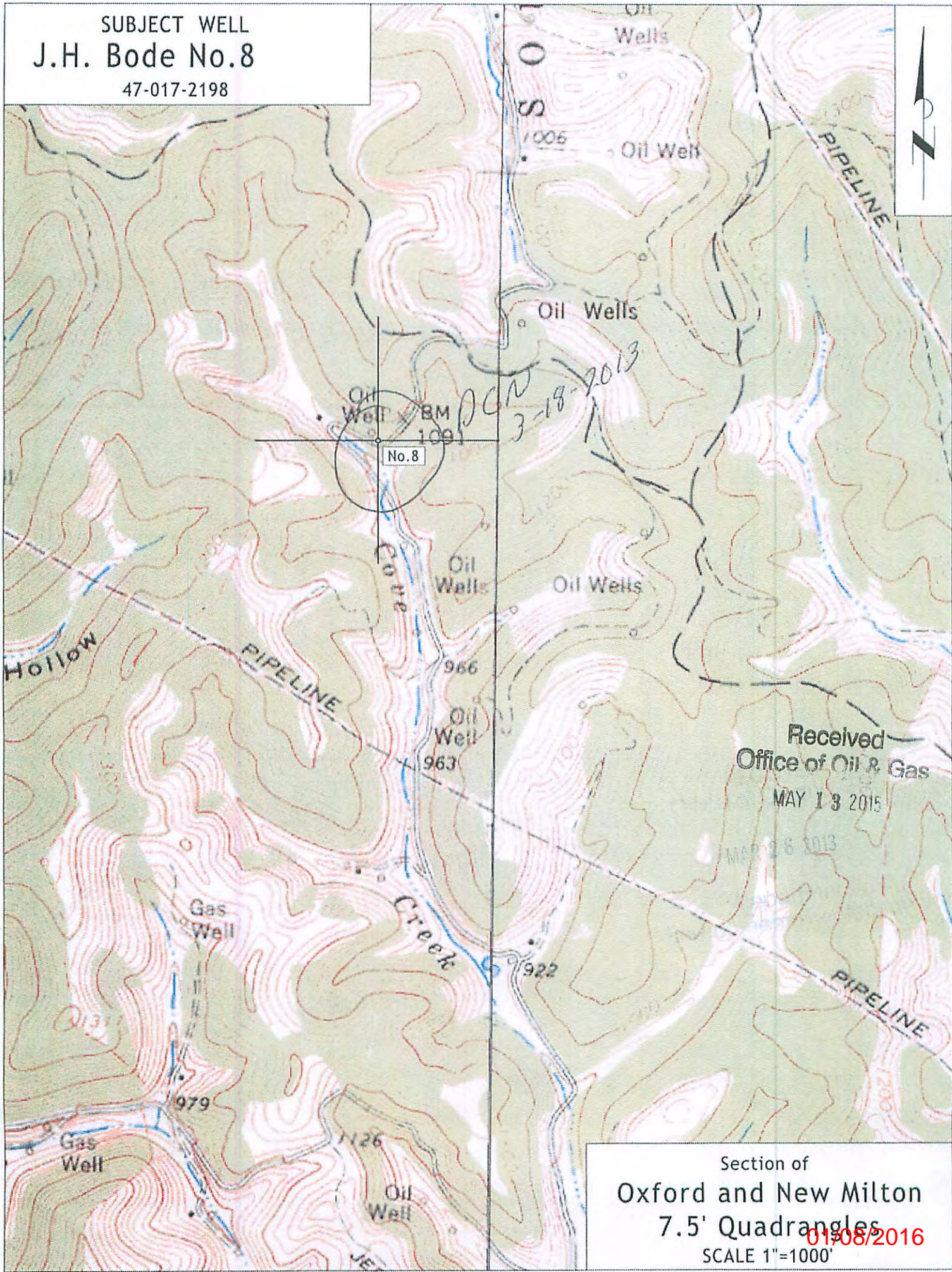

Received
Office of Oil & Gas
MAY 13 2015

MAY 26 2013

Section of
Oxford and New Milton
7.5' Quadrangles
SCALE 1"=1000'

01/08/2016