

LATITUDE 39° 22' 30"

LONGITUDE 110° 58' 08"



7'5 OGIS topo location

7.5' loc,	<u>1.97 S</u>	15' loc	<u>4.85 S</u>
	<u>0.76 W</u>	(calc.)	<u>0.76 W</u>

Company _____

Farm _____

Elev. Topo est. 1330'
Centerpoint c

Quad SALEM 7 1/2'

County DODDRIDGE

District McCLELLAN

WELL LOCATION MAP

File No. 017-2170

Down

The Wheeling Nail Gas Company.
LOCATION FOR WELL No. 1622

Lease No. 2791 for 188 Acres, Sedalia District.

DESCRIPTION

Well No. 2 on farm of J. J. Downs Mrs.
McClellan Dis't., Twp. Doddridge County W. Va.
350 feet from West line of Williams Farm.
350 feet from North line of H. J. Shayhen Farm.
feet from line of Farm.
feet of well on Farm.

As shown on sketch below. Scale of sketch: 1" equals 1320 feet.

Location made May 12 1913 Signed C. E. Baker

Reservation around Buildings 500 Feet.

Lat. 39° 20' 48"
Long. 80° 35' 49"

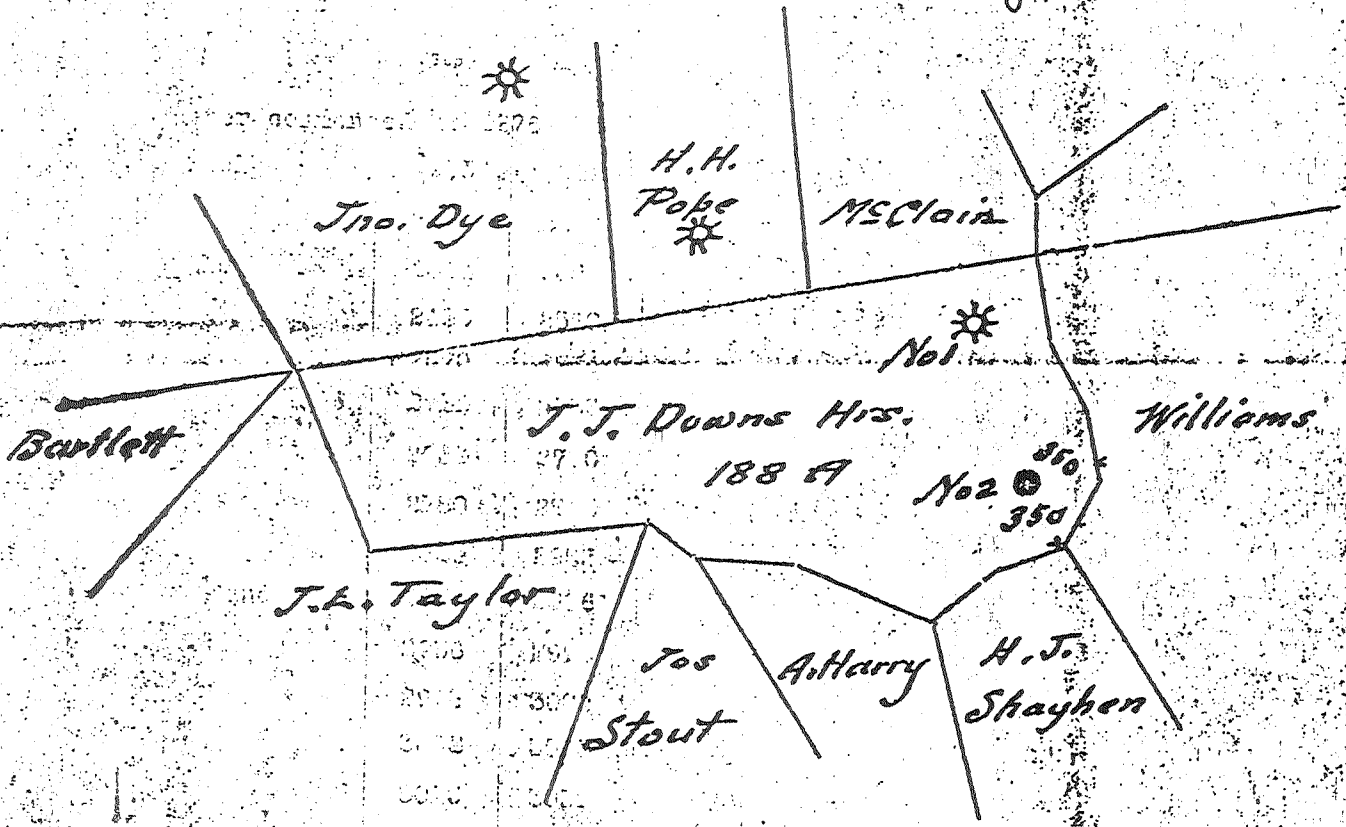

017-2170

Chas. E. Baker, Former Dist. Supt. Pittsburgh, Pa., May 21 - 1913.
Sedalia W. Va.

You are hereby authorized to commence work on above well at once, as well must be commenced by at once 1913, and must be completed by 1913.

APPROVED

All charges for labor and material incident to above well must be charged to this Well No. 1622

Location checked and approved or changed as noted, for following reasons:

Division *Sedalia 7769*

THE MANUFACTURERS LIGHT AND HEAT CO.
Farmers Bank Building, Pittsburgh, Penna.

017-2170 188 Acres
Farm

Record of Well No. 1622 on J. J. Downs

-Sedalia Field Sedalia District Doddridge County W. Va. State
Rig commenced 190 Completed 190

Drilling commenced June 17, 1913 Completed July 31, 1913

Cost per foot Contractor Kellen & Moriarty Address Salem, W. Va.

Drillers' names W. H. Pickard & Geo Underwood

BOILER			ENGINE			RIG			
H. P.	No.	Name of Maker	H. P.	No.	Name of Maker	New	Old	Height	Name of Builder
						New	-	84	J. F. Kendall

CONDUCTOR AND CASING USED IN DRILLING										
Conductor	13 inch	10 inch	8 1/2 inch	6 1/2 inch	6 inch	5 1/2 inch	5 3/16 inch	6 inch	4 inch	
16	-	-	1450	2169						

CONDUCTOR AND CASING LEFT IN WELL										
Conductor	13 inch	10 inch	8 1/2 inch	6 1/2 inch	6 inch	5 1/2 inch	5 3/16 inch	6 inch	inch	3 inch
16	-	-	1450	2169						

OIL WELL						GAS WELL				
When Shot	Size of Torpedo	1st Day's Production	Tubing	Rods	Tanks	Size of Packer	Depth Set	Packed With	1st Minute's Pressure	Rock Press
			Top	Bottom	Thickness				80	41

FORMATION	Top	Bottom	Thickness	REMARKS
Native Coal	470	472	2	
Pgh.	915	922	7	
Big Dunkard	1435	1445	10	
Gas Sand	1600	1615	15	
1st Salt Sand	1670	1705	35	
2nd "	1800	1845	45	
Water	1805			
Maxon	2070	2100	30	Four bailers
Little Lime	2140	2145	5	
Pencil Cave	2146	2148	2	
Big Lime	2155	2220	65	
Big Injun	2220			
Gas	2247	2262	15	2 6/10 Water in 6 5/8 casing
Total Depth	2276			Shut in on 6 5/8 casing

test

Shut in on 6 5/8 casing
 1/2 - 50 #
 1 - 80
 2 - 125
 3 - 160
 4 - 190
 5 - 220
 60 350
 12 hours 410

W. C. Baker

017-2170

Examined above information and measurements and found to be correct by

Examined and approved by

Kellen & Moriarty Contractor

Superintendent of Co.

NOTE.-The above blank must be filled out carefully by the Contractor with a complete and accurate record of the Well, and accompany, when presented for payment. All formations and known sands must be given by their proper name, with steel line measurements, and under the head of "Remarks" must be recorded in what sand and at what depth Oil, Gas or Water was found, the quantity, of course the quality of the sand, and thickness of bed.

Division _____

Company _____

Record of Well No. 1422 on _____

Farm _____ Acre _____
 County _____ State _____

Rig Commenced 19 _____ Completed 19 _____
 Drilling Commenced 19 _____ Completed 19 _____
 Contractor _____ Address _____
 Driller' Name _____

CASING AND TUBING RECORD

Conductor	18"	10"	8 1/4"	7"	6 1/2"	5 3/8"	4"	3"	
Used in Drig.									
Left in Well									

PACKER RECORD

Size	Depth Set	Type Packer	Date

SHOOTING RECORD

Type Explosive	Amount	DEPTH		Volume Before Cu. Ft.	Aft
		Top	Bottom		

VOLUME AND PRESSURE

Date	Reading In Inches	Liquid	Size Orifice	Volume	Sand	PRESSURE IN MIN.					24 Hr. R. P.	Max. R.	
						1	5	10	30	60			

TOTAL INITIAL OPEN FLOW

CUBIC FEET PER 24 HOURS

FORMATION	TOP	BOTTOM	THICKNESS	REMARKS
Conductor		16		
Red Rock	16	150	134	
Slate	150	270	120	
Lime	270	325	55	
Red Rock	325	405	80	
Lime	405	470	65	
Slate	472	572	100	
Lime	572	700	128	
Red Rock	700	810	110	
Lime	810	915	105	
Pgh Coal	915	922	7	
Slate	922	1038	116	
Red Rock	1038	1120	82	
Sand	1120	1170	50	
Slate	1170	1255	85	
Red Rock	1255	1350	95	
Sand	1355	1365	10	
Slate	1365	1435	70	
Sand	1435	1445	10	
Slate	1445	1600	155	
Slate	1415	1470	55	
Slate	1705	1800	95	
Slate	1845	1900	55	
Sand	"	1900	2065	165
Slate	"	2065	2070	5
Red Rock	2100	2186	86	
Lime	2136	2140	4	

Examined above information and measurements and found to be correct by _____

Examined and Approved by _____

Contractor _____

Field Superintendent _____

NOTE--The above blank must be filled out carefully by the contractor, with a complete and accurate record of the well, and accompany when presented for the bill for drilling. All formations and known sands must be given by their correct names.

The Manufacturers Light & Heat Company 017-2170

Division Sedalia DEJ, #6

Record of Well No. 1622 on J.J. Downs Farm 188 Acres
 Sedalia Field McClellan District Doddrige County W. Va. State
 Rig Commenced Oct. 17th. 1929, Completed Oct. 29th. 1929 192
 Drilling Commenced December 12th. 1929, Completed January 11th. 19230
 Cost per Foot \$1.75 Contractor Harry Moore Address Hundred, West. Va.
 Drillers' Names Cecil Gaines Irvin Bates.

BOILER			ENGINE			RIG			
H. P.	No.	Name of Maker	H. P.	No.	Name of Maker	New	Old	Height	Name of Builder
							Old	82	

CONDUCTOR AND CASING USED IN DRILLING										
Conductor	18 inch	10 inch	8 1/4 inch	6 1/2 inch	6 1/2 inch	5 1/2 inch	5 ft inch	5 inch	4 inch	
							243' 7"			

CONDUCTOR AND CASING LEFT IN WELL										
Conductor	18 inch	10 inch	8 1/4 inch	6 1/2 inch	6 1/2 inch	5 1/2 inch	5 ft inch	5 inch	4 inch	3 inch
							243' 7"			

OIL WELL						GAS WELL					
When Shot	Size of Torpedo	1st Day's Production	Tubing	Rods	Tanks	Size of Packer	Depth Set	Packed with	1st Minute Pressure	Rock Pressure	
FORMATION			Top	Bottom	Thickness	Disc. Wall	REMARKS				
			Drilling Deeper commenced at 2276' in Big Injun Sand								
			915	922	7						
			2220	2324	104		5/8 x 4	2161' 11"	4	8#	
			2324	2485	161					70#	
			2485	2570	85						
			2570	2715	145						
			2715	2733	18						
			2733	2780	47						
			2780	2825	45						
			2825	2933	108						
			2933	2956	23						
			2956	2998	42						
			2998	3002	4						
			3002	3013	11						
			3013	3033	20						
			3095								
			Gas at 3016 to 3021. Test. 44/10 Water in Hole reduced at 2935. 5 3/16. 12. Joints. of 5 3/16" Casing used for Line. Steel Shoe on top and Bottom. Test before drg Deeper. 9/10 water in 2" Total Test. 53/10 water inn 2"								
			<i>350000 cu ft</i>								
			Shut in test.								
						1M	2M	3M	4M	5M 24 Hrs	
						8	14	20	25	29 70#	

Examined and approved by _____ Superintendent of Co.
 The Manufacturers Light & Heat Co. Contractor
 NOTE: - The above blank must be filled out carefully by the contractor, with a complete and accurate record of the Well, and accompany, when presented for payment
 All formations and known sands must be given by their proper name, with steel line measurements, and under the head of "Remarks" must be recorded in what sand and at what depth Oil, Gas or Water was found, the quantity of same, the quality of the sand, and thickness of pay.
 Memoranda of boiler and engine work to be forwarded by contractor.