



west virginia department of environmental protection

Office of Oil and Gas
601 57th Street SE
Charleston, WV 25304
(304) 926-0450
(304) 926-0452 fax

Earl Ray Tomblin, Governor
Randy C. Huffman, Cabinet Secretary
www.dep.wv.gov

February 25, 2015

WELL WORK PLUGGING PERMIT

Plugging

This permit, API Well Number: 47-1702154, issued to EQT PRODUCTION COMPANY, is evidence of permission granted to perform the specified well work at the location described on the attached pages and located on the attached plat, subject to the provisions of Chapter 22 of the West Virginia Code of 1931, as amended, and all rules and regulations promulgated thereunder, and to all conditions and provisions outlined in the pages attached hereto. Notification shall be given by the operator to the Oil and Gas Inspector at least 24 hours prior to the construction of roads, locations, and/or pits for any permitted work. In addition, the well operator shall notify the same inspector 24 hours before any actual well work is commenced and prior to running and cementing casing. Spills or emergency discharges must be promptly reported by the operator to 1-800-642-3074 and to the Oil and Gas inspector.

Upon completion of the plugging well work, the above named operator will reclaim the site according to the provisions of WV Code 22-6-30. The above named operator will also file, as required in WV Code 22-6-23, an affidavit on form WR-38 by two experienced persons in the operator's employment and the Oil and Gas inspector that the work authorized under this permit was performed and a description given. Failure to abide by all statutory and regulatory provisions governing all duties and operations here under may result in suspensions or revocation of this permit and in addition may result in civil and/or criminal penalties being imposed upon the operator.

This permit will expire in two (2) years from date of issue. If there are any questions, please free to contact me at (304) 926-0499 ext. 1654.

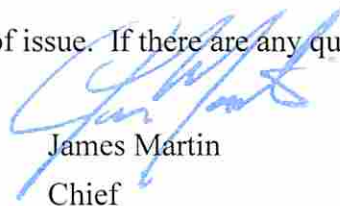

James Martin
Chief

Operator's Well No: D-3
Farm Name: MAXWELL, L.
API Well Number: 47-1702154
Permit Type: Plugging
Date Issued: 02/25/2015

Promoting a healthy environment.

02/27/2015

PERMIT CONDITIONS

COALBED METHANE WELLS

West Virginia Code §22-6-11 allows the Office of Oil and Gas to place specific conditions upon this permit. Permit conditions have the same effect as law. Failure to adhere to the specified permit conditions may result in enforcement action.

CONDITIONS

1. All pits must be lined with a minimum of 20 mil thickness synthetic liner.
2. In the event of an accident or explosion causing loss of life or serious personal injury in or about the well or while working on the well, the well operator or its contractor shall give notice, stating the particulars of the accident or explosion, to the oil and gas inspector and the Chief within twenty-four (24) hours.
3. Well work activities shall not constitute a hazard to the safety of persons.
4. If this well is associated with a coal operator mine through, then the plugging methodology (work order) must have MSHA Approval.

1702154P

Form WW-4 (B)
Permit Copy
(Rev 2/01)

Date: January 7, 2015
Operator's Well _____
Well No. 121521 (Maxwell D-3)
API Well No.: 47 017 - 02154

STATE OF WEST VIRGINIA
DIVISION OF ENVIRONMENTAL PROTECTION
OFFICE OF OIL AND GAS

CK 18875
\$ 600.00

APPLICATION FOR A PERMIT TO PLUG AND ABANDON

4) Well Type: Oil _____ Gas X Liquid Injection _____ Waste Disposal: _____
If Gas, Production _____ X Or Underground storage _____ Deep _____ Shallow X

5) Elevation: 1084 ft Watershed: Blue Stone Ck. Of Middle Island Ck. Of Ohio R.
Location: West Union County: Doddridge Quadrangle: West Union
District: _____

6) Well Operator EQT Production Company
120 Professional Place
Address: Bridgeport, WV 26330

7) Designated Agent: Rex C. Ray
Address: 120 Professional Place
Bridgeport, WV 26330

8) Oil & Gas Douglas Newlon
Name: 4060 Dutchman Road
Address: Macfarlan, WV 26148

9) Plugging Contractor:
Name: HydroCarbon Well Service
Address: PO BOX 995
Buckhannon, WV 26201

10) Work Order: The work order for the manner of plugging this well is as follows:
See Attachment for details and procedures.

Received
Office of Oil & Gas
JAN 12 2015

OFFICE USE ONLY

Notification must be given to the district oil and gas inspector 24 hours before permitted work can commence.

Work order approved by inspector _____ Date _____

02/27/2015

PLUGGING PROGNOSIS - Weston

Maxwell D #3 (121521)
 Doddridge Co., West Virginia
 API # 47-017-02154
 West Union Quad

BY: Craig Duckworth
 DATE: 10/15/14

CURRENT STATUS:

10" csg @ 350'
 8 1/4" csg @ 912'
 6 5/8" csg @ 1150'
 3" tbg @ ????'
 TD @ 1660'

Fresh Water @ None reported
 1" Salt Sand @ 1300'
 Gas Shows @ 1660' Big Injun
 Oil Shows @ None reported
 Stimulation: None reported
 Elevation: 1100'

Salt Water @ None reported
 Coal @ None reported

Verify Elevation 1084 or 1100'

1. Notify State Inspector, Douglas Newlon 304-932-8049, 24 hrs. Prior to commencing operations.
2. TIH w/ tbg @ 1660'; Set 200' C1A Cement Plug @ 1660' to 1460' (Gas Shows @ 1660' Big Injun)
3. TOOH w/ tbg @ 1460'; gel hole @ 1460' to 1300'
4. TOOH w/ tbg, Free Point 8 5/8", cut 6 5/8" @ free point, TOOH w/ 6 5/8" csg
5. TIH w/ tbg @ 1300'; Set 150' C1A Cement Plug @ 1300' to 1150' (6 5/8" casing cut & Salt Sand @ 1300')
6. Set a 100' C1A Cement Plug 50' In/Out of cut. Perf all FW, Coal, Oil and Gas shows below 6 5/8" cut.
Do not omit any plugs
7. TOOH w/ tbg @ 1150'; ~~gel hole~~ ^{Cement} @ 1150' to 962'.
8. TOOH w/ tbg, Free Point 8 1/4", cut 8 1/4" @ free point, TOOH w/ 8 1/4" csg
9. TIH w/ tbg @ 962'; Set 100' C1A Cement Plug @ 962' to 862' (8 1/4" csg 912')
10. Set a 100' C1A Cement Plug 50' In/Out of cut. Perf all FW, Coal, Oil and Gas shows below 8 1/4" cut.
Do not omit any plugs
11. TOOH w/ tbg @ 862'; gel hole @ 862' to 400'.
12. TOOH w/ tbg @ 400'; Set 100' C1A Cement Plug @ 400' to 300' (10" csg @ 350')
13. Set a 100' C1A Cement Plug 50' In/Out of cut. Perf all FW, Coal, Oil and Gas shows below 10" cut.
Do not omit any plugs
14. TOOH w/ tbg @ 300' gel hole @ 300' to 200'.
15. TOOH w/ tbg @ 200'; Set 200' C1A Cement Plug @ 200' to 0' (Surface)
16. Top off as needed
17. Set Monument to WV-DEP Specifications
18. Reclaim Location & Road to WV-DEP Specifications

*DCW
 1-27-2015*

STATE OF WEST VIRGINIA
DEPARTMENT OF MINES, OIL AND GAS DIVISION

Date 4-2-1980

FORM IV-35
(Obverse)

Operator's Well No. GW 36 (D-2)

(08-78)

WELL OPERATOR'S REPORT
OF
DRILLING, FRACTURING AND/OR STIMULATING, OR PHYSICAL CHANGE

API Well No. 47-017-21
State County Per

2154

WELL TYPE: Oil / Gas / Liquid Injection / Waste Disposal
(If "Gas", Production / Underground storage / Deep / Shallow)

LOCATION: Elevation: 1100.00' Watershed: LT. FORK OF ARNOLDS CK & BLUESTONE CK
District: WEST UNION County: DODDRIDGE Quadrangle: WEST UNION 7 1/2

WELL OPERATOR CITIES SERVICE CO. DESIGNATED AGENT MR SAM J MATTHEWS
Address Box 873 Address Box 873
CHARLESTON, W.V. 25323 CHARLESTON, W.V. 25323

PERMITTED WORK: Drill / Convert / Drill deeper / Re-drill / Fracture or stimulate
Plug off old formation / Perforate new formation /
Other physical change in well (specify) _____

F.E.R.C. FILING

PERMIT ISSUED ON UNKNOWN, 19____ OIL & GAS INSPECTOR FOR THIS WORK:

IF APPLICABLE: PLUGGING OF DRY HOLE OR CONTINUOUS PROGRESSION FROM DRILLING OR REWORKING. VERBAL PERMISSION OBTAINED Name: _____ Address: _____

GEOLOGICAL TARGET FORMATION: BIG INJUN Depth 1660 feet
Depth of completed well, _____ feet Rotary / Slick Tools _____
Water strata depth: Fresh, _____ feet; salt, _____ feet.
Coal seam depths: _____ Is coal being mined in the area?
Work was commenced _____, 19____, and completed JUN 10 1980, 19____

CASING AND TUBING PROGRAM

CASING OR TUBING TYPE	SPECIFICATIONS				FOOTAGE INTERVALS		CEMENT FILL-UP OR SACKS (Cubic feet)	PACKERS
	Size	Grade	Weight per ft	New	Used	For drilling		
Conductor								Kinds
Fresh water								
Coal	10"					350'		Sizes
Intermediate	8 1/4"					912'		
Production	6 5/8"						1150'	Center set
Tubing	3"					(NOT AVAILABLE)		
Liners								Perforations:
								Top Bottom

OPEN FLOW DATA

Producing formation N/A Pay zone depth _____ feet
Gas: Initial open flow, _____ Mcf/d Oil: Initial open flow, _____ bbl/d
Final open flow, _____ Mcf/d Final open flow, _____ bbl/d
Time of open flow between initial and final tests, _____ hours
Static rock pressure, _____ psig (surface measurement) after _____ hours shut in
(If applicable due to multiple completion--)

Second producing formation _____ Pay zone depth _____ feet
Gas: Initial open flow, _____ Mcf/d Oil: Initial open flow, _____ bbl/d
Final open flow, _____ Mcf/d Final open flow, _____ bbl/d
Time of open flow between initial and final tests, _____ hours
Static rock pressure, _____ psig (surface measurement) after _____ hours shut in

Received
Office of Oil & Gas
JAN 12 2015

0 1 2 3 LATITUDE 39 20 30

-1
-2
-3

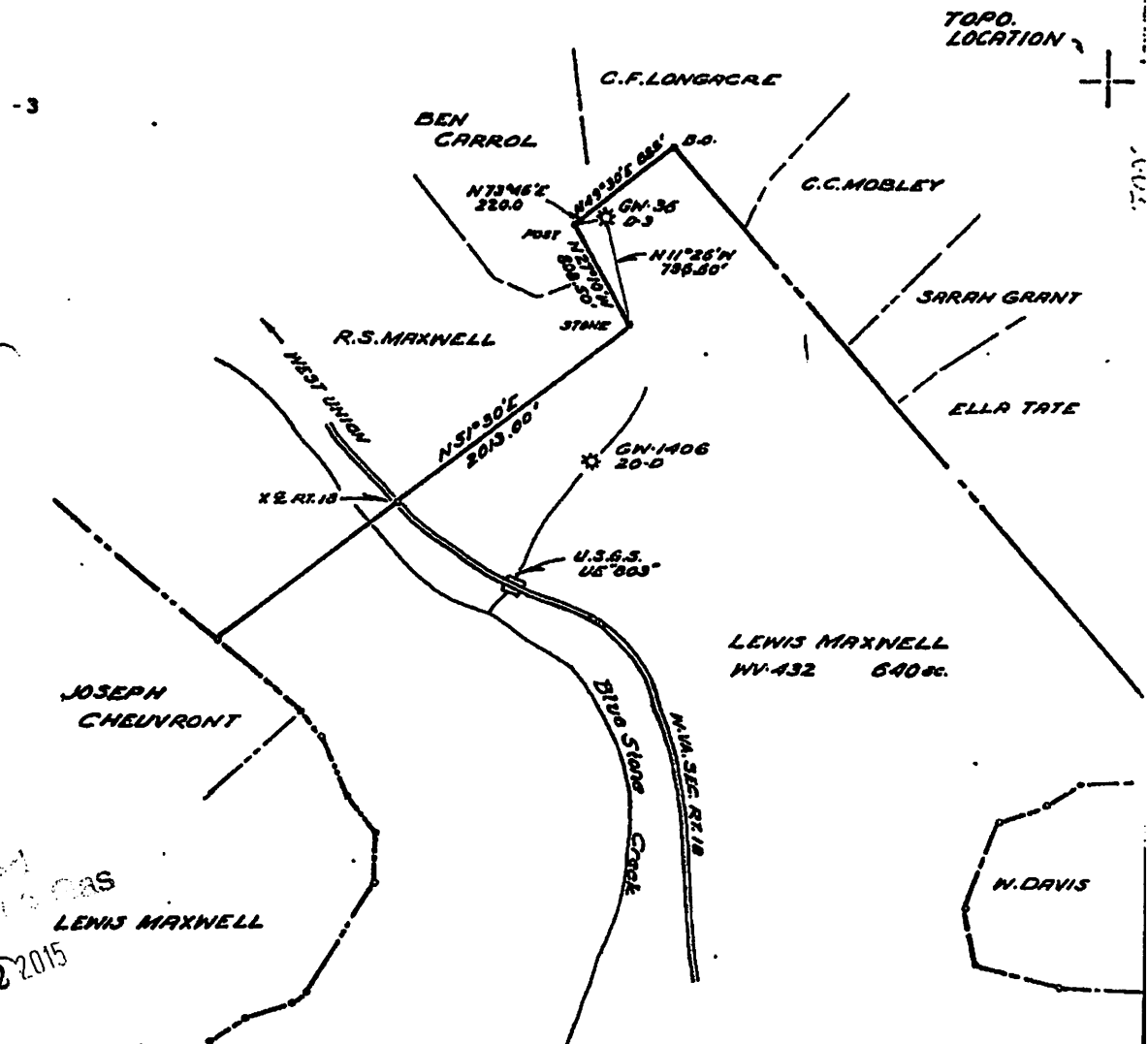

Received
Office of Oil & Gas
JAN 12 2015
LEWIS MAXWELL

CERTIFICATE

"I, the undersigned, hereby certify that this map is correct to the best of my knowledge and belief and shows all the information required by paragraph 6 of the rules and regulations of the oil and gas section of the mining laws of West Virginia."
Minimum degree of accuracy is one part in 200
Signed Arnold J. Day 1/15/73

- NEW LOCATION
- RECONDITION
- DRILL DEEPER
- ABANDONMENT

COMPANY	CITIES SERVICE OIL COMPANY		
ADDRESS	BOX 873 CHARLESTON, W.VA.		
BY	LEWIS MAXWELL		
MAP	ACRES	LEASE NO.	GN 36
WELL (FARE) NO.	D-3	SERIAL NO.	GN 36
ELEVATION (SPRINT LEVEL)	1085.00'		
QUADRANGLE	WEST UNION		
COUNTY	DOODRIDGE	DISTRICT	WEST UNION
POINT OF PROVEN ELEVATION	U.S.G.S. US 803		
FILE NO.	DRAWING NO.	N-2-73	
DATE	APRIL 3 1973	SCALE	1" = 1000'

STATE OF WEST VIRGINIA
DEPARTMENT OF MINES
OIL AND GAS DIVISION
CHARLESTON
WELL LOCATION MAP
File No. <u>2154</u>
<p>✦ DENOTES LOCATION OF WELL ON UNITED STATES TOPOGRAPHIC MAPS SCALE 1 TO 62 500. LATITUDE AND LONGITUDE LINES BEING REPRESENTED BY BORDER LINES AS SHOWN.</p> <p>— DENOTES ONE INCH SPACES ON BORDER LINE OF ORIGINAL TRACING</p>

DETAILS OF PERFORATED INTERVALS, FRACTURING OR STIMULATING, PHYSICAL CHANGE, ETC.

NO INFORMATION AVAILABLE

WELL LOG

FORMATION	Color	Hard or Soft	Top Feet	Bottom Feet	REMARKS Including indication of all fresh and salt water, coal, oil and gas
BIG LIME			1530	1598	
BIG INJUN			1598	1660	

(Attach separate sheets if complete as necessary)

CITIES SERVICE CO.
Well Operator

By [Signature]
Its Region Production Mgr

NOTE: Regulation 2.02(i) provides as follows:

"The term 'log' or 'well log' shall mean a systematic, detailed geological record of all formations, including coal, encountered in the drilling of a well."

Received
Office of Oil & Gas

JAN 12 2015

02/27/2015

WW-4-A
Revised 6/07

1) Date: January 7, 2015
2) Operator's Well Number
121521 (Maxwell D-3)
3) API Well No.: 47 017 - 02154
State County Permit

STATE OF WEST VIRGINIA - BUREAU OF ENVIRONMENT
DIVISION OF ENVIRONMENTAL PROTECTION, OFFICE OF OIL & GAS
NOTICE AND APPLICATION TO PLUG AND ABANDON WELL

4) Surface Owner(s) to be served:
(a) Name Frank Butler & Key Oil Co.
Address 22 Garton Plaza
Weston, WV 25456
(b) Name _____
Address _____
(c) Name _____
Address _____
6) Inspector Douglas Newton
Address 4060 Dutchman Road
Macfarlan, WV 26148
Telephone (304) 932-8049

5) (a) Coal Operator:
Name None
Address _____
(b) Coal Owner(s) with Declaration
Name Lewis Maxwell Oil & Gas
c/o Quinn Financial Mgmt.
Address P. O. Box 2253
Clarksburg, WV 26302-2253
Name Karen M. Henderson
Address 190 Sapphire Drive
Meadowbrook, WV 26404-6701
(c) Coal Lessee with Declaration
Name None
Address _____

TO THE PERSONS NAMED ABOVE:

You should have received this Form and the following documents:

- (1) The application to Plug and Abandon a Well on Form WW-4B, which sets out the parties involved in the work and describes the well its and the plugging work order; and
 - (2) The plat (surveyor's map) showing the well location on Form WW-6.
- The reason you received these documents is that you have rights regarding the application which are summarized in the instructions on the reverses side. However, you are not required to take any action at all.

Take notice that under Chapter 22-6 of the West Virginia Code, the undersigned well operator proposes to file or has filed this Notice and Application and accompanying documents for a permit to plug and abandon a well with the Chief of the Office of Oil and Gas, West Virginia Division of Environmental Protection, with respect to the well at the location described on the attached Application and depicted on the attached Form WW-6. Copies of this Notice, the Application, and the plat have been mailed by registered or certified mail or delivered by hand to the person(s) named above (or by publication in certain circumstances) on or before the day of mailing or delivery to the Chief.

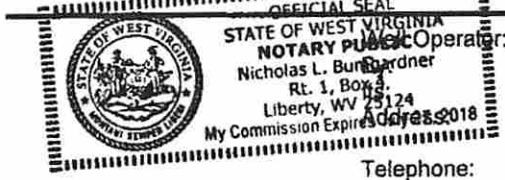

EQT Production Company
Victoria J. Roark
Permitting Supervisor
PO Box 280
Bridgeport, WV 26330
(304) 848-0076

Subscribed and sworn before me this 9 day of JANUARY, 2015
My Commission Expires: 7/27/2018
Notary Public

The Office of Oil & Gas processes your personal information, such as name, address and phone number, as part of our regulatory duties. Your personal information may be disclosed to other State agencies or third parties in the normal course of business or as needed to comply with statutory or regulatory requirements, including Freedom of Information Act requests. Our office will appropriately secure your personal information. If you have any questions about our use of your personal information, please contact DEP's Chief Privacy Officer at depprivacyofficer@wv.gov.

1702154P

neopost
01/09/2015
FIRST CLASS MAIL
US POSTAGE
\$09.75
ZIP 26330
041L10228892

erson
re Dr
ook WV 26404

7014 2120 0003 6735 0052
7014 2120 0003 6735 0052

U.S. Postal Service™
CERTIFIED MAIL® RECEIPT
 Domestic Mail Only

For delivery information, visit our website at www.usps.com®.

OFFICIAL USE

Postage	\$	Postmark Here
Certified Fee		
Return Receipt Fee (Endorsement Required)		
Restricted Delivery Fee (Endorsement Required)		

Total Post: Karen Henderson
 Sent To: 190 Sapphire Dr
 Meadowbrook WV 26404
 Street & Apt. / or PO Box No. 121521 Plugging
 City, State, Zip

PS Form 3800, July 2014 See Reverse for Instructions

C/O Vicki Roark
P.O. Box 280
Bridgeport, WV 26330

SENDER: COMPLETE THIS SECTION

- Complete items 1, 2, and 3. Also complete item 4 if Restricted Delivery is desired.
- Print your name and address on the reverse so that we can return the card to you.
- Attach this card to the back of the mailpiece, or on the front if space permits.

1. Article Addressed to:
 Karen Henderson
 190 Sapphire Dr
 Meadowbrook WV 26404
 121521 Plugging

Received
Office of Oil & Gas

COMPLETE THIS SECTION ON DELIVERY

A. Signature
 Agent
 Addressee

B. Received by (Printed Name) C. Date of Delivery

D. Is delivery address different from item 1? Yes
 If YES, enter delivery address below: No

3. Service Type
 Certified Mail® Priority Mail Express™
 Registered Return Receipt for Merchandise
 Insured Mail Collect on Delivery

4. Restricted Delivery? (Extra Fee) Yes

JAN 12 2015

02/27/2015

1702154P

01/09/2015
US POSTAGE
\$09.7
ZIP 2603
04111022E



7014 2120 0003 6735 0038
7014 2120 0003 6735 0038

**U.S. Postal Service™
CERTIFIED MAIL® RECEIPT**
Domestic Mail Only

For delivery information, visit our website at www.usps.com®.

OFFICIAL USE

Postage	\$
Certified Fee	
Return Receipt Fee (Endorsement Required)	
Restricted Delivery Fee (Endorsement Required)	

Postmark Here

To: Frank Butler & Key Oil Co
22 Garton Plaza
Weston, WV 25456

City: Weston, WV 25456

PS Form 3800, July 2014 See Reverse for Instructions



Vicki Roark
Box 280
Weston, WV 26330

Received
Office of Oil & Gas

JAN 12 2015

SENDER: COMPLETE THIS SECTION

- Complete items 1, 2, and 3. Also complete item 4 if Restricted Delivery is desired.
- Print your name and address on the reverse so that we can return the card to you.
- Attach this card to the back of the mailpiece, or on the front if space permits.

1. Article Addressed to:

Frank Butler & Key Oil Co
22 Garton Plaza
Weston, WV 25456

121521 Plugging

COMPLETE THIS SECTION ON DELIVERY

A. Signature Agent
X Addressee

B. Received by (Printed Name) C. Date of Delivery

D. Is delivery address different from item 1? Yes
If YES, enter delivery address below: No

i. Service Type

Certified Mail® Priority Mail Express™
 Registered Return Receipt for Merchandise
 Insured Mail Collect on Delivery

4. Restricted Delivery? (Extra Fee) Yes

02/27/2015

170 2154P

neopost®
01/09/2015
US POSTAGE
FIRST CLASS M
\$09.75
ZIP 26330
04111022681

Lewis Maxwell Oil & Gas
C/O Quinn Financial Mgmt
PO Box 2253
Clarksburg WV 26302

**U.S. Postal Service™
CERTIFIED MAIL® RECEIPT**
Domestic Mail Only

For delivery information, visit our website at www.usps.com®.

OFFICIAL USE

Postage	\$	Postmark Here
Certified Fee		
Return Receipt Fee (Endorsement Required)		
Restricted Delivery Fee (Endorsement Required)		
Total		

Sent To: Lewis Maxwell Oil & Gas
C/O Quinn Financial Mgmt
PO Box 2253
Clarksburg WV 26302

Street or PO: 121521 Plugging
City, St:

PS Form 3800, July 2014 See Reverse for Instructions



7014 2120 0003 6735 0045
7014 2120 0003 6735 0045



C/O Vicki Roark
P.O. Box 280
Bridgeport, WV 26330

Received
Office of Oil & Gas

JAN 12 2015

121521 Plugging

SENDER: COMPLETE THIS SECTION

- Complete items 1, 2, and 3. Also complete item 4 if Restricted Delivery is desired.
- Print your name and address on the reverse so that we can return the card to you.
- Attach this card to the back of the mailpiece, or on the front if space permits.

1. Article Addressed to:

Lewis Maxwell Oil & Gas
C/O Quinn Financial Mgmt
PO Box 2253
Clarksburg WV 26302

COMPLETE THIS SECTION ON DELIVERY

A. Signature Agent
 Addressee

B. Received by (Printed Name) C. Date of Delivery

D. Is delivery address different from item 1? Yes
If YES, enter delivery address below: No

3. Service Type
 Certified Mail® Priority Mail Express™
 Registered Return Receipt for Merchandise
 Insured Mail Collect on Delivery

4. Restricted Delivery? (Extra Fee) Yes

02/27/2015

1702154P

EQT
C/O Vicki Roark
P.O. Box 280
Bridgeport, WV 26330

Douglas Newlon
4060 Ditchman Road
Macfarlan, WV 26148

604949 (John Coulehan #4949)

650771 (Jones & Blair #305)

604953 (Fannie Harper #4953)

121561 Maxwell D-3

Received
Office of Oil & Gas
JAN 12 2015

neopost
01/09/2015
US POSTAGE

POSTCLASS MAIL
ZIP 26330
041110226892

\$03.29

02/27/2015

STATE OF WEST VIRGINIA
DEPARTMENT OF ENVIRONMENTAL PROTECTION, OFFICE OF OIL & GAS
CONSTRUCTION AND RECLAMATION PLAN AND SITE REGISTRATION APPLICATION FORM
GENERAL PERMIT FOR OIL AND GAS PIT WASTE DISCHARGE

Operator Name: EQT PRODUCTION COMPANY OP ID: _____
Watershed: Blue Stone Ck. Of Middle Island Ck. Of Ohio R. Quadrangle: West Union
Elevation: 1084 ft County: Doddridge District: West Union

Description of anticipated Pit Waste: Formation Fluids

Do you anticipate using more than 5,000 bbls of water to complete the proposed well work? Yes ___ No X
Will synthetic liner be used in the pit? Yes Is so, what ml.? 10 ml

Proposed Disposal Method for Treated Pit Wastes:

- Land Application
- Underground Injection - UIC Permit Number _____
- Reuse (at API Number) _____
- Offsite Disposal Permit #. _____
- Other: Explain _____

DCW
1-22-2015

Drilling medium anticipated for this well? Air, freshwater, oil based, etc.
If oil based, what type? Synthetic, petroleum, etc.

Additives to be used? _____

Will closed loop system be used? _____

Drill Cuttings disposal method? Leave in pit, landfill, remove offsite, etc.

If left in pit and plan to solidify what medium will be used? Cement, Lime, sawdust

Landfill or offsite name/permit number? _____

I certify that I understand and agree to the terms and conditions of the GENERAL WATER POLLUTION PERMIT issued on August 1, 2005, by the Office of Oil and Gas of the West Virginia Division of Environmental Protection. I understand that the provisions of the permit are enforceable by law. Violations of any terms or condition of the general permit and/or other applicable law or regulation can lead to enforcement action.

I certify under penalty of law that I have personally examined and am familiar with the information submitted on this application form and all attachments thereto and that, based on my inquiry of those individuals immediately responsible for obtaining the information, I believe that the information is true, accurate and complete. I am aware that there are significant penalties for submitting false information, including the possibility of fine or imprisonment.

Company Official Signature _____ *Victoria Roark*

Company Official (Typed or Printed) Victoria Roark

Company Official Title Permitting Supervisor-WV

Subscribed and sworn before me this 9 day of JANUARY, 2015

My Commission Expires 7/27/2018 Notary Public

Office of Oil and Gas

FEB 13 2015

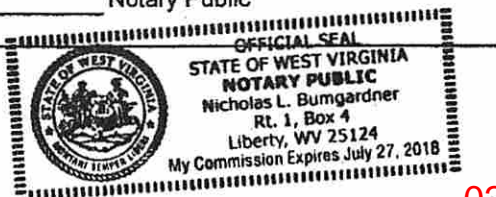

OPERATOR'S WELL NO.:
121521 (Maxwell D-3)

LEGEND

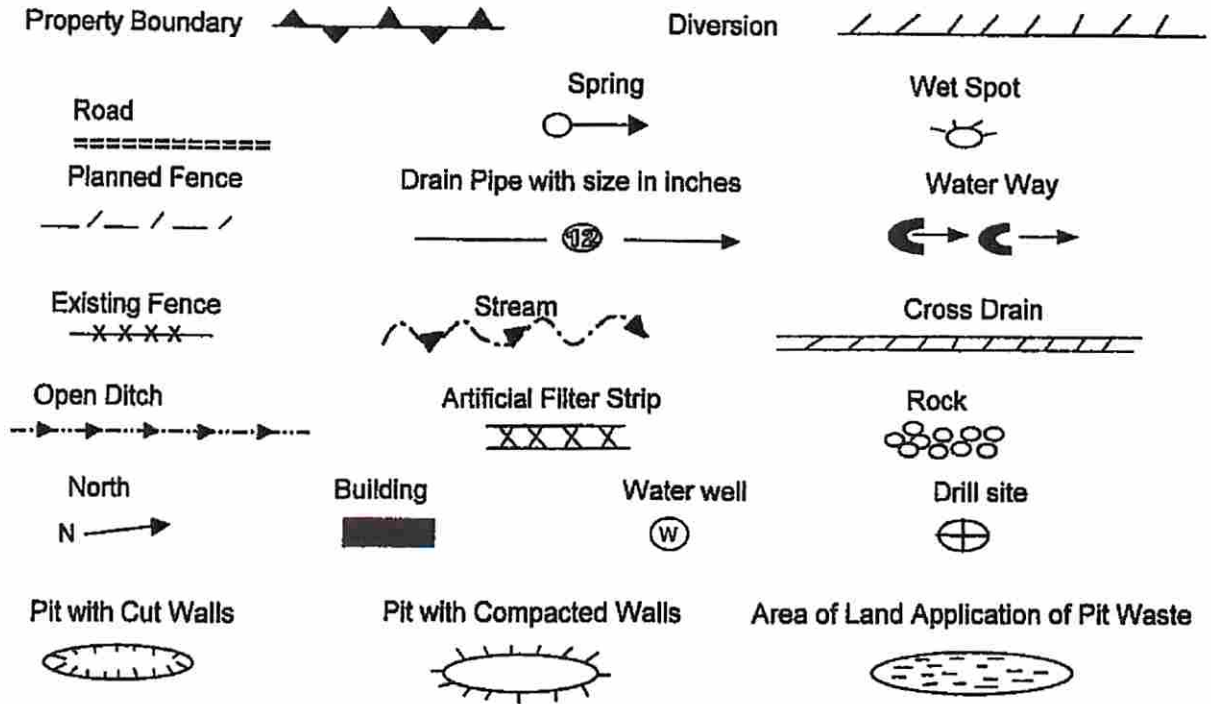

Proposed Revegetation Treatment: Acres Disturbed: 1± Prevegetation pH _____

Lime 3 Tons/acre or to correct to pH 6.5

Fertilizer (10-20-20) or equivalent 1/3 ton lbs/acre (500 lbs minimum)

Mulch 2 Tons/acre or hydroseed.

SEED MIXTURES

Area I		Area II	
Seed Type	lbs/acre	Seed Type	lbs/acre
Red Fescue	40	Red Fescue	15
Alsike Clover	5	Alsike Clover	5
Annual Rye	15		

ATTACH:

Drawing(s) of road, location, pit and proposed area for land application.

Photocopies section of involved 7.5' topographic sheet.

Plan approved by: Douglas Newb

Comments: install ETS as required

Title: Oil & Gas Inspector Date: 1-27-2015

Field Reviewed? Yes No

WW-7
8-30-06



West Virginia Department of Environmental Protection
Office of Oil and Gas
WELL LOCATION FORM: GPS

API: 47-017-02154 WELL NO.: WV 121521 (Maxwell D-3)

FARM NAME: L. Maxwell

RESPONSIBLE PARTY NAME: EQT Production Company

COUNTY: Doddridge DISTRICT: West Union 8

QUADRANGLE: West Union 7.5' 671

SURFACE OWNER: Chad W. Johnson

ROYALTY OWNER: Phyllis J. Davis, et al.

UTM GPS NORTHING: 4349089

UTM GPS EASTING: 521052 GPS ELEVATION: 330 m (1084 ft)

The Responsible Party named above has chosen to submit GPS coordinates in lieu of preparing a new well location plat for a plugging permit or assigned API number on the above well. The Office of Oil and Gas will not accept GPS coordinates that do not meet the following requirements:

- Datum: NAD 1983, Zone: 17 North, Coordinate Units: meters, Altitude: height above mean sea level (MSL) – meters.
- Accuracy to Datum – 3.05 meters
- Data Collection Method:
Survey grade GPS : Post Processed Differential
Real-Time Differential
Mapping Grade GPS : Post Processed Differential
Real-Time Differential

Received
Office of Oil & Gas

JAN 15

4. Letter size copy of the topography map showing the well location.

I the undersigned, hereby certify this data is correct to the best of my knowledge and belief and shows all the information required by law and the regulations issued and prescribed by the Office of Oil and Gas.

Steph Oborn
Signature

DS # 2180
Title

12/11/14
Date



POTENTIAL WATER SAMPLE DATA SHEET

CLIENT: EQT PRODUCTION COMPANY
LEASE NAME AND WELL No. Maxwell D-3 - WV 121521 - API No. 47-017-02154

POTENTIAL SAMPLE LOCATIONS

There appears to be no known water samples within the required 1000' of the existing well WV 121521.

Received
Office of Oil & Gas
JAN 12 2015

BIRCH RIVER OFFICE
237 Birch River Road
Birch River, WV 26610
phone: 304-649-8606
fax: 304-649-8608

BRIDGEPORT OFFICE
172 Thompson Drive
Bridgeport, WV 26330
phone: 304-848-5035
fax: 304-848-5037

CALDWELL OFFICE
212 Cumberland Street
Caldwell, OH 43724
phone: 740-305-5007
fax: 740-305-5126

ALUM CREEK OFFICE
P.O. Box 108 • 1413 Childress Rd
Alum Creek, WV 25003
phone: 304-756-2949
fax: 304-756-2948

RANSON OFFICE
401 South Fairfax Blvd, Suite 3
Ranson, WV 25438
phone: 304-724-5008
fax: 304-724-5010

1702154A

Topo Quad: West Union 7.5'

Scale: 1" = 2000'

County: Doddridge

Date: October 31, 2014

District: West Union

Project No: 67-30-00-08

Water

47-017-02154 WV 121521 (Maxwell D-3)

No potential water wells within 1000'

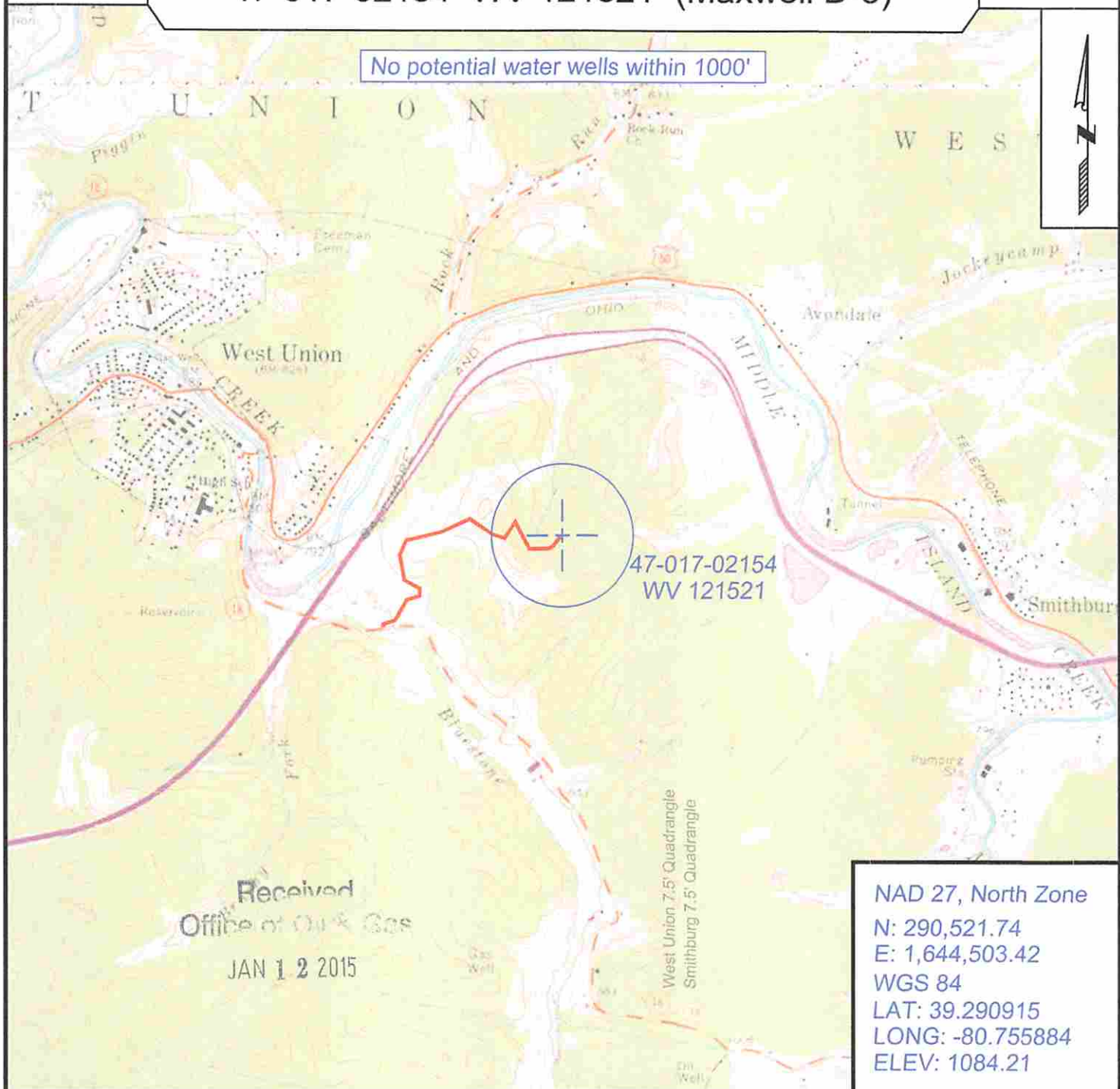

Received
Office of Oil & Gas
JAN 12 2015

NAD 27, North Zone
 N: 290,521.74
 E: 1,644,503.42
 WGS 84
 LAT: 39.290915
 LONG: -80.755884
 ELEV: 1084.21



SURVEYING AND MAPPING SERVICES PERFORMED BY:
ALLEGHENY SURVEYS, INC.
 1-800-482-8606
 237 Birch River Road
 Birch River, WV 26610
 PH: (304) 649-8606
 FAX: (304) 649-8608

PREPARED FOR:
EQT Production Company
 P.O. Box 280
 Bridgeport, WV 26330

02/27/2015