

OGIS
7.5' loc

2015
0.79W

7.5 OGIS topo location

7.5' loc	_____	15' loc	<u>4.89S</u>
	_____	(calc.)	<u>0.79W</u>

Company _____

Farm Lewis Maxwell B-14
GW-244

Quad West Union + 15' SE

County _____

District West Union

WELL LOCATION MAP

File No. Dodd 2147

(OGIS 2396

54 Frac)

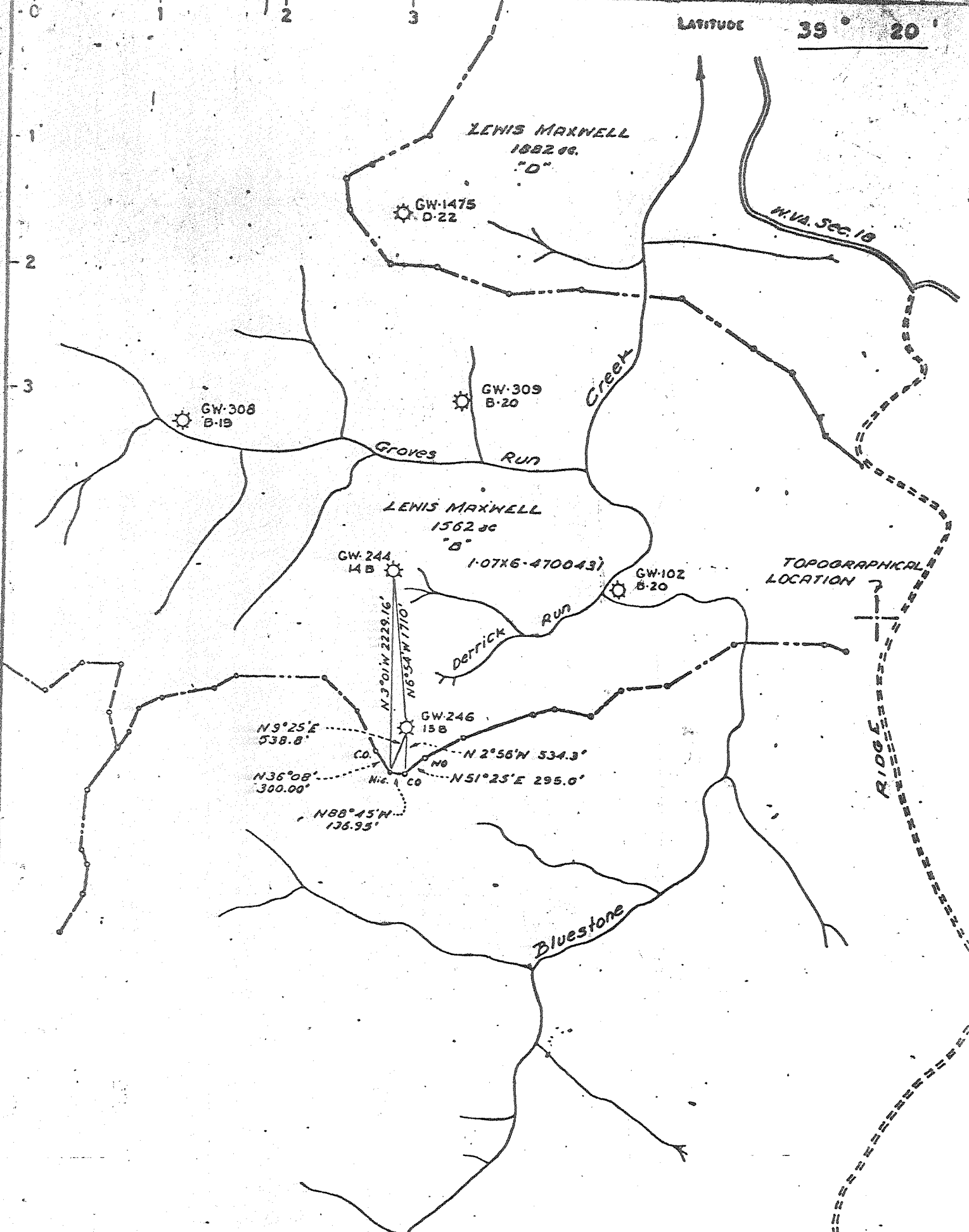

- NEW LOCATION
- RECONDITION
- DRILL DEEPER
- ABANDONMENT

CERTIFICATE

"I, the undersigned, hereby certify that this map is correct to the best of my knowledge and belief and shows all the information required by paragraph 6 of the rules and regulations of the oil and gas section of the mining laws of West Virginia."

Minimum degree of accuracy is one part in 200

Signed *Michael P. ...* 1.15.77

COMPANY	CITIES SERVICE OIL COMPANY		
ADDRESS	BOX 873, CHARLESTON, W. VA.		
FARM	LEWIS MAXWELL		
MAP	ACRES	1562	LEASE NO. 1-07XG-4700431
WELL (FARM) NO.	B-14	SERIAL NO.	GW-244
ELEVATION (SPIRIT LEVEL)	1063.00		
QUADRANGLE	WEST UNION		
COUNTY	DODDRIDGE	DISTRICT	WEST UNION
POINT OF PROVEN ELEVATION	CITIES SERVICE GW-102		
FILE NO.	DRAWING NO.	W-1-73	
DATE	MARCH 30, 1973		
	SCALE	1"=1320'	

STATE OF WEST VIRGINIA
DEPARTMENT OF MINES
OIL AND GAS DIVISION
CHARLESTON

WELL LOCATION MAP

017-2147 (54 FRAC)
FILE NO. 017-2147

See also 2396

↑ DENOTES LOCATION OF WELL ON UNITED STATES TOPOGRAPHIC MAPS SCALE 1 TO 62,500. LATITUDE AND LONGITUDE LINES BEING REPRESENTED BY BORDER LINES AS SHOWN.

↓ DENOTES ONE INCH SPACES ON BORDER LINE OF ORIGINAL TRACING

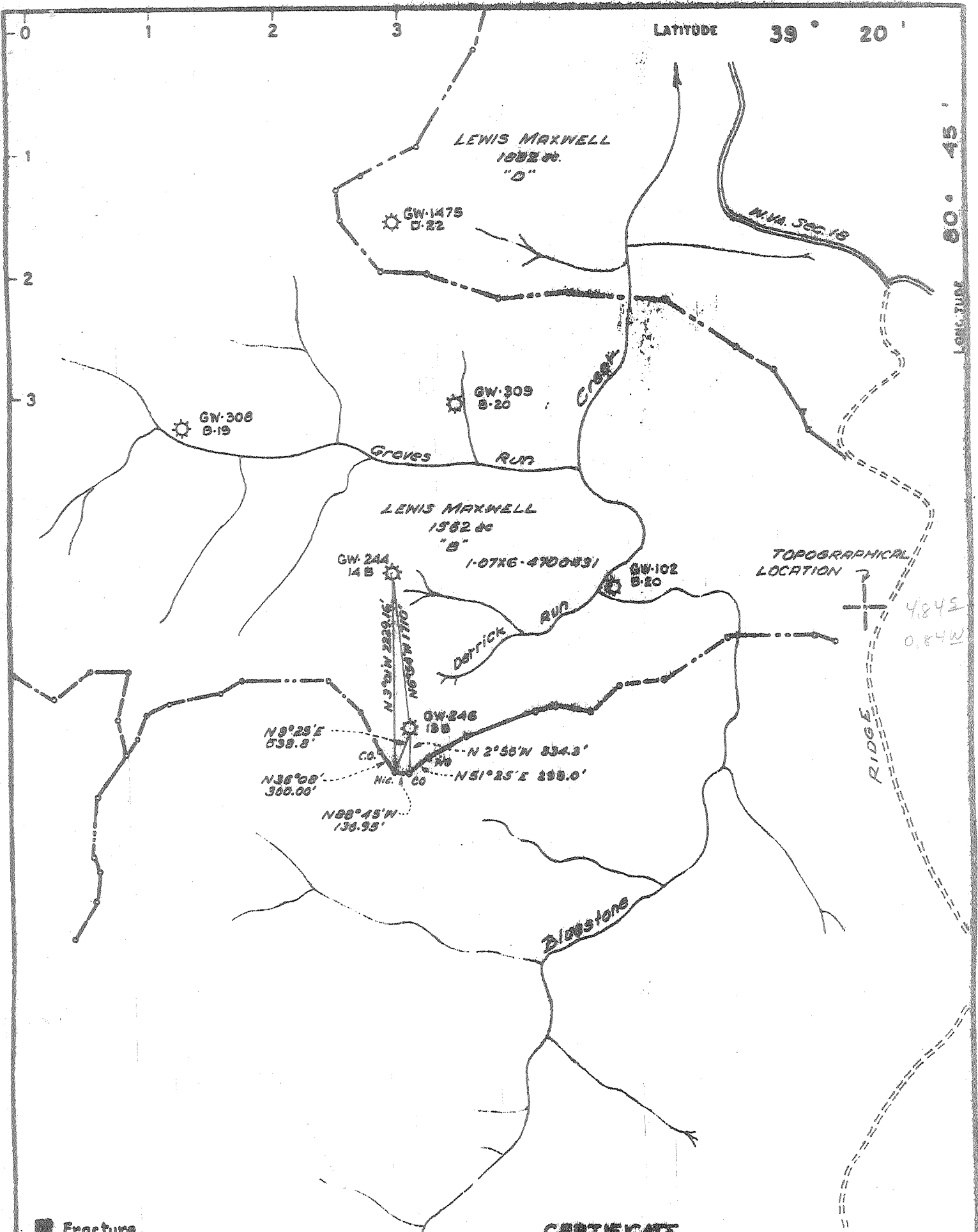

- Fracture
- NEW LOCATION
- RECONDITION
- DRILL DEEPER
- ABANDONMENT

CERTIFICATE

"I, the undersigned, hereby certify that this map is correct to the best of my knowledge and belief and shows all the information required by paragraph 6 of the rules and regulations of the oil and gas portion of the mining laws of West Virginia."
 Minimum degree of accuracy is one part in 200
 State: West Virginia

COMPANY CITIES SERVICE OIL COMPANY
 ADDRESS BOX 873, CHARLESTON, W. VA.
 FARM LEWIS MAXWELL
 MAP _____ ACRES 1562 LEASE NO. 1-0716-4700831
 WELL (FARM) NO. B-14 SERIAL NO. GW-244
 ELEVATION (SPIRIT LEVEL) 1063.00
 QUADRANGLE WEST UNION SE
 COUNTY ODDORIDGE DISTRICT WEST UNION
 POINT OF PROVEN ELEVATION CITIES SERVICE GW-102
 FILE NO. _____ DRAWING NO. W-1-73
 DATE MARCH 30, 1973 SCALE 1"=1320'

STATE OF WEST VIRGINIA
 DEPARTMENT OF MINES
 OIL AND GAS DIVISION
 CHARLESTON
WELL LOCATION MAP
 FILE NO. Dodd-54-ERAC
2396-1602147
 + DENOTES LOCATION OF WELL ON UNITED STATES TOPOGRAPHIC MAPS SCALE 1 TO 62 500. LATITUDE AND LONGITUDE LINES BEING REPRESENTED BY BORDER LINES AS SHOWN
 - DENOTES ONE INCH SPACES ON BORDER LINE OF ORIGINAL TRACING

RECORD OF LEWIS MAXWELL #14 *ls. W. #244*

On waters of Blue Stone, Doddridge County, W. Va.
 Well was drilled by Columbian Carbon Co. of Williamsport, Pa.
 Contractor, F. S. Greathouse, of Weston, W. Va.
 Record kept of all formations.

	TOP	BOTTOM	THICKNESS
Conductor Box	0	12	12 Feet
Soil & Red Rock	0	12	12
Lime Rock	12	16	4
Red Rock	16	50	34
Lime Rock Hard	50	110	60
Coal Black & Soft	110	115	5
Slate Black & Soft	115	165	50
Lime Rock Hard	165	205	40
Red Rock	205	225	20
Sand Hard	225	310	85
Slate Soft	310	350	40
Red Rock	350	365	15
Slate Soft	365	510	145
Red Rock	510	525	15
Lime Hard	525	655	130
Red Rock	655	665	10
Lime Rock	665	745	80
Red Rock	745	780	35
Lime Rock	780	880	100
Little Dunkard Sand	880	900	20
Slate Soft	900	920	20
Lime Rock	920	935	15
Big Dunkard Sand	935	955	20
Lime Rock	955	1090	130
Gas Sand	1090	1196	106
Black Slate	1196	1208	12
Lime Rock Hard	1208	1250	42
Slate Black	1250	1350	100
1st Salt Sand	1350	1385	35
Slate Lime & Shells	1385	1460	75
2nd Salt Sand	1460	1520	60
Slate Dark	1520	1580	60
3rd Salt Sand	1580	1600	20
LITTLE GAS -	1590	XXXXXXXXXXXXXXXXXXXX	
Slate Black	1600	1635	35
Maxon Sand	1635	1653	18
Slate Soft	1653	1658	5
Lime Rock	1658	1690	32
Blue Monday Sand	1690	1710	20
Pencil Cave	1710	1726	16
Big Lime	1726	1791	65
Big Injun Sand	1791	1865	74
Gas -	1798	1815	17
Gas -	1883	XXXXXXXXXXXXXXXXXXXX	Ray Sand
Slate Soft	1865	1891	6
TOTAL DEPTH	1891		

Drilling Commenced April 22, 1924 Completed May 21, 1924

Casing put in well 10" 372-6" 8 1/2 - 984 - 5" 6-5/8 - 1761 feet

Casing Pulled Out 10" 372-6"

Casing left in 6-5/8 - 1761 feet 8 1/2 - 984-5"

Well was tubed with 2" tubing on May 22, 1924

Packer set at 123 feet from bottom of hole perforation joint on bottom

Drillers on well W. E. Flannigan & O. L. Pratt of Weston, W. Va.

Tooldressers - D. R. Beachler and Henry Flesher " " "

Record copied from original well record by F. S. Greathouse

017-2147

017-2147

Sheet No.

Drilled Deeper

District West Union

Columbia Carbon Co. Lewis Maxwell

Well No. 14

FORMATION	COLOR	HARD OR SOFT	No. ON SAMPLE BOTTLE	TOP	BOTTOM	AMOUNT
Lewis Maxwell Well No. 14 Drilled Down from 1891 to 2495						
Started Rigging Up June 1, 1931- Finished Drilling June 21, 1931.						
Lime	Blue			1891	2030	139
Gantz Sand				2030	2200	170
Slate & Shells				2200	2280	80
Lime				2280	2330	50
Slate & Shells				2330	2430	100
Gordon Stray				2430	2440	10
Slate				2440	2456	16
Gordon Sand				2456	2464	8
Break Slate				2464	2469	5
Sand				2469	2475	6
Slate				2475	2495	20
Little Gas From 2458 to 2463						
Little Gas and Show of Oil from 2469 to 2475						
Gas in All 6/10 Water through 2" pipe. = 103 MCF						
Steel Line				2495		
Well Was shut in in 6 1/4 casing June 21, 1931.						
Drillers on well O. L. Pratt of Weston, W. Va.						
Algie McKinney of West Union, W. Va.						
Tooldressers on well Gainer Pratt of Weston, W. Va.						
French Pratt of Weston, W. Va.						
Record copied from original well record by F. S. Greathouse of Weston, W. Va.						
				00 Ftg	2495 1891	
					604 ft.	



STATE OF WEST VIRGINIA
DEPARTMENT OF MINES

RECEIVED

MAR 30 1973

OIL & GAS DIVISION
DEPT. OF MINES

Oil and Gas Division

OIL AND GAS WELL PERMIT APPLICATION

TO THE DEPARTMENT OF MINES,
Charleston, W. Va.

Surface Owner Lewis Maxwell
Address West Union, West Virginia
Mineral Owner _____
Address _____
Coal Owner _____
Address _____
Coal Operator _____
Address _____

DATE March 30, 1973
Company Cities Service Oil Company
Address Box 873, Charleston, W. Va. 25323
Farm Lewis Maxwell Acres 1562
Location (waters) Blue Stone Run
Well No. "B" #14, G-244 Elevation 1063
District West Union County Doddridge
Quadrangle West Union

THIS PERMIT MUST BE POSTED AT THE WELL SITE
All provisions being in accordance with Chapter 22,
of the W. Va. Code, the location is hereby approved
for fracturing. This permit shall expire if
operations have not commenced by 5/2/73.

Robert T. Ford
Deputy Director - Oil & Gas Division

INSPECTOR TO BE NOTIFIED Mr. Wm. Blosser
Box 1857 PH: Fairmont
Calfax 363-9105
W.V. 24566

GENTLEMEN:

The undersigned well operator is entitled to drill upon the above named farm or tract of land for oil and gas, having fee title thereto, (or as the case may be) under grant or lease dated December 20, 1968 by Lewis & Sarah E. Maxwell made to Cities Service Oil Co. (formerly Col. Carbon Co.) and recorded on the 19 day of March 1969, in Doddridge County, Book 11 Page 479

_____ NEW WELL _____ DRILL DEEPER _____ REDRILL FRACTURE OR STIMULATE
_____ OIL AND GAS WELL ORIGINALLY DRILLED BEFORE JUNE 5, 1969.

The enclosed plat was prepared by a registered engineer or licensed land surveyor and all coal owners and/or operators have been notified as of the above date.

The above named coal owners and/or operator are hereby notified that any objection they wish to make, or are required to make by Section 3 of the Code, must be received by, or filed with the Department of Mines within ten (10) days. *

Copies of this notice and the enclosed plat were mailed by registered mail, or delivered to the above named coal operators or coal owners at their above shown respective address _____ day _____ before, or on the same day with the mailing or delivery of this copy to the Department of Mines at Charleston, West Virginia.

Very truly yours,
(Sign Name) Sam J. Matthews
Sam J. Matthews Well Operator
Region Prod. Manager
Address _____ Street Box 873
of _____
Well Operator _____ City or Town Charleston
_____ State West Virginia 25323

*SECTION 3 If no objections are filed or found by the Department of mines, within said period of ten days from the receipt of notice and plat by the department of mines, to said proposed location, the department shall forthwith issue to the well operator a permit reciting the filing of such plat, that no objections have been made by the coal operators or found thereto by the department and that the same is approved and the well operator authorized to proceed.

BLANKET BOND

Rodd-54-Gran PERMIT NUMBER
2396
2147

THIS IS AN ESTIMATE ONLY
ACTUAL INFORMATION WILL BE SUBMITTED ON OG-10 UPON COMPLETION

PROPOSED WORK ORDER TO _____ DRILL _____ DEEPEN FRACTURE-STIMULATE
 DRILLING CONTRACTOR: (If Known) RESPONSIBLE AGENT:
 NAME Bud Spencer NAME Sam J. Matthews
 ADDRESS West Union, West Virginia ADDRESS Box 873, Charleston, W. Va. 25323
 TELEPHONE _____ TELEPHONE 344-8383
 ESTIMATED DEPTH OF COMPLETED WELL: 2000' ROTARY _____ CABLE TOOLS
 PROPOSED GEOLOGICAL FORMATION: Big Injun
 TYPE OF WELL: OIL _____ GAS COMB. _____ STORAGE _____ DISPOSAL _____
 RECYCLING _____ WATER FLOOD _____ OTHER _____

TENTATIVE CASING PROGRAM:

CASING AND TUBING SIZE	USED FOR DRILLING	LEFT IN WELL	CEMENT FILL UP OR SACKS - CUBIC FT.
20 - 16			
13 - 10			
9 - 5/8			
8 - 5/8	984'		Not cemented
7 6-5/8"	1761'		Not cemented
5 1/2			
4 1/2			
3			Perf. Top
2			Perf. Bottom
Liners			Perf. Top
			Perf. Bottom

APPROXIMATE FRESH WATER DEPTHS NA FEET SALT WATER _____ FEET
 APPROXIMATE COAL DEPTHS 110-115
 IS COAL BEING MINED IN THE AREA? No BY WHOM? _____

TO DRILL:

SUBMIT FIVE (5) COPIES OF OG - 1, \$100.00 PERMIT FEE, PERFORMANCE BOND AND PERMANENT COPY OF PLAT.

TO DRILL DEEPER OR REDRILL:

SUBMIT FIVE (5) COPIES OF OG - 1, SHOWING ORIGINAL PERMIT NUMBER AND PERFORMANCE BOND. ON WELLS DRILLED PRIOR TO 1929, A PERMANENT COPY OF THE PLAT AND THE ORIGINAL WELL RECORD MUST ALSO BE SUBMITTED.

TO FRACTURE - STIMULATE:

OIL AND/OR GAS WELL ORIGINALLY DRILLED BEFORE JUNE 5, 1929, FIVE (5) COPIES OG - 1, PERFORMANCE BOND, PERMANENT PLAT AND ORIGINAL WELL RECORD.

OIL AND/OR GAS WELL ORIGINALLY DRILLED ON AND/OR AFTER JUNE 5, 1929, FIVE COPIES OG - 1, SHOWING ORIGINAL PERMIT NUMBER, AND PERFORMANCE BOND.

Required forms must be filed within ninety (90) days of completion for bond release. Inspector to be notified twenty-four (24) hours in advance.

The following waiver must be completed by the coal operator if the permit is to be issued within ten days of receipt thereof.

WAIVER: I the undersigned, Agent for _____ Coal Company, Owner or Operator of the coal under this lease have examined and place on our mine maps this proposed well location.

We the _____ Coal Company have no objections to said well being drilled at this location, providing operator has complied with all rules and regulations in Articles 4, 5, and 7, Chapter 22 of the West Virginia Code.

For Coal Company

Official Title