

FILE NO. \_\_\_\_\_  
 DRAWING NO. \_\_\_\_\_  
 SCALE As Shown  
 MINIMUM DEGREE OF ACCURACY 1 in 200  
 PROVEN SOURCE OF ELEVATION C.S.O. & G. Well A-65  
Elev. 927.14'

I THE UNDERSIGNED, HEREBY CERTIFY THAT THIS PLAT IS CORRECT TO THE BEST OF MY KNOWLEDGE AND BELIEF AND SHOWS ALL THE INFORMATION REQUIRED BY LAW AND THE REGULATIONS ISSUED AND PRESCRIBED BY THE DEPARTMENT OF MINES.  
 (SIGNED) Donald J. Bay  
 R. P. E. \_\_\_\_\_ L. L. S. 247

PLACE SEAL HERE

(+) DENOTES LOCATION OF WELL ON UNITED STATES TOPOGRAPHIC MAPS  
 FORM IV-6  
 (8-78)



Department of Mines  
 Oil & Gas Division

DATE May 21, 19 86  
 OPERATOR'S WELL NO. A-59, GW-298  
 API WELL NO.

47 - 017 - 2143 - P  
 STATE COUNTY PERMIT

Oil & Gas An Rept. was Dadd 30  
Talres - Dadd 30 -  
Maxwell (GW-298)

WELL TYPE: OIL \_\_\_\_\_ GAS X LIQUID INJECTION \_\_\_\_\_ WASTE DISPOSAL \_\_\_\_\_  
 (IF "GAS", PRODUCTION X STORAGE \_\_\_\_\_ DEEP \_\_\_\_\_ SHALLOW \_\_\_\_\_)  
 LOCATION: ELEVATION 1160.00 WATER SHED LEFT FK. OF ARNOLDS CREEK  
 DISTRICT WEST UNION COUNTY DODDRIDGE  
 QUADRANGLE OXFORD 7 1/2'  
 SURFACE OWNER R. S. MAXWELL & LERENZY ROY ACREAGE \_\_\_\_\_  
 OIL & GAS ROYALTY OWNER LEWIS MAXWELL HRS. LEASE ACREAGE 2654.88  
 LEASE NO. WV-427

PROPOSED WORK: DRILL \_\_\_\_\_ CONVERT \_\_\_\_\_ DRILL DEEPER \_\_\_\_\_ REDRILL \_\_\_\_\_ FRACTURE OR STIMULATE \_\_\_\_\_ PLUG OFF OLD FORMATION \_\_\_\_\_ PERFORATE NEW FORMATION \_\_\_\_\_ OTHER PHYSICAL CHANGE IN WELL (SPECIFY) \_\_\_\_\_  
PLUG & ABANDON

PLUG AND ABANDON X CLEAN OUT AND REPLUG \_\_\_\_\_  
 TARGET FORMATION BIG INJUN ESTIMATED DEPTH 2013 T.D.  
 WELL OPERATOR CITIES SERVICE DESIGNATED AGENT PAUL D. PHILLIPS  
 ADDRESS OIL AND GAS CORP. ADDRESS P.O. Box 873  
P.O. Box 873, CHARLESTON WV. 25323 CHARLESTON WV 25323

LATITUDE 35° 15' 00"

LONGITUDE 80° 45' 15"

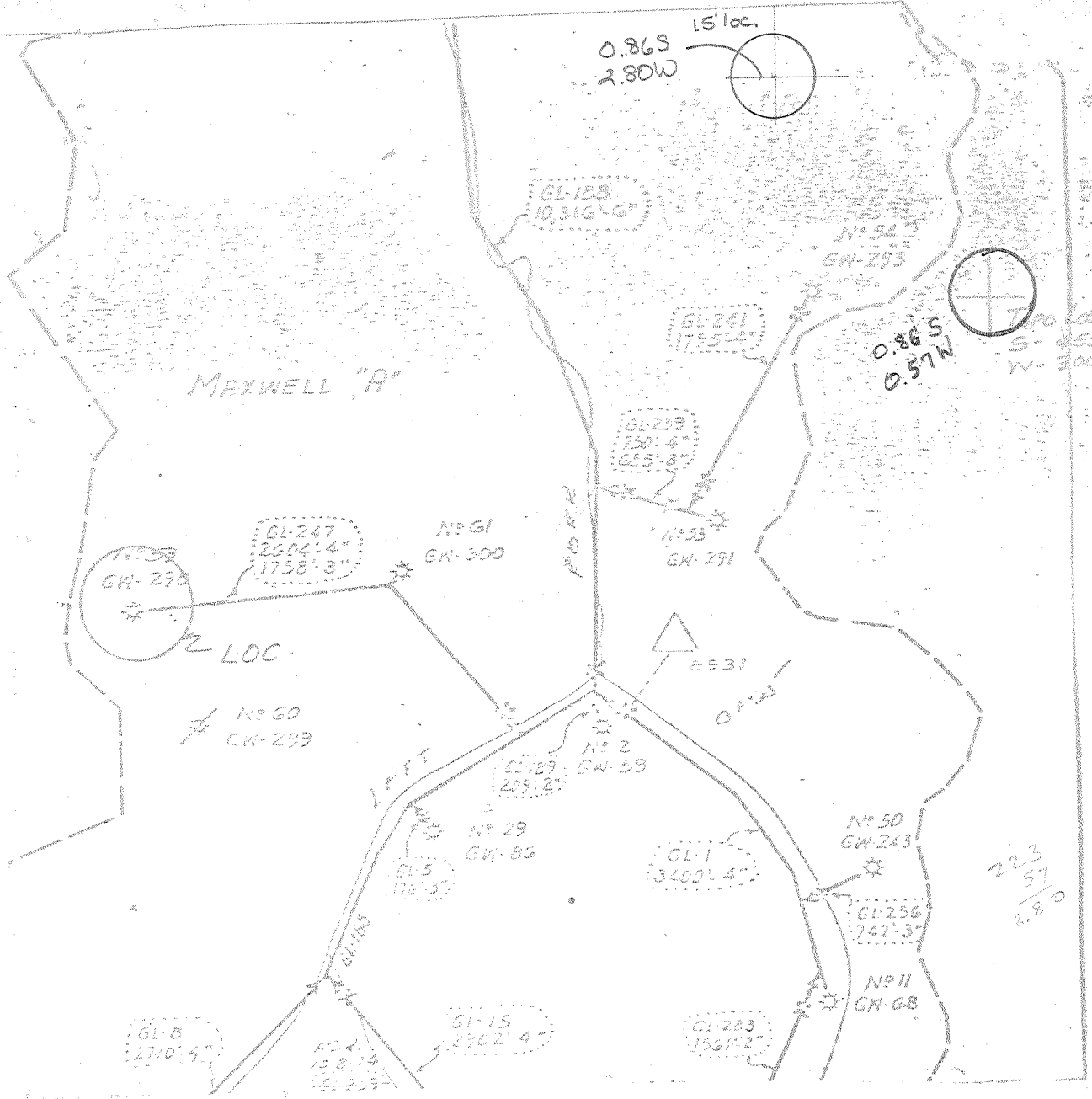

FILE NO. \_\_\_\_\_  
 DRAWING NO. \_\_\_\_\_  
 SCALE 1"=1320'  
 MINIMUM DEGREE OF ACCURACY \_\_\_\_\_  
 SOURCE OF ELEVATION \_\_\_\_\_

I THE UNDERSIGNED, HEREBY CERTIFY THAT THIS PLAT IS CORRECT TO THE BEST OF MY KNOWLEDGE AND BELIEF AND SHOWS ALL THE INFORMATION REQUIRED BY LAW AND THE REGULATIONS ISSUED AND PRESCRIBED BY THE DEPARTMENT OF MINES.  
 (SIGNED) Donald J. Leaf  
 R.P.E. \_\_\_\_\_ L.L.S. 241

PLACE SEAL HERE

4) DENOTES LOCATION OF WELL ON UNITED STATES TOPOGRAPHIC MAPS  
 FORM IV-6 (8-78)



STATE OF WEST VIRGINIA  
 DEPARTMENT OF MINES  
 OIL AND GAS DIVISION

DATE MAR 25 19 80  
 OPERATOR'S WELL NO. GW 298(1-59)  
 API WELL NO. \_\_\_\_\_  
47 - 017 - 2143  
 STATE COUNTY PERMIT

WELL TYPE: OIL \_\_\_\_\_ GAS X LIQUID INJECTION \_\_\_\_\_ WASTE DISPOSAL \_\_\_\_\_  
 (IF "GAS") PRODUCTION \_\_\_\_\_ STORAGE \_\_\_\_\_ DEEP \_\_\_\_\_ SHALLOW X  
 LOCATION: ELEVATION 1198 WATERSHED LEFT FK OF ARNOLDS CR  
 DISTRICT WEST UNION COUNTY DODDRIDGE  
 QUADRANGLE OXFORD T 1/2, Holbrook NE  
 SURFACE OWNER \_\_\_\_\_ ACREAGE \_\_\_\_\_  
 OIL & GAS ROYALTY OWNER MAXWELL 'A' LEASE ACREAGE \_\_\_\_\_  
 LEASE NO. \_\_\_\_\_  
 PROPOSED WORK: DRILL \_\_\_\_\_ CONVERT \_\_\_\_\_ DRILL DEEPER \_\_\_\_\_ REGRILL \_\_\_\_\_ FRACTURE GR  
 STIMULATE \_\_\_\_\_ PLUG OFF OLD FORMATION \_\_\_\_\_ PERFORATE NEW  
 FORMATION \_\_\_\_\_ OTHER PHYSICAL CHANGE IN WELL (SPECIFY)  
F.E.R.C. FILLING  
 PLUG AND ABANDON \_\_\_\_\_ CLEAN OUT AND REFLUG \_\_\_\_\_  
 TARGET FORMATION \_\_\_\_\_ ESTIMATED DEPTH \_\_\_\_\_  
 WELL OPERATOR CITE'S SERVICE Co DESIGNATED AGENT SAM J. MATHEWS  
 ADDRESS PO BX 873 ADDRESS PO BX 873  
CHARLESTON WV CHARLESTON WV

# LOG OF WELL

Well No. \_\_\_\_\_

From West Union      Columbia Carbon Co.      Lewis Maxwell      Well No. 298

FORMATION	COLOR	HARD OR SOFT	No. ON SAMPLE BOTTLE	TOP	BOTTOM	AMOUNT
Soil and Red Rock				0	35	35
Conductor Box				16	16	18
Sand Rock				35	70	35
Red Rock				70	80	10
Red Rock				80	110	30
Lime Rock				110	135	25
Red Rock				135	165	30
Sand Rock				165	230	65
Red Rock				230	265	35
Lime Rock				265	296	31
Red Rock				296	320	24
Lime Rock				320	347	27
Red Rock				347	429	82
Sand Rock				429	465	36
Red Rock				465	505	40
Lime Rock				505	510	5
Black Slate				510	530	20
Lime Hard				530	540	10
Slate Rock				540	620	80
Lime Hard				620	640	20
Pink Rock				640	657	17
White Slate				657	670	13
Red Rock				670	725	55
Lime Hard				725	750	25
Pink Lime				750	780	30
Hard Lime Gray				780	800	20
Red Rock				800	845	45
Middle Dunkard Sand				845	858	13
Slate Rock				858	873	15
Red Rock				873	891	18
Lime Hard				891	907	16
Red Rock				907	913	6
Lime				913	938	25
Red Rock Shells				938	970	32
Slate Black				970	1000	30
Big Dunkard Sand				1000	1020	20
Black Slate				1020	1040	20
Gas Sand Hard				1040	1060	20
Slate Rock				1060	1155	95
Lime				1155	1180	25
1 St. Salt Sand				1180	1220	40
Lime				1220	1235	15
Sand				1235	1240	5
Slate				1240	1370	130
2 Nd. Salt Sand				1360	XXXXXX	XXXXXX
Little Show of Oil and Water ←				1375	XXXXXX	XX XX
More Water, Hole Full				1390	1440	50
Lime Rock				1440	1480	40
3 Rd. Salt Sand				1480	1495	15
Slate Rock				1495	1525	30
4 th. Salt Sand				1525	1545	20
Slate Rock				1545	1560	15
5 th. Salt Sand				1560	1620	60
Lime Rock				1620	1635	15
Slate Rock				1635	1667	32
Sand Hard, Salt Sand				1667	1680	13
Slate Soft				1680	1735	55
Maxon Sand ←				1704	1720	16
Gas 38/10 Water in 3 Inch, = 585 MCF				1735	1768	33
Slate and Shells				1768	1781	13
Stray Sand				1781	1803	22
Lime				1803	1808	5
XXXXXX Slate Soft						

017 0143

was: ~~Dodd~~ Dodd, 30

Line Hard Little  
Fencil Caves  
Big Line  
Big Injun Sand  
Gas 8/10 Mercury through 8 inch. = 989 MCF  
Slate Rock  
Total Depth

1888	1891
1898	1914
1914	1929
1930	2011
1982	1984
2011	2013

Started Spuding Oct. 15/1930 and Finished drilling Nov. 12/1930  
Pulled the 10" casing and shut well in 6 5/8 casing.  
Casing left in well 8 1/2 1195 ft. 7 in. 6 5/8 1825 ft. 2 in.  
6 5/8 Casing had perforated joint 133 ft and 11 in., to 155 ft., 4 in., from bottom. Packer set from 223 ft., 9 in., to 228 ft., 1 in., from bottom.  
Total length of pipe in hole 1886 ft., 2 inches. Steel shoe on bottom of 6 5/8. Pulled all of the 10" and left the 8" in well.  
Drillers on well, O. L. Pratt, Weston, W. Va.  
Algy McKinney, West Union, W. Va.  
Tooldressers on well, Gainer Pratt, Weston, W. Va.  
French Pratt, Weston, W. Va.  
This record was copied from original well record by F. S. Creathouse.

1886  
228  
1658

2011  
2013

2011  
2013

AFFIDAVIT OF PLUGGING AND FILLING WELL

AFFIDAVIT SHOULD BE MADE IN TRIPLICATE, one copy mailed to the Division, one copy to be retained by the Well Operator and the third copy (and extra copies if required) should be mailed to each coal operator at their respective addresses.

N/A  
Coal Operator or Owner

Cities Service Oil and Gas Corporation  
Name of Well Operator  
P. O. Box 873, Charleston, WV 25323

Address  
Lewis Maxwell Heirs, c/o Robert L. Holland

Complete Address  
19

WELL AND LOCATION

~~Coal Operator or Owner~~  
Lease or Property Owner  
P. O. Box 425, West Union, WV 26456  
Address

West Union District  
Doddridge County

Robert S. Maxwell, West Union, WV 26456  
Lease or Property Owner  
Lorenzo Roy, Rt. 2, Gen. Del., Philippi, WV 26416  
Address

WELL NO. Maxwell "A" #59, GW-298  
Lewis Maxwell Heirs Farm

STATE INSPECTOR SUPERVISING PLUGGING Mike Underwood, Rt. 2, Box 135, Salem, WV 26426  
Phone: 782-1043

AFFIDAVIT

STATE OF WEST VIRGINIA,  
County of Kanawha ss:

Wesley Shultz and Blaine W. Minney  
being first duly sworn according to law depose and say that they are experienced in the work of plugging and filling oil and gas wells and were employed by Cities Service Oil and Gas Corporation, well operator, and participated in the work of plugging and filling the above well, that said work was commenced on the 4th day of August, 19 86, and that the well was plugged and filled in the following manner:

Sand or Zone Record Formation	Filling Material	Plugs Used Size & Kind	Casing	
			CSG PULLED	CSG LEFT IN
1982-1657	Class A Cement	325' - 70 sxs		
1657-1394	6% Gel			
1394-1100	Class A Cement	294' - 90 sxs		
1100-217	6% Gel			
217-Surface	Class A Cement	217'- 107 sxs		
		7" 17#	1410'	476'
		8-5/8" 24#	196'	999'
Coal Seams		Description of Monument		
(Name)		7" csg 3' above GL inscribed		
(Name)		Lewis Maxwell A-59 GW-298		
(Name)		API #47-017-2143-P		
(Name)		CSOGC		

9/16/86

and that the work of plugging and filling said well was completed on the 14th day of August, 19 86.

And further deponents saith not.

Sworn to and subscribed before me this 2nd day of September, 19 86.

Wesley Shultz  
Blaine W. Minney  
Donald Gray  
~~Commissioner~~ Commissioner

My commission expires:

June 1, 1989

Permit No. 47-017-2143-P

SEP 22 1986