

LATITUDE 39° 15' 00"

LONGITUDE 80° 47' 30"



7'5 OGIS topo location

7.5' loc  $\frac{1.73 S}{0.44 W}$

15' loc  $\frac{1.73 S}{2.67 W}$   
(calc.)

Company \_\_\_\_\_

Farm \_\_\_\_\_

Quad OXFORD 7 1/2' Holbrook NE

County DODDRIEGE

District WEST UNION

WELL LOCATION MAP

File No. 017-2128

LATITUDE 39° 15' 00"

LONGITUDE 80° 47' 30"

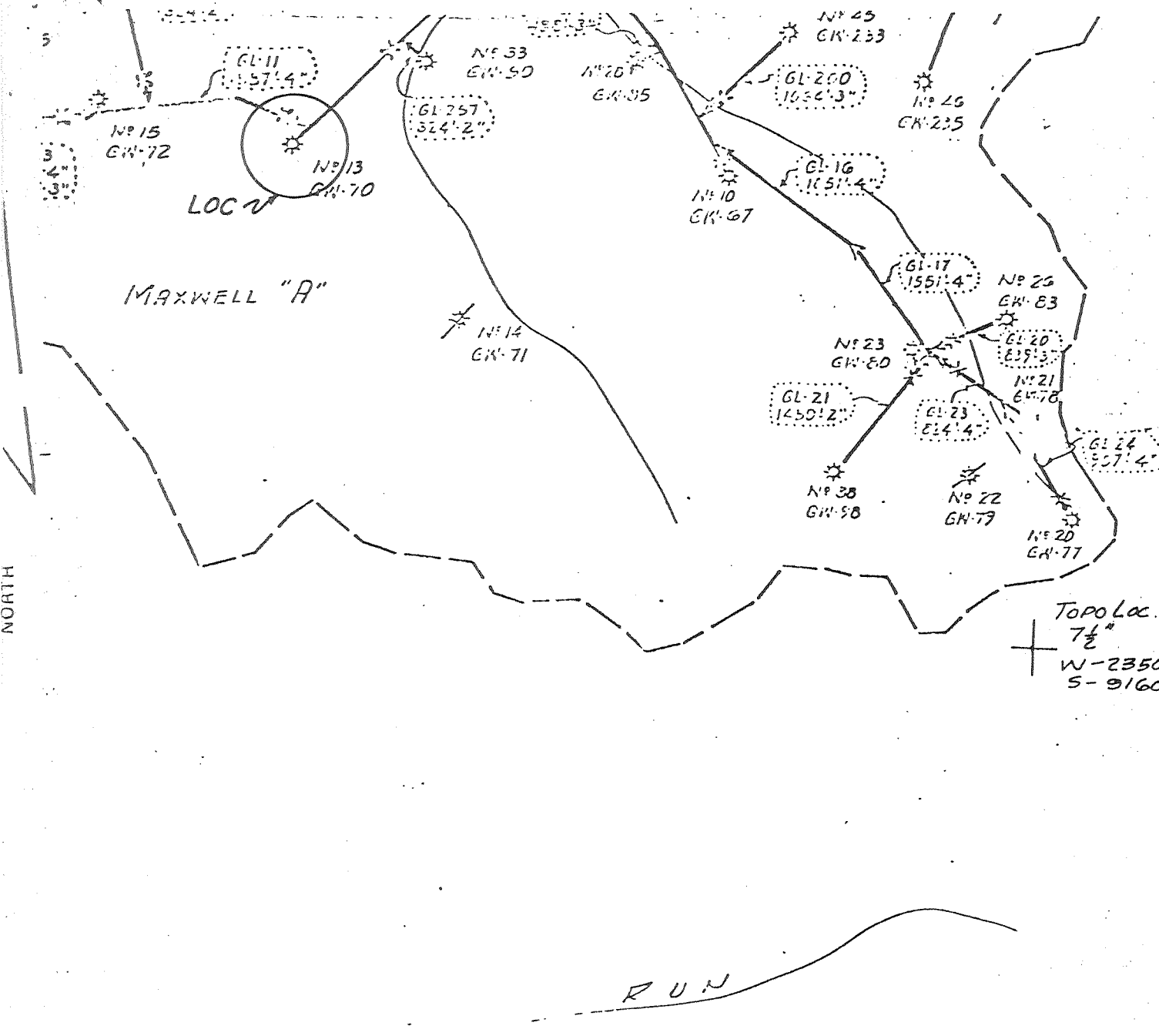

FILE NO. \_\_\_\_\_  
 DRAWING NO. \_\_\_\_\_  
 SCALE 1"=1320  
 MINIMUM DEGREE OF ACCURACY \_\_\_\_\_  
 PROVEN SOURCE OF ELEVATION \_\_\_\_\_

I THE UNDERSIGNED, HEREBY CERTIFY THAT THIS PLAT IS CORRECT TO THE BEST OF MY KNOWLEDGE AND BELIEF AND SHOWS ALL THE INFORMATION REQUIRED BY LAW AND THE REGULATIONS ISSUED AND PRESCRIBED BY THE DEPARTMENT OF MINES.

(SIGNED) Arnold J. Bay  
 R.P.E. \_\_\_\_\_ L.L.S. 247

PLACE SEAL HERE

(+) DENOTES LOCATION OF WELL ON UNITED STATES TOPOGRAPHIC MAPS



DATE MAR 25, 1960  
 OPERATOR'S WELL NO. GW70(A-13)  
 API WELL NO. \_\_\_\_\_  
47 - 017 - 2128  
 STATE COUNTY PERMIT

STATE OF WEST VIRGINIA  
 DEPARTMENT OF MINES  
 OIL AND GAS DIVISION

WELL TYPE: OIL \_\_\_ GAS X LIQUID INJECTION \_\_\_ WASTE DISPOSAL \_\_\_  
 (IF "GAS,") PRODUCTION \_\_\_ STORAGE \_\_\_ DEEP \_\_\_ SHALLOW X  
 LOCATION: ELEVATION 955' WATERSHED LEFT FK OF ARNOLDS CK  
 DISTRICT WEST UNION COUNTY ODDDRIDGE  
 QUADRANGLE OXFORD 7 1/2'

SURFACE OWNER \_\_\_\_\_ ACREAGE \_\_\_\_\_  
 OIL & GAS ROYALTY OWNER MAXWELL 'A' LEASE ACREAGE \_\_\_\_\_  
 LEASE NO. \_\_\_\_\_

PROPOSED WORK: DRILL \_\_\_ CONVERT \_\_\_ DRILL DEEPER \_\_\_ REDRILL \_\_\_ FRACTURE OR STIMULATE \_\_\_ PLUG OFF OLD FORMATION \_\_\_ PERFORATE NEW FORMATION \_\_\_ OTHER PHYSICAL CHANGE IN WELL (SPECIFY) F.E.R.C. FILING

PLUG AND ABANDON \_\_\_ CLEAN OUT AND REPLUG \_\_\_  
 TARGET FORMATION \_\_\_\_\_ ESTIMATED DEPTH \_\_\_\_\_  
 WELL OPERATOR CITIES SERVICE Co DESIGNATED AGENT SAM J. MATTHEWS  
 ADDRESS P.O. BX 873 ADDRESS P.O. BX 873  
CHARLESTON, WV CHARLESTON, WV