

LATITUDE

3915

808

LONGITUDE

LONGITUDE

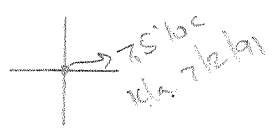

7'5 OGIS topo location

7.5' loc	<u>1465</u>	15' loc	<u>1465</u>
	<u>154W</u>	(calc.)	<u>154W</u>

Company _____

Farm _____

SECTION NE 2 =

Quad Oxford Holbrook NE

County _____

District W. Union

WELL LOCATION MAP

File No. Dodd 2127

NORTH

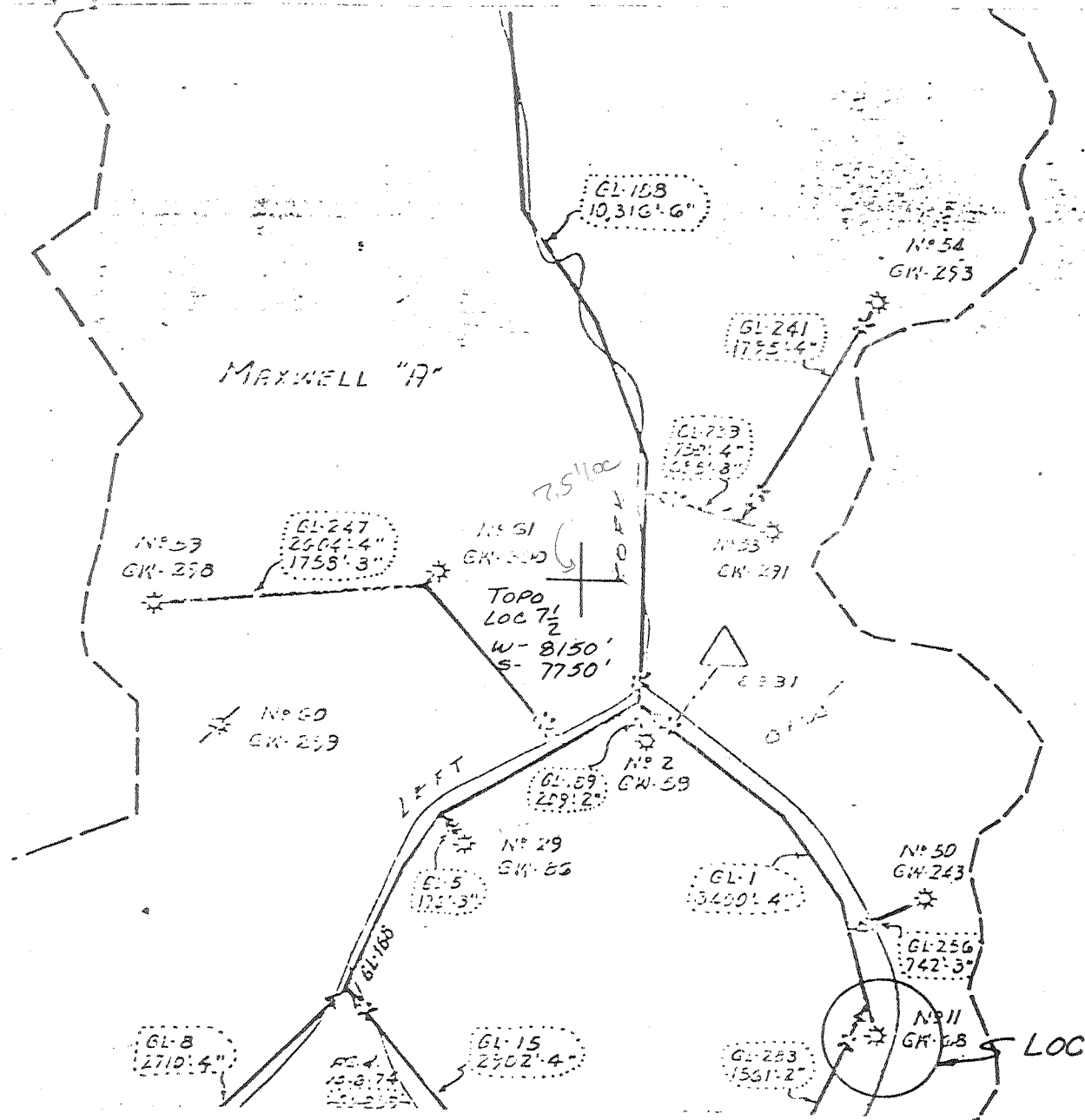

FILE NO. _____
 DRAWING NO. _____
 SCALE 1"=1320
 MINIMUM DEGREE OF ACCURACY _____
 PROVEN SOURCE OF ELEVATION _____

I THE UNDERSIGNED, HEREBY CERTIFY THAT THIS PLAT IS CORRECT TO THE BEST OF MY KNOWLEDGE AND BELIEF AND SHOWS ALL THE INFORMATION REQUIRED BY LAW AND THE REGULATIONS ISSUED AND PRESCRIBED BY THE DEPARTMENT OF MINES.
 (SIGNED) Samuel J. Bay
 R.P.E. _____ L.L.S. 247

PLACE SEAL HERE

(+) DENOTES LOCATION OF WELL ON UNITED STATES TOPOGRAPHIC MAPS
 FORM IV-6 (8-78)



DATE MAR 25 1980
 OPERATOR'S WELL NO. GW 68 (A-11)
 API WELL NO. _____
47 - 017 - 2127
 STATE COUNTY PERMIT

STATE OF WEST VIRGINIA
 DEPARTMENT OF MINES
 OIL AND GAS DIVISION

WELL TYPE: OIL ___ GAS ___ LIQUID INJECTION ___ WASTE DISPOSAL ___
 (IF "GAS,") PRODUCTION ___ STORAGE ___ DEEP ___ SHALLOW X
 LOCATION: ELEVATION 995' WATERSHED LEFT FK OF ARNOLDS CK
 DISTRICT WEST UNION COUNTY DODDRIDGE
 QUADRANGLE OXFORD 7 1/2
 SURFACE OWNER _____ ACREAGE _____
 OIL & GAS ROYALTY OWNER MAXWELL 'A' LEASE ACREAGE _____
 LEASE NO. _____
 PROPOSED WORK: DRILL ___ CONVERT ___ DRILL DEEPER ___ REDRILL ___ FRACTURE OR STIMULATE ___ PLUG OFF OLD FORMATION ___ PERFORATE NEW FORMATION ___ OTHER PHYSICAL CHANGE IN WELL (SPECIFY) F.E.R.C. FILLING
 PLUG AND ABANDON ___ CLEAN OUT AND REPLUG ___
 TARGET FORMATION _____ ESTIMATED DEPTH _____
 WELL OPERATOR CITES SERVICE Co DESIGNATED AGENT SAM J. MATTHEWS
 ADDRESS P.O. BX 873 ADDRESS P.O. BX 873
CHARLESTON W.V. CHARLESTON W.V.

CODE No. G. V. 88 *GW 68* NAME Lewis Maxwell #11-A

Horizontal

CASING AND TUBING

PACKERS

GAS, WATER AND OIL RECORD

SIZE	PLT IN WELL	PULLED	CASING FT.	SIZE	MAKE	SET AT	LIQUID OR GAS	DEPTH	FT. RAISED IN HOLE	VOLUME
Conductor			10'				Gas	SD. 2100 - 2130		Doddridge
10" Casing			220'	1 - 6-5/8"x5-3/16"	Hook Wall		Oil & Water	1115		2127
8 1/2" Casing			887'		Packer		Gas	1440 - 1470		
6 5/8" Casing			1610'				Gas	1687 - 1680		Show in Inj
5-3/16" 17# 1654'8"										
2-3/8" 1750'7"									2329 - 2332	Est. 1 Million
5-1/2" Liner 75'8"										

RECORD OF SHOT

DATE SHOT	FROM	TO	SAND	TYPE OF EXPLOSIVE	QUANTITY	PRODUCTION BEFORE SHOT	PRODUCTION AFTER SHOT
			Not shot				

YEAR DEPLETION CALCULATION GRAPHIC FROM TO THICKNESS FORMATION

LOG

RECONDITIONED: 9-4-36 to 12-29-36							
Water broke in and drowned gas.	100'			Conductor		10	
Gas came back after water was shut off. Used 1654'8" of 5-3/16" 17# casing and 1-6-5/8x5-3/16" Hook Wall Packer. Open Flow 4/10 W 1 1/2" 23,640 cu ft - 1/4 bbl. oil & water 20" 1/4".	200'			Water		20	
	300'			10" Casing		220	
	400'			Big Dunkard Sand		880	1000
	500'			8 1/2" Casing		887	
	600'			Gas Sand		1100	1150
	700'			Oil & Water		1115	
	800'			Coal		1155	
	900'			Maxon Sand Gas		1440	1470
	1000'			Little Lime		1578	1588
				Pencil Cave		1588	1600
				Big Lime		1600	1675
				6 5/8" Casing		1610	
				Big Injun Sand		1675	1745
				Gas		1687	1690
				Gantz Sand		1915	2040
				30-foot Sand Shells		2240	2250
				Stray Sand		2312	2380
				Gordon Sand		2329	2332
				Total depth		2348'	

Re conditioned 6-24-58 to 8-9-58

7" casing leaking - found hole at 1280' - pulled 5-1/2" casing. Ran 75'8" of 5-1/2" O. D. casing, 1750'7" of 2-3/8" O. D. 4.6# tubing 1 2-3/8"x5-1/2" anchor packer 1 Parmaco gas head, 1 tubing cage Cemented 7" casing and fractured Big Injun as follows:

Pumped in 10 gallons Hyflo. Filled tubing and hole with 17 bbls. kerosene. Broke down with 2 pumps. Inj. rate 8 bbls/min for 5 minutes. Maximum 1600#-broke to 1400#. Gelled 4,000 gallons kerosene and injected with 3500# sand. Injection rate 7.1 bbls/min. Max. pressure 2050#-at end of gel 1950#. Flushed with 40 bbls. kerosene. Inj. rate 7.3 bbls/min. maximum 1950#- final 1600#.

Released packer and pulled tubing

Ran 1750'7" of 2-3/8" tubing. Set packer at 1673' - top of packer 1668' 75'8" of 5-1/2" O. D. anchor. Ran cage and 1 perforated joint on 2"

2264' Last Below 10-55

yes E



STATE OF WEST VIRGINIA
DEPARTMENT OF MINES
OIL AND GAS DIVISION

Quadrangle _____

Permit No. 017-2127

WELL RECORD

Oil or Gas Well gas
(KIND)

Company Columbian Carbon Company
Address Box 873, Charleston 23, W. Va.
Farm Lewis Maxwell Acres _____
Location (waters) Arnolds Creek
Well No. 11-A -- GW-68 Elev. _____
District West Union County Doddridge
The surface of tract is owned in fee by Mrs. Grace Gaylord
tal (for further addresses contact CCC)
Address _____
Mineral rights are owned by same
Address _____

Casing and Tubing	Used in Drilling	Left in Well	Packers
Size Conductor	10'		Kind of Packer
16			Hookwall
13			Size of <u>6-5/8"</u>
10"	220'		Depth set
8 1/4"	887'		
6 3/8"	1610'		
5 3/16" 17#	1654' 8"		
3			Perf. top
2			Perf. bottom
Liners Used			Perf. top
			Perf. bottom

Drilling commenced _____
Drilling completed December 17, 1912
Date Shot _____ From _____ To _____
With _____
Open Flow /10ths Water in _____ Inch
/10ths Merc. in _____ Inch
Volume _____ Cu. Ft.
Rock Pressure _____ lbs. _____ hrs.
Oil _____ bbls., 1st-24 hrs.
WELL ACIDIZED _____
WELL FRACTURED _____

CASING CEMENTED _____ SIZE _____ No. Ft. _____ D
COAL WAS ENCOUNTERED AT _____ FEET _____ INCH
_____ FEET _____ INCHES _____ FEET _____ INCH
_____ FEET _____ INCHES _____ FEET _____ INCH

RESULT AFTER TREATMENT

ROCK PRESSURE AFTER TREATMENT

Fresh Water _____ Feet Salt Water _____ Feet

Formation	Color	Hard or Soft	Top	Bottom	Oil, Gas or Water	Depth	Remarks
Conductor			10				
Water			20				
10" casing			220				
Big Dunkard Sand			880	1000			
8-1/4" casing			887				
Gas Sand			1100	1150			
Oil and Water			1115				
Coal			1155				
Mason Sand Gas			1440	1470			
Little Lime			1578	1588			
Pencil Cave			1588	1600			
Big Lime			1600	1675			
6-5/8" casing			1610				
Big Injun Sand			1675	1745			
Gas			1687	1690			
Gantz Sand			1915	2040			
Thirty Foot Sand Shells			2240	2250			
Stray Sand			2312	2320			
Gordon Sand			2329	2332			
Total depth			2348				