

LATITUDE 39° 20' 00"

80° 42' 30"

LONGITUDE

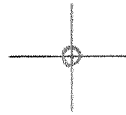

7.5 OGIS topo location

7.5' loc 1.95S
1.21W

15' loc 1.95S
(calc.) 3.44W

Company _____

Farm _____

Quad SMITH BURG ^{Centerpoint SW} 7/2

County DODDRIDGE

District WEST UNION

WELL LOCATION MAP

File No. 017-2121

2, not loc.

ORIGINAL

LONGITUDE 80 42' 30"

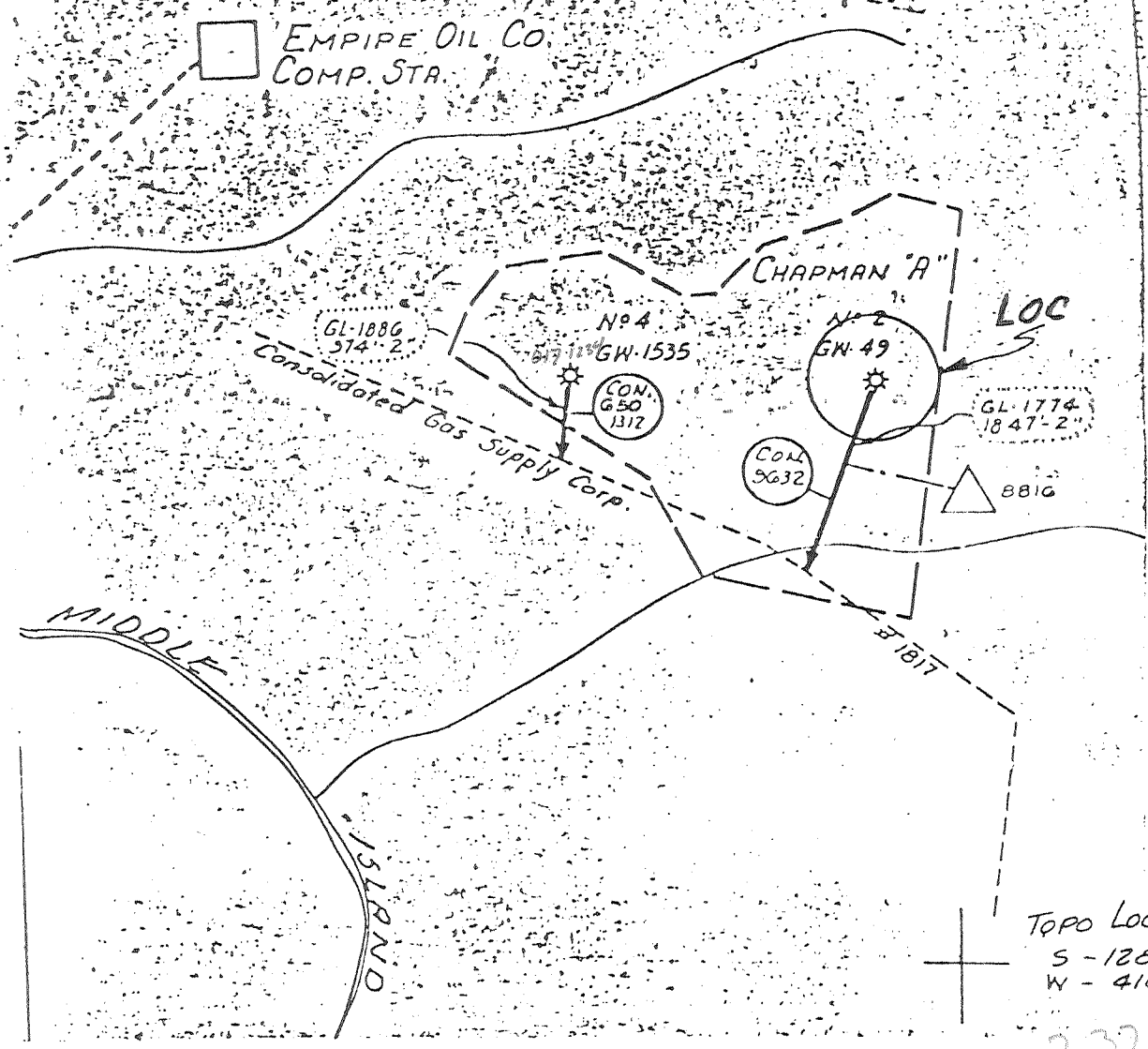

TOPO LOC 7 1/2
S - 12875'
W - 4100'

237
0-70

FILE NO. _____
 DRAWING NO. _____
 SCALE 1" = 1320
 MINIMUM DEGREE OF ACCURACY _____
 PROVEN SOURCE OF ELEVATION _____

I THE UNDERSIGNED, HEREBY CERTIFY THAT THIS PLAT IS CORRECT TO THE BEST OF MY KNOWLEDGE AND BELIEF AND SHOWS ALL THE INFORMATION REQUIRED BY LAW AND THE REGULATIONS ISSUED AND PRESCRIBED BY THE DEPARTMENT OF MINES

(SIGNED) Samuel J. Bay
 R.P.E. _____ L.L.S. 247

PLACE SEAL HERE

(+) DENOTES LOCATION OF WELL ON UNITED STATES TOPOGRAPHIC MAPS



DATE MAR 26 19 80
 OPERATOR'S WELL NO. GW49 (A-2)
 API WELL NO. _____
47 - 017 - 2121
 STATE COUNTY PERMIT

STATE OF WEST VIRGINIA
 DEPARTMENT OF MINES
 OIL AND GAS DIVISION

WELL TYPE: OIL ___ GAS X LIQUID INJECTION ___ WASTE DISPOSAL ___
 (IF "GAS,") PRODUCTION ___ STORAGE ___ DEEP ___ SHALLOW X
 LOCATION: ELEVATION 1180 WATER SHED MEATHOUSE FORK
 DISTRICT NEW MILTON COUNTY DODDRIDGE
 QUADRANGLE SMITHBURG 7 1/2
 SURFACE OWNER _____ ACREAGE _____
 OIL & GAS ROYALTY OWNER CHAPMAN 'A' LEASE ACREAGE _____
 LEASE NO. _____
 PROPOSED WORK: DRILL ___ CONVERT ___ DRILL DEEPER ___ REDRILL ___ FRACTURE OR STIMULATE ___ PLUG OFF OLD FORMATION ___ PERFORATE NEW FORMATION ___ OTHER PHYSICAL CHANGE IN WELL (SPECIFY) F.E.R.C. FILING
 PLUG AND ABANDON ___ CLEAN OUT AND REPLUG ___
 TARGET FORMATION _____ ESTIMATED DEPTH _____
 WELL OPERATOR CITIES SERVICE Co. DESIGNATED AGENT SAM J. MATTHEWS
 ADDRESS PO Bx 873 ADDRESS PO Bx 873
CHARLESTON WV 25373 CHARLESTON WV 2532

RECEIVED

1.0 API well number: (If not available, leave blank. 14 digits.)	47-017-02121 0000												
2.0 Type of determination being sought: (Use the codes found on the front of this form.)	108 Section of NGPA												
3.0 Depth of the deepest completion location: (Only needed if sections 103 or 107 in 2.0 above.)	--- feet												
4.0 Name, address and code number of applicant: (35 letters per line maximum. If code number not available, leave blank.)	Cities Service Company Name Box 300 Street Tulsa City OK State 74102 Zip Code												
5.0 Location of this well: [Complete (a) or (b).] (a) For onshore wells (35 letters maximum for field name.)	Smithburg Field Name Doddridge County WV State												
(b) For OCS wells:	N/A Area Name Date of Lease: Mo. Day Yr. OCS Lease Number												
(c) Name and identification number of this well: (35 letters and digits maximum.)	Chapman A #2												
(d) If code 4 or 5 in 2.0 above, name of the reservoir: (35 letters maximum.)	N/A												
6.0 (a) Name and code number of the purchaser: (35 letters and digits maximum. If code number not available, leave blank.)	Consolidated Gas Supply Co. Name 004228 Buyer Code												
(b) Date of the contract:	1 2 2 4 2 3 Mo. Day Yr.												
(c) Estimated annual production:	7.5 MMcf												
7.0 Contract price: (As of filing date. Complete to 3 decimal places.)	<table border="1" style="width:100%; border-collapse: collapse;"> <thead> <tr> <th style="width:25%;">(a) Base Price (\$/MMBTU)</th> <th style="width:25%;">(b) Tax</th> <th style="width:25%;">(c) All Other Prices [Indicate (+) or (-).]</th> <th style="width:25%;">(d) Total of (a), (b) and (c)</th> </tr> </thead> <tbody> <tr> <td style="text-align: center;">2 2 6 4</td> <td style="text-align: center;">2 1 4</td> <td style="text-align: center;">---</td> <td style="text-align: center;">2 4 7 8</td> </tr> <tr> <td style="text-align: center;">2 2 6 4</td> <td style="text-align: center;">2 1 4</td> <td style="text-align: center;">---</td> <td style="text-align: center;">2 4 7 8</td> </tr> </tbody> </table>	(a) Base Price (\$/MMBTU)	(b) Tax	(c) All Other Prices [Indicate (+) or (-).]	(d) Total of (a), (b) and (c)	2 2 6 4	2 1 4	---	2 4 7 8	2 2 6 4	2 1 4	---	2 4 7 8
(a) Base Price (\$/MMBTU)	(b) Tax	(c) All Other Prices [Indicate (+) or (-).]	(d) Total of (a), (b) and (c)										
2 2 6 4	2 1 4	---	2 4 7 8										
2 2 6 4	2 1 4	---	2 4 7 8										
8.0 Maximum lawful rate: (As of filing date. Complete to 3 decimal places.)	<table border="1" style="width:100%; border-collapse: collapse;"> <thead> <tr> <th style="width:25%;">(a) Base Price (\$/MMBTU)</th> <th style="width:25%;">(b) Tax</th> <th style="width:25%;">(c) All Other Prices [Indicate (+) or (-).]</th> <th style="width:25%;">(d) Total of (a), (b) and (c)</th> </tr> </thead> <tbody> <tr> <td style="text-align: center;">2 2 6 4</td> <td style="text-align: center;">2 1 4</td> <td style="text-align: center;">---</td> <td style="text-align: center;">2 4 7 8</td> </tr> <tr> <td style="text-align: center;">2 2 6 4</td> <td style="text-align: center;">2 1 4</td> <td style="text-align: center;">---</td> <td style="text-align: center;">2 4 7 8</td> </tr> </tbody> </table>	(a) Base Price (\$/MMBTU)	(b) Tax	(c) All Other Prices [Indicate (+) or (-).]	(d) Total of (a), (b) and (c)	2 2 6 4	2 1 4	---	2 4 7 8	2 2 6 4	2 1 4	---	2 4 7 8
(a) Base Price (\$/MMBTU)	(b) Tax	(c) All Other Prices [Indicate (+) or (-).]	(d) Total of (a), (b) and (c)										
2 2 6 4	2 1 4	---	2 4 7 8										
2 2 6 4	2 1 4	---	2 4 7 8										
9.0 Person responsible for this application:	W. F. Hanagan Name Manager, Natural Gas Sales and Regulation Title Signature 2/16/79 Date Application is Completed (918) 586-3239 Phone Number												

Agency Use Only
Date Received by Jurisdiction Agency FEB 27 1979
Date Received by FERC

Chapman A-2

RECORD OF VIVIAN CHERMAN No. 2

CONTRACTOR J. E. TRAINER.

Native Coal		100'
Coal		360
Big Dankard		900
Gas Sand		910
Salt Sand		1130
Big Lime		1680
Big Injun	1747	1894
Gantz Sand	2020	2115
Gordon Stray	2462	2472
Gordon	2485	2492
Gas at	2487	
Total Depth	2497	

Finished Nov. 8th, 1907

10" casing

202' *Pulled out*

8-1/4" "

915' *Pulled out*

6-5/8" "

1732

2497

017-2121