

Jamie
4/16/91

HAESSLY HARDWOOD LUMBER SALES

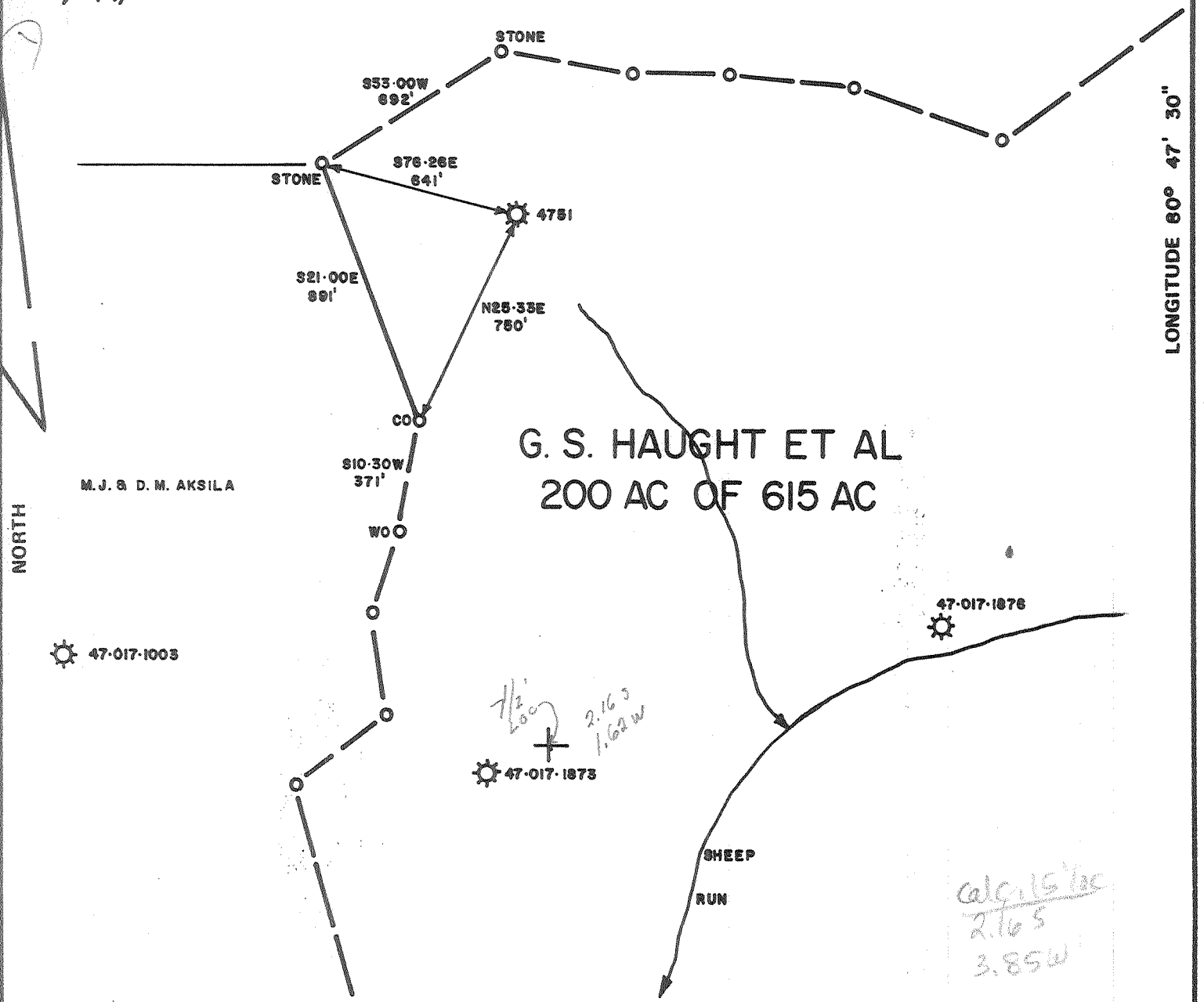

LONGITUDE 60° 47' 30"

11250'

FILE NO. _____
 DRAWING NO. _____
 SCALE 1" = 500'
 MINIMUM DEGREE OF ACCURACY 1 IN 200
 PROVEN SOURCE OF ELEVATION RD FORKS
841'

I THE UNDERSIGNED, HEREBY CERTIFY THAT THIS PLAT IS CORRECT TO THE BEST OF MY KNOWLEDGE AND BELIEF AND SHOWS ALL THE INFORMATION REQUIRED BY LAW AND THE REGULATIONS ISSUED AND PRESCRIBED BY THE DEPARTMENT OF MINES.
 (SIGNED) David L. Mitchell
 R.P.E. _____ L.L.S. 873

UTM E 515372.9
 UTM N 4340843.5
 3070
 PLACE SEAL HERE

(+) DENOTES LOCATION OF WELL ON UNITED STATES TOPOGRAPHIC MAPS
 FORM IV-6
 (7-87)



DATE 11/27/89, 19____
 OPERATOR'S WELL NO. 4751
 API WELL NO. 47 - 017 - 2070-P
 STATE COUNTY PERMIT

STATE OF WEST VIRGINIA
 DEPARTMENT OF MINES
 OIL AND GAS DIVISION

WELL TYPE: OIL ___ GAS X LIQUID INJECTION ___ WASTE DISPOSAL ___
 (IF "GAS,") PRODUCTION X STORAGE ___ DEEP ___ SHALLOW ___
 LOCATION: ELEVATION 1148' WATER SHED SHEEP RUN
 DISTRICT SOUTHWEST COUNTY DODDRIDGE
 QUADRANGLE OXFORD, W. VA. / HOLBROOK (NE) 54-1-4
 SURFACE OWNER HAESSLY HARDWOOD LUMBER SALES ACREAGE 615
 OIL & GAS ROYALTY OWNER G. S. HAUGHT ET AL LEASE ACREAGE 615
 LEASE NO. 6125
 PROPOSED WORK: DRILL ___ CONVERT ___ DRILL DEEPER ___ REDRILL ___ FRACTURE OR STIMULATE ___ PLUG OFF OLD FORMATION ___ PERFORATE NEW FORMATION ___ OTHER PHYSICAL CHANGE IN WELL (SPECIFY) _____

PLUG AND ABANDON X CLEAN OUT AND REPLUG ___
 TARGET FORMATION 4TH SALT/SIG INJUN ESTIMATED DEPTH 2013' (TD)
 WELL OPERATOR EQUITRANS DESIGNATED AGENT BILL HOSTUTLER
 ADDRESS 4955 STEUBENVILLE PIKE ADDRESS P.O. BOX 1550
PITTSBURGH, PA. 15205 CLARKSBURG, WV 26301

COMPANY

FORM: G38-14263

Record of Well No. 4757 Located on Eli Mutter Farm Jaw 14 1920
Southwest District Dodbridge County West Va State
 Division 9 District No. Drilled under well Order 15227
 Rig built by John Craig Began Feb 2 1920 Completed Feb 16 1920
W. H. Young Began Aug 2 1929 Completed Aug 14 1929
 Well drilled by W. H. Young Began Feb 25 1920 Completed May 26 1920
 Depth of Well 1936 feet Size of Hole 5 3/16 Producing Gas
 Elev: 1145 2013

CASED WITH			REMARKS
ANNUITY	SIZE	JOINTS	
<u>442</u>	<u>10</u>	<u>28</u>	
<u>1001</u>	<u>8 1/4</u>	<u>50</u>	
<u>1400</u>	<u>6 5/8</u>	<u>69</u>	
<u>1885</u>	<u>5 3/16</u>	<u>85</u>	

COAL VEINS 500
505
Sp. Coal

FORMATION	COLOR	OPEN OR CLOSE HARD OR SOFT	TOP	BOTTOM	REMARKS GAS-OIL-WATER (THICKNESS OF PAY)
<u>Little Rock</u>			<u>965</u>	<u>1015</u>	<u>Water 60-2 B lv.</u>
<u>Big "</u>			<u>1020</u>	<u>1080</u>	
<u>Gas sand</u>			<u>1105</u>	<u>1150</u>	
<u>at. salt</u>			<u>1175</u>	<u>1225</u>	
<u>and salt</u>			<u>1280</u>	<u>1330</u>	
<u>3rd salt</u>			<u>1335</u>	<u>1395</u>	<u>Water 1353-570 ft. Could not fail dry</u>
<u>5th salt</u>			<u>1456</u>	<u>1495</u>	
<u>6th salt</u>			<u>1525</u>	<u>1555</u>	
<u>7th "</u>			<u>1610</u>	<u>1655</u>	<u>Gas 1663-1645 - 4 1/2 W 2"</u>
<u>8th "</u>			<u>1700</u>	<u>1780</u>	
<u>Little Limestone</u>			<u>1820</u>	<u>1835</u>	
<u>Big Limestone</u>			<u>1840</u>	<u>1910</u>	
<u>Big Iron</u>			<u>1910</u>	<u>1988</u>	<u>Gas 1923 - 7 1/2 W 5 3/16</u>
<u>Atlat Dept</u>			<u>1936</u>		<u>710 M x</u>
<u>Began drilling at</u>			<u>1936</u>		<u>Oil flow 1945</u>
					<u>Gas 1967-69 - 3 1/2 W 2 1/2"</u>
					<u>1980-85 - 4 1/2 W 2 1/2"</u>

Well # 4757 Eli Nutters

NAME	TOP	BOTTOM	OIL	GAS	WATER	REMARKS
Clay	16					
Loam	16	40				
Sand	40	60				
Red Rock	60	110			100	1/2 barrels out to.
Lime	110	140				
Red Rock	140	150				
Lime	150	210				
Red Rock	210	280				
Lime	280	320				
Red Rock	320	360				
Sand	360	436				
Lime	436	460				
Lime Shells	460	525				
"	525	715				
Red Rock	715	760				
Sand	760	820				
Slate	820	920				
Red Rock	920	965				
Little Oakland	965	1015				
Slate	1015	1020				
Big Oakland	1020	1083				
Lime	1083	1105				
Gas Sand	1105	1150				
Slate	1150	1175				
2nd Salt	1175	1225				
Slate	1225	1280				
3rd Salt	1280	1330				
Slate	1330	1335				
Sand	1335	1395				1352-1362 Hole full
Slate	1395	1420				
4th Salt Sand	1420	1430				
Slate	1430	1455				
5th Salt Sand	1455	1475				
Slate	1475	1522				
5th Salt "	1522	1555				
Slate	1555	1561				
Lime	1561	1600				
Sandy Lime	1600	1653		1623-1645		
Slate	1653	1700				
Mason	1700	1780				
Slate	1780	1783				
Lime	1783	1790				
Slate	1790	1800				
Lime	1800	1815				
Slate	1815	1820				
Little Lime	1820	1835				
Quail Core	1835	1840				
Big Lime	1840	1910				
Big Lime	1910			1911-1923		
Oil Depth	1936					

STATE OF WEST VIRGINIA
DEPARTMENT OF ENERGY
DIVISION OF OIL AND GAS

AFFIDAVIT OF PLUGGING AND FILLING WELL

AFFIDAVIT SHOULD BE IN TRIPPLICATE, one copy mailed to the Division, one copy to be retained by the Well Operator and the third copy (and extra copies if required) should be mailed to each coal operator at their respective addresses.

Farm name: HAESSLY HARDWOOD LUMBER Operator Well No.:4751

LOCATION: Elevation: 1145.00 Quadrangle: OXFORD
District: SOUTHWEST County: DODDRIDGE
Latitude: 11250 Feet South of 39 Deg. 15 Min. 0 Sec.
Longitude 8490 Feet West of 80 Deg. 47 Min. 30 Sec.

Well Type: OIL _____ GAS x

Company: Equitrans, Inc.
3500 Park Lane
Pittsburgh PA 15275

Coal Operator Haessley Hardwood Lumber
or Owner Sales
Rt. #2 Newport Pike
Marietta, OH 45750

Agent: Bill Hostutler
Inspector: Mike Underwood
Permit Issued: 04/16/91

Coal Operator _____
or Owner _____

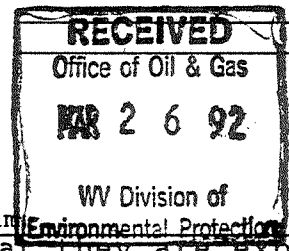

AFFIDAVIT

STATE OF WEST VIRGINIA,
County of Upshur ss:

Alvin Sorcan and Phillip Pulliam being first duly sworn according to law depose and say that they are experienced in the work of plugging and filling oil and gas wells and were employed by Equitrans, Inc., well operator, and participated in the work of plugging and filling the above well, that said work was commenced on the 5 day of March, 1992, and that the well was plugged and filled in the following manner:

TYPE	FROM	TO	PIPE REMOVED		LEFT
cement	1998	1780	5½	1680	205
gel 6%	1780	1700	7	1065	335
cement	1700	1600	8	680	321
gel 6%	1600	1417	10	0	442
cement	1417	1317			
gel 6%	1317	1092			
cement	1092	992			
gel 6%	992	702			
cement	702	602			
gel 6%	602	530			
cement	530	430			
gel 6%	430	100			
cement	100	surface			

Description of monument: 7" casing 4 feet out of ground with API number

and that the work of plugging and filling said well was completed on the 13 day of March, 1992.

And further deponents saith not.

Alvin Sorcan
Phillip Pulliam
Joyce K. Harlow
Notary Public

Sworn and subscribe before me this 17 day of March, 1992
My commission expires: June 16, 1993

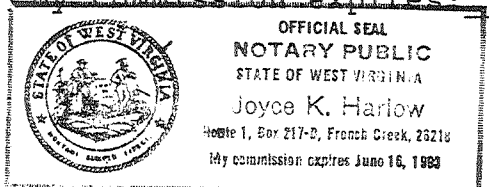

APR 8 1992