

LATITUDE 39° 27' 30"

80° 56' 00" LONGITUDE

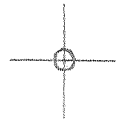

T'5 OGIS topo location

7.5' loc 2.43 S  
0.78 W

15' loc 5.31 S  
(calc.) 0.78 W

Company \_\_\_\_\_

Farm \_\_\_\_\_

Elev 980' - 75 top 14a 315/40  
Centerpoint NC

Quad FOLSOM 7 1/2'

County DODDRIDGE

District MCCLELLAN

WELL LOCATION MAP

File No. 017-1938

HOPE NATURAL GAS CO.

2nd

LOCATION FOR WELL No. 3000

On W. H. Haddock DISTRICT Calhoun Fork  
Bowers Lemaster's Farm, on waters of Calhoun Fork

McBellan District, Doddridge County, West Virginia.

Lease No. 23770 Acres 126 N. 2 S. 2 E. 2 W.

Scale, one inch equals 80 Paces Sent to Clarksburg Office May 2, 1913

Location to be 400 feet from J. W. Hawkins farm line  
~~and 400 feet from Delia Phillips farm line~~

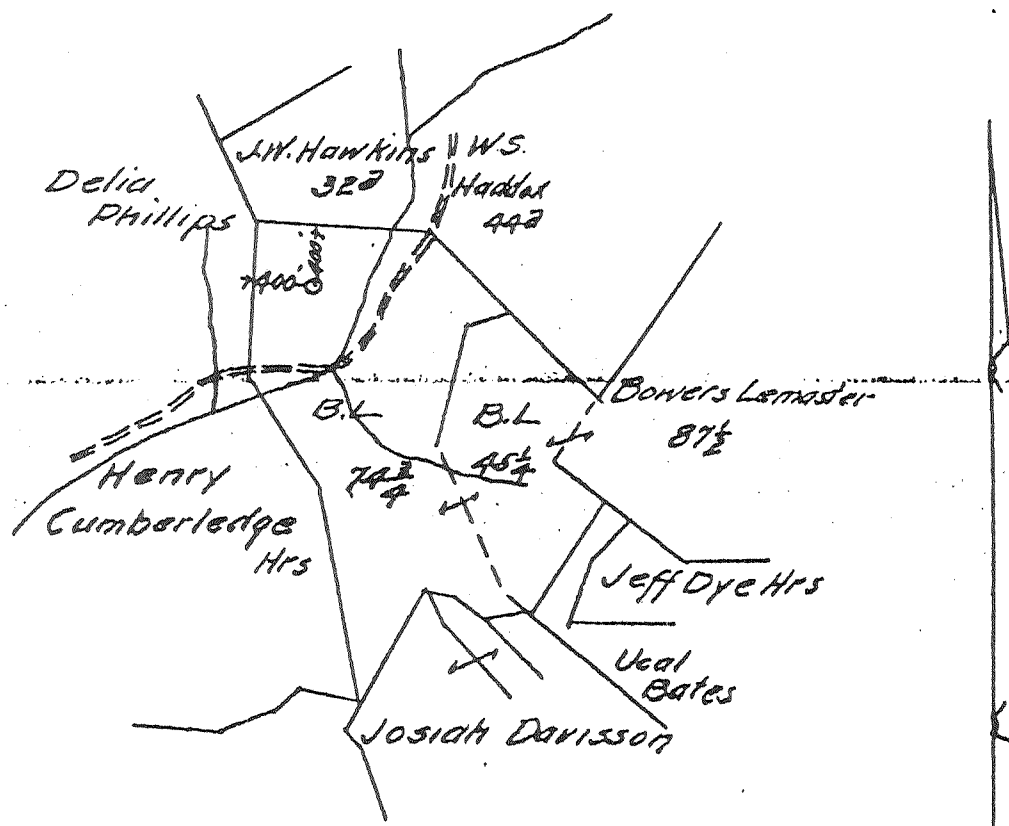

45

API-617-1938

TITLE Good

RESERVE Three hundred feet around the dwelling and barn buildings

SPECIAL INSTRUCTIONS: COMPLETE WELL ON OR BEFORE \_\_\_\_\_

Location made 5-10-13 by W. H. Haddock As per plat, except as noted. On field map

5-13-13 Returned to Pittsburgh 5-13-13

Location changed on account of \_\_\_\_\_

Authorized by \_\_\_\_\_ Date \_\_\_\_\_ Signed \_\_\_\_\_

Record of

Well No. 300.0 v

Located on ...

District ... County ... State ...

Location Made ... First Work Done ... Rig Completed ... Drilling Completed ... Rig Contractor ... Drillers ... Tool Dressers ...

WELL BOOK ... ENTERED FEB 10 1914 G.A.K. ... LARGE RECORD ...

Table with columns: FORMATION, TOP, BOTTOM, Steel Line Measurements, Water Found Depth, Oil Found Depth, Gas Found Depth. Rows include Antive Coal, Pittsburg Coal, Little Dunkard, Gas Sand, First Salt, Second Salt, Maxon, Little Lime, Pencil Cave, Big Lime, Big Injun, Squaw, Berea, Gantz, Fifty Foot, Thirty Foot, Gordon Stray, Gordon, Fourth, Fifth, Hayward, Total Depth.

Table with columns: SIZE, Charged to Well, Put in Well, Packed Out, Left in Well, Transferred Before Completing, Left at Well Not in Use. Rows include 13" Csg., 10" Csg., 8 1/4" Csg., 6 5/8" Csg., 5 3/16" Csg., 2 Tubg., and Pipe 2".

PACKER RECORD

Table with columns: SIZE, KIND, Amount Anchor, Amount Above Anchor, REMARKS. Includes notes about 8 1/4" steel shoe and packings.

SHOOTING RECORD (If shot before or upon completion of well)

Table with columns: DATE, Quarts, Top of Shell, Bottom of Shell, Diameter, Sand, Test Before Shot, Test After Shot, Test Taken After Shot No. Hours, By Whom Shot.

CEMENTING RECORD

Date Cemented ... Top Pittsburg Coal ... Bottom Pittsburg Coal ... Mr. ... of ... Coal Company on ground when coal was cemented ... Remarks ...

APL -017-1938

Approved by ... Foreman