

LATITUDE 39° 20' 00"

LONGITUDE 80° 42' 30"

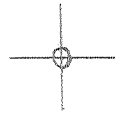

7'5 OGIS topo location

7.5' loc 2.43S
0.79W

15' loc 2.43S
(calc.) 3.02W

Company _____

Farm _____

Elev. 1180' - 75' topo k/a 3/5/93
Centerpointsw

Quad SMITHBURG 7 1/2'

County DODDRIDGE

District WEST UNION

WELL LOCATION MAP

File No. 017-1934

HOPE NATURAL GAS COMPANY.

LOCATION FOR WELL No. 2569

HOPE NATURAL GAS COMPANY

DISTRICT

On *Shirley* Farm, on waters of *Jockey Camp Run*
West District, *Doddridge* County, West Virginia.

Leasing No. *5155* Acres *82* N *S* E *W* *7*

Scale, one inch equals *800* feet Sent to *NYC* *4-10-1912*

Location to be *400 feet from J.C. Coulter's farm*
400 feet from Jones & Blair

017-1934

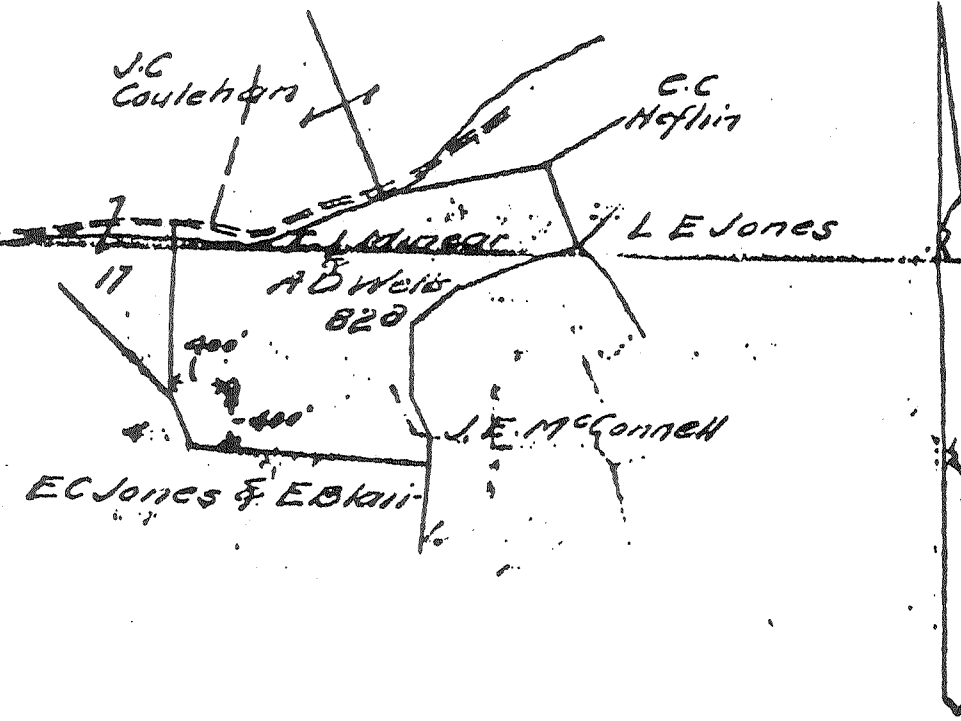

59
60

RESERVE *Five hundred feet around the buildings*

SPECIAL INSTRUCTIONS *Same lease on which is located well No. 946*

Location made *4-19-12* by *W.H. Bradley* as per plat, except as noted. On field map *4-20-12* Returned to Pittsburgh *4-20-12*

Location changed on account of _____

Authorized by _____ Date _____ Signed by _____

Record of Shirley District
 Well No. 2569 Farm
 Located on B. F. Jeffers Jr.
 District Grant County Dodge State W.Va.

Location Made April 19-12 First Work Done April 22-12
 Rig Commenced May 18-12 Rig Completed May 24-12
 Drilling Commenced June 1-12 Drilling Completed July 27-12
 Rig Contractor Johnson & Co. Drilling Contractor Shubert & Reel
 Drillers Wm. Weitz & Al Rawlins
 Tool Dressers A. M. Rice & Bert Cain

FORMATION	TOP	BOTTOM	Steel Line Measurements	Water Found Depth	Oil Found Depth	Gas Found Depth	REMARKS
Native Coal							
Pittsburg Coal							
Little Dunkard							
Gas Sand							
First Salt							
Second Salt							
Maxon							
Little Lime							
Pencil Cove							
Big Lime							
Big Injun							
Sqaw							
Berea							
Gantz							
Fifty Foot							
Thirty Foot							
Gordon Stray							
Gordon							
Fourth							
Fifth							
Bayard							
Total Depth							

Supplement to report marked Aug

SIZE	Charged to Well		Put in Well		Packed Out		Left in Well		Transferred Before Completing		Left at Well Not in Use		If more than two strings of casing are left in hole, give reasons for leaving additional strings
	Foot	In.	Foot	In.	Foot	In.	Foot	In.	Foot	In.	Foot	In.	
12" Csg.													
10" "													
8 1/2" "													
6 5/8" "													
5 1/2-16" "													
Tbg.													

PACKER RECORD

SIZE	KIND	Amount Anchor	Amount Above Anchor	REMARKS
6 5/8 x 8 1/2	Bottom Hole	—	—	1- Packer used
6 5/8 x 5 7/8	"	—	—	1- Packer used
6 5/8 x 2	Anchor Packer	No anchor	1934 1/2 ft 2"	1- " " used as B.F. Packer Casing Co. 6" Hole - No anchor used

SHOOTING RECORD (If shot before or upon completion of well)

DATE	Gauge	Top of Shell	Bottom of Shell	Diameter	Sand	Test Before Shot			Test After Shot			Test Taken After Shot No. Hours	By Whom Shot
						Reading	Liquid	Opening	Reading	Liquid	Opening		

CEMENTING RECORD

Date Cemented..... Size Hole Cemented..... Size Casing Cemented.....
 Top Pittsburg Coal..... Top Cementing..... Amount Cement Used.....
 Bottom Pittsburg Coal..... Bottom Cementing..... Amount Sand Used.....
 Mr..... of..... Coal Company on ground when coal was cemented
 Remarks:..... Signature of persons who cemented well

Approved by W. H. Brown Foreman

017-1934

Located on B. S. Stephens Jr. Farm
 District Grant County Doddridge State W. Va.

Location Made April 19-12 First Work Done April 22-12
 Rig Commenced May 18-12 Rig Completed May 24-12
 Drilling Commenced June 1-12 Drilling Completed July 27-12
 Rig Contractor Jedrovics & Co. Drilling Contractor Lowrance & Peck
 Drillers William Wertz and Al Paulvin
 Tool Dressers A. M. Rice and Bert Carr

ENTERED
 WELL BOOK AUG 12 1912 G.A.P.
 LEASE RECORD
 LEASE BOOK
 WALL MAP Aug 28 1912
 LINE MAP Aug 28 1912
 LOCATION BOOK
 CONTRACTORS PLAT
 CONTRACTOR
 TITLE
AUG 21 1912 U.S.

FORMATION	TOP	BOTTOM	Steel Line Measurements	Water Found Depth	Oil Found Depth	Gas Found Depth
Native Coal	205	207				
Pittsburg Coal						
Little Dunkard	860	880				
Gas Sand	1095	1140				
First Salt	1315	1390				
Second Salt	1440	1470		1440	1440	
Maxon	1550	1613	1589			1589
Little Lime	1725	1745				
Pencil Cave	1745	1755				
Rig Lime	1755	1793				
Big Injun	1793	1910	1894 1900			1894 1900
Squaw	1913	1962				
Berea	1972	2007	1975 1995			1975 1975
Gantz						
Fifty Foot						
Thirty Foot						
Gordon Stray						
Gordon						
Fourth						
Fifth						
Hayard						
Total Depth	2011					

(Coal exhausted)
 2/10 Mercury thru 2" Aug 2-12
 2/10 Mercury thru 2" Aug 2-12
 4/10 Mercury thru 2" Aug 4-12
 984 MCF
 About tests taken after all connections

SIZE	Charged to Well		Put in Well		Pulled Out		Left in Well		Transferred Before Completing		Left at Well Not in Use		If more than two strings of casing are left in hole, give reasons for leaving additional strings
	Feet	In.	Feet	In.	Feet	In.	Feet	In.	Feet	In.	Feet	In.	
13" Csg.													
10" "	1051	5	956	-	956	-	-	-	82	3	969	-	Trans to Stock at well
8 1/2" "	1668	3	1571	0			1571	0	97	3	None	-	
6 5/8" "	2383	11	1824	11			1824	11	559	-	None	-	
5 3/16" "	2136	8	1939	-	1939	-	None	-	40	8	2116	-	Trans to Stock at well
2" Tbg.	2169	-	1934	6			1934	6	234	6	None	-	

PACKER RECORD

SIZE	KIND	Amount Anchor	Amount Above Anchor	REMARKS
5/8 x 5/4	B. Hole			
5/8 x 5 3/16	"			
5/8 x 2	A. Packer	No anchor	1924 1/2	5 3/16 casing pulled - Packer left in hole. A. Packer used as B. hole packer and set at bottom of 6" hole - No anchor used - No Packer

SHOOTING RECORD (If shot before or upon completion of well)

DATE	Quartz	Top of Shell	Bottom of Shell	Diameter	Sand	Test Before Shot			Test After Shot			Test After Shot No. Hours	By Whom Shot	
						Reading	Liquid	Opening	Reading	Liquid	Opening			

CEMENTING RECORD

Date Cemented..... Size Hole Cemented..... Size Casing Cemented.....
 Top Pittsburg Coal..... Top Cementing..... Amount Cement Used.....
 Bottom Pittsburg Coal..... Bottom Cementing..... Amount Sand Used.....
 Mr. _____ of _____ Coal Company on ground when coal was cemented
 Remarks: The above 5 3/16 Bottom Hole Packer left at Bottom of 6" Hole
 Signature of persons who cemented well

Approved by A. S. Shuman
 Foreman
 017-1934