

LATITUDE 39° 22' 30"

00, 04, 08
LONGITUDE

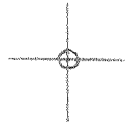

7'5 OGIS topo location

7.5' loc	<u>2.65S</u>	15' loc	<u>5.53S</u>
	<u>0.87W</u>	(calc.)	<u>0.87W</u>

Company _____

Farm _____

Elw. 1200' - 7.5' topo - Kla 3/5 hrs
Centerpoint wa

Quad SMITHBURG 7 1/2'

County DODDRIDGE

District GRANT

WELL LOCATION MAP

File No. 017-1924

HOPE NATURAL GAS COMPANY.

LOCATION FOR WELL No. 1530

Shirley DISTRICT
 Stella R. Darnell Farm, on waters of Big Flint
 Grant District, Doddridge County, West Virginia.
 Lease No. 4764 Acres 99 N. S. 8 E. W. 4
 Scale, one inch equals 80 Poles Sent to N.Y.C. 11-27-1909
 Location to be 400 feet from John F. Boyce farm line and
 400 feet from Silas B. Williams farm line.

017-1924

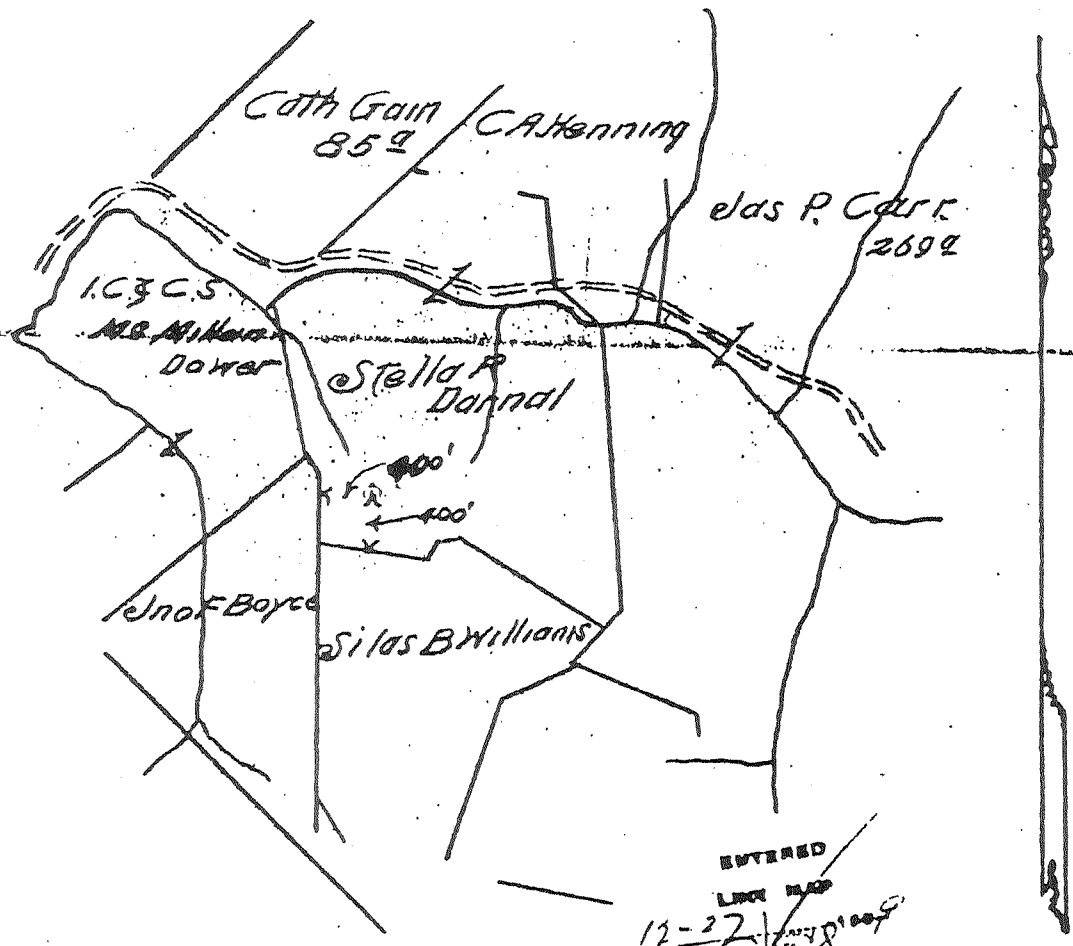

ENTERED
 LOG NO.
 12-27-1909
 1530
 ENTERED
 WELL BOOK
 TRAP RECORD
 WELL DOCKET
 WELL MAP 12-27-1909
 LOCATION BOOK

RESERVE Three hundred feet around the buildings

SPECIAL INSTRUCTIONS complete well on or before March 23, 1910

Location made 12-7-09 by R. Dent As per plat, except as noted. On field map.
 12-7-09 Returned to Pittsburgh DEC 7 - 1909 1

Location changed on account of

Authorized by Date 1 Signed

Hope Natural Gas Company
REPAIR RECORD
017-1924

Well No. 1530 ✓ Farm Name Stella Darnell ✓ District Salem ✓
Date First Work Done 8-11-50 ✓ Nature of Work Rigging UP ✓
Commenced: Cleaning Out 8-14-50 ✓ Completed: Cleaning Out 9-28-50 ✓
Drilling Deeper 9-29-50 ✓ Drilling Deeper 10-5-50 ✓
Abandoning _____ Abandoning _____

Size	Before Repairs		Pulled		Put in Well		After Repairs		Weight
	Tally	Steel Line	Tally	Steel Line	Tally	Steel Line	Tally	Steel Line	
0 1/2"	363 ✓		None ✓		None ✓		363 ✓		
5/8"	1172 ✓		None ✓		None ✓		1172 ✓		
"	2089 ✓		None ✓		None ✓		2089 ✓		
"	None ✓		None ✓		2103 ✓	2073 ✓	2103 ✓		Cemented (2073) 17 lb RT
"	2285 ✓		2285 ✓		None ✓		None ✓		

SHOOTING RECORD (Show if Open Shot or Tamped Shot)												
Date	Quarts	Top of Shell	Bottom of Shell	Diameter	Sand	TEST BEFORE SHOT			TEST AFTER SHOT			By Whom Shot
						Reading	Liquid	Opening	Reading	Liquid	Opening	
12-50	500#	2151	2231	4 1/2"	Injun	22/10 W	(17.64%)	3/4"	24/10 W	(36.5%)	1"	6 days Marietta Torpedo Co
26-50	20-qts	2237	2251	3"	Injun	24/10 W	(36.84%)	1"	35/10 W	(44.4%)	1"	24 hrs Marietta Torpedo Co

RECORD OF ANY DEEPER DRILLING					PACKER RECORD		
Formation	Top	Bottom	Oil at	Gas at	Size	Kind	Set At (Steel Line)
Fgh Coal 700)					5 1/2" x 10"	St. Casing Shoe	2073
Commenced drilling at depth of							Cemented
Drilled pocket to take cure of water)							
Below Injun sand)					Size 6-5/8 x 4"	Kind Hook-wall	
Began drilling	2254		None	None			
Comp. drilling		2294	"	"			
Note: when well was shot, it was found that gas pay							
bottom was at 2251, and this fact accounts for the							
second shot, as shown above.)							
Total Depth		2294					

VOLUME AND PRESSURE REPORT
BEFORE CLEANING OUT (Take Test When Ready to Clean Out)

Date of Test	Flow Meter or Open Flow	PITOT TUBE			CUBIC FEET	Sands Gas From	Time Blown
		Reading	Liquid Used	Opening			
15-50	See message 8-29-50 ✓		Gas drowned out				

AFTER CLEANING OUT
VOLUME TEST

Date of Test	Flow Meter or Open Flow	PITOT TUBE			CUBIC FEET	Sands Gas From	Time Blown
		Reading	Liquid Used	Opening			
0-5-50	FM	30/10	water ✓	1"	41.222	Injun	6 hrs

AFTER DRILLING DEEPER *Packet*
VOLUME TEST

Date of Test	Flow Meter or Open Flow	PITOT TUBE			CUBIC FEET	Sands Gas From	Time Blown
		Reading	Liquid Used	Opening			
0-5-50	FM	30/10	water ✓	1"	41.2 M. ✓	Injun	6 hrs

PRESSURE TEST

Date of Test	Opening	1 Min.	2 Min.	3 Min.	4 Min.	5 Min.	6 Min.	7 Min.	8 Min.	9 Min.	10 Min.	30 Min.	60 Min.	Hrs. Rept
		0/5/50	5/2" Casing	1 1/2	2	3	4	5	6	7	8	9	9	18
	" Tubing													

Remarks: Moved in Bucyrus spudder. Pulled 4 1/2" tubing. Cleaned out. Shot Injun pay, as above. Cleaned out again. Ran string 5 1/2" casing, cementing with 10 bags at 2073 SIM. Cleaned out and drilled pocket. Left hole in good condition, except that pay sand makes ll gels

ORIGINAL—For Land Dept. Only water in 16 hours. *[Signature]*
District Superintendent