

LATITUDE 39° 20' 00"



LONGITUDE 80° 42' 30"

7.5 OGIS topo location

7.5' loc	<u>0.70S</u>	15' loc	<u>0.70S</u>
	<u>0.18W</u>	(calc.)	<u>241W</u>

Company _____

Farm _____

Elev. 1230' - 7.5' topo - k/c 315h3

Centerpoint SW

Quad SMITHBURG 7 1/2

County DODDRIDGE

District GRANT

WELL LOCATION MAP

File No. 017-1918

HOPE NATURAL GAS COMPANY.

LOCATION FOR WELL No. 1226

Shirley DISTRICT

HOPE NATURAL GAS COMPANY
NEW YORK OFFICE

Joseph Simpson Farm, on waters of Israel's Fork
District, Daddridge County, West Virginia.

Case No. 10097, Acres. 23 N. 9 S. 9 E. W. 6

Scale: one inch equals 80 Poles Sent to N.Y.C. 4-7-1909

Location to be 400 feet south of A.J. Charter farm; 200 feet west of Mrs. Simpson farm; 200 feet east of J.P. Fox farm.

RECORDED
APR 21 1909
B.A.R. 4-21-09

4-21-09
C.H.R.

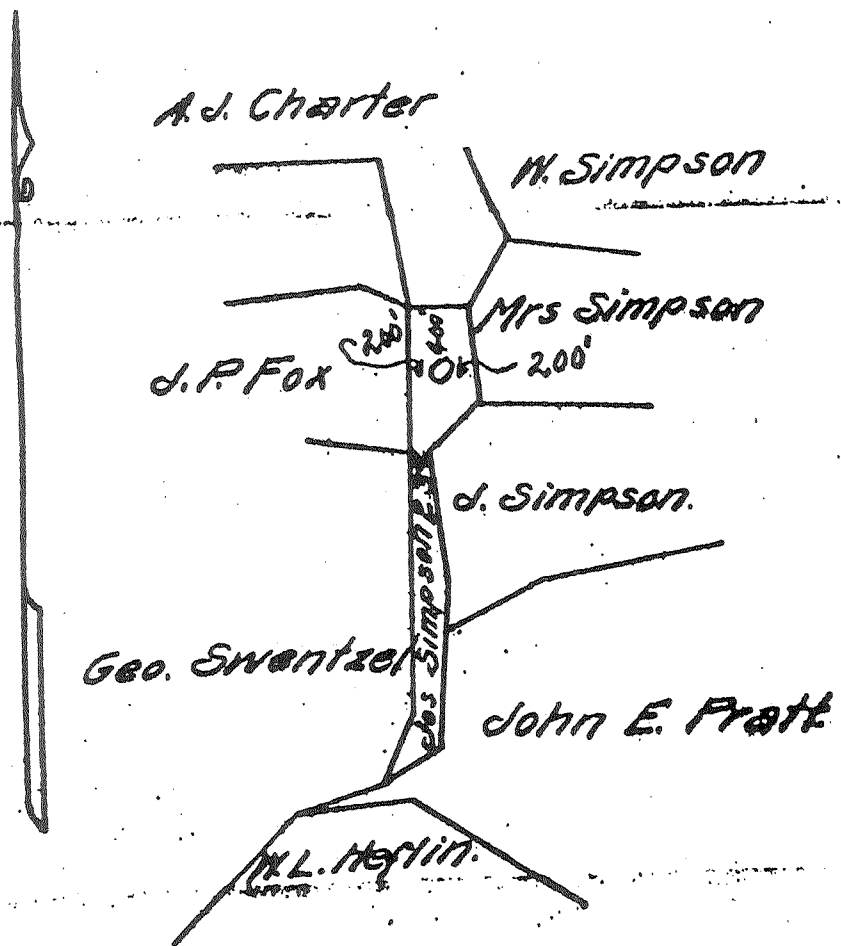

RESERVE None-

SPECIAL INSTRUCTIONS

Location made 4-16-04 by D.H. Bradley As per plat, except as noted. On field map

4-17-04 Returned to Pittsburgh 1

Location changed on account of

Authorized by Date 1 Signed

Record of Shiley Company
 Well No. 1226
 Located on Grant
 District Doddridge County West
 Location made 4-16-09 First work done May 3-1909
 Rig Commenced May 13-1909 Rig Completed May 22-1909
 Drilling Commenced June 18-1909 Drilling Completed May 23-1910
 Rig Contractor John Wells (Drilling Contractor) S. H. Young
 Drillers Herb Bonner - J. M. Curry
 Tool Dressers

FORMATION	TOP	BOTTOM	Steel Line Measurements	Water Found Depth	Gas or Oil Depth Found	REMARKS
Native Coal						
Pittsburgh Coal	720	724				
Little Dunkard	1174	1186				
Big Dunkard	1274	1294				
Gas Sand	1459	1510				
First Salt	1556	1620				
Second Salt	1660	1770		1666		Salt water
Maxon						
Little Lime	1938	1944	1950			
Pencil Cave	1944	1948	2050			
Big Lime	1950	2041	2105			
Big Injun	2050	2205	2162			2129-2132 Could not test.
Squaw	2228	2270	2170			2162-2170 Made 1/2 m. through
Berea			2228			2267-2268 " 7/8 " "
Gantz			2257			
Fifty Foot			2265			
Thirty Foot			2272			
Gordon Stray						
Gordon						
Fourth						
Fifth						
Bayard						
TOTAL DEPTH		2272				

ENTERED
 WELL BOOK
 LEASE RECORD
 LEASE DOCKET
 WALL MAP
 LINE MAP
 LOCATION BOOK
 CONTRACTORS' PLAN
 CONTRACTOR
 TITLE

No.	Charged to Well		Put in Well		Pulled Out		Left in Well		Transferred before Completing		Left at Well Not in Use		Size	Remarks
	Foot	In.	Foot	In.	Foot	In.	Foot	In.	Foot	In.	Foot	In.		
10	358	11	339				339				19	11		
24	1202	2	1180				1180				42	2		
62	7356	2	2054				2054				90	2		
52	764										76	4		

Note.—If 10" casing cemented, so state, and at what depth no
 If tubed note size and amount of tubing
 If more than two strings of casing are left in hole give reasons for leaving additional strings 10" left in hole because of no puller on 6 3/8" casing. Short string that best to do so.

Steel line measurements should be made of Top and Bottom of Pittsburgh Coal and all the principal sands.
 Under Remarks note if any of principal sands are not found and if any peculiarities in sands, as looser or harder than ordinary, etc.
 If any coal other than native or Pittsburgh be found, give steel line measurements of Top and Bottom and nature of coal.
 Note if water found is fresh or salt.

Approved by J. A. Dodge