

1701917 P

WW-7
5-02



West Virginia Department of Environmental Protection
Office of Oil and Gas
WELL LOCATION FORM: GPS

API: 47-017-01917 WELL NO.: DTI 01115
FARM NAME: C. M. TATE
RESPONSIBLE PARTY NAME: CNX GAS COMPANY LLC
COUNTY: DODDRIDGE DISTRICT: WEST UNION
QUADRANGLE: WEST UNION 7.5'
SURFACE OWNER: KEY OIL COMPANY, ET. AL. 22 GARTON PLAZA, WESTON, WV 26452
ROYALTY OWNER: JANET DICKERSON, ET. AL.
UTM GPS NORTHING: 4,349,490.04 METERS
UTM GPS EASTING: 521,464.47 METERS GPS ELEVATION: 379.56 METERS 1245.28 FT

The Responsible Party named above has chosen to submit GPS coordinates in lieu of preparing a new well location plat for a plugging permit on the above well. The Office of Oil and Gas will not accept GPS coordinates that do not meet the following requirements:

- 1. Datum: NAD 1983, Zone: 17 Coordinate Units: meters Altitude: Height above mean sea level (MSL) - meters
- 2. Accuracy to Datum - 3.05 meters
- 3. Data Collection Method: Survey Grade GPS : Post Processed Differential Real-Time Differential
Mapping Grade GPS : Post Processed Differential Real-Time Differential

I the undersigned hereby state this data is correct to the best of my knowledge and belief and shows all the information required by law and the regulation issued and prescribed by the Office of Oil and Gas.

Signature J. Michael Evans
J. Michael Evans, PS

Title WV Professional Surveyor #900

Date 05/22/13

Received
MAY 18 2013
Office of Oil and Gas
WV Dept. of Environmental Protection
Received
MAY 22 2013
Office of Oil and Gas
WV Dept. of Environmental Protection

CNX USE: NAD 27 WV NORTH SPC: 01115 = 291,815.47' 1,645,880.07' ELEV. = 1,245.28'

1701917 P

DELORME

XMap® 7

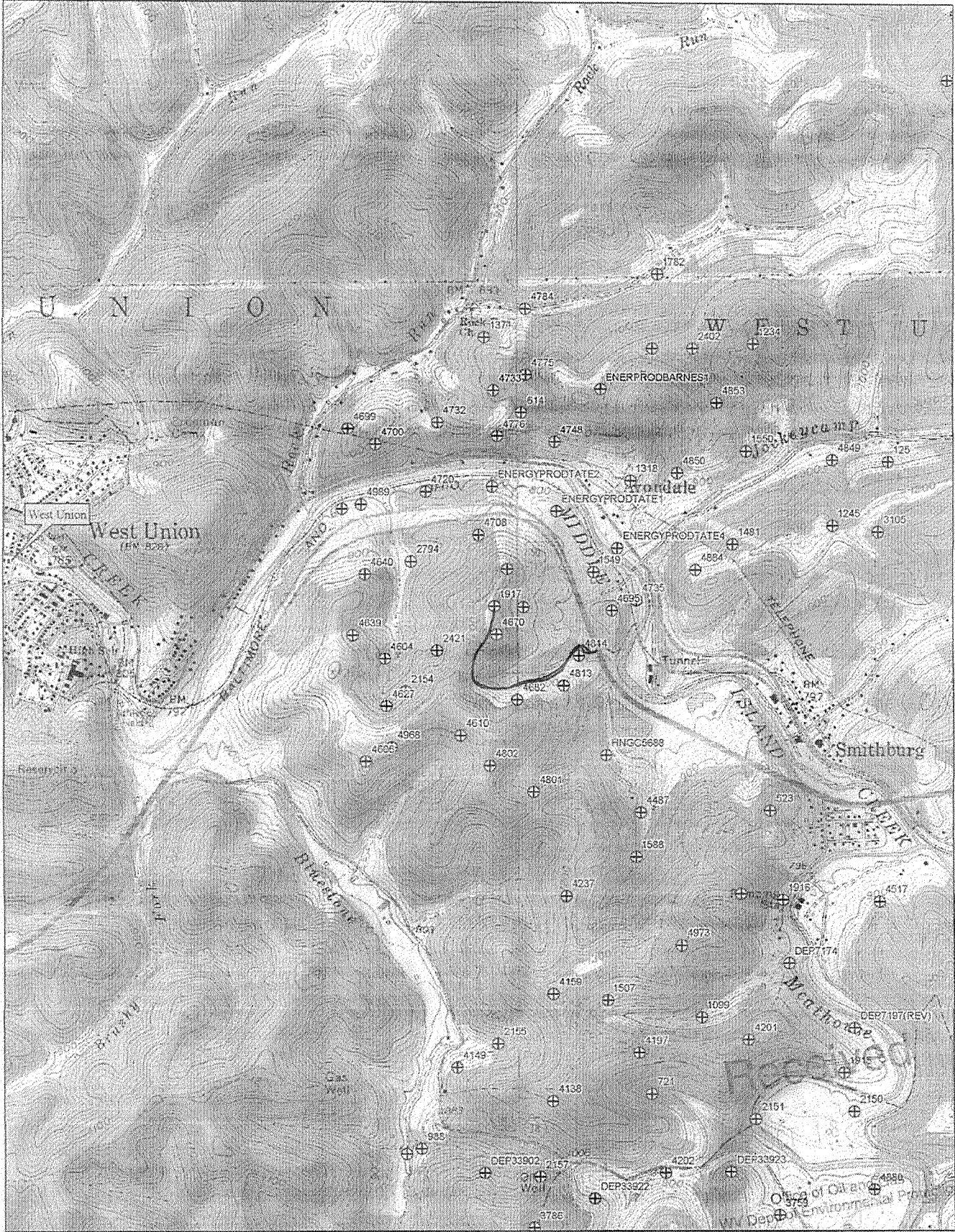

Data use subject to license.
 © DeLorme. XMap® 7.
 www.delorme.com

North Arrow
 MN (N.A.T.M.)

Scale 1 : 24,000
 1" = 2,000.0 ft Data Zoom 13-0

LATITUDE 39° 20' 00"

80° 45' 00"

LONGITUDE



7.5 OGIS topo location

7.5' loc 2.795
0.09W

15' loc 2.795
(calc.) 0.09W

Company 384

Farm CM Take (115)

Elev. 1130' - 7.5' topo - k1a31sk3
↓ 15' SE

Quad WEST UNION 7 1/2

County DODDRIDGE

District WEST UNION

WELL LOCATION MAP

File No. 017-1917

12-2
12-12-08

LOCATION FOR WELL No. 1115
DISTRICT.

On Farm, on waters of Middle Island
District, County, West Virginia

Lease No. 4404 Acres 102 Range: N. S. 11 E. W. 8

Scale 1" = 80 feet Made 19.....

250' from C.F. Longacre line
300' .. Northery cor. of 6th tract X 95th trac.
of same farm.

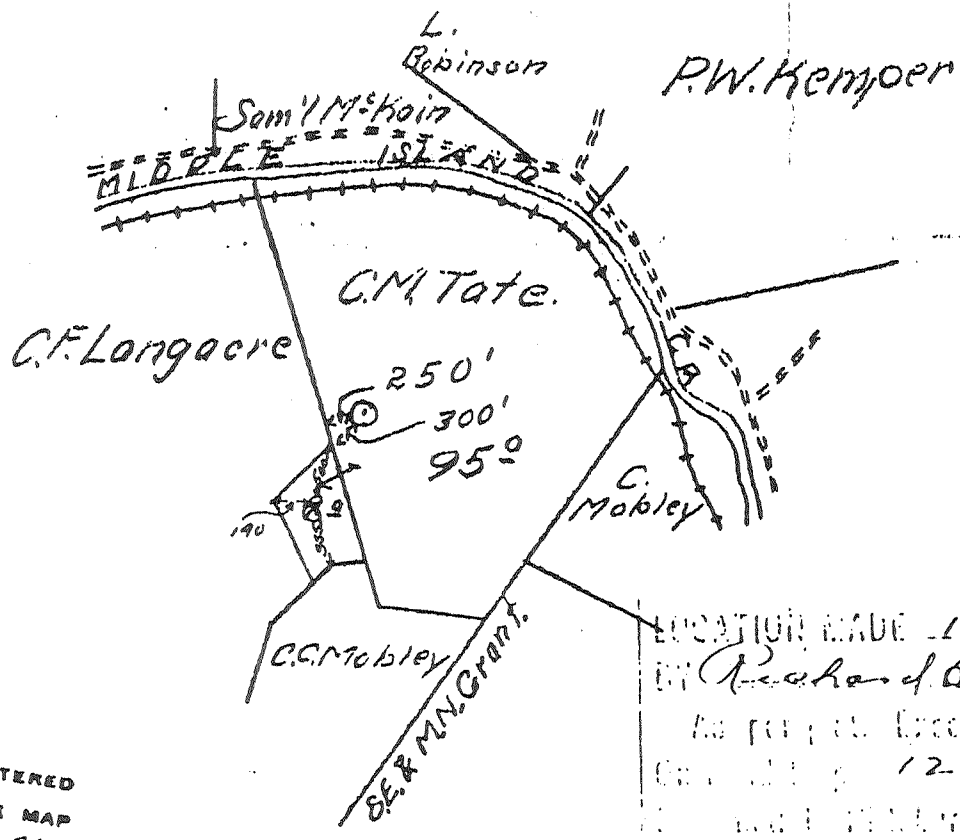

LOCATION MADE 12-9-1908
 BY Richard Skutt
 No part of except as noted
 Dec 11 1908
 DEC 10 1908

ENTERED
 LINE MAP
 Dec 24 1908
 BY C.A.R.

017-1917

RESERVE:
 SPECIAL INSTRUCTIONS:

WELL RECORD.

Well No. 1115 Farm 102 Acres
 District 10 County Wva State
 Rig Commenced Jan 18 1907 Contractor Hope Plat. Gas Co.
 Rig Completed Jan 21 1907
 Drilling Commenced March 9 1909 Contractor J. N. Williams
 Drilling Completed April 11 1901

ROCK FORMATION.	TOP	BOTTOM.	REMARKS.
Little Coal	1015	-	<p>49109</p> <p>22-09</p> <p>1st Day, Mr. D. 66-24</p> <p>Drilled by J. N. Williams</p> <p>Tool Pressure, New Kielder, Glasson Company.</p> <p>1 3/4" Gauge 8 1/4 x 6 7/8" set at 2053 ft.</p>
Pullong Coal	672	-	
Little Sandstone	1015	1045	
Big Sandstone	1110	1140	
Blue Sandstone	1230	1260	
Thin Salt Sand	1355	1395	
Green Sandstone	1530	1570	
Marl	1967	2007	
Blue Sandstone	2007	2013	
Big Injunctive Sand	2013	2075	
Total Depth	2171	-	
	2100	-	

No more casing required
 10" casing required to 17' depth in this well.

CASING RECORD.

Size.	Charged to Well.		Put in Well.		Pulled Out.		Left in Well.		Transferred Before Completion.		Left at Well, Not in Use.	
	Feet.	In.	Feet.	In.	Feet.	In.	Feet.	In.	Feet.	In.	Feet.	In.
10"	1176	4	1120	-	-	-	1120	-	-	-	52	8
8 1/4"	11	-	0	-	-	-	-	-	-	-	1713	2
6 3/4"	2425	4	2053	-	-	-	2053	-	-	-	202	4

Approved by _____ Supt.
 Production First 24 hours } _____

PROOF—Sum of Three right hand columns equals First or "Charged to Well."
 Use as many sheets as necessary to make a complete record.
 In making out this record please use copying ink or an indelible pencil.