

WW-7
8-30-06



West Virginia Department of Environmental Protection
Office of Oil and Gas
WELL LOCATION FORM: GPS

API: 47-017-01908 WELL NO.: Martin

FARM NAME: McDaniel

RESPONSIBLE PARTY NAME: Erika Whetstone

COUNTY: Doddridge DISTRICT: McClellan

QUADRANGLE: Folsom

SURFACE OWNER: Howard R and Judy D McDaniel

ROYALTY OWNER: _____

UTM GPS NORTHING: 4363248.62

UTM GPS EASTING: 537623.76 GPS ELEVATION: 1,019

The Responsible Party named above has chosen to submit GPS coordinates in lieu of preparing a new well location plat for a plugging permit or assigned API number on the above well. The Office of Oil and Gas will not accept GPS coordinates that do not meet the following requirements:

1. Datum: NAD 1983, Zone: 17 North, Coordinate Units: meters, Altitude: height above mean sea level (MSL) – meters.
2. Accuracy to Datum – 3.05 meters
3. Data Collection Method:

Survey grade GPS _____: Post Processed Differential _____

Real-Time Differential _____

Mapping Grade GPS X: Post Processed Differential _____

Real-Time Differential X

RECEIVED
Office of Oil and Gas

MAY 29 2019

WV Department of
Environmental Protection

4. Letter size copy of the topography map showing the well location.

I the undersigned, hereby certify this data is correct to the best of my knowledge and belief and shows all the information required by law and the regulations issued and prescribed by the Office of Oil and Gas.

Erika Whetstone
Signature

Permitting Manager
Title

5/17/2019
Date

47-017-01902A

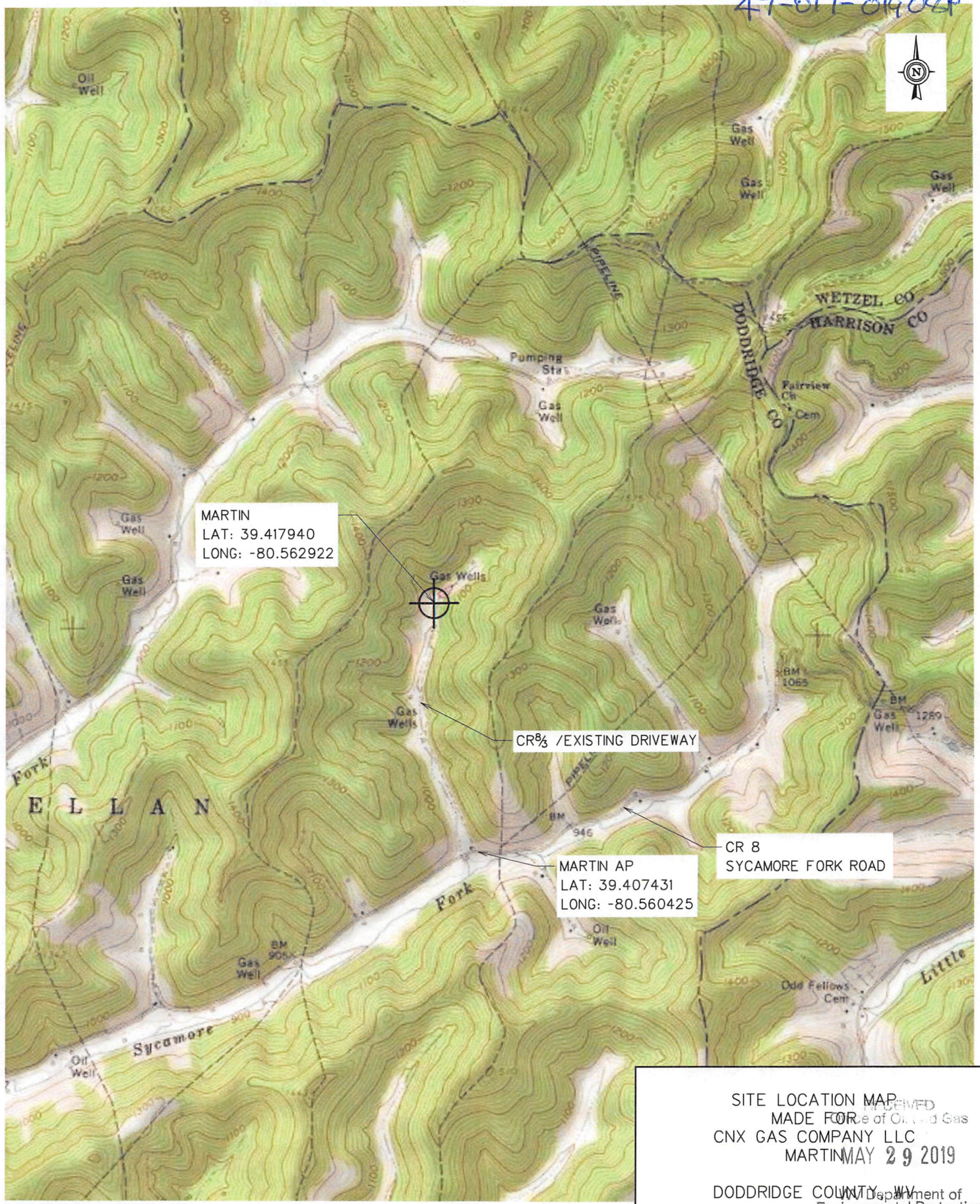

MARTIN
LAT: 39.417940
LONG: -80.562922

CR 8 1/2 / EXISTING DRIVEWAY

MARTIN AP
LAT: 39.407431
LONG: -80.560425

CR 8
SYCAMORE FORK ROAD

REFERENCES: IMAGERY PROVIDED BY USGS:
FOLSOM, WV QUADRANGLE;
STATE 7.5 MINUTE SERIES

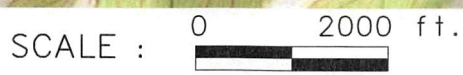

SITE LOCATION MAP
MADE FOR RECEIVED
CNX GAS COMPANY LLC
MARTIN MAY 29 2019
DODDRIDGE COUNTY, WV Department of
Environmental Protection
PREPARED BY
STAHL SHEAFFER ENGINEERING
6000 TOWN CENTER BLVD., SUITE 215
CANONSBURG, PA. 15317
PHONE: 724.960.1111 FAX: 724.960.1162