

11/7/73

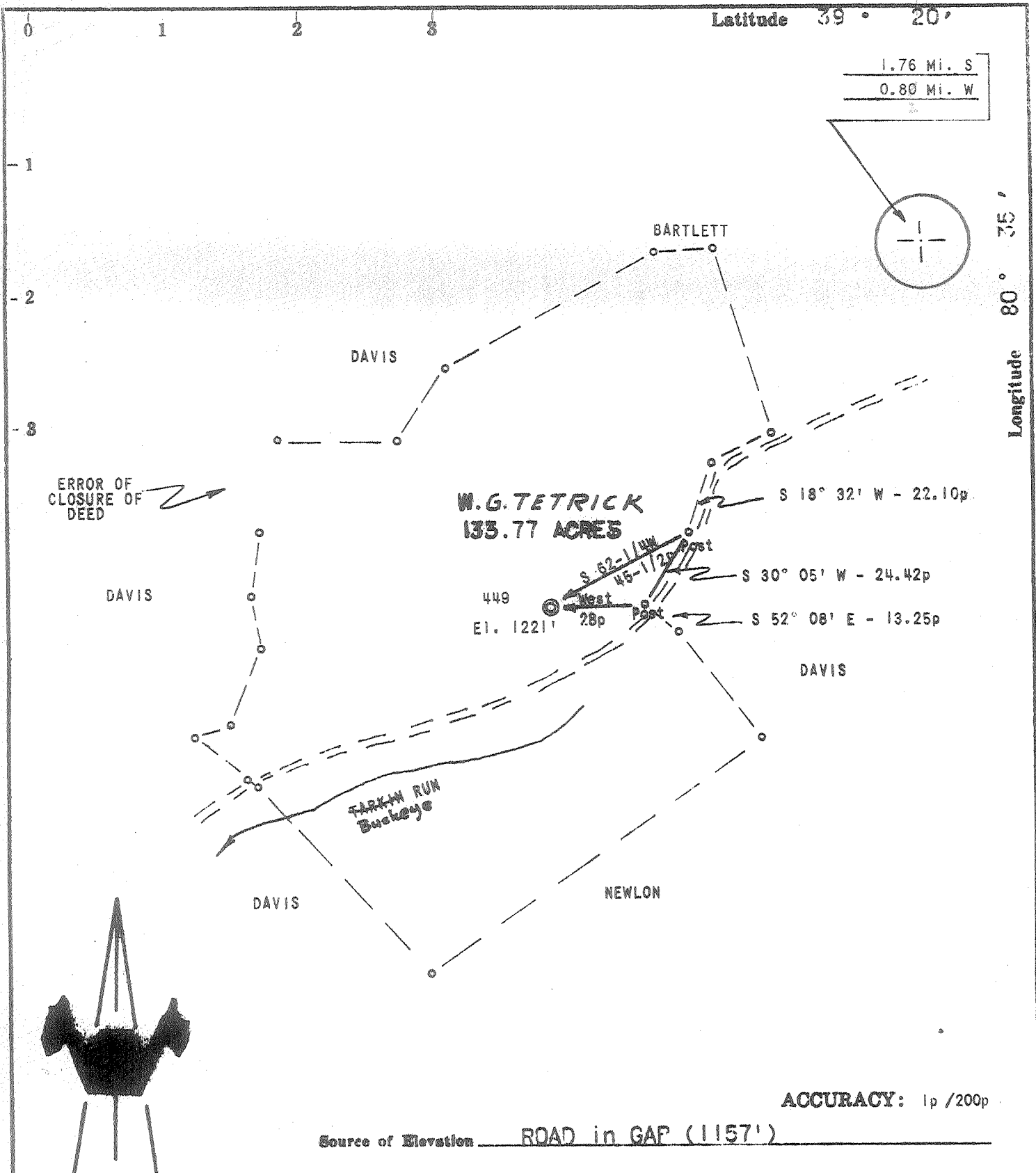

- New Location
- Drill Deeper
- Abandonment
- Fracture
- Redrill

I, the undersigned, hereby certify that this map is correct to the best of my knowledge and belief and shows all the information required by paragraph 8 of the rules and regulations of the oil and gas section of the mining laws of West Virginia.

Chet Waterman

Company APOLLO PETROLEUM CORP.

Address SPENCER, W. VA.

Farm W.G. TETRICK

Tract _____ Acres 133.77 Lease No. _____

Well (Farm) No. 449 Serial No. _____

Elevation (Spirit Level) 1221'

Quadrangle CENTERPOINT *SC*

County DODDRIDGE District GRANT

Engineer CHET WATERMAN

Engineer's Registration No. 3788

File No. 73083-224 Drawing No. _____

Date 6/1/73 Scale 1" = 40p

STATE OF WEST VIRGINIA
DEPARTMENT OF MINES
OIL AND GAS DIVISION
CHARLESTON

WELL LOCATION MAP

FILE NO. Dodd-1733

+ Denotes location of well on United States Topographic Maps, scale 1 to 62,500, latitude and longitude lines being represented by border lines as shown.

- Denotes one inch spaces on border line of original tracing.

47 017



RECEIVED
JUL 19 1973

STATE OF WEST VIRGINIA
DEPARTMENT OF MINES

OIL & GAS
DEPT. OF MINES

Oil and Gas Division

WELL RECORD

Quadrangle Centerpoint
Permit No. DODD-1733

Rotary Oil
Cable _____ Gas
Recycling _____ Comb. _____
Water Flood _____ Storage _____
Disposal _____ (Kind)

Company APOLLO PETROLEUM CORPORATION
Address Box 51, Spencer, W. Va.
Farm W. G. Tetrick Acres 133
Location (waters) Buckeye Run
Well No. 449 Elev. 1,221'
District Grant County Doddridge
The surface of tract is owned in fee by _____

Address _____
Mineral rights are owned by Willis G. Tetrick
P.O. Box 267 Clarksburg, W. Va.
Drilling Commenced 6/10/73
Drilling Completed 6/16/73
Initial open flow _____ cu. ft. _____ bbls.
Final production 1,750M cu. ft. per day _____ bbls.
Well open 12 hrs. before test 600 RP.
Well treatment details: _____

Casing and Tubing	Used in Drilling	Left in Well	Cement fill up Cu. ft. (Sks.)
Size 20-16			
Cond. 13-10"			
9 5/8			
8 5/8	790'	790'	200 Sks.
7			
5 1/2			
4 1/2	2390'	2390'	125 Sks.
3			
2			
Liners Used	6-3/4" Hole		

Attach copy of cementing record.
Well perforations 2339 - 2356' - 13 holes.
Water Frac - 500 Bbls. Water, 1000 Gals. Acid, 16,000# 20/40 Sand.

Coal was encountered at _____ Feet _____ Inches
Fresh water _____ Feet _____ Salt Water _____ Feet _____
Producing Sand Injun Depth 2290'

Formation	Color	Hard or Soft	Top Feet	Bottom Feet	Oil, Gas or Water	* Remarks
Surface			0	10		Cemented to surface
Rock & Sand			10	95		
Hard Sand			95	160		Logged by Basin
Sandy Shale			160	460		
Red Shale			460	910		
Sand & Shale			910	1475		
Salt Sand			1475	2200		
Little Lime			- 2200	2218		
Pencil Cave			2218	2238		
Big Lime			- 2238	2290		
<u>Injun</u>			2290	2385		
Shale			2385	2390		T. D.

(over)

* Indicates Electric Log tops in the remarks section.



STATE OF WEST VIRGINIA
DEPARTMENT OF MINES

RECEIVED
JUN 7 1973
OIL & GAS DIVISION
DEPT. OF MINES

Oil and Gas Division

OIL AND GAS WELL PERMIT APPLICATION

TO THE DEPARTMENT OF MINES,
Charleston, W. Va.

DATE June 7, 1973
Company Apollo Petroleum Corporation
Address Box 51, Spencer, W. Va.
Farm W. G. Tetrick Acres 133.77
Location (waters) Buckeye Run Middle Island Cr.
Well No. 449 Elevation 1221'
District Grant County Doddridge
Quadrangle Centerpoint

Surface Owner _____
Address _____
Mineral Owner Willis G. Tetrick
Address P.O. Box 267, Clarksburg, W. Va.
Coal Owner _____
Address _____
Coal Operator _____
Address _____

INSPECTOR TO BE NOTIFIED Mr. Wm. Bessie
Box 1857 PH: Fairmont
Colfax 363-9105
WV. 26544

THIS PERMIT MUST BE POSTED AT THE WELL SITE
All provisions being in accordance with Chapter 22,
of the W. Va. Code, the location is hereby approved
for Drilling. This permit shall expire if
operations have not commenced by 10-7-73.
Deputy Director
Deputy Director - Oil & Gas Division

GENTLEMEN:

The undersigned well operator is entitled ^{Assignment} to drill upon the above named farm or tract of land for oil and gas, having fee title thereto, (or as the case may be) under grant or lease dated March 29 19 73 by J. H. McCoy, et ux made to Apollo Petroleum Corp. and recorded on the 8th day of May 19 73, in Doddridge County, Book 97 Page 162

NEW WELL _____ DRILL DEEPER _____ REDRILL _____ FRACTURE OR STIMULATE
_____ OIL AND GAS WELL ORIGINALLY DRILLED BEFORE JUNE 5, 1969.

The enclosed plat was prepared by a registered engineer or licensed land surveyor and all coal owners and/or operators have been notified as of the above date.

The above named coal owners and/or operator are hereby notified that any objection they wish to make, or are required to make by Section 3 of the Code, must be received by, or filed with the Department of Mines within ten (10) days. *

Copies of this notice and the enclosed plat were mailed by registered mail, or delivered to the above named coal operators or coal owners at their above shown respective address _____ day _____ before, or on the same day with the mailing or delivery of this copy to the Department of Mines at Charleston, West Virginia.

Very truly yours, **APOLLO PETROLEUM CORPORATION**
(Sign Name) Tom D. Boydale
Well Operator
Box 51
Street
Spencer
City or Town
West Virginia
State

Address
of
Well Operator

*SECTION 3 If no objections are filed or found by the Department of mines, within said period of ten days from the receipt of notice and plat by the department of mines, to said proposed location, the department shall forthwith issue to the well operator a permit reciting the filing of such plat, that no objections have been made by the coal operators or found thereto by the department and that the same is approved and the well operator authorized to proceed.

BLANKET BOND

Dodd-1733 PERMIT NUMBER 47017

THIS IS AN ESTIMATE ONLY
ACTUAL INFORMATION WILL BE SUBMITTED ON OG-10 UPON COMPLETION

PROPOSED WORK ORDER TO DRILL _____ DEEPEN _____ FRACTURE-STIMULATE _____
 DRILLING CONTRACTOR: (If Known) RESPONSIBLE AGENT:
 NAME F. W. A. Drilling Co. NAME R. L. Mann
 ADDRESS Elkview, W. Va. ADDRESS Box 51, Spencer, W. Va.
 TELEPHONE 965-5201 TELEPHONE 927-1148
 ESTIMATED DEPTH OF COMPLETED WELL: 2,400 Ft. ROTARY CABLE TOOLS _____
 PROPOSED GEOLOGICAL FORMATION: Big Injun
 TYPE OF WELL: OIL _____ GAS COMB. _____ STORAGE _____ DISPOSAL _____
 RECYCLING _____ WATER FLOOD _____ OTHER _____

TENTATIVE CASING PROGRAM:

CASING AND TUBING SIZE	USED FOR DRILLING	LEFT IN WELL	CEMENT FILL UP OR SACKS - CUBIC FT.
20 - 16			
13 - 10	30 Ft.	30 Ft.	To surface
9 - 5/8			700'
8 - 5/8	700 Ft.	700 Ft.	400' Fill up
7			
5 1/2			
4 1/2	2,400 Ft.	2,400 Ft.	
3			Perf. Top
2			Perf. Bottom
Liners			Perf. Top
			Perf. Bottom

APPROXIMATE FRESH WATER DEPTHS _____ FEET SALT WATER 1,200 FEET
 APPROXIMATE COAL DEPTHS _____
 IS COAL BEING MINED IN THE AREA? No BY WHOM? _____

TO DRILL:

SUBMIT FIVE (5) COPIES OF OG - 1, \$100.00 PERMIT FEE, PERFORMANCE BOND AND PERMANENT COPY OF PLAT.

TO DRILL DEEPER OR REDRILL:

SUBMIT FIVE (5) COPIES OF OG - 1, SHOWING ORIGINAL PERMIT NUMBER AND PERFORMANCE BOND. ON WELLS DRILLED PRIOR TO 1929, A PERMANENT COPY OF THE PLAT AND THE ORIGINAL WELL RECORD MUST ALSO BE SUBMITTED.

TO FRACTURE - STIMULATE:

OIL AND/OR GAS WELL ORIGINALLY DRILLED BEFORE JUNE 5, 1929, FIVE (5) COPIES OG - 1, PERFORMANCE BOND, PERMANENT PLAT AND ORIGINAL WELL RECORD.

OIL AND/OR GAS WELL ORIGINALLY DRILLED ON AND/OR AFTER JUNE 5, 1929, FIVE COPIES OG - 1, SHOWING ORIGINAL PERMIT NUMBER, AND PERFORMANCE BOND.

Required forms must be filed within ninety (90) days of completion for bond release. Inspector to be notified twenty-four (24) hours in advance.

The following waiver must be completed by the coal operator if the permit is to be issued within ten days of receipt thereof.

WAIVER: I the undersigned, Agent for _____ Coal Company, Owner or Operator of the coal under this lease have examined and place on our mine maps this proposed well location.

We the _____ Coal Company have no objections to said well being drilled at this location, providing operator has complied with all rules and regulations in Articles 4, 5, and 7, Chapter 22 of the West Virginia Code.

 For Coal Company

 Official Title