

ACCURACY: 1P / 200P

Source of Elevation ROAD INTERSECTION (859')

- New Location
- Drill Deeper
- Abandonment
- Fracture
- Redrill

I, the undersigned, hereby certify that this map is correct to the best of my knowledge and belief and shows all the information required by paragraph 6 of the rules and regulations of the oil and gas section of the mining laws of West Virginia.

Chet Waterman

Company PENN RESOURCES, INC. *Willard E. Ferrell*
 Address PHILADELPHIA, Pa.
 Farm J. L. ROBERTS
 Tract Acres 45 3/8 Lease No. _____
 Well (Farm) No. 1 Serial No. _____
 Elevation (Spirit Level) 1005'
 Quadrangle CENTERPOINT *C*
 County DODDRIDGE District McCLELLAN
 Engineer CHET WATERMAN
 Engineer's Registration No. 3788
 File No. 71003-16 Drawing No. _____
 Date 1/16/71 Scale 1" = 30P

STATE OF WEST VIRGINIA
 DEPARTMENT OF MINES
 OIL AND GAS DIVISION
 CHARLESTON

WELL LOCATION MAP

FILE NO. DOD-1615

Cancelled 11/22/71

+ Denotes location of well on United States Topographic Maps, scale 1 to 62,500, latitude and longitude lines being represented by border lines as shown.

— Denotes one inch spaces on border line of original tracing.

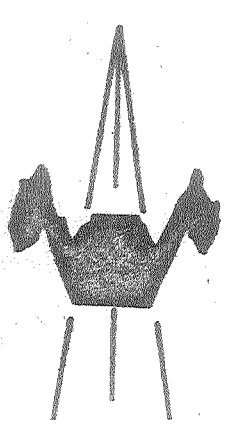
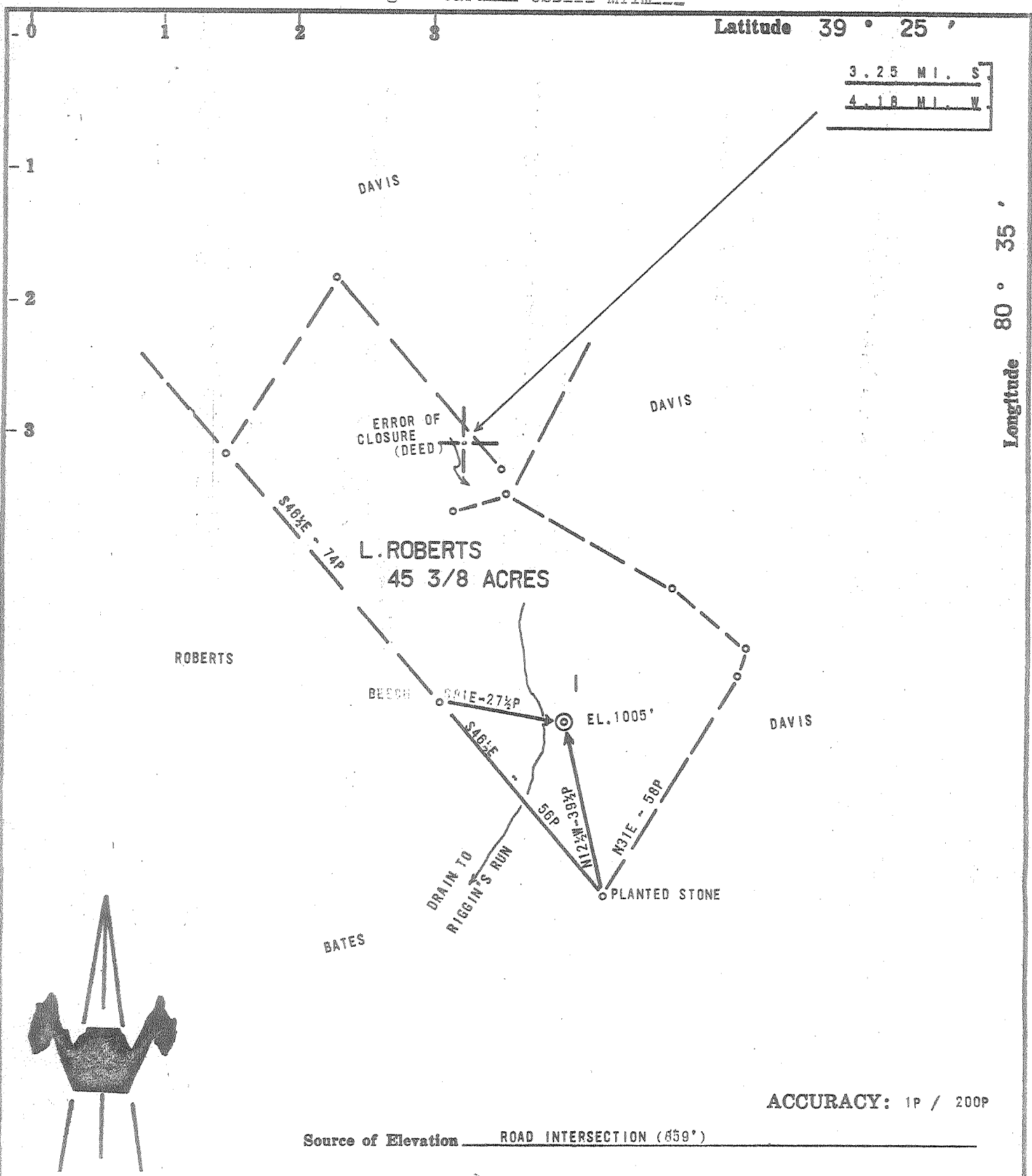

ACCURACY: 1P / 200P

Source of Elevation ROAD INTERSECTION (859')

I, the undersigned, hereby certify that this map is correct to the best of my knowledge and belief and shows all the information required by paragraph 6 of the rules and regulations of the oil and gas section of the mining laws of West Virginia.

- New Location
- Drill Deeper
- Abandonment
- Fracture
- Redrill

Chet Waterman

Company	<u>PENN RESOURCES, INC.</u>	<i>Willard E. Ferrell</i>
Address	<u>PHILADELPHIA, Pa.</u>	
Farm	<u>J. L. ROBERTS</u>	
Tract	<u>Acres 45 3/8</u>	Lease No. _____
Well (Farm) No.	<u>1</u>	Serial No. _____
Elevation (Spirit Level)	<u>1005'</u>	
Quadrangle	<u>CENTERPOINT C</u>	
County	<u>DODDRIDGE</u>	District <u>McCLELLAN</u>
Engineer	<u>CHET WATERMAN</u>	
Engineer's Registration No.	<u>3788</u>	
File No.	<u>71003-16</u>	Drawing No. _____
Date	<u>1/16/71</u>	Scale <u>1" = 30P</u>

STATE OF WEST VIRGINIA
DEPARTMENT OF MINES
OIL AND GAS DIVISION
CHARLESTON

WELL LOCATION MAP
FILE NO. DOD-1615

+ Denotes location of well on United States Topographic Maps, scale 1 to 62,500, latitude and longitude lines being represented by border lines as shown.

— Denotes one inch spaces on border line of original tracing.

D