

~~Note: Lease to James F. Scott covers that portion of the Prunty tract SE of road - No acreage given~~

Minimum Error of Closure 1' in 200'

Source of Elevation Records of Pennzoil Company

I, the undersigned, hereby certify that this map is correct to the best of my knowledge and belief and shows all the information required by paragraph 8 of the rules and regulations of the oil and gas section of the mining laws of West Virginia.

Signed: [Signature]
Squares: N S E W

- Fracture
- New Location
- Drill Deeper
- Abandonment

Map No. _____

Company SCOTT ENTERPRISES, Inc. (James F. Scott)
 Address Salom, W. Va.
 Farm U. G. Prunty
 Tract 13 of 67± Acres 13± Lease No. _____
 Well (Farm) No. One Serial No. _____
 Elevation (Spirit Level) 937
 Quadrangle Centerpoint NC
 County Doddridge District McClallen
 Engineer [Signature]
 Engineer's Registration No. 1227
 File No. _____ Drawing No. _____
 Date June 28, 1969 Scale 1" = 800'

STATE OF WEST VIRGINIA
DEPARTMENT OF MINES
OIL AND GAS DIVISION
CHARLESTON

WELL LOCATION MAP
FILE NO. DOD-1570

† Denotes location of well on United States Topographic Maps, scale 1 to 62,500, latitude and longitude lines being represented by border lines as shown.

- Denotes one inch spaces on border line of original tracing.

LATITUDE 39° 30'

LONGITUDE 80° 55'

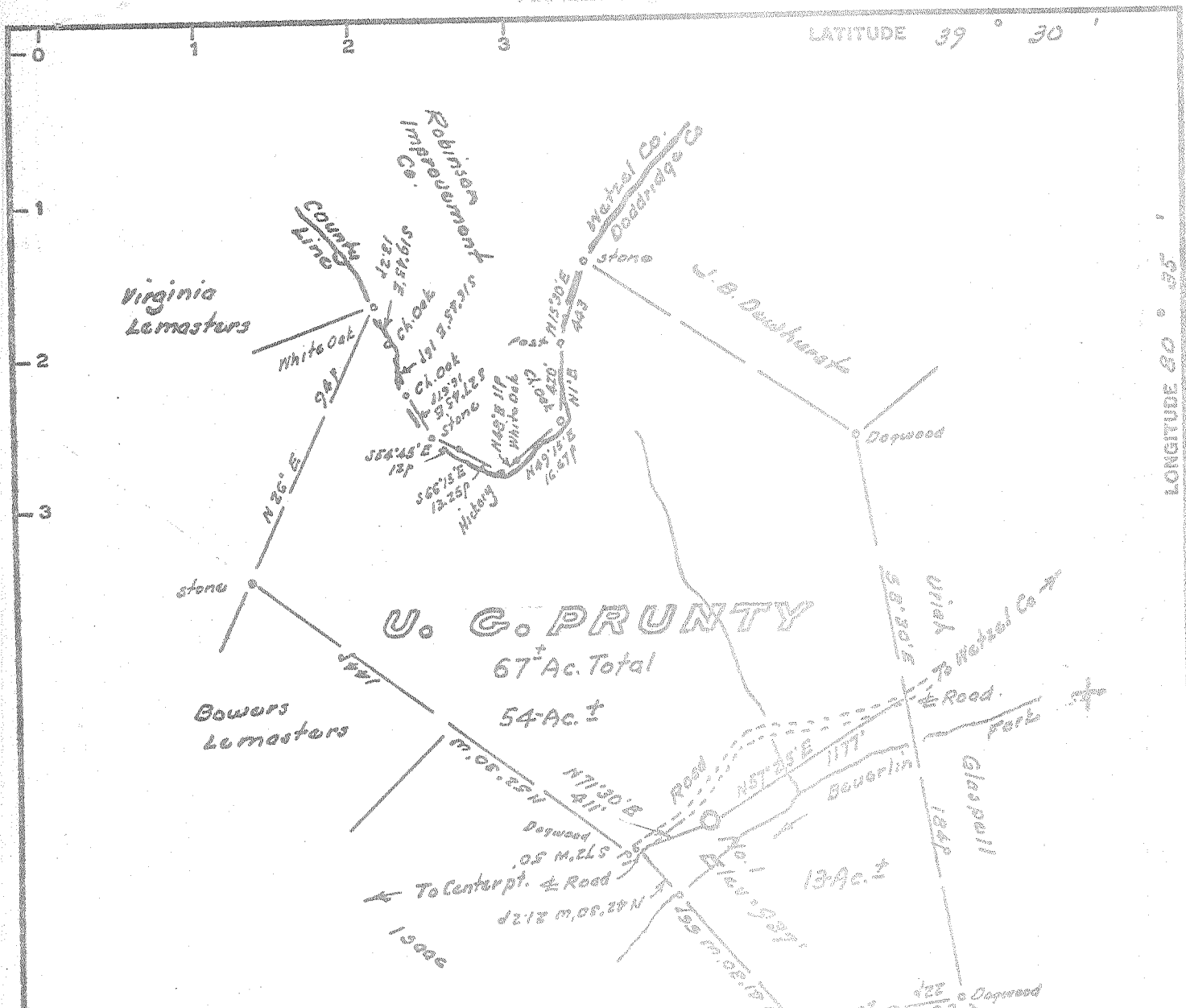

Minimum Error of Closure 1' in 200'

Source of Elevation Records of Pennzoil Company

I, the undersigned, hereby certify that this map is correct to the best of my knowledge and belief and shows all the information required by paragraph 6 of the rules and regulations of the oil and gas section of the mining laws of West Virginia.

Signed: [Signature]
Squares: N S E W

Map No.

- Fracture.....
- New Location.....
- Drill Deeper.....
- Abandonment.....

Company SCOTT ENTERPRISES, Inc.
 (James F. Scott)
 Address Salmon, W. Va.
 Farm U. G. Prunty
 Tract 13 of 67 Acres 54 Lease No. _____
 Well (Farm) No. One Serial No. _____
 Elevation (Spirit Level) 937
 Quadrangle Centerpoint NC
 County Doddridge District McClellan
 Engineer [Signature]
 Engineer's Registration No. 1227
 File No. _____ Drawing No. _____
 Date June 28, 1969 Scale 1" = 800'

STATE OF WEST VIRGINIA
 DEPARTMENT OF MINES
 OIL AND GAS DIVISION
 CHARLESTON

WELL LOCATION MAP
 FILE NO. 202-1570-CARC.

10-6-69
 † Denotes location of well on United States Topographic Maps, scale 1 to 62,500, latitude and longitude lines being represented by border lines as shown.

- Denotes one inch spaces on border line of original tracing.