

RECEIVED  
Office of Oil and Gas

WW-7  
8-30-06

MAR 10 2015



WV Department of  
Environmental Protection

West Virginia Department of Environmental Protection  
Office of Oil and Gas  
**WELL LOCATION FORM: GPS**

API: 47-017-01398 WELL NO.: WV 129941 (Lewis Maxwell B-25)  
FARM NAME: Lewis Maxwell  
RESPONSIBLE PARTY NAME: EQT Production Company  
COUNTY: Doddridge DISTRICT: West Union  
QUADRANGLE: West Union 7.5'  
SURFACE OWNER: Ruth Davies Pierce C/O Tom Davies  
ROYALTY OWNER: Mary Maxine Welch, et al.  
UTM GPS NORTHING: 4346896  
UTM GPS EASTING: 518520 GPS ELEVATION: 377 m (1238 ft)

The Responsible Party named above has chosen to submit GPS coordinates in lieu of preparing a new well location plat for a plugging permit or assigned API number on the above well. The Office of Oil and Gas will not accept GPS coordinates that do not meet the following requirements:

- 1. Datum: NAD 1983. Zone: 17 North. Coordinate Units: meters. Altitude: height above mean sea level (MSL) – meters.
- 2. Accuracy to Datum – 3.05 meters
- 3. Data Collection Method:  
Survey grade GPS  : Post Processed Differential   
Real-Time Differential   
Mapping Grade GPS  : Post Processed Differential   
Real-Time Differential
- 4. Letter size copy of the topography map showing the well location.

I the undersigned, hereby certify this data is correct to the best of my knowledge and belief and shows all the information required by law and the regulations issued and prescribed by the Office of Oil and Gas.

Signature

PS # 2180  
Title

1/20/15  
Date

Topo Quad: West Union 7.5' Scale: 1" = 2000'  
 County: Doddridge Date: January 20, 2015  
 District: West Union Project No: 67-30-00-08

47-017-01398 WV 129941 (Lewis Maxwell B-25)

Topo

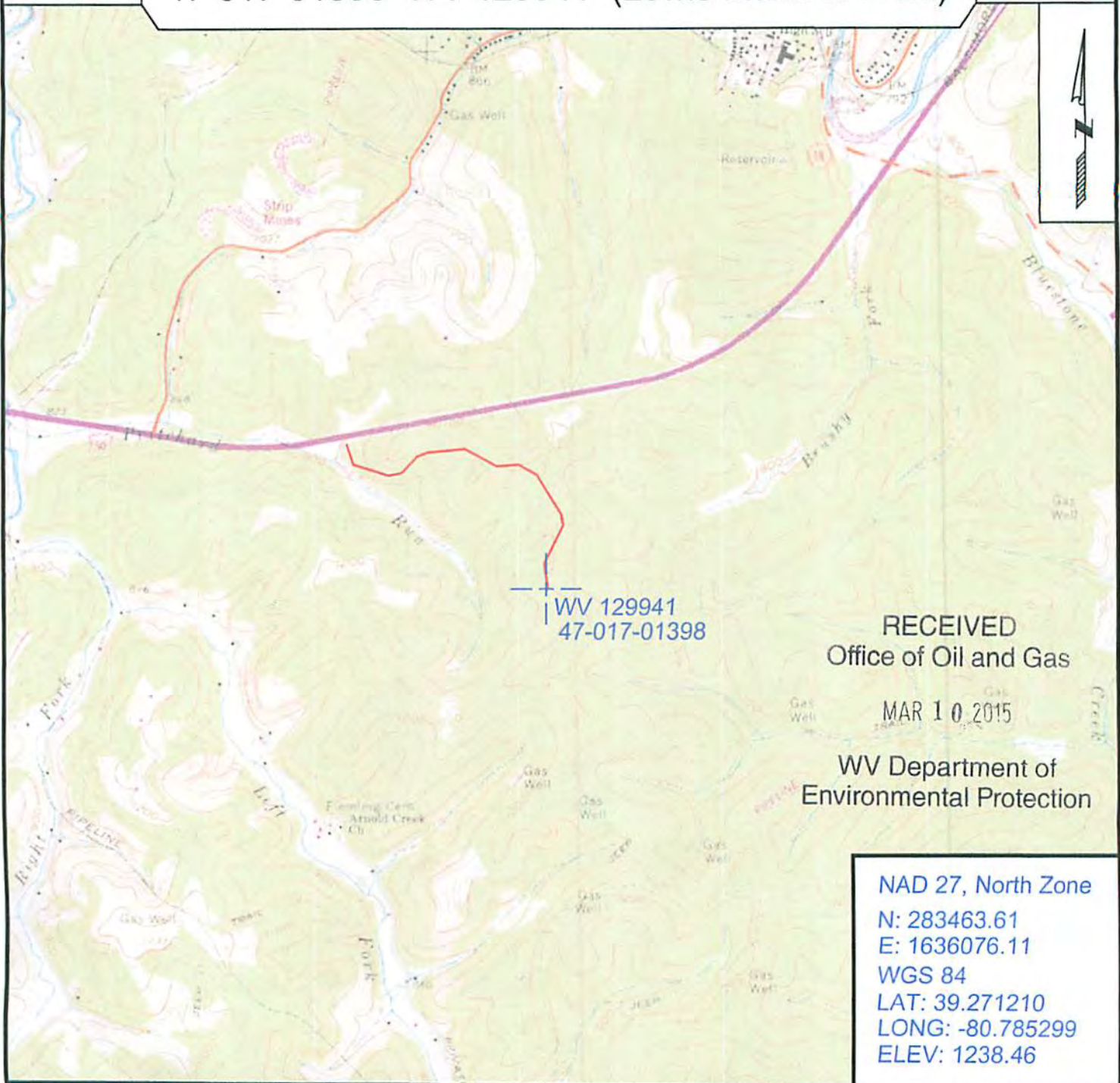

RECEIVED  
Office of Oil and Gas

MAR 10 2015

WV Department of  
Environmental Protection

NAD 27, North Zone  
 N: 283463.61  
 E: 1636076.11  
 WGS 84  
 LAT: 39.271210  
 LONG: -80.785299  
 ELEV: 1238.46



SURVEYING AND MAPPING SERVICES PERFORMED BY:  
**ALLEGHENY SURVEYS, INC.**

1-800-482-8606  
 237 Birch River Road  
 Birch River, WV 26610  
 PH: (304) 649-8606  
 FAX: (304) 649-8608

PREPARED FOR:

**EQT Production Company**

P.O. Box 280  
 Bridgeport, WV 26330