

LATITUDE 39 10

LONGITUDE 80 45

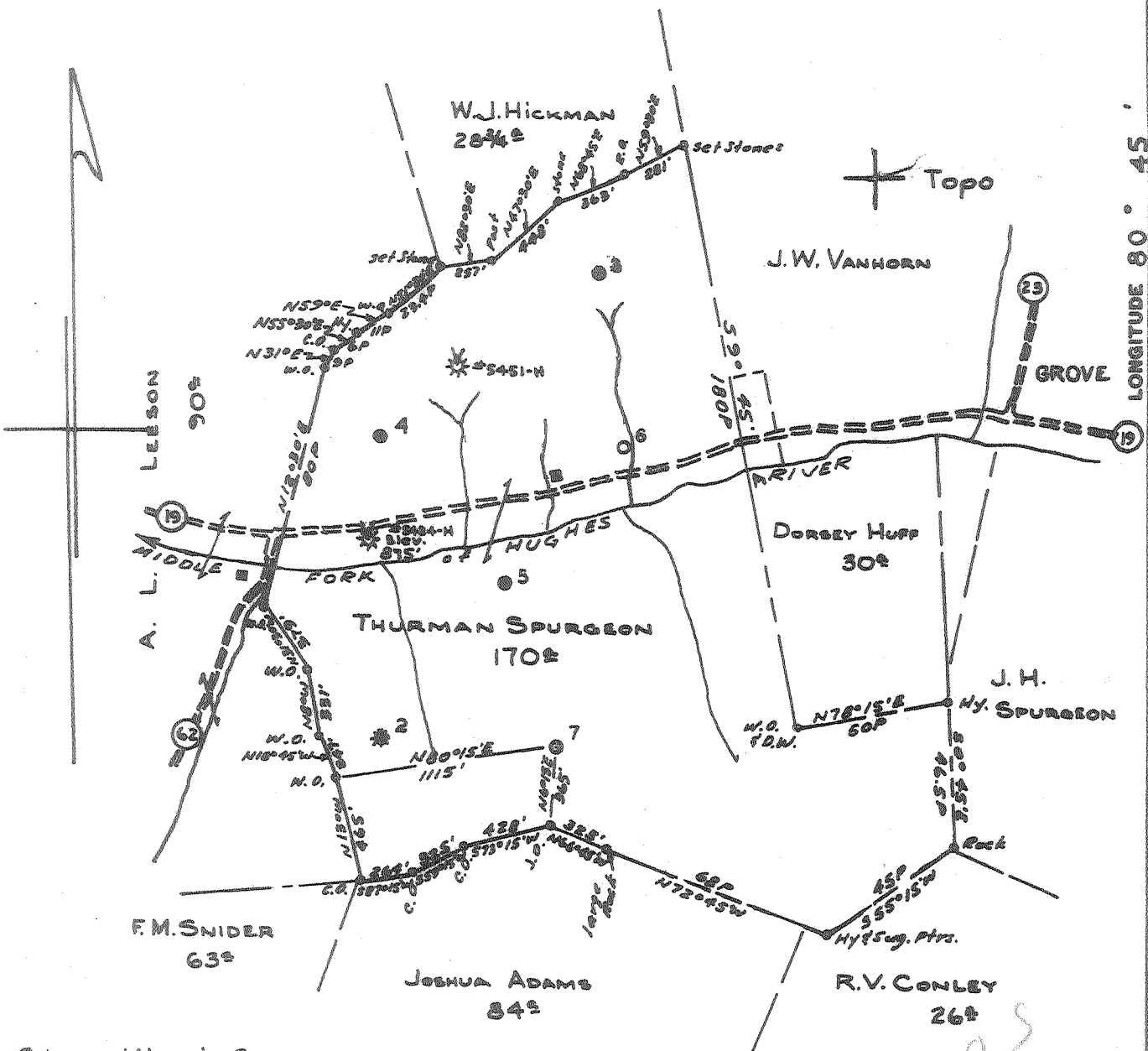

SURFACE: Nannie Spurgeon
 Auburn, W. Va.
 COAL: No Commercial Coal.

Minimum Error of Closure 1' in 200'

Source of Elevation H. N. G. Co. Well #5434-H (Abd. Permit - Dodd. 1052-A) ELEV. 875' ground.

I, the undersigned, hereby certify that this map is correct to the best of my knowledge and belief and shows all the information required by paragraph 6 of the rules and regulations of the oil and gas section of the mining laws of West Virginia.

- Fracture.....
- New Location.....
- Drill Deeper.....
- Abandonment.....

Signed: A.C. Hillbert

Map No. 647 Squares: N S 21 E W 9-10

Company PENNZOIL COMPANY
 Address P. O. BOX 1588, PARKERSBURG, W. VA.
 Farm THURMAN SPURGEON
 Tract _____ Acres 170^e Lease No. 71767
 Well (Farm) No. 7 Serial No. _____
 Elevation (Spirit Level) 1169.79' ground
 Quadrangle HOLBROOK EL
 County DODDRIDGE District COVE
 Engineer A.C. Hillbert
 Engineer's Registration No. 2534
 File No. 1416 Drawing No. _____
 Date Oct. 6, 1965 Scale 1" = 800'

STATE OF WEST VIRGINIA
 DEPARTMENT OF MINES
 OIL AND GAS DIVISION
 CHARLESTON

WELL LOCATION MAP

FILE NO. Dod - 1329

+ Denotes location of well on United States Topographic Maps, scale 1 to 62,500, latitude and longitude lines being represented by border lines as shown.

- Denotes one inch spaces on border line of original tracing.



12-1-65
WJ

STATE OF WEST VIRGINIA
DEPARTMENT OF MINES
OIL AND GAS DIVISION

Rotary
Spudder
Cable Tools
Storage

Quadrangle HOLBROOK
Permit No. DOD-1329

WELL RECORD

Oil or Gas Well Gas + Oil
(KIND)

Company PENNZOIL COMPANY
Address P. O. Box 1588, Parkersburg, West Va.
Farm Thurman Spurgeon Acres 170
Location (waters) _____
Well No. 7 Elev. 1169.79
District Cove County Doddridge
The surface of tract is owned in fee by Nannie Spurgeon
Address Auburn, West Va.
Mineral rights are owned by LaVaughn Wolverton, et al
Address West Union, W. Va.
Drilling commenced October 22, 1965
Drilling completed October 28, 1965
Date Shot _____ From _____ To _____
With _____
Open Flow _____ /10ths Water in _____ Inch
_____ /10ths Merc. in _____ Inch
Volume Show _____ Cu. Ft.
Rock Pressure _____ lbs. _____ hrs.
Oil show _____ bbls., 1st 24 hrs.
WELL ACIDIZED _____

Casing and Tubing	Used in Drilling	Left in Well	Packers
Size			
8 5/8"	489.67	489.67	Kind of Packer
5 1/2"	2193.17	2193.17	Guide Shoe
2-3/8"	2126.14	2126.14	Float Collar
8 1/4"			Size of
6 5/8"			5-1/2"
5 3/16"			5-1/2"
3"			Depth set
2"			2170'
Liners Used			2148' 2109-1/2
			Perf. top
			Perf. bottom 2114-1/2
			Perf. top
			Perf. bottom

CASING CEMENTED 8 5/8" SIZE 484 No. Ft. 10-22-65 Date
5-1/2" 2170 10-28-65
COAL WAS ENCOUNTERED AT _____ FEET _____ INCHES
_____ FEET _____ INCHES
_____ FEET _____ INCHES

WELL FRACTURED November 2, 1965 Used: 58,000# Sand, 600 Gals. Mud Acid, 200# J-111, 400# J-84, 25 Gal. F-40, 40 Gal. Freflo, 3 Allison
RESULT AFTER TREATMENT Gas: 150 MCF Oil: 100 Bbls.
ROCK PRESSURE AFTER TREATMENT 300#
Fresh Water _____ Feet _____ Salt Water _____ Feet _____

Formation	Color	Hard or Soft	Top	Bottom	Oil, Gas or Water	Depth	Remarks
Silts & Shale			0	500			
Sand			500	520			
Shale			520	555			
Sand			555	580			
Shale			580	618			
Silts & Shale			618	985			
Sand			985	995			
Shale			995	1135			
Sand			1135	1160			
Silts & Shale			1160	1340			
Sand & Shale			1340	1428			
Shale			1428	1510			
Sand			1510	1522			
Shale			1522	1568			
Sand			1568	1572			
Shale			1572	1594			
Sand			1594	1716			
Shale			1716	1792			
Sand			1792	1846			
Shale			1846	1944			
Little Lime			-1944	1958			
Blue Monday			1958	1967			
Pencil Cave			1967	1976			
Big Lime			-1976	2037			
Big Injun			2037	2123			
Pay			2108	2118			
Grey Shale			2123	2170			
Total Depth				2170			

