

WW-7
8-30-06



West Virginia Department of Environmental Protection
Office of Oil and Gas
WELL LOCATION FORM: GPS

API: 47-017-01231 WELL NO.: WV 129931 (Lewis Maxwell B24)

FARM NAME: Lewis Maxwell

RESPONSIBLE PARTY NAME: EQT Production Company

COUNTY: Doddridge DISTRICT: West Union

QUADRANGLE: West Union 7.5'

SURFACE OWNER: Ruth M. Davies Pierce, et al.

ROYALTY OWNER: Lewis Maxwell Oil and Gas, LLC, et al.

UTM GPS NORTHING: 4347779

UTM GPS EASTING: 519576 GPS ELEVATION: 304 m (999 ft)

The Responsible Party named above has chosen to submit GPS coordinates in lieu of preparing a new well location plat for a plugging permit or assigned API number on the above well. The Office of Oil and Gas will not accept GPS coordinates that do not meet the following requirements:

1. Datum: NAD 1983, Zone: 17 North, Coordinate Units: meters, Altitude: height above mean sea level (MSL) – meters.
2. Accuracy to Datum – 3.05 meters
3. Data Collection Method:

Survey grade GPS _____ : Post Processed Differential _____
 Real-Time Differential _____
 Mapping Grade GPS X : Post Processed Differential X
 Real-Time Differential _____

4. **Letter size copy of the topography map showing the well location.**

I the undersigned, hereby certify this data is correct to the best of my knowledge and belief and shows all the information required by law and the regulations issued and prescribed by the Office of Oil and Gas.

Sty O'Brien
Signature

PS #2180
Title

4/27/18
Date

RECEIVED
Office of Oil and Gas
JUN 05 2018
WV Department of
Environmental Protection

Topo Quad: West Union 7.5' Scale: 1" = 2000'
 County: Doddridge Date: April 27, 2018
 District: West Union Project No: 67-30-00-08

47-017-01231 WV 129931 (Lewis Maxwell B24)

Topo

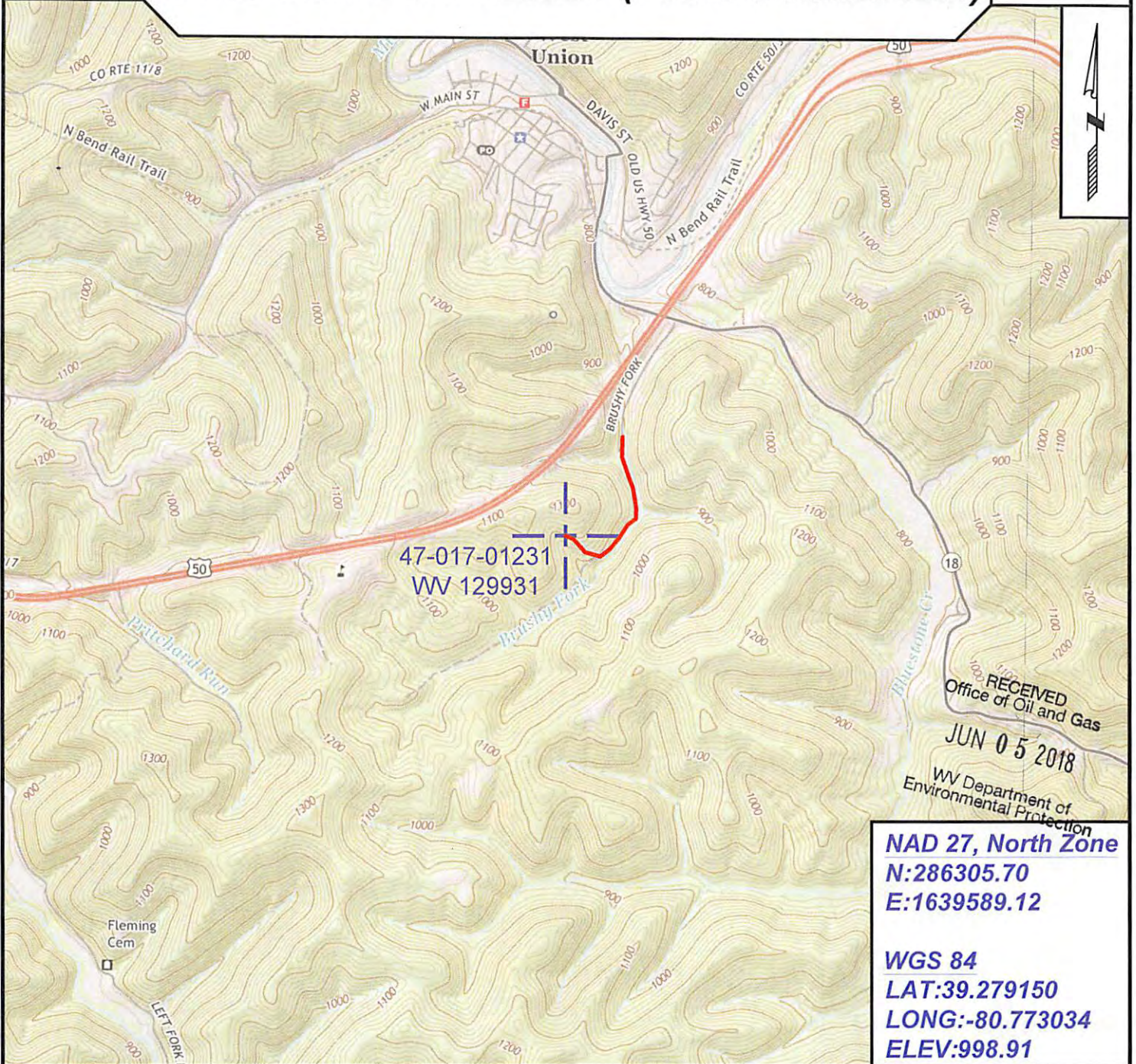

47-017-01231
WV 129931

NAD 27, North Zone
N:286305.70
E:1639589.12

WGS 84
LAT:39.279150
LONG:-80.773034
ELEV:998.91



SURVEYING AND MAPPING SERVICES PERFORMED BY:
ALLEGHENY SURVEYS, INC.
 1-800-482-8606
 237 Birch River Road
 Birch River, WV 26610
 PH: (304) 649-8606
 FAX: (304) 649-8608

PREPARED FOR:
EQT Production Company
 2400 Ansys Drive
 Canonsburg, PA 15317

06/15/2018