

Derivation of Elevation
USGS BM marked "7-JEA", elev.
850, on handrail of bridge at
mouth of Brushy Fork.

I, the undersigned, hereby certify that this map is correct to the best of my knowledge and belief and shows all of the information required by paragraph 6 of the rules and regulations of the oil and gas section of the mining laws of West Virginia.

W. H. ...
R. P. E. No. 1227

- New Location
- Drill Deeper
- Abandonment

issued 3/26/74
Error in closure: - less than 1/100'

Company Southern Triangle Oil Co
 Address Box 473, Mt. Carmel, Ill., 62863
 Farm Celia Schulte "B" Lease
 Tract _____ Acres 53.0 Lease No. _____
 Well (Farm) No. "B" One Serial No. _____
 Elevation (Spirit Level) 1213' 1150'
 Quadrangle Nadis WC
 County Doddridge District Cann
 Engineer W. H. ...
 Engineer's Registration No. 1227
 File No. _____ Drawing No. _____
 Date June 8, 1963 Scale 1" = 300' 495'

STATE OF WEST VIRGINIA
DEPARTMENT OF MINES
OIL AND GAS DIVISION
CHARLESTON

WELL LOCATION MAP
FILE NO. Doc-989-P

+ Denotes location of well on United States Topographic Maps, scale 1 to 62,500, latitude and longitude lines being represented by border lines as shown.

- Denotes one inch spaces on border line of original tracing.

47-017

Latitude 39° 10'

Longitude 80° 40'

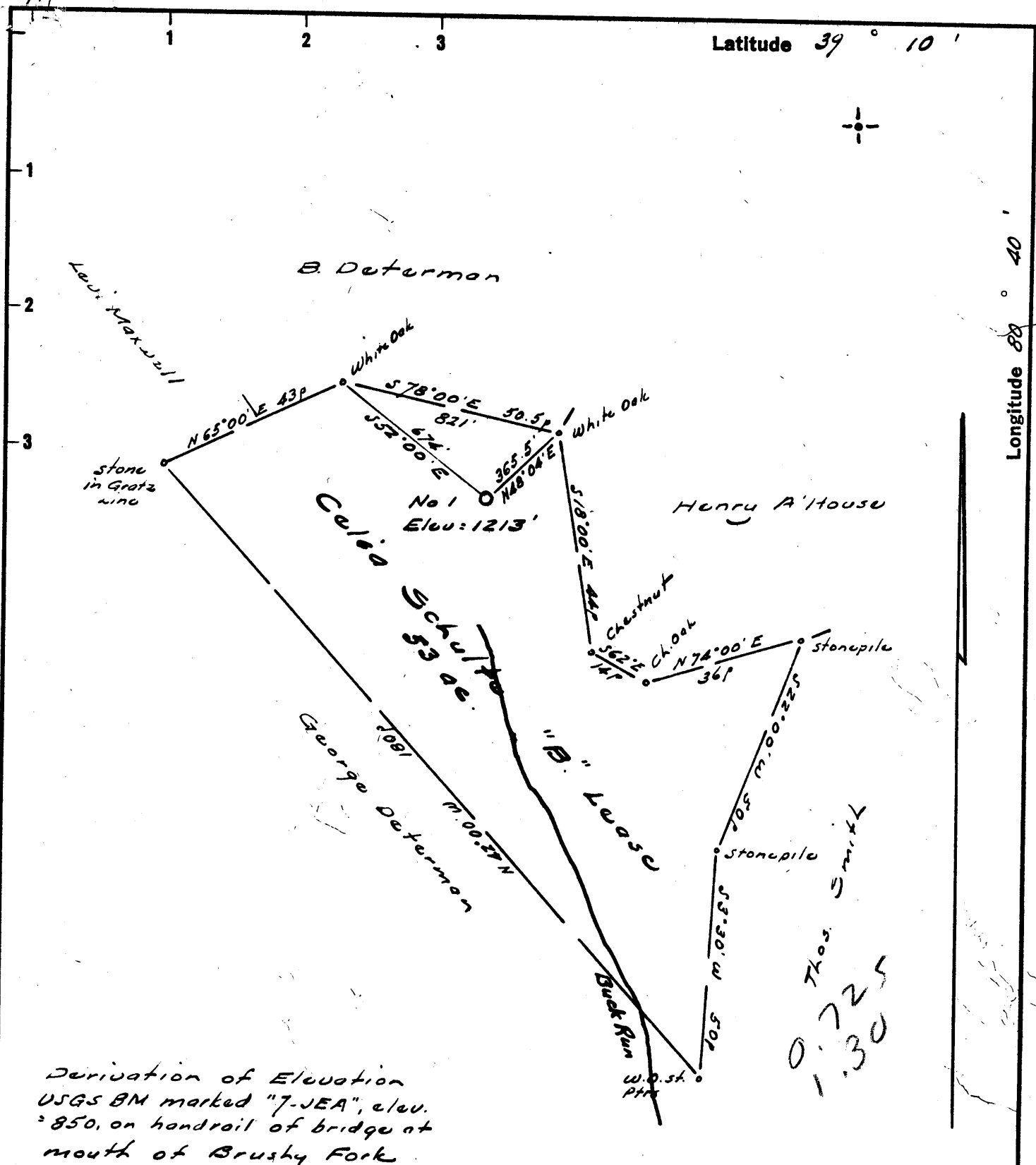

Derivation of Elevation
 USGS BM marked "7-JEA", elev.
 = 850, on handrail of bridge at
 mouth of Brushy Fork

I, the undersigned, hereby certify that this map is correct to the best of my knowledge and belief and shows all of the information required by paragraph 6 of the laws and regulations of the oil and gas section of the mining laws of West Virginia.

W. H. St. Pth
 R. P. E. No. 1227

- New Location
- Drill Deeper
- Abandonment

Error in Closure: - Less than 1/100

Company Southern Triangle Oil Co.
 Address 104 Bank St., Weston, W. Va.
 Farm Celia Schulte "B" Lease
 Tract _____ Acres 53.0 Lease No. _____
 Well (Farm) No. One Serial No. _____
 Elevation (Spirit Level) 1213'
 Quadrangle Vadis WC
 County Doddridge District Cove
 Engineer W. H. St. Pth
 Engineer's Registration No. 1227
 File No. _____ Drawing No. _____
 Date June 8, 1963 Scale 1" = 300' = 495'

STATE OF WEST VIRGINIA
 DEPARTMENT OF MINES
 OIL AND GAS DIVISION
 CHARLESTON

WELL LOCATION MAP
 FILE NO. Dod-989

- + Denotes location of well on United States Topographic Maps, scale 1 to 62,500, latitude and longitude lines being represented by border lines as shown.
- Denotes one inch spaces on border line of original tracing.



STATE OF WEST VIRGINIA
DEPARTMENT OF MINES
OIL AND GAS DIVISION

Rotary
 Spudder
 Cable Tools
 Storage Gas Sho
 Oil or Gas Well oil well (KIND)

Quadrangle Va dis
 Permit No. DOD - 989

WELL RECORD

Company Southern Triangle Oil Co.
 Address Box 230, Mt. Carmel, Illinois
 Farm Celia Schulte Acres 53
 Location (waters) Buck Run (150' - 160' - 170')
 Well No. B-1 Elev. 1222 75
 District _____ County Doddridge
 The surface of tract is owned in fee by Celia Schulte
 Address Nutter Fort, W. Va.
 Mineral rights are owned by Celia Schulte
 Address Nutter Fort, W. Va.
 Drilling commenced 6-25-63
 Drilling completed 7-19-63
 Date Shot _____ From _____ To _____
 With _____
 Open Flow _____ /10ths Water in _____ Inch
 _____ /10ths Merc. in _____ Inch
 Volume 100,000 Cu. Ft.
 Rock Pressure 750 lbs. 24 hrs.
 Oil (45) bbls., 1st 24 hrs.
 WELL ACIDIZED NO
 WELL FRACTURED NO

Casing and Tubing	Used in Drilling	Left in Well	Packers
Size			Kind of Packer
16			
13			
10			Size of
8 1/2	80	80	
6 3/8			Depth set
5 3/16		2398	
3			Perf. top
2			Perf. bottom
Liners Used			Perf. top
			Perf. bottom

CASING CEMENTED 5 1/2 SIZE 2398 No. Ft. _____ Date _____
 By Dowell 50 sks. cement
 COAL WAS ENCOUNTERED AT 0 FEET 0 INCHES
 _____ FEET _____ INCHES FEET _____ INCHES
 _____ FEET _____ INCHES FEET _____ INCHES

RESULT AFTER TREATMENT

ROCK PRESSURE AFTER TREATMENT

Fresh Water none Feet _____ Salt Water none Feet _____

Formation	Color	Hard or Soft	Top	Bottom	Oil, Gas or Water	Depth	Remarks
soil	yellow	soft	0	14			
shly sand	grey	soft	14	106			
shale	grey	soft	106	243			
sand	white	soft	243	279			
shale & shly							
sand	grey	soft	279	604			
sand	white	soft	604	673			
shale	grey	soft	673	864			
shly sand	grey	864	1011				
shale	grey	soft	1011	1143			
shly sand	grey	soft	1143	1231			
shale	grey	soft	1231	1391			
sand	white	hard	1391	1503			
shale	grey	soft	1503	1642			
shly sand	grey	soft	1642	1725			
shale	grey	soft	1725	1903			
shly sand & shale	grey	soft	1903	2256			
Little Lime	brown	hard	2256	2269			
shale	green	soft	2269	2284			
Blue Monday	white	hard	2284	2330			
Big Lime	brown	hard	2330	2355			
sandy lime	grey	hard	2355	2403			
sand	white	soft	2403	2420			
TD	2420				1st salt sand		
					gas & oil	2403 - 20	

