

**AUDIE I. COTTRILL ET AL. LEASE**  
**183 ACRES**  
**WELL NO. 2-3**  
**47-017-00933**

(UTM(M) ZONE 17)  
 NAD'83 GEO. LAT-(N) 39.373984 LONG-(W) 80.644783  
 NAD'83 UTM (M) N. 4,358,339 E. 530,596

5-18-64  
 WESLEY R. DRAKE  
 40.25 AC.

5-18-68  
 DAVID JOSEPH  
 NADOLNY  
 183.08 AC.

WELL NO. 2-3  
 47-017-00933

P/O 5-18-68  
 DAVID JOSEPH  
 NADOLNY  
 183.08 AC.

5-23-6  
 HOWARD C. SITLER &  
 REAGAN J. ALLISON, JR.  
 102 AC.

5-18-61  
 NAZERETH  
 FARM INC.  
 98 AC.

5-23-7  
 GODFREY C.  
 MEREDITH ET AL.  
 16.4 AC.



12 Vauhorn Drive | P.O. Box 150 | Glenville, WV 26351 | 304.462.5634  
 1413 Kanawha Boulevard, East | Charleston, WV 25201 | 304.546.3952  
 254 East Beckley Bypass | Beckley, WV 25801 | 304.255.5296  
[slsvv.com](http://slsvv.com)

**LEGEND**

- LEASE LINE
- SURFACE LINE
- TIE LINE
- CREEK
- ROAD
- COUNTY ROUTE
- PROPOSED WELL
- EXISTING WELL
- PERMITTED WELL
- DISTRICT-TAXMAP-PARCEL 00-00-00

**NOTES ON SURVEY**

- WELL SPOT CIRCLE & TOPO MARK SCALE IS 1"=2000'.

I THE UNDERSIGNED, HEREBY CERTIFY THAT THIS PLAT IS CORRECT TO THE BEST OF MY KNOWLEDGE AND BELIEF AND SHOWS ALL THE INFORMATION REQUIRED BY LAW AND THE REGULATIONS ISSUED AND PRESCRIBED BY THE DIVISION OF ENVIRONMENTAL PROTECTION.

P.S. 677 Gregory A. Smith



(+) DENOTES LOCATION OF WELL ON UNITED STATES TOPOGRAPHIC MAPS.  
 DATE JANUARY 16, 20 23  
 REVISED \_\_\_\_\_, 20 \_\_\_\_  
 OPERATORS WELL NO. 2-3  
 API WELL NO. 47 - 017 - 00933-P  
 STATE COUNTY PERMIT

MINIMUM DEGREE OF ACCURACY 1 / 2500 FILE NO. 9340-SURV-Well 4701700933-MT-R00-20230119.dwg  
 HORIZONTAL & VERTICAL CONTROL DETERMINED BY DGPS (SUBMETER MAPPING GRADE TIE TO CORS NETWORK) SCALE 1" = 500'

STATE OF WEST VIRGINIA  
 DIVISION OF ENVIRONMENTAL PROTECTION  
 OFFICE OF OIL AND GAS

WELL TYPE: OIL  GAS  LIQUID INJECTION  WASTE DISPOSAL  IF "GAS" PRODUCTION  STORAGE  DEEP  SHALLOW   
 LOCATION:  
 ELEVATION 1019' WATERSHED LITTLE BATTLE RUN  
 DISTRICT McCLELLAN COUNTY DODDRIDGE QUADRANGLE SMITHBURG 7.5'  
 SURFACE OWNER DAVID JOSEPH NADOLNY ACREAGE 183.08±  
 ROYALTY OWNER DRILLING APPALACHIAN COPROPRATION, ET AL ACREAGE 183±  
 PROPOSED WORK:  
 DRILL  CONVERT  DRILL DEEPER  REDRILL  FRACTURE OR STIMULATE  PLUG OFF OLD FORMATION   
 PERFORATE NEW FORMATION  PLUG AND ABANDON  CLEAN OUT AND REPLUG  OTHER   
 PHYSICAL CHANGE IN WELL (SPECIFY) \_\_\_\_\_ TARGET FORMATION MAXON  
 ESTIMATED DEPTH 1800'

WELL OPERATOR UNKNOWN WVDEP PAID PLUGGING CONTRACT DESIGNATED AGENT JASON HARMON, WVDEP  
 ADDRESS 601 57TH STREET ADDRESS 601 57TH STREET  
CHARLESTON, WV 25304 (WVDEP) CHARLESTON, WV 25304

STS

# A.J. COTTRILL LEASE

## 47-017-00933

03/10/2023

RECEIVED  
Office of Oil and Gas  
JAN 26 2023  
WV Department of  
Environmental Protection

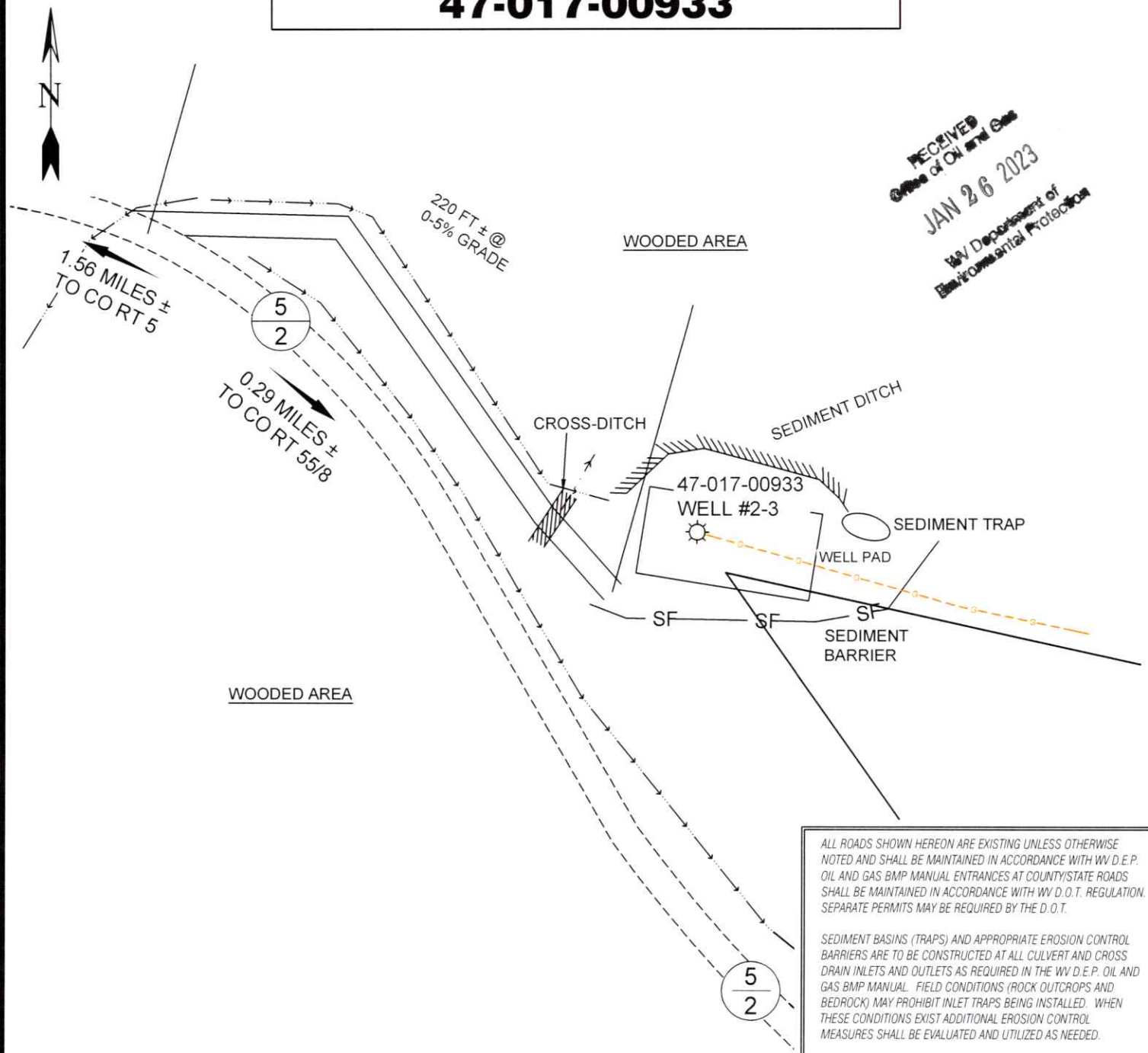

ALL ROADS SHOWN HEREON ARE EXISTING UNLESS OTHERWISE NOTED AND SHALL BE MAINTAINED IN ACCORDANCE WITH WV D.E.P. OIL AND GAS BMP MANUAL. ENTRANCES AT COUNTY/STATE ROADS SHALL BE MAINTAINED IN ACCORDANCE WITH WV D.O.T. REGULATION. SEPARATE PERMITS MAY BE REQUIRED BY THE D.O.T.

SEDIMENT BASINS (TRAPS) AND APPROPRIATE EROSION CONTROL BARRIERS ARE TO BE CONSTRUCTED AT ALL CULVERT AND CROSS DRAIN INLETS AND OUTLETS AS REQUIRED IN THE WV D.E.P. OIL AND GAS BMP MANUAL. FIELD CONDITIONS (ROCK OUTCROPS AND BEDROCK) MAY PROHIBIT INLET TRAPS BEING INSTALLED. WHEN THESE CONDITIONS EXIST ADDITIONAL EROSION CONTROL MEASURES SHALL BE EVALUATED AND UTILIZED AS NEEDED.

EARTHWORK CONTRACTORS ARE RESPONSIBLE FOR NOTIFICATION TO THE OPERATOR AND INSPECTOR PRIOR TO ANY DEVIATION FROM THIS PLAN.

TEMPORARY SEED & MULCH ALL SLOPES AFTER CONSTRUCTION OF LOCATION.

CUT & STACK ALL MARKETABLE TIMBER.

STACKED BRUSH MAY BE USED FOR SEDIMENT CONTROL.

APPLICATIONS FOR SEPARATE PLC PERMITS ON THE ACCESS ROAD STREAM CROSSINGS HAVE BEEN PREPARED (IF APPLIES).

- = EXISTING CULVERT
- = PROPOSED CULVERT 15' MIN. UNLESS OTHERWISE NOTED
- = PROPOSED STREAM CROSSING
- = APPROXIMATE LIMITS OF DISTURBANCE

### SCALE: 1"=50'

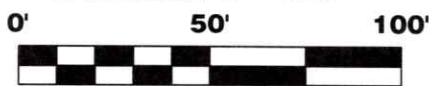

12 Vanhorn Drive | P.O. Box 150 | Glenville, WV 26351 | 304.462.5634  
 1412 Kanawha Boulevard, East | Charleston, WV 25301 | 304.348.3952  
 254 East Beckley Bypass | Beckley, WV 25801 | 304.255.5296  
 slswv.com

DRAWN BY JDR	FILE NO. 9340	DATE 01-19-23	CADD FILE: 9340-SURV-REC-R00-JDR-230116.DWG
-----------------	------------------	------------------	--

# A.J. COTTRILL LEASE 47-017-00933



12 Vanhorn Drive | P.O. Box 150 | Glenville, WV 26351 | 304.462.5634  
1412 Kanawha Boulevard, East | Charleston, WV 25301 | 304.346.3952  
254 East Beckley Bypass | Beckley, WV 25801 | 304.255.5296  
slsw.com

**SCALE: 1"=2000'**

0'      2000'      4000'



TOPO SECTION OF SMITHBURG, WV  
7.5' TOPO QUADRANGLE

DRAWN BY JDR	FILE NO. 9340	DATE 01-18-23	CADD FILE: 9340-SURV-REC-000- JDR-230116.DWG
-----------------	------------------	------------------	--