

AM

Latitude 39° 15'

Longitude 80° 40'

Note:- Well elevation taken from U.S.G.S. B.M. (Elev = 1268) located on the west side of ridge road approx. 1/4 mi from location in a NNE direction

1
2
3

E.H. KING

LICK RUN

AL

Robert Holland



200 AC.

Porter Maxwell

N 1° 45' E 235 P

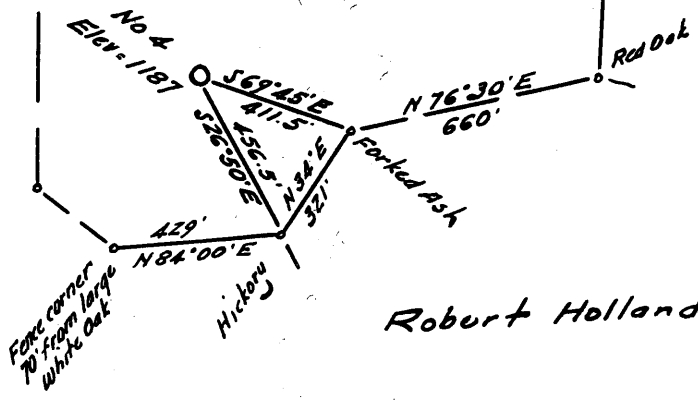

Robert Holland

4.80
4.24

- New Location ..
- Drill Deeper
- Abandonment

W. H. Stetson

Company Thomas E. Allen
 Address Box 176, West Union, W. Va.
 Farm E. H. King, et al
 Tract _____ Acres 200 Lease No. _____
 Well (Farm) No. 4 Serial No. _____
 Elevation (Spirit Level) 1187
 Quadrangle Uadis NW
 County Doddridge District New Milton
 Engineer W. H. Stetson
 Engineer's Registration No. 1227
 File No. _____ Drawing No. _____
 Date Dec 31, 1962 Scale 1" = 40' = 660'

STATE OF WEST VIRGINIA
DEPARTMENT OF MINES
OIL AND GAS DIVISION
CHARLESTON

WELL LOCATION MAP
FILE NO. Dod-924

+ Denotes location of well on United States Topographic Maps, scale 1 to 62,500, latitude and longitude lines being represented by border lines as shown.

- Denotes one inch spaces on border line of original tracing.

6-6 134

WR-35

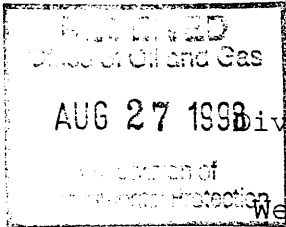

31-Jan-97
API # 47- 17-00924 D

State of West Virginia
Division of Environmental Protection
Section of Oil and Gas

Well Operator's Report of Well Work

Farm name: ADRIAN, GEORGE Operator Well No.: MAXWELL #4

LOCATION: Elevation: 1,187.00 Quadrangle: NEW MILTON

District: NEW MILTON County: DODDRIDGE
Latitude: 5320 Feet South of 39 Deg. 15Min. 0 Sec.
Longitude 8750 Feet West of 80 Deg. 42 Min. 30 Sec.

Company: MUTSCHELKNAUS, CLARENCE W
170 E. MAIN ST. P.O. BOX 351
SALEM, WV 26426-0351

Casing & Tubing Size	Used in Drilling	Left in Well	Cement Fill Up Cu. Ft.
7"	2054	2054	
2 7/8"	2670	2670	

Agent: NORMAN J. OLLEY

Inspector: MIKE UNDERWOOD
Permit Issued: 01/31/97
Well work Commenced: 4/31/97
Well work Completed: 4/10/97
Verbal Plugging _____
Permission granted on: _____
Rotary Cable Rig
Total Depth (feet) 2675
Fresh water depths (ft) NA

Salt water depths (ft) NA

Is coal being mined in area (Y/N)? NO
Coal Depths (ft): _____

OPEN FLOW DATA

This is a Drill Deeper

Producing formation Gorden Pay zone depth (ft) 2570
Gas: Initial open flow 150,000 MCF/d Oil: Initial open flow 5 Bbl/d
Final open flow 400,000 MCF/d Final open flow 3 Bbl/d
Time of open flow between initial and final tests _____ Hours
Static rock Pressure 86 psig (surface pressure) after 12 Hours

Second producing formation _____ Pay zone depth (ft) _____
Gas: Initial open flow _____ MCF/d Oil: Initial open flow _____ Bbl/d
Final open flow _____ MCF/d Final open flow _____ Bbl/d
Time of open flow between initial and final tests _____ Hours
Static rock Pressure _____ psig (surface pressure) after _____ Hours

NOTE: ON BACK OF THIS FORM PUT THE FOLLOWING: 1). DETAILS OF PERFORATED INTERVALS, FRACTURING OR STIMULATING, PHYSICAL CHANGE, ETC. 2). THE WELL LOG WHICH IS A SYSTEMATIC DETAILED GEOLOGICAL RECORD OF ALL FORMATIONS, INCLUDING COAL ENCOUNTERED BY THE WELLBORE.

For: Clarence W. Mutschelknaus
MUTSCHELKNAUS, CLARENCE W.

By: Clarence W. Mutschelknaus
Date: 10/9/97

SEP 14 1997

0000 0734 0



STATE OF WEST VIRGINIA
DEPARTMENT OF MINES
OIL AND GAS DIVISION 4

P

Quadrangle Vadis

Permit No. DOD-924

WELL RECORD

Oil or Gas Well Gas
(KIND)

Company T. E. Allen
Address P. O. Box 176, West Union, W. Va.
Farm E. H. King Acres 200
Location (waters) Lick Run
Well No. 4 Mas Elev. 1187
District New Milton County Doddridge
The surface of tract is owned in fee by Maxwell Heirs
Address West Union, W. Va.
Mineral rights are owned by Lewis Maxwell Heirs
Address West Union, W. Va.
Drilling commenced June 7, 1963
Drilling completed July 10, 1963
Date Shot X From _____ To _____
With X
Open Flow 20 /10ths Water in _____ Inch
_____ /10ths Merc. in _____ Inch
Volume _____ Cu. Ft.
Rock Pressure 250 lbs. 12 hrs.
Oil none bbls., 1st 24 hrs.
WELL ACIDIZED ----
WELL FRACTURED Yes

Casing and Tubing	Used in Drilling	Left in Well	Packers
Size			Kind of Packer
16			
13			
10			Size of
8 1/2			
6 3/4	2054	2054	Depth set
5 3/16			
3			Perf. top
2			Perf. bottom
Liners Used			Perf. top
			Perf. bottom

CASING CEMENTED Yes SIZE 7' No. Ft. 2054 Date
45 sks. cement - 4 sks. aquagel-Garaton
COAL WAS ENCOUNTERED AT _____ FEET _____ INCHES
_____ FEET _____ INCHES FEET _____ INCHES
_____ FEET _____ INCHES FEET _____ INCHES

RESULT AFTER TREATMENT 400,000 CU. FT. ✓
ROCK PRESSURE AFTER TREATMENT 500 - 24 hrs.
Fresh Water Yes Feet 125 Salt Water _____ Feet

Formation	Color	Hard or Soft	Top	Bottom	Oil, Gas or Water	Depth	Remarks
Surface	Slate	Shells Hard	0	40			
Slate-Shells	Gray	Hard	40	130	Water	125	Fresh
Sand	"	"	130	157			
Slate-Shells	"	"	157	172			
Red Rock	Red	"	172	197			
Sand	Gray	Soft	197	225			
Slate	"	Hard	225	264			
Sand	"	Soft	264	305			
Red Rock	Red	Hard	305	323			
Lime	Gray	"	323	336			
Rock	Red	"	336	372			
Sand	Gray	Soft	372	401			
Sla.-Shells	Gray	Hard	401	442			
Rock	Red	"	442	472			
Slate-Shells	Gray	"	472	482			
Sand	"	Soft	482	512			
Slate-Shells	"	Hard	512	523			
Lime-Shells	"	Soft	523	562			
Slate-Shells	"	Hard	562	650			
Rock	Red	"	650	685			
Slate-Shells	Gray	"	685	695			
Rock	Red	"	695	741			
Sand	Gray	Hard	741	783			
Rock	Red	"	783	810			
Slate-Shells	Gray	"	810	876	Water	920	Fresh
Rock	Red	"	876	886			
Shell	Gray	"	886	905			
Sand	"	Soft	905	936			
Lime	Pink	Hard	936	957			
Slate-Shells	Gray	"	957	1008			

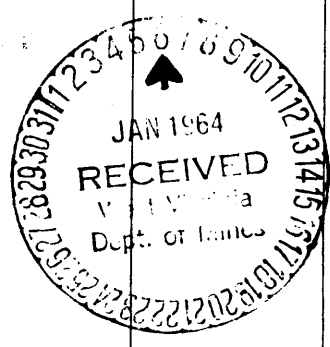

Formation	Color	Hard or Soft	Top 4	Bottom	Oil, Gas or Water	Depth Found	Remarks
Sand	Gray	Soft	1008	1032			
Slate-Shells	"	Hard	1032	1090			
Lime	Pink	Soft	1090	1125			
Slate-Shells	Gray	Hard	1125	1152			
Rock	Red	"	1152	1158			
Sand	Gray	Soft	1158	1204			
Slate	"	Hard	1204	1213			
Sand	"	Soft	1213	1289			
Slate-Shells	"	Hard	1289	1300			
Sand	"	Soft	1300	1335	Water	1315	Fresh
Slate-Shells	"	Hard	1335	1366			
Sand	"	Soft	1366	1455			
Slate-Shells	"	Hard	1455	1590			
Sand	"	Soft	1590	1659			
Lime	Pink	Hard	1659	1752			
Sand	Gray	Soft	1752	1770			
Slate-Shells	"	Hard	1770	1835			
Sand	"	Soft	1835	1870			
Slate	"	Hard	1870	1887			
Big Lime	Pink	"	1887	1889			
Sand	Gray	Soft	1889	1946			
Sand	"	"	1946	1986	Gas	1986	
Injun Sand	Gray	"	1986	2022			
Slate	"	Hard	2022	2038			
Lime	"	"	2038	2055			

Date January 3, 1964

APPROVED J. E. Allen, Owner

Promoter

By _____

(Title)

1 Date: 1-16-97
2 Operator's well number
3 API Well No: 47 - Dod-00924
State County Permit

Surface Owner Back of page signed on file copy

Drill Dept

STATE OF WEST VIRGINIA - BUREAU OF ENVIRONMENT
DIVISION OF ENVIRONMENTAL PROTECTION
OFFICE OF OIL AND GAS

NOTICE AND APPLICATION FOR A WELL WORK PERMIT

- 4) Surface Owner(s) to be served: (a) Coal Operator:
- (a) Name George Adrian Name None
Address Rt 18 Blodville Address _____
West Union WV
- (b) Name _____ (b) Coal Owner(s) with Declaration
Address _____ Name None
Address _____
- (c) Name _____ (c) Coal Lessee with Declaration
Address _____ Name _____
Address _____
- 6) Inspector M. K. Underwood (c) Coal Lessee with Declaration
Address Rt 2, Box 39A Name None
Salem WV 26426 Address _____
Telephone (304)- 732-1043

TO THE PERSON(S) NAMED ABOVE TAKE NOTICE THAT:

Included is the lease or leases or other continuing contract or contracts by which I hold the right to extract oil and gas OR
 Included is the information required by Chapter 22, Article 6, Section 8(d) of the Code of West Virginia (see page 2)

I certify that as required under Chapter 22 of the West Virginia Code, I have provided copies of this notice and application, a location plat, and accompanying documents, pages _____ on the above named parties, by

- Personal Service (Affidavit attached)
- Certified Mail (Postmarked postal receipt attached)
- Publication (Notice of Publication attached)

RECEIVED
Division of Environmental Protection

JAN 30 1997

Permitting
Office of Oil & Gas

I have read and understand Chapter 22-6 and 38 CSR 11-18, and I agree to the terms and conditions of any permit issued under this application.

I certify under penalty of law that I have personally examined and am familiar with the information submitted on this application form and all attachments, and that based on my inquiry of those individuals immediately responsible for obtaining the information, I believe that the information is true, accurate, and complete.

I am aware that there are significant penalties for submitting false information, including the possibility of fine and imprisonment.

Well Operator: Charles W. Mutschalknaus
By: W. Mutschalknaus
His title: manager
Address: P.O. Box 351
Salem, WV 26426
Telephone: (304) 742-2707

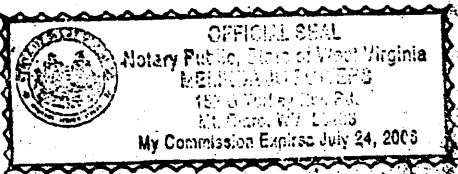

Subscribed and sworn before me this 17 day of January, 19 97

[Signature] Notary Public
My commission expires July 24, 2003

Please Copy